

STATE OF KANSAS  
STATE CORPORATION COMMISSION  
CONSERVATION DIVISION  
800 BITTING BUILDING  
WICHITA, KANSAS

15-069-03319-00-00

WELL PLUGGING APPLICATION FORM

File One Copy

Lease Owner Jones, Shelburne & Farmer Address Russell, Kansas  
(Applicant) Inc.  
Lease (Farm Name) Weissback Well No. 1

Well Location C E/2 NE NE Sec. 22 Twp. 7 Rge. (E)-(W) 22

County Graham Field Name (if any) Worcester

Total Depth 3848 Oil    Gas    Dry Hole X

Was well log filed with application? yes. If not, explain:           

Date and hour plugging is desired to begin 3:30 P. M. 10-18-52

Plugging of the well will be done in accordance with the Rules and Regulations of the State Corporation Commission, or with the approval of the following exceptions: Explain fully any exceptions desired.  
(Use an additional sheet if necessary) none

Name of the person on the lease in charge of well for owner           

Frank Carroll Address Great Bend, Kansas

Name of Plugging Contractor Frank Carroll Casing Pulling Company

Address Great Bend, Kansas

Invoice covering assessment for plugging this well should be sent to

Jones, Shelburne & Farmer, Inc. Address Russell, Kansas

and payment will be guaranteed by applicant.

**PLUGGING**  
FILE SEC 22 7 R 22  
BOOK PAGE 53 LINE 27

STATE CORPORATION COMMISSION  
JAN 24 1953  
CONSERVATION DIVISION  
Wichita, Kansas

John W. Farmer  
Applicant or Acting Agent

Date January 22, 1953

1-24-53

OPERATOR Jones, Shelburne & Farmer, Inc.ADDRESS Russell, Kansas

## FORMATION RECORD

Give detailed description and thickness of all formations drilled through, contents of sand, whether dry, water, oil or gas.

Formation	Top	Bottom	Formation	Top	Bottom
Shale & shells	0	1030			
Shale & sand	1030	1295	TOPS:		
Shale & streaks	1295		Anhydrite	1950	
Sand	1295	1490	Elevation	2309 R. B.	
Sand	1490	1660	Heehner	3502	
Shale	1660	2010	Toronto	3530	
Shale & Red Bed	2010	2294	Lansing	3542	
Shale & Lime	2294	3370	B. of K. C.	3734	
Lime	3370	3438	Marmaton Lime	3776	
Lime & Shale	3438	3535	Marmaton Chert	3801	
Lime	3535	3670	Arbuckle	3844	
Lime & Shale	3670	3719	T. D.	3848	
Lime	3719	3740			
Lime & shale	3740	3845			
Arbuckle					
Total Depth					3848

Total Depth 3848

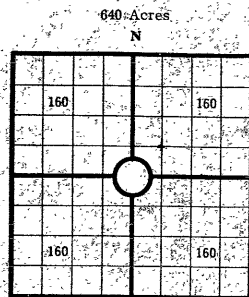

COUNTY 22 SEC 75 TWP 22W RGE

COMPANY OPERATING Jones, Shelburne & Farmer, Inc.

OFFICE ADDRESS Russell, Kansas

FARM NAME Weissback WELL NO. 1

DRILLING STARTED 2-20 19 52 DRILLING FINISHED 3-6 19 52

DATE OF FIRST PRODUCTION \_\_\_\_\_ COMPLETED \_\_\_\_\_

WELL LOCATED C. E/2 NE/4 NE/4 North of South  
Line and \_\_\_\_\_ ft. East of West Line of Quarter Section

Elevation (Relative to sea level) DERRICK FLOOR 2307 GROUND \_\_\_\_\_

CHARACTER OF WELL (Oil, gas, or dryhole) Oil

## OIL OR GAS SANDS OR ZONES

Name	From	To	Name	From	To
1			4		
2			5		
3			6		

## Perforating Record If Any

## Shot Record

Formation	From	To	No. of Shots	Formation	From	To	Size of Shot

## CASING RECORD

Amount Set						Amount Pulled		Packer Record			
Size	Wt.	Thds.	Make	Ft.	In.	Ft.	In.	Size	Length	Depth Set	Make
8 5/8	24	8	LW	165							
5 1/2	17	8	LW	3845							

Liner Record: Amount \_\_\_\_\_ Kind \_\_\_\_\_ Top \_\_\_\_\_ Bottom \_\_\_\_\_

## CEMENTING AND MUDDING

Size	Amount Set		Sacks Cement	Chemical		Method of Cementing	Amount	Mudding Method	Results (See Note)
	Ft.	In.		Gal.	Make				
8 5/8	165		100						
5 1/2	3845		100						

Note: What method was used to protect sands if outer strings were pulled?

NOTE: Were bottom hole plugs used? \_\_\_\_\_ If so, state kind, depth set and results obtained \_\_\_\_\_

## TOOLS USED

Rotary Tools were used from \_\_\_\_\_ feet to \_\_\_\_\_ Cable tools were used from \_\_\_\_\_ feet to \_\_\_\_\_ feet, and from \_\_\_\_\_ feet to \_\_\_\_\_ feet, and from \_\_\_\_\_ feet to \_\_\_\_\_

Type Rig \_\_\_\_\_

## INITIAL PRODUCTION TEST

Describe initial test: whether by flow through tubing or casing or by pumping \_\_\_\_\_

Amount of Oil Production \_\_\_\_\_ bbls. Size of choke, if any \_\_\_\_\_ Length of test \_\_\_\_\_ Water

Production \_\_\_\_\_ bbls. Gravity of oil \_\_\_\_\_ Type of Pump if pump is used, describe \_\_\_\_\_

I, the undersigned, being first duly sworn upon oath, state that this well record is true, correct and complete according to the records of this office and to the best of my knowledge and belief.

Vice-President

*John Farmer*  
Name and title of representative of company

Subscribed and sworn to before me this 22nd day of January 1953.My Commission expires April 23, 1956 *Bonnie Derrishill*

Notary Public

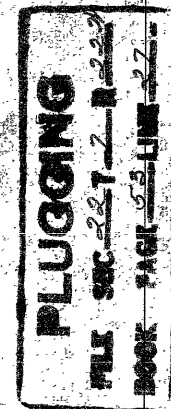

SUBSCRIPTION DIVISION 1-24-53  
 Wichita, Kansas

FARM NAME Weissback WELL NO. 1 COUNTY Graham SEC 22 TWP 75 RGE 22W



STATE OF KANSAS  
STATE CORPORATION COMMISSION  
CONSERVATION DIVISION  
800 BITTING BUILDING  
WICHITA, KANSAS  
October 20, 1952

15-065-03319-00-00

Well No. 1  
Lease Weissbeck  
Description Q1/2 NE NE 22-7-22W  
County Graham  
File No. 53-27

Jones, Shelburne & Farmer, Inc.,  
Russell, Kansas

Gentlemen:

This letter is your authority to plug the above subject well, in accordance with the Rules and Regulations of the State Corporation Commission. When you are ready to plug this well, please contact our District Plugging Supervisor, Mr. Eldon Petty, Box 326, Hays, Kansas.

STATE CORPORATION COMMISSION  
CONSERVATION DIVISION

BY: J. P. Roberts  
J. P. ROBERTS

cc: DISTRICT PLUGGING SUPERVISOR

F