

065-22,464 -00-00

STATE CORPORATION COMMISSION OF KANSAS
OIL & GAS CONSERVATION DIVISION
WELL COMPLETION OR RECOMPLETION FORM
ACO-1 WELL HISTORY
DESCRIPTION OF WELL AND LEASE

API NO. 15-.....

County.....Graham.....
30' W of
NE NW NW Sec. 7 Twp. 7S Rge. 21. X West

Operator: License # 4767
Name Ritchie Exploration, Inc.
Address 125 N. Market, Suite 1000
City/State/Zip Wichita, KS 67202

4950..... Ft North from Southeast Corner of Section
4320..... Ft West from Southeast Corner of Section
(Note: Locate well in section plat below)

Purchaser Koch Oil Company
Wichita, KS

Lease Name Anita Davis Well # 1

Field Name ANITA

Operator Contact Person Jeff Christian
Phone 316/267-4375

Producing Formation Lansing

Contractor: License # 6033
Name Murfin Drilling Co.

Elevation: Ground 2210' KB 2215'

Wellsite Geologist Bob Mathiesen
Phone 316/267-4375

PLEASE KEEP THIS
INFORMATION
CONFIDENTIAL

Designate Type of Completion
X New Well Re-Entry Workover
X Oil SWD Temp Abd
Gas Inj Delayed Comp.
Dry Other (Core, Water Supply etc.)

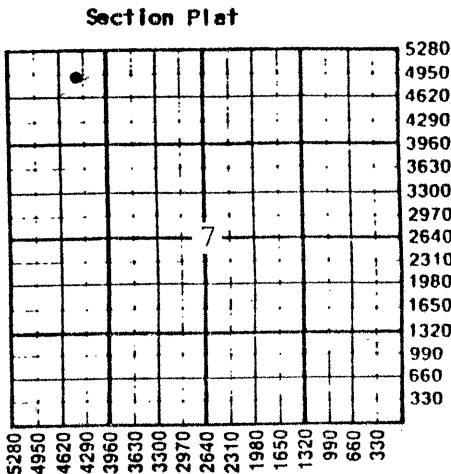

If OWVO: old well info as follows:
Operator
Well Name
Comp. Date

WATER SUPPLY INFORMATION

Disposition of Produced Water: X Disposal
Docket # D-20,496 Repressuring

WELL HISTORY

Drilling Method:
X Mud Rotary Air Rotary Cable
6/6/88 6/13/88 6/29/88
Spud Date Date Reached TD Completion Date
3764' N/A
Total Depth PBTD

Questions on this portion of the ACO-1 call:
Water Resources Board (913) 296-3717

Source of Water: Hauled.
Division of Water Resources Permit #

Groundwater.....Ft North from Southeast Corner
(Well)Ft West from Southeast Corner of
Sec Twp Rge East West

Surface Water.....Ft North from Southeast Corner
(Stream, pond etc).....Ft West from Southeast Corner
Sec Twp Rge East West

Other (explain).....
(purchased from city, R.W.D. #)

Amount of Surface Pipe Set and Cemented at.....feet
Multiple Stage Cementing Collar Used? X Yes No
If yes, show depth set 1824' feet
If alternate 2 completion, cement circulated 435
from 1824' feet depth to Surface 485 SX cmt
Cement Company Name Allied Cementing
Invoice # 51847 51829
11-23-88

INSTRUCTIONS: This form shall be completed in triplicate and filed with the Kansas Corporation Commission, 200 Colorado Derby Building, Wichita, Kansas 67202, within 120 days of the spud date of any well. Rule 82-3-130, 82-3-107 and 82-3-106 apply. Information on side two of this form will be held confidential for a period of 12 months if requested in writing and submitted with the form. See rule 82-3-107 for confidentiality in excess of 12 months. One copy of all wireline logs and drillers time log shall be attached with this form. Submit CP-4 form with all plugged wells. Submit CP-111 form with all temporarily abandoned wells.

All requirements of the statutes, rules and regulations promulgated to regulate the oil and gas industry have been fully complied with and the statements herein are complete and correct to the best of my knowledge.

Signature [Signature]
Title Vice President Date 9/27/88

Subscribed and sworn to before me this 27th day of September 1988
Notary Public Linda K. Rice
Date Commission Expires 6/07/92

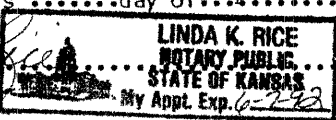

K.C.C. OFFICE USE ONLY
F Letter of Confidentiality Attached
C Wireline Log Received
C Drillers Time Log Received
Distribution
KCC SWD/Rep NGPA
KGS Plug Other (Specify)
9-29-88

Operator Name Ritchie Exploration, Inc. Lease Name Anita Davis Well # 1

Sec. 7 Twp. 7S Rge. 21W County Graham

RELEASED 3-6-90 MAR 06 1990

WELL LOG

INSTRUCTIONS: Show important tops and base of formations penetrated. Detail all cores. Report all drill stem tests giving interval tested, time tool open and closed, flowing and shut-in pressures, fluid level, pressure reached static level, hydrostatic pressures, bottom hole temperature, fluid recovery, and flow rates if gas to surface during test. Attach extra sheet if more space is needed. Attach copy of log.

CONFIDENTIAL

PLEASE KEEP THIS INFORMATION CONFIDENTIAL

PLEASE KEEP THIS INFORMATION CONFIDENTIAL

Drill Stem Tests Taken [X] Yes [] No
Samples Sent to Geological Survey [X] Yes [] No
Cores Taken [] Yes [X] No
DST #1 3353'-3376' (Oread "A"). Rec. 1' of heavy oil (100% oil); 59' slightly oil cut watery mud (3% oil, 90% mud, & 7% water); 120' slightly oil cut muddy water (2% oil 35% mud, 63% water); and 180' water. 360' total fluid. IFP:46-105#/30"; ISIP:1180#/45"; FFP:128-186#/30"; FSIP:1168#/45".

DST #2 3400'-3465' (Toronto & Top zones). Rec. 10' mud, no show of oil. IFP:46-46#/30"; ISIP:1157#/30"; FFP:58-58#/30"; FSIP:1100#/30".

DST #3 3463'-3506' (35' & 50' zones). Rec. 60' slightly oil cut muddy water (15% oil, 33% mud, 64% water); 240' of slightly oil cut muddy water (5% oil, 55% mud, 40% water); 240' slightly oil cut muddy water (3% oil, 30% mud, 67% water); and 480' slightly oil cut muddy water (trace oil, 25% mud, 75% water). 1020' of total fluid. IFP:70-362#/30"; ISIP:1214#/30"; FFP:373-525#/30"; FSIP:1214#/30".

Formation Description table with columns: Name, Top, Bottom. Rows include Anhydrite, B/Anhydrite, Topeka, Toronto, Lansing, B/RC, Cong. sand, Ero. Arbuckle, Arbuckle, LTD.

CASING RECORD, PERFORATION RECORD, TUBING RECORD, Date of First Production, Estimated Production Per 24 Hours

METHOD OF COMPLETION, Disposition of gas, Production Interval

15-065-22464-00-00

SIDE TWO (Page Two)

ACO-1 WELL HISTORY

OPERATOR Ritchie Exploration, Inc. LEASE NAME #1 Anita Davis

SEC. 7 TWP. 7S RGE. 21W (E) (W)

FILL IN WELL LOG AS REQUIRED:

SHOW GEOLOGICAL MARKERS, LOGS RUN, OR OTHER DESCRIPTIVE INFORMATION.

Show all important zones of porosity and contents thereof; cored intervals, and all drill-stem tests, including depth interval tested, cushion used, time tool open, flowing and shut-in pressures, and recoveries.

FORMATION DESCRIPTION, CONTENTS, ETC.	TOP	BOTTOM	NAME	DEPTH	
DST #4 3503'-3527' (70'-90' zones). Misrun. Packer failure.			<p>RELEASED MAR 06 1990 FROM CONFIDENTIAL 3-6-90</p>		
DST #5 3499'-3527' (70'-90' zones). 630' gas in pipe. Rec. 660' of clean gassy oil (33% gravity); 240' watery mud cut oil (6% gas, 59% oil, 21% mud, 14% water); and 60' of slightly oil cut muddy water (2% oil, 65% mud, 33% water). 960' total fluid. IFF:58-245#/30"; ISIP:1203#/30"; FFP:280-350#/30"; FSIP:1191#/30".					
DST #6 3552'-3612' (140'-180' zones). 420' gas in pipe. Rec. 400' of gassy muddy oil (13% gas, 53% oil, 34% mud). IFF:58-116#/30"; ISIP:1271#/45"; FFP:151-186#/30"; FSIP:1260#/45".					
DST #7 3609'-3646' (200'-220' zones). Rec. 15' of mud w/a few oil spots on top. IFF:35-35#/30"; ISIP:905#/30"; FFP:46-46#/30"; FSIP:801#/30".					
DST #8 3660'-3710' (Cong. sand). Rec. 5' of mud. IFF:35-35#/30"; ISIP:70#/30"; FFP:46-46#/30"; FSIP:58#/30".					
DST #9 3706'-3740' (Arbuckle). Rec. 10' of mud with show of heavy oil in tool. IFF:35-35#/30"; ISIP:605#/30"; FFP:46-46#/30"; FSIP:350#/30".					
<p>PLEASE KEEP THIS INFORMATION CONFIDENTIAL</p>					
<p>OCT 03 1988 KANSAS GEOLOGICAL SURVEY WICHITA BRANCH</p>					
				<p>RECEIVED STATE GEOLOGICAL COMMISSION OCT 29 1988 CORRELATION DIVISION Wichita Kansas</p>	

TELEPHONE:

AREA CODE 913 483-2627

ALLIED CEMENTING COMPANY, INC.

P. O. BOX 31

RUSSELL, KANSAS 67665

15-065-22464-00-00

TO: Ritchie Exploration Inc.
125 N. Market Suite 1000
Wichita, Kansas 67202

INVOICE NO. 51829
PURCHASE ORDER NO. _____
LEASE NAME Anita Davis #1
DATE June 14, 1988

SERVICE AND MATERIALS AS FOLLOWS:

218-445
Common 128 sks @\$5.00 \$ 1,090.00
Pozmix 217 sks @\$2.10 455.70
Gel 26 sks @\$6.75 175.50

Handling 435 sks @\$0.75 326.25
Mileage (35) @\$0.03¢ per sk per mi 456.25
Two stage top 150.00

\$ 1,721.20

Total

933.00
120-3251-03
\$ 2,654.20
802 < 530.84
2123.36

THANK YOU

JUN 17 1988

All Prices Are Net, Payable 20th of Month Following Date of Invoice. ¼ of 1% Charged Thereafter

TELEPHONE:

AREA CODE 913 483-2627

ALLIED CEMENTING COMPANY, INC.

P. O. BOX 31

RUSSELL, KANSAS 67665

15-005-22464-00-00

TO: Ritchie Exploration Inc.
125 N. Market Suite 1000
Wichita, Kansas 67202
51777

INVOICE NO. 51830

PURCHASE ORDER NO. _____

LEASE NAME Anita Davis #1

DATE June 14, 1988

SERVICE AND MATERIALS AS FOLLOWS:

Common 75 sks @\$5.00
 Pozmix 50 sks @\$2.10
 Salt 19 sks @\$4.75

\$ 375.00
 105.00
90.25

\$ 570.25

Handling 125 sks @\$0.75
 Mileage (35) @\$0.03c per sk per mi
 Two stage bottom
 Mi @\$1.00 pmp. trk.

93.75
 131.25
 838.00
35.00

1,098.00

14 1/2" g. shoe 104.00
 1 AFU 161.00
 1 basket 108.00
 6 cent. 246.00
 1 2-stage collar 2,267.00

Total

2,886.00
 120-3251-03
 \$ 4,554.25
 802 < 910.85
3643.40

Float held

THANK YOU

JUN 17 1988

All Prices Are Net, Payable 20th of Month Following Date of Invoice. 3/4 of 1% Charged Thereafter