

FOR KCC USE:

EFFECTIVE DATE: 4-25-94

DISTRICT # 2

SEAT Yes No

State of Kansas

NOTICE OF INTENTION TO DRILL

Must be approved by the K.C.C. five (5) days prior to commencing well

FORM C-1 7/91

FORM MUST BE TYPED

FORM MUST BE SIGNED

ALL BLANKS MUST BE FILLED

Expected Spud Date UNKNOWN month day year

Spot NW SW Sec 22 Twp 34 S. Rg 3 East West

OPERATOR: License # 9663
Name: PIONEER EXPLORATION CO.
Address: P. O. BOX 691007
City/State/Zip: HOUSTON, TEXAS 77269
Contact Person: DEAN JONES
Phone: 713-893-9400

990 feet from South / XXXX line of Section
4950 feet from East / XXXX line of Section
IS SECTION X REGULAR IRREGULAR?

CONTRACTOR: License #: UNKNOWN
Name:

(NOTE: Locate well on the Section Plat on Reverse Side)
County: SUMNER
Lease Name: SUBERA Well #: 3
Field Name: SUBERA

Well Drilled For: Well Class: Type Equipment:
X Oil ... Enh Rec X Infield X Mud Rotary
X Gas ... Storage ... Pool Ext. ... Air Rotary
X OWWO ... Disposal ... Wildcat ... Cable
... Seismic: ... # of Holes ... Other

Is this a Prorated/Spaced Field? yes X no
Target Formation(s): MISSISSIPPI
Nearest lease or unit boundary: 330'
Ground Surface Elevation: 1186 feet MSL

If OWWO: old well information as follows:
Operator: HERNDON DRILLING CO.
Well Name: SUBERA #3
Comp. Date: 6/57 Old Total Depth 4732'

Water well within one-quarter mile: 50 X yes X no
Public water supply well within one mile: 50 yes no
Depth to bottom of fresh water: 50
Depth to bottom of usable water: 230

Directional, Deviated or Horizontal wellbore? X yes no
If yes, true vertical depth:
Bottom Hole Location:

Surface Pipe by Alternate: 1 2
Length of Surface Pipe Planned to be set: 652' (set)
Length of Conductor pipe required: 0
Projected Total Depth: 4800'
Formation at Total Depth: ARBUCKLE

Water Source for Drilling Operations: X well farm pond other
DWR Permit #:
Will Cores Be Taken? yes X no
If yes, proposed zone:

AFFIDAVIT

The undersigned hereby affirms that the drilling, completion and eventual plugging of this well will comply with K.S.A. 55-101, et. seq.
It is agreed that the following minimum requirements will be met:

RECEIVED
STATE CORPORATION COMMISSION
APR 25 1994
CONSERVATION DIVISION
Wichita, Kansas

- 1. Notify the appropriate district office prior to spudding of well;
2. A copy of the approved notice of intent to drill shall be posted on each drilling rig;
3. The minimum amount of surface pipe as specified below shall be set by circulating cement to the top; in all cases surface pipe shall be set through all unconsolidated materials plus a minimum of 20 feet into the underlying formation;
4. If the well is dry hole, an agreement between the operator and the district office on plug length and placement is necessary prior to plugging;
5. The appropriate district office will be notified before well is either plugged or production casing is cemented in;
6. IF AN ALTERNATE IS COMPLETED, PRODUCTION PIPE SHALL BE CEMENTED FROM BELOW ANY USABLE WATER TO SURFACE WITHIN 120 DAYS OF SPUD DATE. IN ALL CASES, NOTIFY DISTRICT OFFICE PRIOR TO ANY CEMENTING.

I hereby certify that the statements made herein are true and to the best of my knowledge and belief.
Date: 4/20/1994 Signature of Operator or Agent: Title: GEOLOGIST

FOR KCC USE:
API # 15- 191-01,021-00-00
Conductor pipe required NONE feet
Minimum surface pipe required 652' feet per Alt. X
Approved by: CB 4-25-94
This authorization expires: 10-25-94
(This authorization void if drilling not started within 6 months of effective date.)
Spud date: Agent:

REMEMBER TO:

- File Drill Pit Application (form CDP-1) with Intent to Drill;
- File Completion Form ACO-1 within 120 days of spud date;
- File acreage attribution plat according to field prorations orders;
- Notify appropriate district office 48 hours prior to workover or re-entry;
- Submit plugging report (CP-4) after plugging is completed;
- Obtain written approval before disposing or injecting salt water.

Mail to: Conservation Division, 200 Colorado Derby Building, 202 W. First St., Wichita, Kansas 67202-1234.

22
34
3

IN ALL CASES PLOT THE INTENDED WELL ON THE PLAT BELOW

PLAT OF ACREAGE ATTRIBUTABLE TO A WELL IN A PRORATED OR SPACED FIELD

If the intended well is in a prorated or spaced field, please fully complete this side of the form. If the intended well is in a prorated or spaced field complete the plat below showing that the well will be properly located in relationship to other wells producing from the common source of supply. Please show all the wells within 1 mile of the boundaries of the proposed acreage attribution unit for gas wells and within 1/2 mile of the boundaries of the proposed acreage attribution unit for oil wells.

API NO. 15- _____
 OPERATOR PIONEER EXPLORATION COMPANY LOCATION OF WELL: COUNTY SUMNER
 LEASE SUBERA 990' feet from south/~~XXXX~~ line of section
 WELL NUMBER #3 330' feet from ~~east~~/west line of section
 FIELD SUBERA SECTION 22 TWP 35S RG 3 W

NUMBER OF ACRES ATTRIBUTABLE TO WELL 10 IS SECTION X REGULAR or _____ IRREGULAR
 QTR/QTR/QTR OF ACREAGE NW - SW - SW IF SECTION IS IRREGULAR, LOCATE WELL FROM NEAREST
CORNER BOUNDARY.

Section corner used: _____ NE _____ NW _____ SE _____ SW

PLAT

(Show location of the well and shade attributable acreage for prorated or spaced wells.)
 (Show footage to the nearest lease or unit boundary line.)

R 3W

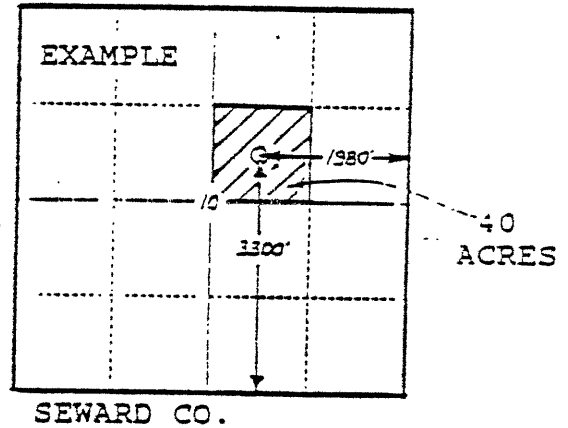
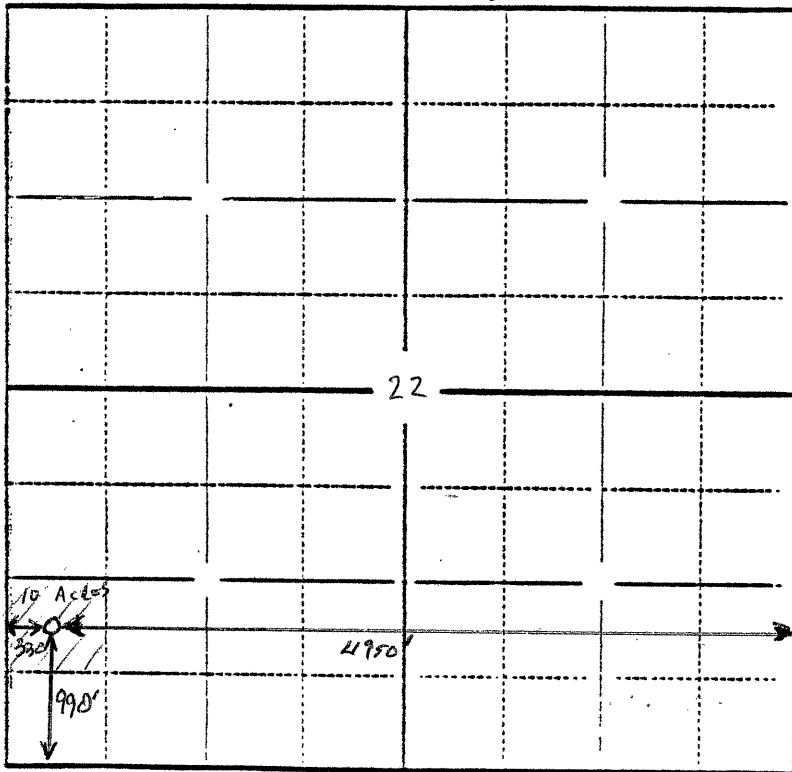

SUMNER CO., KANSAS

In plotting the proposed location of the well, you must show:

- 1) The manner in which you are using the depicted plat by identifying section lines, i.e. 1 section, 1 section with 8 surrounding sections, 4 sections, etc.;
- 2) the distance of the proposed drilling location from the section's south/north and east/west lines; and
- 3) the distance to the nearest lease or unit boundary line.