

CARD MUST BE TYPED

State of Kansas

CARD MUST BE SIGNED /o

### NOTICE OF INTENTION TO DRILL

(see rules on reverse side)

Starting Date ... 10 ..... 19 ..... 87 .....  
month day year

OPERATOR: License # ..... 4748 .....  
Name ... A. & A. Discovery, Inc. ....  
Address ... P.O. Box 156 .....  
City/State/Zip ... Hill City, KS ..... 67642 .....  
Contact Person ... Darrel Anderson .....  
Phone ... (913) 674-2768 .....

CONTRACTOR: License # ..... 4083 .....  
Name ... Western KS Drilling .....  
City/State ... Hays, KS ..... 67601 .....

Well Drilled For:	Well Class:	Type Equipment:
<input checked="" type="checkbox"/> Oil	<input type="checkbox"/> SWD	<input type="checkbox"/> Infield
<input type="checkbox"/> Gas	<input type="checkbox"/> Inj	<input checked="" type="checkbox"/> Mud Rotary
<input type="checkbox"/> OWWO	<input type="checkbox"/> Expl	<input type="checkbox"/> Pool Ext.
	<input checked="" type="checkbox"/> Wildcat	<input type="checkbox"/> Air Rotary
		<input type="checkbox"/> Cable

If OWWO: old well info as follows:

Operator .....  
Well Name .....  
Comp Date ..... Old Total Depth .....

I certify that well will comply with K.S.A. 55-101, et seq., plus eventually plugging hole to KCC specifications.

Date ... 10/13/87 ..... Signature of Operator or Agent Darrel Anderson Title ... President .....

For KCC Use:

Conductor Pipe Required ..... feet; Minimum Surface Pipe Required ..... feet per Alt. X (2)  
This Authorization Expires 4-14-88 Approved By R.H. 10-14-87 200

EFFECTIVE DATE: 10-19-87

API Number 15— 065-22,416 0000 — East  
30 ft. south of  
E2. SE. SE. Sec. 29. Twp. 7. S, Rg. 22.  West  
..... 630 ..... Ft. from South Line of Section  
..... 330 ..... Ft. from East Line of Section

(Note: Locate well on Section Plat on reverse side)

Nearest lease or unit boundary line ... 330 ..... feet  
County ... Graham .....  
Lease Name ... Davis ..... Well # ... 2 .....  
Ground surface elevation ... 2264 ..... feet MSL  
Domestic well within 330 feet:  yes  no  
Municipal well within one mile:  yes  no  
Depth to bottom of fresh water ... 200' .....  
Depth to bottom of usable water ... 1100' .....  
Surface pipe by Alternate:  1  2  
Surface pipe planned to be set ... 200' .....  
Conductor pipe required .....  
Projected Total Depth ... 3900' ..... feet  
Formation ... Arbuckle .....

Must be filed with the K.C.C. five (5) days prior to commencing well  
 This card void if drilling not started within six (6) months of date received by K.C.C.

**Important procedures to follow:**

1. Notify District office before setting surface casing.
2. Set surface casing by circulating cement to the top.
3. File completion forms ACO-1 with K.C.C. within 90 days of well completion, following instructions on ACO-1, side 1, and including copies of wireline logs.
4. Notify District office 48 hours prior to old well workover or re-entry.
5. Prior to filing Intent, prepare a proposed plugging plan in case well is D & A, then obtain approval of plan when calling district office prior to setting surface pipe.
6. Submit plugging report (CP-4) to K.C.C. after plugging is completed.
7. Obtain an approved injection docket number before disposing of salt water.
8. Notify K.C.C. within 10 days when injection commences or terminates.
9. If an alternate 2 completion, cement in the production pipe from below any usable water to surface within 120 days of spud date.

**A Regular Section of Land  
 1 Mile = 5,280 Ft.**

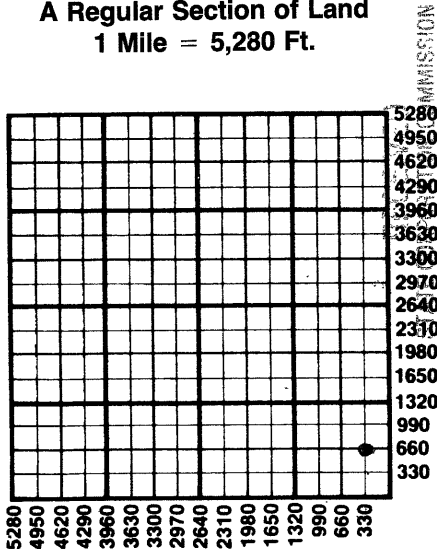

OCT 14 1987

10-14-87

CONSERVATION DIVISION

Wichita, Kansas

State Corporation Commission of Kansas  
 Conservation Division  
 200 Colorado Derby Building  
 Wichita, Kansas 67202  
 (316) 263-3238