

For KCC Use:

Effective Date: 4

District # 4

SGA? ☐ Yes ☒ No

KANSAS CORPORATION COMMISSION
OIL & GAS CONSERVATION DIVISION

NOTICE OF INTENT TO DRILL

Must be approved by KCC five (5) days prior to commencing well

OWWO

Form C-1

September 1999

Form must be Typed

Form must be Signed

All blanks must be Filled

Expected Spud Date 1 20 06
month day year

OPERATOR: License# 30420

Name: VJI Natural Resources Inc.

Address: 30-38 48th St.

City/State/Zip: Astoria, New York 11103

Contact Person: Jason Dinges

Phone: 785-625-8360

CONTRACTOR: License# 33436

Name: Forrest Energy LLC.

Well Drilled For:	Well Class:	Type Equipment:
<input checked="" type="checkbox"/> Oil	<input type="checkbox"/> Enh Rec	<input checked="" type="checkbox"/> Infield
<input type="checkbox"/> Gas	<input type="checkbox"/> Storage	<input type="checkbox"/> Pool Ext.
<input checked="" type="checkbox"/> OWO	<input type="checkbox"/> Disposal	<input type="checkbox"/> Wildcat
<input type="checkbox"/> Seismic; # of Holes	<input type="checkbox"/> Other	<input type="checkbox"/> Cable
<input type="checkbox"/> Other		

If OWO: old well information as follows:

Operator: John Jay Darrah, Jr.

Well Name: Deines #1

Original Completion Date: 12-23-85 Original Total Depth: 4450

Directional, Deviated or Horizontal wellbore? ☐ Yes ☒ No

If Yes, true vertical depth: _____

Bottom Hole Location: _____

KCC DKT #: _____

Spot 100'E, C S/2-SW Sec. 17 Twp. 15 S. R. 25 ☐ East ☒ West

660 feet from S / N (circle one) Line of Section

1420 feet from E / W (circle one) Line of Section

Is SECTION ☒ Regular ☐ Irregular?

(Note: Locate well on the Section Plat on reverse side)

County: Trego

Lease Name: Deines Well #: 1 OWO

Field Name: Splitter

Is this a Prorated / Spaced Field? ☐ Yes ☒ No

Target Formation(s): Mississippi

Nearest Lease or unit boundary: 660

Ground Surface Elevation: 2427 feet MSL

Water well within one-quarter mile: ☐ Yes ☒ No

Public water supply well within one mile: ☐ Yes ☒ No

Depth to bottom of fresh water: 150'

Depth to bottom of usable water: 1000

Surface Pipe by Alternate: 1 ☒ 2

Length of Surface Pipe Planned to be set: 247' Set already

Length of Conductor Pipe required: none

Projected Total Depth: 4450

Formation at Total Depth: Mississippi

Water Source for Drilling Operations:

Well ☐ Farm Pond ☒ Other ☐

DWR Permit #: _____

(Note: Apply for Permit with DWR ☐)

Will Cores be taken? ☐ Yes ☒ No

If Yes, proposed zone: _____

AFFIDAVIT

The undersigned hereby affirms that the drilling, completion and eventual plugging of this well will comply with K.S.A. 55-101, et. seq.

It is agreed that the following minimum requirements will be met:

1. Notify the appropriate district office **prior** to spudding of well;
2. A copy of the approved notice of intent to drill **shall be posted** on each drilling rig;
3. The minimum amount of surface pipe as specified below **shall be set** by circulating cement to the top; in all cases surface pipe shall be set through all unconsolidated materials plus a minimum of 20 feet into the underlying formation.
4. If the well is dry hole, an agreement between the operator and the district office on plug length and placement is necessary **prior to plugging**;
5. The appropriate district office will be notified before well is **either plugged or production casing is cemented in**;
6. If an ALTERNATE II COMPLETION, production pipe shall be cemented from below any usable water to surface within 120 days of spud date. **In all cases, NOTIFY district office prior to any cementing.**

I hereby certify that the statements made herein are true and to the best of my knowledge and belief.

Date: 1-8-06 Signature of Operator or Agent: Jason Dinges Title: Agent

For KCC Use ONLY

API # 15 - 195-21831-00-01

Conductor pipe required NONE feet

Minimum surface pipe required 247' feet per Alt. 2

Approved by 2591-11-06

This authorization expires: 7-11-06

(This authorization void if drilling not started within 6 months of effective date.)

Spud date: _____ Agent: _____

Remember to:

- File Drill Pit Application (form CDP-1) with Intent to Drill;
- File Completion Form ACO-1 within 120 days of spud date;
- File acreage attribution plat according to field proration orders;
- Notify appropriate district office 48 hours prior to workover or re-entry;
- Submit plugging report (CP-4) after plugging is completed;
- Obtain written approval before disposing or injecting salt water.

RECEIVED
JAN 11 2006
KCC WICHITA

17
15
25W

IN ALL CASES PLOT THE INTENDED WELL ON THE PLAT BELOW

Plat of acreage attributable to a well in a prorated or spaced field

If the intended well is in a prorated or spaced field, please fully complete this side of the form. If the intended well is in a prorated or spaced field complete the plat below showing that the well will be properly located in relationship to other wells producing from the common source of supply. Please show all the wells and within 1 mile of the boundaries of the proposed acreage attribution unit for gas wells and within 1/2 mile of the boundaries of the proposed acreage attribution unit for oil wells.

API No. 15-195-21,831

Operator: VJI Natural Resources Inc.

Lease: Deines

Well Number: # 1 QWWO

Field: Splitter

Number of Acres attributable to well: _____

QTR / QTR / QTR of acreage: _____

Location of Well: County: Trego

_____ 660 feet from S / N (circle one) Line of Section

_____ 1420 feet from E / W (circle one) Line of Section

Sec. 17 Twp. 15 S. R. 25 ☐ East ☒ WestIs Section ☒ Regular or _____ Irregular

If Section is Irregular, locate well from nearest corner boundary.

Section corner used: _____ NE _____ NW _____ SE _____ SW

PLAT

(Show location of the well and shade attributable acreage for prorated or spaced wells.)

(Show footage to the nearest lease or unit boundary line.)

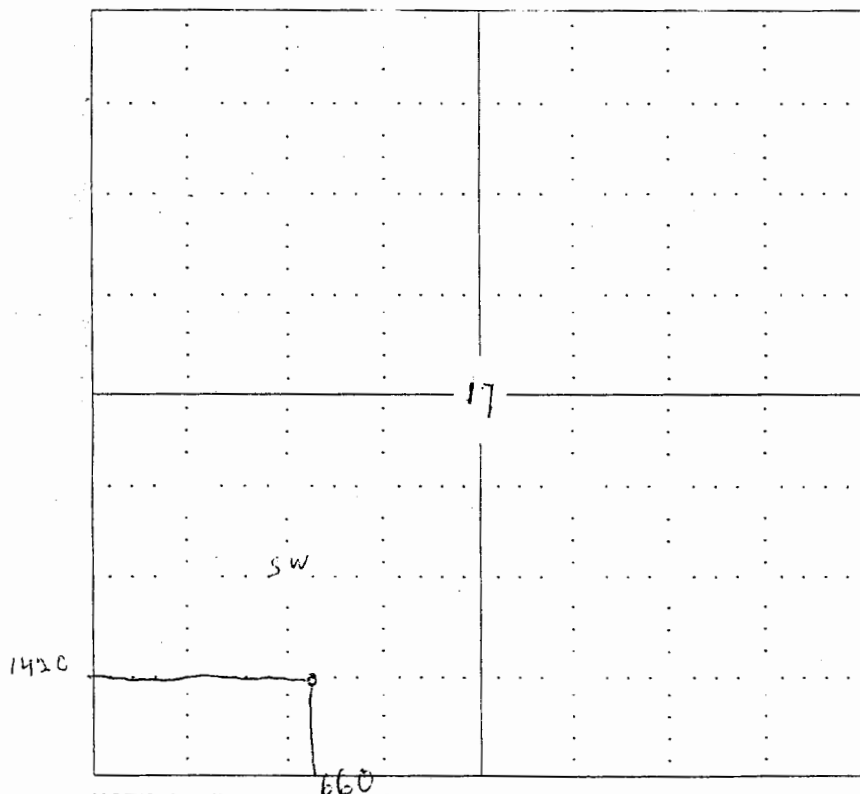

NOTE: In all cases locate the spot of the proposed drilling location.

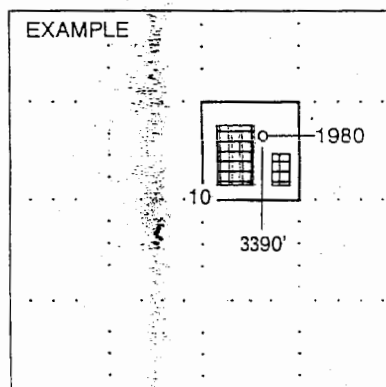

In plotting the proposed location of the well, you must show:

1. The manner in which you are using the depicted plat by identifying section lines, i.e. 1 section, 1 section with 8 surrounding sections, 4 sections, etc.
2. The distance of the proposed drilling location from the section's south / north and east / west.
3. The distance to the nearest lease or unit boundary line.
4. If proposed location is located within a prorated or spaced field a certificate of acreage attribution plat must be attached: (CO-7 for oil wells; CG-8 for gas wells).