

For KCC Use: 1-23-06
Effective Date: _____
District # 1
SGA? Yes No

**KANSAS CORPORATION COMMISSION
OIL & GAS CONSERVATION DIVISION
NOTICE OF INTENT TO DRILL**

RECEIVED

JAN 17 2006

Form C-1

December 2002

Form must be Typed

Form must be signed

All blanks must be Filled

Must be approved by KCC five (5) days prior to commencing well

Expected Spud Date 02/16/06
month day year

Spot: APPROX
N 12 SE - SW Sec. 25 Twp. 30S R. 32 East West

OPERATOR: License # 5447

950 feet from N / S Line of Section

Name: OXY USA Inc.

2063 feet from E / W Line of Section

Address: P.O. Box 2528

Is SECTION X Regular _____ Irregular?

City/State/Zip: Liberal, KS 67905

(Note: Locate well on the Section Plat on reverse side)

Contact Person: Vicki Carder

County: Haskell

Phone: (620) 629-4242

Lease Name: Halley A Well #: 3

CONTRACTOR: License # _____

Field Name: _____

Name: _____

Is this a Prorated / Spaced Field? Yes No

ADVISE ON ACO-1, MUST BE LICENSED WITH KCC

Well Drilled For: Well Class: Type Equipment:

Target Formation(s): St. Louis

Oil Enh Rec Infield Mud Rotary

Nearest Lease or unit Boundary: 950

Gas Storage Pool Ext Air Rotary

Ground Surface Elevation: 2842 feet/MSL

OWWO Disposal Wildcat Cable

Water well within one-quarter mile Yes No

Seismic: # of Holes Other

Public water supply well within one mile: Yes No

Other

Depth to bottom of fresh water: 600

Depth to bottom of usable water: 640

If OWWO: old well information as follows:

Surface Pipe by Alternate: 1 2

Operator: _____

Length of Surface Pipe Planned to be set: 1750

Well Name: _____

Length of Conductor Pipe Required: NONE

Original Completion Date: _____ Original Total Depth: _____

Projected Total Depth: 5775

Formation at Total Depth: St. Louis

Directional, Deviated or Horizontal wellbore? Yes No

Water Source for Drilling Operations:

IF Yes, true vertical depth _____

Well Farm Pond Other _____

Bottom Hole Location _____

DWR Permit # _____

KCC DKT #: _____

Will Cores be Taken? Yes No

If Yes, Proposed zone: _____

AFFIDAVIT

The undersigned hereby affirms that the drilling, completion and eventual plugging of this well will comply with K.S.A. 55-101, et. Seq. It is agreed that the following minimum requirements will be met:

1. Notify the appropriate district office **prior** to spudding of well;
2. A copy of the approved notice of intent to drill **shall be** posted on each drilling rig;
3. The minimum amount of surface pipe as specified below **shall be set** by circulating cement to the top; in all cases surface pipe **shall be set** through all unconsolidated materials plus a minimum of 20 feet into the underlying formation.
4. If the well is dry hole, an agreement between the operator and the district office on plug length and placement is necessary **prior to plugging**;
5. The appropriate district office will be notified before well is either plugged or production casing is cemented in;
6. If an ALTERNATE II COMPLETION, production pipe shall be cemented from below any usable water to surface within **120 days** of spud date. Or pursuant to Appendix "B" - Eastern Kansas surface casing order #133,891-C, which applies to the KCC District 3 area, alternate II cementing must be completed within 30 days of the spud date or the well shall be plugged. **In all cases, NOTIFY district office** prior to any cementing.

I hereby certify that the statements made herein are true and to the best of my knowledge and belief.

Date: 01/12/06 Signature of Operator or Agent: Vicki Carder Title: Capital Project

For KCC Use ONLY

API # 15 - 081-21639-0000

Conductor pipe required NONE feet

Minimum Surface pipe required 660 feet per Alt. 1

Approved by: RSP 1-18-06

This authorization expires: 7-18-06

(This authorization void if drilling not started within 6 months of effective date.)

Spud date: _____ Agent: _____

Remember to:

- File Drill Pit Application (form CDP-1) with Intent to Drill;
- File Completion Form ACO-1 within 120 days of spud date;
- File acreage attribution plat according to field proaction orders;
- Notify appropriate district office 48 hours prior to workover or re-entry;
- Submit plugging report (CP-4) after plugging is completed;
- Obtain written approval before disposing or injecting salt water.
- If this permit has expired (see: authorized expiration date) please check the box below and return to the address below.

Well Not Drilled - Permit Expired

Signature of Operator or Agent: _____

Date: _____

Mail to: KCC - Conservation Division, 130 S. Market - Room 2078, Wichita, Kansas 67202

25
30
32 W

IN ALL CASES PLOT THE INTENDED WELL ON THE PLAT BELOW

Plat of acreage attributable to a well in a prorated or spaced field

If the intended well is in a prorated or spaced field, please fully complete this side of the form. If the intended well is in a prorated or spaced field complete the plat below showing that the well will be properly located in relationship to other wells producing from the common source of supply. Please show all the wells and within 1 mile of the boundaries of the proposed acreage attribution unit for gas wells and within 1/2 mile of the boundaries of the proposed acreage attribution unit for oil wells.

API No. 15 - _____
 Operator: _____
 Lease: _____
 Well Number: _____
 Field: _____

Number of Acres attributable to well: _____
 QTR / QTR / QTR of acreage: _____ - _____ - _____

Location of Well: County _____
 _____ feet from N / S Line of Section
 _____ feet from E / W Line of Section
 Sec. _____ Twp. _____ R. _____ East West

Is Section Regular or Irregular

IF Section is Irregular, locate well from nearest corner boundary.

Section corner used: NE NW SE SW

PLAT

*(Show location of the well and shade attributable acreage for prorated or spaced wells.)
 (Show footage to the nearest lease or unit boundary line.)*

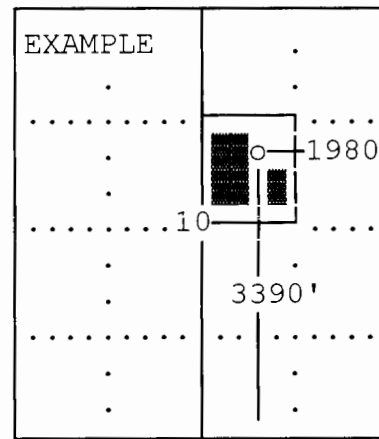
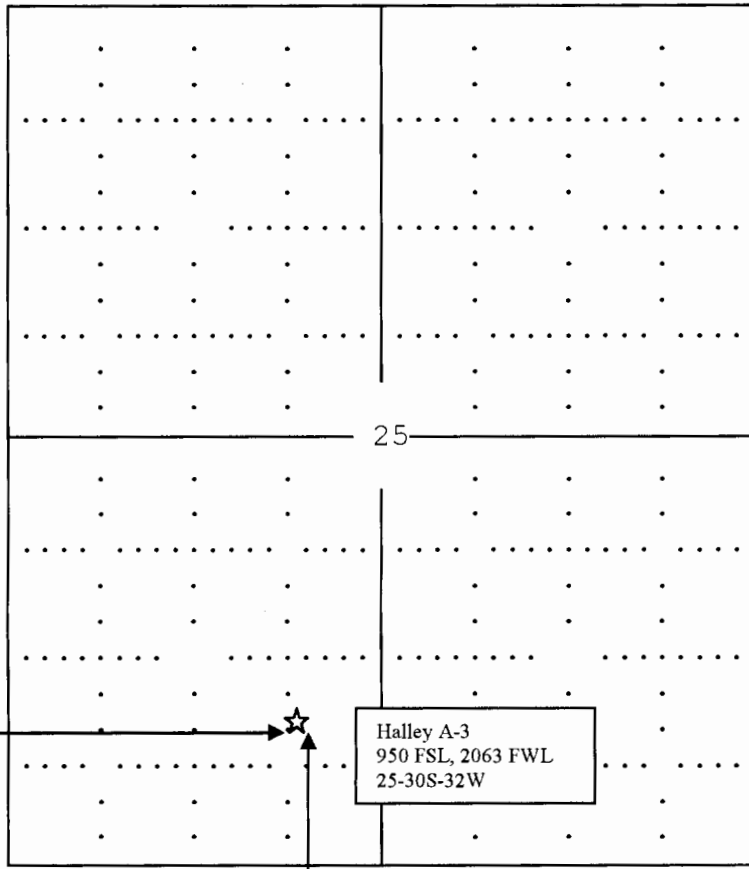

SEWARD CO.

Note: In all cases locate the spot of the proposed drilling location.

Haskell County

In plotting the proposed location of the well, you must show:

1. The manner in which you are using the depicted plat by identifying section lines, i.e. 1 section, 1 section with 8 surrounding sections, 4 sections, etc.
2. The distance of the proposed drilling location from the sections south / north and east / west.
3. The distance to the nearest lease or unit boundary line.
4. If proposed location is located within a prorated or spaced field a certificate of acreage attribution plat must be attached: (CO-7 for oil wells; CG-8 for gas wells).