

FOR KCC USE:

FORM C-1 7/91

EFFECTIVE DATE: 8-26-92

FORM MUST BE TYPED

DISTRICT # 4

State of Kansas

FORM MUST BE SIGNED

SSA? Yes No

NOTICE OF INTENTION TO DRILL

ALL BLANKS MUST BE FILLED

Must be approved by the K.C.C. five (5) days prior to commencing well

Expected Spud Date 09 07 92
month day year

Spot SE SE SE Sec 3 Twp 7 S. Rg 23 East West

OPERATOR: License # 5058
Name: Griggs Oil, Inc.
Address: 107 N. Market, Suite 800
City/State/Zip: Wichita, KS 67202
Contact Person: Jim Collins
Phone: 316-267-7779

330' feet from South / North Line of Section
330' feet from East / West Line of Section
IS SECTION X REGULAR IRREGULAR?

CONTRACTOR: License #: 5422
Name: Abercrombie RTD

(NOTE: Locate well on the Section Plat on Reverse Side)
County: Graham
Lease Name: Fountain Well #: B-1
Field Name: Mt. Etna NW A.C.
Is this a Prorated/Spaced Field? yes X no

Well Drilled For: Well Class: Type Equipment:
X Oil Enh Rec Infield X Mud Rotary
Gas Storage Pool Ext. Air Rotary
OWWO Disposal Wildcat Cable
Seismic: # of Holes Other

Target Formation(s): LKC
Nearest lease or unit boundary: 330
Ground Surface Elevation: 2400 feet MSL
Water well within one-quarter mile: yes X no
Public water supply well within one mile: yes X no
Depth to bottom of fresh water: 150
Depth to bottom of usable water: 1250
Surface Pipe by Alternate: 1 X 2
Length of Surface Pipe Planned to be set: 200'
Length of Conductor pipe required: -0-
Projected Total Depth: 3950
Formation at Total Depth: BKC
Water Source for Drilling Operations: well X farm pond other

If OWWO: old well information as follows:
Operator: N/A
Well Name:
Comp. Date: Old Total Depth

DWR Permit #:
Will Cores Be Taken?: yes X no
If yes, proposed zone:

Directional, Deviated or Horizontal wellbore? yes X no
If yes, true vertical depth:
Bottom Hole Location:

AFFIDAVIT

The undersigned hereby affirms that the drilling, completion and eventual plugging of this well will comply with K.S.A. 55-101, et. seq.

It is agreed that the following minimum requirements will be met:

- 1. Notify the appropriate district office prior to spudding of well;
2. A copy of the approved notice of intent to drill shall be posted on each drilling rig;
3. The minimum amount of surface pipe as specified below shall be set by circulating cement to the top; in all cases surface pipe shall be set through all unconsolidated materials plus a minimum of 20 feet into the underlying formation;
4. If the well is dry hole, an agreement between the operator and the district office on plug length and placement is necessary prior to plugging;
5. The appropriate district office will be notified before well is either plugged or production casing is cemented in;
6. IF AN ALTERNATE II COMPLETION, PRODUCTION PIPE SHALL BE CEMENTED FROM BELOW ANY USABLE WATER TO SURFACE WITHIN 120 DAYS OF SPUD DATE. IN ALL CASES, NOTIFY DISTRICT OFFICE PRIOR TO ANY CEMENTING.

I hereby certify that the statements made herein are true and to the best of my knowledge and belief.

Date: 8-20-92 Signature of Operator or Agent: James S. Collins Title: Vice-President

FOR KCC USE:
API # 15- 065-22690-00-00
Conductor pipe required None feet
Minimum surface pipe required 200' feet per Alt. X(2)
Approved by: CB 8-21-92
This authorization expires: 2-21-93
(This authorization void if drilling not started within 6 months of effective date.)
Spud date: Agent:

REMEMBER TO:

- File Drill Pit Application (form CDP-1) with Intent to Drill;
- File Completion Form ACO-1 within 120 days of spud date;
- File acreage attribution plat according to field proration orders;
- Notify appropriate district office 48 hours prior to workover or re-enters;
- Submit plugging report (CP-4) after plugging is completed;
- Obtain written approval before disposing or injecting salt water.

Mail to: Conservation Division, 200 Colorado Derby Building, 202 W. First St., Wichita, Kansas 67202-1286.

RECEIVED
STATE CORPORATION COMMISSION
8-21-92
AUG 21 1992
CONSERVATION DIVISION
Wichita, Kansas

IN ALL CASES PLOT THE INTENDED WELL ON THE PLAT BELOW

PLAT OF ACREAGE ATTRIBUTABLE TO A WELL IN A PRORATED OR SPACED FIELD

If the intended well is in a prorated or spaced field, please fully complete this side of the form. If the intended well is in a prorated or spaced field complete the plat below showing that the well will be properly located in relationship to other wells producing from the common source of supply. Please show all the wells within 1 mile of the boundaries of the proposed acreage attribution unit for gas wells and within 1/2 mile of the boundaries of the proposed acreage attribution unit for oil wells.

API NO. 15- _____
 OPERATOR Griggs Oil, Inc.
 LEASE Fountain
 WELL NUMBER B-1
 FIELD Mt. Etna NW

LOCATION OF WELL: COUNTY Graham
330 feet from south/north line of section
330 feet from east/west line of section
 SECTION 3 TWP 7-S RG 23 W

NUMBER OF ACRES ATTRIBUTABLE TO WELL 20
 QTR/QTR/QTR OF ACREAGE SE - SE - SE

IS SECTION X REGULAR or _____ IRREGULAR
IF SECTION IS IRREGULAR, LOCATE WELL FROM NEAREST CORNER BOUNDARY.

Section corner used: _____ NE _____ NW X SE _____ SW

PLAT

(Show location of the well and shade attributable acreage for prorated or spaced wells.)
 (Show footage to the nearest lease or unit boundary line.)

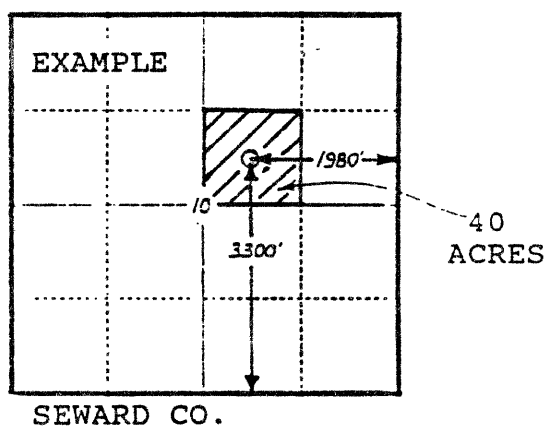
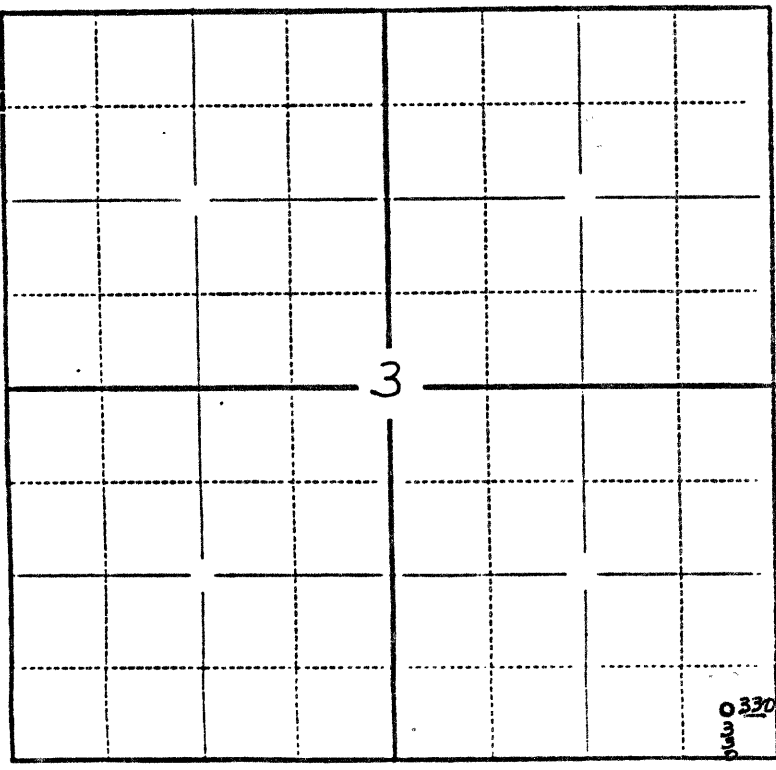

In plotting the proposed location of the well, you must show:

- 1) The manner in which you are using the depicted plat by identifying section lines, i.e. 1 section, 1 section with 8 surrounding sections, 4 sections, etc.;
- 2) the distance of the proposed drilling location from the section's south/north and east/west lines; and
- 3) the distance to the nearest lease or unit boundary line.