

EFFECTIVE DATE: 9-4-91

FORM MUST BE TYPED
FORM C-1 4/90

State of Kansas
NOTICE OF INTENTION TO DRILL

FORM MUST BE SIGNED
ALL BLANKS MUST BE FILLED

Must be approved by the K.C.C. five (5) days prior to commencing well

Expected Spud Date: September 6, 1991
month day year

70' N & 70' E of
SW SW NW Sec 3 Twp 7 S, Rg 23 West

OPERATOR: License # 5058
Name: Griggs Oil, Inc
Address: 107 N. Market #800
City/State/Zip: Wichita, KS 67202
Contact Person: Jim Collins VP
Phone: 316-267-7779

3040 feet from South line of Section
4880 feet from East line of Section
(Note: Locate well on Section Plat on Reverse Side)

CONTRACTOR: License #: 5422
Name: Abercrombie RTD

County: Graham
Lease Name: Fountain Well #: 4
Field Name: Mt. Etna Northwest
Is this a Prorated Field? yes X no
Target Formation(s): LKC
Nearest lease or unit boundary: 400'
Ground Surface Elevation: 2393 EST feet MSU
Domestic well within 330 feet: yes X no
Municipal well within one mile: yes X no
Depth to bottom of fresh water: 120'
Depth to bottom of usable water: 1150'
Surface Pipe by Alternate: 1 X 2
Length of Surface Pipe Planned to be set: 200'
Length of Conductor pipe required: NA
Projected Total Depth: 3950'
Formation at Total Depth: BKC
Water Source for Drilling Operations:
well X farm pond other
DWR Permit #: to be filed
Will Cores Be Taken?: yes X no
If yes, proposed zone:

Well Drilled For: Well Class: Type Equipment:
X Oil Inj Infield X Mud Rotary
Gas Storage X Pool Ext Air Rotary
O&W Disposal Wildcat Cable
Seismic # of Holes

If O&W: old well information as follows:
Operator: NA
Well Name:
Comp. Date: Old Total Depth

Directional, Deviated or Horizontal wellbore? yes X no
If yes, total depth location:

AFFIDAVIT

The undersigned hereby affirms that the drilling, completion and eventual plugging of this well will comply with K.S.A. 55-101, et. seq.

- It is agreed that the following minimum requirements will be met:
- The appropriate district office shall be notified before setting surface pipe;
 - The minimum amount of surface pipe as specified above shall be set by circulating cement to the top; in all cases surface pipe shall be set through all unconsolidated materials plus a minimum of 20 feet into the underlying formation;
 - If the well is dry, a plugging proposal shall be submitted to the district office. An agreement between the operator and the district office on plug length and placement is necessary prior to plugging;
 - The appropriate district office will be notified before well is either plugged or production casing is cemented in;
 - If an Alternate II completion, production pipe shall be cemented from below any usable water to surface within 120 days of spud date. In all cases, notify district office prior to any cementing.

I hereby certify that the statements made herein are true and to the best of my knowledge and belief.
Date: 8/29/91 Signature of Operator or Agent: Title: VP

FOR KCC USE:
API # 15- 065-22,648-00-00
Conductor pipe required None feet
Minimum surface pipe required 200 feet per Alt. #2
Approved by: MW 8-30-91
EFFECTIVE DATE: 9-4-91
This authorization expires: 2-29-92
(This authorization void if drilling not started within 6 months of effective date.)
Spud date: Agent:

RECEIVED
STATE CONSERVATION COMMISSION
AUG 30 1991
CONSERVATION DIVISION
Wichita, Kansas
3 2 23cc

REMEMBER TO:

- File Drill Pit Application (form CDP-1) with Intent to Drill;
- File Completion Form ACO-1 within 120 days of spud date;
- File acreage attribution plus according to field proration orders;
- Notify appropriate district office 48 hours prior to workover or re-entry;
- Submit plugging report (CP-4) after plugging is completed;
- Obtain written approval before disposing or injecting salt water.

PLAT OF ACREAGE ATTRIBUTABLE TO A WELL

State Corporation Commission, Conservation Division
200 Colorado Derby Bldg. Wichita, Kansas 67202

OPERATOR Griggs Oil, Inc. LOCATION OF WELL:
 LEASE Fountain 3040 feet north of SE corner
 WELL NUMBER 4 4880 feet west of SE corner
 FIELD Mt Etna NW Sec. 3 T 7S R 23WE/W
 COUNTY Graham
 NO. OF ACRES ATTRIBUTABLE TO WELL 10 IS SECTION X REGULAR IRREGULAR?
 DESCRIPTION OF ACREAGE 76' N + 70' E of SW SW NW IF IRREGULAR, LOCATE WELL FROM NEAREST CORNER BOUNDARY.

NOTE: If plat depicted is insufficient for your circumstances, you may attach your own scaled or surveyed plat.

PLAT R-23 W

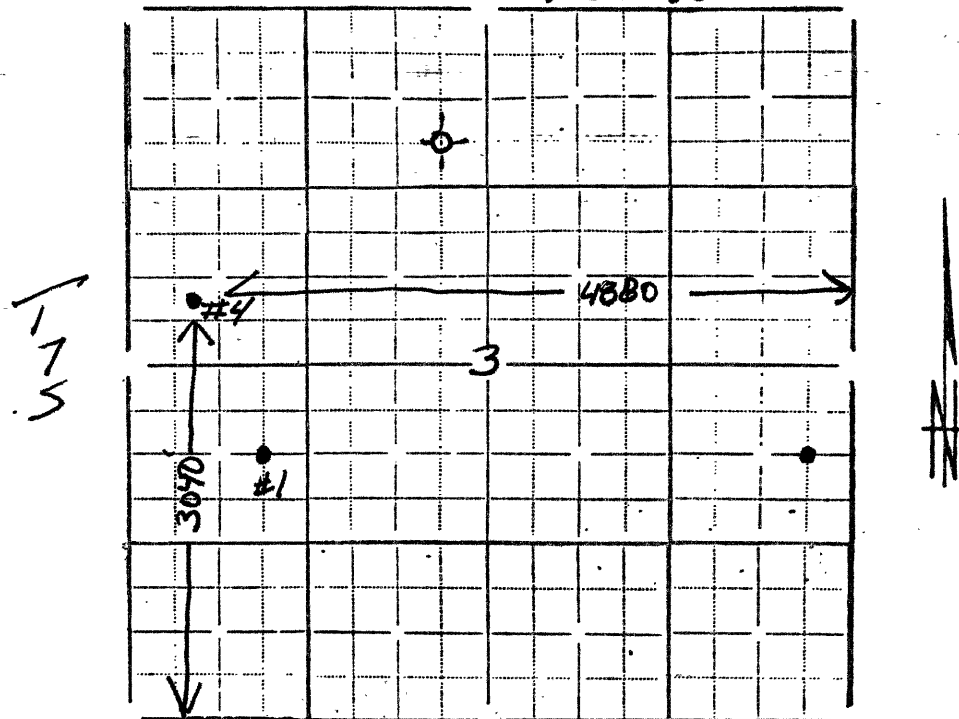

In plotting the proposed location of the well, you must show:

- 1) The manner in which you are using the depicted plat by identifying section lines, i.e. 1 section, 1 section with 8 surrounding partial sections, 4 sections, 16 sections, etc.;
- 2) the well's location relative to the location of other wells producing from the same common source of supply in adjoining drilling units, pursuant to K.A.R. 82-3-108, 82-3-207, 82-3-312, or special orders of the Commission;
- 3) the distance of the proposed drilling location from the section's east and south lines; and
- 4) the distance to the nearest lease or unit boundary line.

I hereby certify that the statements made herein are true and to the best of my knowledge and belief.

Signature of Operator or Agent James M. Collins

Date 8/29/91

Title VP