

FOR KCC USE:

EFFECTIVE DATE: 3-3-92

DISTRICT # 4

SGA? Yes X No

State of Kansas
NOTICE OF INTENTION TO DRILL

FORM C-1 7/91
FORM MUST BE TYPED
FORM MUST BE SIGNED
ALL BLANKS MUST BE FILLED

Must be approved by the K.C.C. five (5) days prior to commencing well

Expected Spud Date 3-1-92
month day year

Spot S 1/2 - N 1/2 SW 1/4 Sec 2 Twp 7 S, Rg 23 West

OPERATOR: License # 5474
Name: NORTHERN LIGHTS OIL CO., L.P.
Address: P.O. BOX 164
City/State/Zip: Andover, KS 67002
Contact Person: John Sutherland, Jr.
Phone: 316-733-1515

1650 feet from South North line of Section
1320 feet from East West line of Section
IS SECTION XX REGULAR IRREGULAR?

(NOTE: Locate well on the Section Plat on Reverse Side)
County: GRAHAM

Lease Name: Ft. Hays Well #: 1
Field Name: wildcat

CONTRACTOR: License #: 4958
Name: MALLARD, J.V.

Is this a Prorated/Spaced Field? yes X no
Target Formation(s): LKC

Nearest lease or unit boundary: 990
Ground Surface Elevation: will fill in 160 feet MSL on ACO-1

Well Drilled For: Well Class: Type Equipment:
X Oil Enh Rec Infield X Mud Rotary
Gas Storage Pool Ext. Air Rotary
OWWO Disposal X Wildcat Cable
Seismic: # of Holes Other

Water well within one-quarter mile: yes XX no
Public water supply well within one mile: yes XX no

Depth to bottom of fresh water: 160
Depth to bottom of usable water: 1150

If OWWO: old well information as follows:
Operator:
Well Name:
Comp. Date: Old Total Depth

Surface Pipe by Alternate: 1 X 2
Length of Surface Pipe Planned to be set: 250

Length of Conductor pipe required:
Projected Total Depth: 3950

Formation at Total Depth: Marmaton

Directional, Deviated or Horizontal wellbore? yes X no
If yes, true vertical depth:
Bottom Hole Location:

Water Source for Drilling Operations:
well XX farm pond other

DWR Permit #:
Will Cores Be Taken? yes XX no
If yes, proposed zone:

AFFIDAVIT

The undersigned hereby affirms that the drilling, completion and eventual plugging of this well will comply with K.S.A. 55-101, et. seq.
It is agreed that the following minimum requirements will be met:

- 1. Notify the appropriate district office prior to spudding of well;
2. A copy of the approved notice of intent to drill shall be posted on each drilling rig;
3. The minimum amount of surface pipe as specified below shall be set by circulating cement to the top; in all cases surface pipe shall be set through all unconsolidated materials plus a minimum of 20 feet into the underlying formation;
4. If the well is dry hole, an agreement between the operator and the district office on plug length and placement is necessary prior to plugging;
5. The appropriate district office will be notified before well is either plugged or production casing is cemented in;
6. IF AN ALTERNATE II COMPLETION, PRODUCTION PIPE SHALL BE CEMENTED FROM BELOW ANY USABLE WATER TO SURFACE WITHIN 120 DAYS OF SPUD DATE. IN ALL CASES, NOTIFY DISTRICT OFFICE PRIOR TO ANY CEMENTING.

I hereby certify that the statements made herein are true and to the best of my knowledge and belief.

Date: 2/25/92 Signature of Operator or Agent: J. L. W. Title: General Partner

FOR KCC USE:
API # 15- 065-22667-00-00
Conductor pipe required: None feet
Minimum surface pipe required: 400 feet per Alt.
Approved by: MLD 2-27-92
This authorization expires: 8-27-92
(This authorization void if drilling not started within 6 months of effective date.)
Spud date: Agent:

REMEMBER TO:

- File Drill Pit Application (form CDP-1) with Intent to Drill;
- File Completion Form ACO-1 within 120 days of spud date;
- File acreage attribution plat according to field proration orders;
- Notify appropriate district office 48 hours prior to workover or re-entry;
- Submit plugging report (CP-4) after plugging is completed;
- Obtain written approval before disposing or injecting salt water.

Mail to: Conservation Division, 200 Colorado Derby Building, 202 W. First St., Wichita, Kansas 67202-1286.

Handwritten notes and signatures on the right side of the page.

IN ALL CASES PLOT THE INTENDED WELL ON THE PLAT BELOW

PLAT OF ACREAGE ATTRIBUTABLE TO A WELL IN A PRORATED OR SPACED FIELD

If the intended well is in a prorated or spaced field, please fully complete this side of the form. If the intended well is in a prorated or spaced field complete the plat below showing that the well will be properly located in relationship to other wells producing from the common source of supply. Please show all the wells within 1 mile of the boundaries of the proposed acreage attribution unit for gas wells and within 1/2 mile of the boundaries of the proposed acreage attribution unit for oil wells.

API NO. 15- \_\_\_\_\_  
 OPERATOR Northern Lights Oil Co., L.P.  
 LEASE Ft. Hays  
 WELL NUMBER 1  
 FIELD Wildcat

LOCATION OF WELL: COUNTY Graham  
1650 feet from south/north line of section  
1320 feet from east/west line of section  
 SECTION 2 TWP 7S RG 23W

NUMBER OF ACRES ATTRIBUTABLE TO WELL ---  
 QTR/QTR/QTR OF ACREAGE \_\_\_\_\_ - \_\_\_\_\_ - \_\_\_\_\_

IS SECTION X REGULAR or \_\_\_\_\_ IRREGULAR  
IF SECTION IS IRREGULAR, LOCATE WELL FROM NEAREST CORNER BOUNDARY.

Section corner used: \_\_\_\_\_ NE \_\_\_\_\_ NW \_\_\_\_\_ SE \_\_\_\_\_ SW  
**PLAT**

(Show location of the well and shade attributable acreage for prorated or spaced wells.)  
 (Show footage to the nearest lease or unit boundary line.)

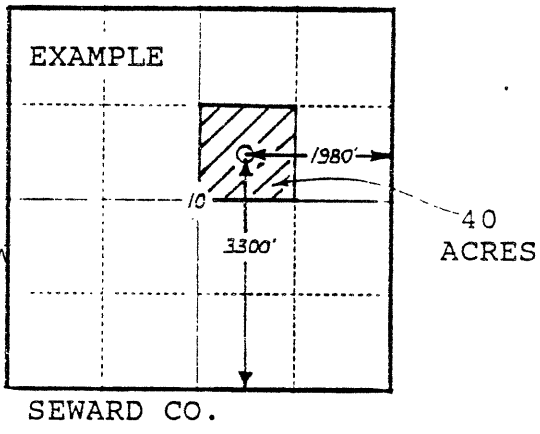
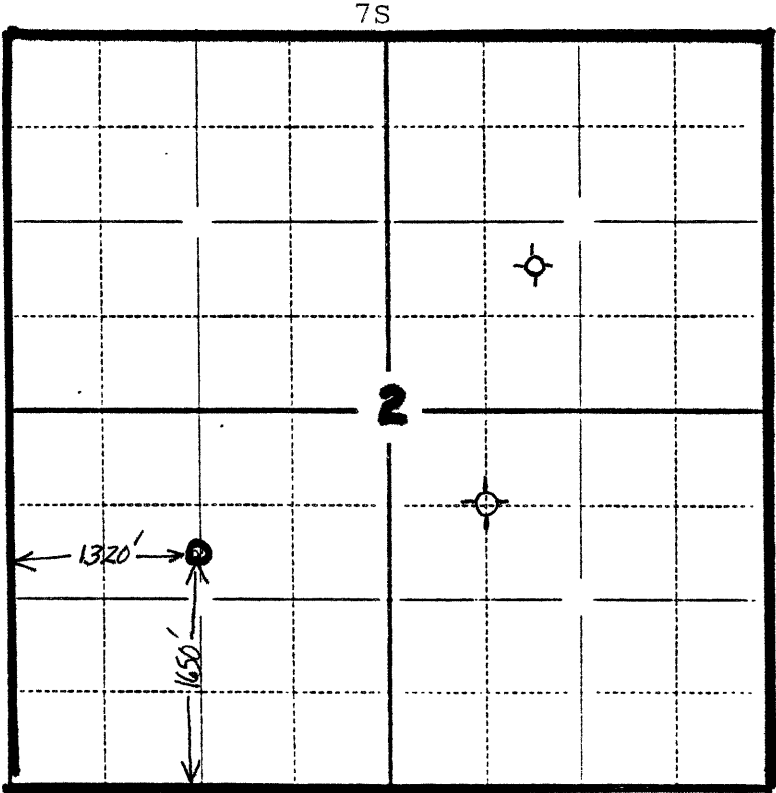

In plotting the proposed location of the well, you must show:

- 1) The manner in which you are using the depicted plat by identifying section lines, i.e. 1 section, 1 section with 8 surrounding sections, 4 sections, etc.;
- 2) the distance of the proposed drilling location from the section's south/north and east/west lines; and
- 3) the distance to the nearest lease or unit boundary line.