

15-065-20002-00-00

STATE OF KANSAS  
STATE CORPORATION COMMISSION

Give All Information Completely  
Make Required Affidavit  
Mail or Deliver Report to:  
Conservation Division  
State Corporation Commission  
212 North Market, Insurance Bldg.  
Wichita, Kansas

WELL PLUGGING RECORD

Graham County. Sec. 32 Twp. 7s Rge. 25w(E)\_\_\_\_(W)

Location as "NE/CNW/SW" or footage from lines NE, NE, SW,

Lease Owner John O. Farmer, Inc.

Lease Name Haskett Well No. 1

Office Address P. O. Box 352, Russell, Kansas 67665

Character of Well (completed as Oil, Gas or Dry Hole) Dry Hole

Date well completed 1/18 1967

Application for plugging filed 1/18 1967

Application for plugging approved 1/18 1967

Plugging commenced 1/18 1967

Plugging completed 4:30 P.M. 1/18 1967

Reason for abandonment of well or producing formation \_\_\_\_\_

If a producing well is abandoned, date of last production \_\_\_\_\_ 19\_\_\_\_

Was permission obtained from the Conservation Division or its agents before plugging was commenced? Yes

Name of Conservation Agent who supervised plugging of this well W. L. Nichols, Morland, Kansas

Producing formation \_\_\_\_\_ Depth to top \_\_\_\_\_ Bottom \_\_\_\_\_ Total Depth of Well 3967 Feet

Show depth and thickness of all water, oil and gas formations.

OIL, GAS OR WATER RECORDS

CASING RECORD

FORMATION	CONTENT	FROM	TO	SIZE	PUT IN	PULLED OUT

Describe in detail the manner in which the well was plugged, indicating where the mud fluid was placed and the method or methods used in introducing it into the hole. If cement or other plugs were used, state the character of same and depth placed, from \_\_\_\_\_ feet to \_\_\_\_\_ feet for each plug set.

Plug # 1 600' 20 sx. cement  
Plug # 2 220' 20 sx. cement  
Plug # 3 40' 10 sx. cement  
Completed: 4:30 P.M. 1/18/67

RECEIVED  
STATE CORPORATION COMMISSION  
JAN 27 1967  
JAN 27 1967  
CONSERVATION DIVISION  
Wichita, Kansas

(If additional description is necessary, use BACK of this sheet)  
Name of Plugging Contractor John O. Farmer, Inc.  
Address P.O. Box 352, Russell, Kansas 67665

STATE OF KANSAS, COUNTY OF RUSSELL, ss.  
JOHN O. FARMER, President (employee of owner) or (owner or operator) of the above-described well, being first duly sworn on oath, says: That I have knowledge of the facts, statements, and matters herein contained and the log of the above-described well as filed and that the same are true and correct. So help me God.

(Signature) John O. Farmer  
P.O. Box 352, Russell, Kansas  
(Address)

SUBSCRIBED AND SWORN TO before me this 27th day of January, 19 67

My commission expires February 15, 1967

Helen Carlson  
Notary Public.

OPERATOR JOHN O. FARMER, INC. 15-065-20002-00-00  
 ADDRESS P.O. Box 352, Russell, Kansas

FORMATION RECORD

Give detailed description and thickness of all formation drilled through, contents of sand, whether dry, water, oil or gas.

WELL NO. 1 COUNTY Graham TWP 7S RGE 25W  
 SEC. 32

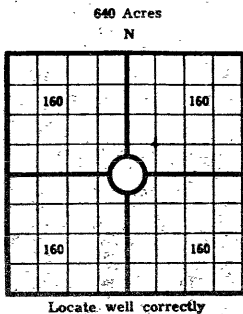

COUNTY Graham, SEC. 32, TWP. 7s, RGE. 25W  
 COMPANY OPERATING John O. Farmer, Inc.  
 OFFICE ADDRESS Box 352, Russell, Ks.  
 DRILLING STARTED 1/10/67, DRILLING FINISHED 1/18/67  
 DATE OF FIRST PRODUCTION \_\_\_\_\_ COMPLETED \_\_\_\_\_  
 WELL LOCATED NE 1/4 NE 1/4 SW 1/4, North of South  
 Line and \_\_\_\_\_ ft. East of West Line of Quarter Section  
 Elevation (Relative to sea level) 2486' DERRICK FLOOR 2483' GROUND  
 CHARACTER OF WELL (Oil, gas or dryhole) Dry Hole

OIL OR GAS SANDS OR ZONES

Name	From	To	Name	From	To
1			4		
2			5		
3			6		

Perforating Record if Any

Shot Record

Formation	From	To	No. of Shots	Formation	From	To	Size of Shot

CASING RECORD

Amount Set							Amount Pulled		Packer Record		
Size	Wt.	Thds.	Make	Ft.	In.	Ft.	In.	Size	Length	Depth Set	Make

Liner Record: Amount \_\_\_\_\_ Kind \_\_\_\_\_ Top \_\_\_\_\_ Bottom \_\_\_\_\_

CEMENTING AND MUDDING

Size	Amount Set		Sacks Cement	Chemical		Method of Cementing	Amount	Mudding Method	Results (See Note)
	Ft.	In.		Gal.	Make				
8 5/8"	207'	135	sx.						

Note: What method was used to protect sands if outer strings were pulled?

NOTE: Were bottom hole plugs used? \_\_\_\_\_ If so, state kind, depth set and results obtained

TOOLS USED

Rotary Tools were used from 0 feet to R.T.D. Cable tools were used from \_\_\_\_\_ feet to \_\_\_\_\_ feet, and from \_\_\_\_\_ feet to \_\_\_\_\_ feet, and from \_\_\_\_\_ feet to \_\_\_\_\_ feet  
 Type Rig Rotary

INITIAL PRODUCTION TEST

Describe initial test: whether by flow through tubing or casing or by pumping

Amount of Oil Production \_\_\_\_\_ bbls. Size of choke, if any \_\_\_\_\_ Length of test \_\_\_\_\_ Water

Production \_\_\_\_\_ bbls. Gravity of oil \_\_\_\_\_ Type of Pump if pump is used, describe \_\_\_\_\_

Formation	Top	Bottom	Formation	Top	Bottom
Surface		208			
Shale	208	430'			
Shale & Sand	430	1200			
Shale	1200	1968			
Shale & Shells	1968	2115			
Anhydrite	2115	2150			
Shale & Shells	2150	2925			
Shale & Lime	2925	3245			
Lime & Shale	3245	3685			
Lime	3685	3947			

Log Tops	
Anhydrite	2150'
Heebner	3696'
Toronto	3719'
Lansing	3734'
B/ Kansas City	3952'
L.T.B.	3968'
R.T.D.	3967'

RECEIVED  
 SOIL CONSERVATION COMMISSION  
 JAN 27 1967  
 JAN 27 1967  
 CONSERVATION DIVISION  
 WICHITA, KANSAS

I, the undersigned, being first duly sworn upon oath, state that this well record is true, correct and complete according to the records of this office and to the best of my knowledge and belief.

John O. Farmer  
 Name and title of representative of company  
 President

Subscribed and sworn to before me this 27th day of January, 1967  
 My Commission expires 2/15/67

Helen Carlson  
 Notary Public

FARM NAME Haskett