

RECEIVED

JAN 09 2006

For KCC Use: 1-30-06  
Effective Date: 2  
District #  
SGA?  Yes  No

KANSAS CORPORATION COMMISSION  
OIL & GAS CONSERVATION DIVISION  
**NOTICE OF INTENT TO DRILL**

KCC WICHITA

Form C-1  
December 2002  
Form must be Typed  
Form must be Signed  
All blanks must be Filled

Must be approved by KCC five (5) days prior to commencing well

Expected Spud Date 01-25-05  
month / day / year

OPERATOR: License# 04941  
Name: Union Valley Petroleum Corporation  
Address: 10422 Pinto Lane  
City/State/Zip: Enid, OK 73701  
Contact Person: Paul Youngblood  
Phone: 580-237-3959; Mob: 580-541-1417

CONTRACTOR: License# 33132  
Name: Dan D. Drilling

Well Drilled For:  Oil  Enh Rec  Gas  Storage  OWWO  Disposal  Seismic; # of Holes  Other  
Well Class:  Infield  Pool Ext.  Wildcat  Other  
Type Equipment:  Mud Rotary  Air Rotary  Cable

If OWWO: old well information as follows:  
Operator:  
Well Name:  
Original Completion Date: Original Total Depth:

Directional, Deviated or Horizontal wellbore?  Yes  No  
If Yes, true vertical depth:  
Bottom Hole Location:  
KCC DKT #:

Spot  
C/N2 SE - SE - NW Sec. 4 Twp. 34S S. R. 6W  
495 feet from  N /  S Line of Section  
330 feet from  E /  W Line of Section  
Is SECTION  Regular  Irregular?

(Note: Locate well on the Section Plat on reverse side)  
County: Harper  
Lease Name: BILL Well #: 1-4  
Field Name: EASTHAN NORTH  
Is this a Prorated / Spaced Field?  Yes  No  
Target Formation(s): MISSISSIPPI  
Nearest Lease or unit boundary: 330  
Ground Surface Elevation: 1276 feet MSL  
Water well within one-quarter mile:  Yes  No  
Public water supply well within one mile:  Yes  No  
Depth to bottom of fresh water: 150  
Depth to bottom of usable water: 180  
Surface Pipe by Alternate:  1  2  
Length of Surface Pipe Planned to be set: 250  
Length of Conductor Pipe required: NONE  
Projected Total Depth: 4700  
Formation at Total Depth: MISSISSIPPI  
Water Source for Drilling Operations:  Well  Farm Pond Other HAUL  
DWR Permit #:  
(Note: Apply for Permit with DWR )  
Will Cores be taken?  Yes  No  
If Yes, proposed zone:

**AFFIDAVIT**

The undersigned hereby affirms that the drilling, completion and eventual plugging of this well will comply with K.S.A. 55 et. seq.  
It is agreed that the following minimum requirements will be met:

1. Notify the appropriate district office **prior** to spudding of well;
2. A copy of the approved notice of intent to drill **shall be** posted on each drilling rig;
3. The minimum amount of surface pipe as specified below **shall be set** by circulating cement to the top; in all cases surface pipe **shall be set** through all unconsolidated materials plus a minimum of 20 feet into the underlying formation.
4. If the well is dry hole, an agreement between the operator and the district office on plug length and placement is necessary **prior to plugging**;
5. The appropriate district office will be notified before well is either plugged or production casing is cemented in;
6. If an ALTERNATE II COMPLETION, production pipe shall be cemented from below any usable water to surface within **120 days** of spud date.  
Or pursuant to Appendix "B" - Eastern Kansas surface casing order #133,891-C, which applies to the KCC District 3 area, alternate II cementing must be completed within 30 days of the spud date or the well shall be plugged. **In all cases, NOTIFY district office** prior to any cementing.

I hereby certify that the statements made herein are true and to the best of my knowledge and belief.

Date: 12-23-05 Signature of Operator or Agent: [Signature] Title: President

For KCC Use ONLY  
API # 15 - 077-21546-00-00  
Conductor pipe required NONE feet  
Minimum surface pipe required 200 feet per Alt. 1  
Approved by: [Signature] 12-25-06  
This authorization expires: 7-25-06  
(This authorization void if drilling not started within 6 months of approval date.)  
Spud date: Agent:

Remember to:  
- File Drill Pit Application (form CDP-1) with Intent to Drill;  
- File Completion Form ACO-1 within 120 days of spud date;  
- File acreage attribution plat according to field proration orders;  
- Notify appropriate district office 48 hours prior to workover or re-entry;  
- Submit plugging report (CP-4) after plugging is completed;  
- Obtain written approval before disposing or injecting salt water.  
- If this permit has expired (See: authorized expiration date) please check the box below and return to the address below.  
 Well Not Drilled - Permit Expired  
Signature of Operator or Agent: Date:

4  
34  
607

**IN ALL CASES PLOT THE INTENDED WELL ON THE PLAT BELOW**

*Plat of acreage attributable to a well in a prorated or spaced field*

**If the intended well is in a prorated or spaced field, please fully complete this side of the form.** If the intended well is in a prorated or spaced field complete the plat below showing that the well will be properly located in relationship to other wells producing from the common source of supply. Please show all the wells and within 1 mile of the boundaries of the proposed acreage attribution unit for gas wells and within 1/2 mile of the boundaries of the proposed acreage attribution unit for oil wells.

API No. 15 - \_\_\_\_\_  
 Operator: Union Valley Petroleum Corporation  
 Lease: BILL  
 Well Number: 1-4  
 Field: EASTHAN NORTH  
 Number of Acres attributable to well: \_\_\_\_\_  
 QTR / QTR / QTR of acreage: C N2 SE - SE - NW

Location of Well: County: Harper  
495 feet from  N /  S Line of Section  
330 feet from  E /  W Line of Section  
 Sec. 4 Twp. 34S S. R. 6W  East  West

Is Section:  Regular or  Irregular

**If Section is Irregular, locate well from nearest corner boundary.**

Section corner used:  NE  NW  SE  SW

**PLAT**

*(Show location of the well and shade attributable acreage for prorated or spaced wells.)*

*(Show footage to the nearest lease or unit boundary line.)*

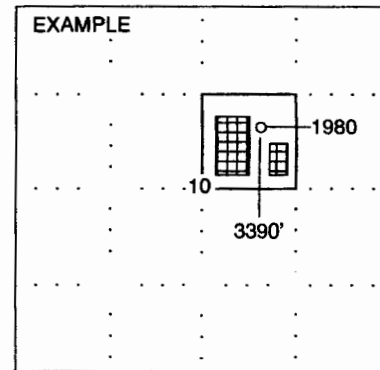
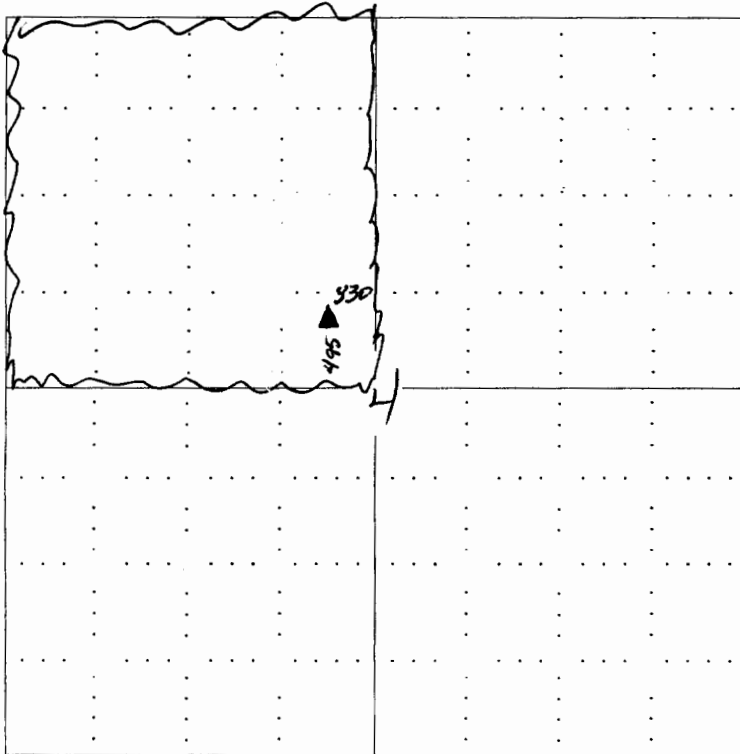

**NOTE: In all cases locate the spot of the proposed drilling locaton.**

**In plotting the proposed location of the well, you must show:**

1. The manner in which you are using the depicted plat by identifying section lines, i.e. 1 section, 1 section with 8 surrounding sections, 4 sections, etc.
2. The distance of the proposed drilling location from the section's south / north and east / west.
3. The distance to the nearest lease or unit boundary line.
4. If proposed location is located within a prorated or spaced field a certificate of acreage attribution plat must be attached: (C0-7 for oil wells; CG-8 for gas wells).

# KANSAS

CORPORATION COMMISSION

KATHLEEN SEBELIUS, GOVERNOR  
BRIAN J. MOLINE, CHAIR  
ROBERT E. KREHBIEL, COMMISSIONER  
MICHAEL C. MOFFET, COMMISSIONER

January 25, 2006

Mr. Paul Youngblood  
Union Valley Petroleum Corporation  
10422 Pinto Lane  
Enid, OK 73701

RE: Drilling Pit Application  
Bill Lease Well No. 1-4  
NW/4 Sec. 04-34S-06W  
Harper County, Kansas

Dear Mr. Youngblood:

District staff has inspected the above referenced location and has determined that the reserve pit shall be constructed **without slots**, the bottom shall be flat and reasonably level, and the free fluids must be removed. The fluids are to be removed from the reserve pit within 72 hours of drilling completion.

**If production casing is set all completion fluids shall be removed from the working pits daily. NO completion fluids or non-exempt wastes shall be placed in the reserve pit.**

The fluids should be taken to an authorized disposal well. Please call the District Office at (316) 630-4000 when the fluids have been removed. Please file form CDP-5 (August 2004), Exploration and Production Waste Transfer, within 30 days of fluid removal. Conservation division forms are available through our office and on the KCC web site: [www.kcc.state.ks.us/conservation/forms](http://www.kcc.state.ks.us/conservation/forms).

**A copy of this letter should be posted in the doghouse along with the approved Intent to Drill.**  
If you have any questions or concerns please feel free to contact the undersigned at the above address.

Sincerely,

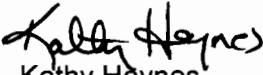
  
Kathy Haynes

Environmental Protection and Remediation Department

cc: Doug Louis