

For KCC Use: 2-7-06  
Effective Date: \_\_\_\_\_  
District # 1  
SGA? ☐ Yes ☒ No

KANSAS CORPORATION COMMISSION  
OIL & GAS CONSERVATION DIVISION

NOTICE OF INTENT TO DRILL

Must be approved by KCC five (5) days prior to commencing well

Form C-1  
December 2002  
Form must be Typed  
Form must be Signed  
All blanks must be Filled

Expected Spud Date February 4, 2006  
month day year

OPERATOR: License# 32204  
Name: REDLAND RESOURCES, INC.  
Address: 8001 NW 23RD STREET  
City/State/Zip: OKLAHOMA CITY, OK 73127  
Contact Person: ALAN THROWER  
Phone: (405)789-7104

CONTRACTOR: License# 3363  
Name: TITAN DRILLING

Well Drilled For:	Well Class:	Type Equipment:
<input type="checkbox"/> Oil	<input type="checkbox"/> Enh Rec	<input checked="" type="checkbox"/> Infield
<input checked="" type="checkbox"/> Gas	<input type="checkbox"/> Storage	<input type="checkbox"/> Pool Ext.
<input type="checkbox"/> CWO	<input type="checkbox"/> Disposal	<input type="checkbox"/> Wildcat
<input type="checkbox"/> Seismic; # of Holes	<input type="checkbox"/> Other	<input type="checkbox"/> Cable
<input type="checkbox"/> Other		

If OWWO: old well information as follows:

Operator: \_\_\_\_\_  
Well Name: \_\_\_\_\_  
Original Completion Date: \_\_\_\_\_ Original Total Depth: \_\_\_\_\_

Directional, Deviated or Horizontal wellbore? ☐ Yes ☒ No

If Yes, true vertical depth: \_\_\_\_\_

Bottom Hole Location: \_\_\_\_\_

KCC DKT #: \_\_\_\_\_

Spot Approx.  
S/2 N/2 NW Sec. 14 Twp. 35S S. R. 16  
1100 feet from ☒ N / ☐ S Line of Section  
1320 feet from ☐ E / ☒ W Line of Section  
Is SECTION Regular ☒ Irregular?

(Note: Locate well on the Section Plat on reverse side)

County: COMANCHE  
Lease Name: WILBUR Well #: 14-5  
Field Name: AETNA GAS AREA  
Is this a Prorated / Spaced Field? ☐ Yes ☒ No  
Target Formation(s): MISSISSIPPIAN  
Nearest Lease or unit boundary: 1100'  
Ground Surface Elevation: 1862 feet MSL  
Water well within one-quarter mile: ☐ Yes ☒ No  
Public water supply well within one mile: ☐ Yes ☒ No  
Depth to bottom of fresh water: 150'  
Depth to bottom of usable water: 180'  
Surface Pipe by Alternate: ☒ 1 ☐ 2  
Length of Surface Pipe Planned to be set: 800'  
Length of Conductor Pipe required: NONE  
Projected Total Depth: 5500'  
Formation at Total Depth: MISSISSIPPIAN  
Water Source for Drilling Operations:  
☐ Well ☐ Farm Pond Other SPRING  
DWR Permit #: \_\_\_\_\_

(Note: Apply for Permit with DWR ☐)

Will Cores be taken? ☐ Yes ☒ No  
If Yes, proposed zone: \_\_\_\_\_

CONSERVATION DIVISION  
WICHITA, KS

AFFIDAVIT

The undersigned hereby affirms that the drilling, completion and eventual plugging of this well will comply with K.S.A. 55 et. seq.

It is agreed that the following minimum requirements will be met:

1. Notify the appropriate district office **prior** to spudding of well;
2. A copy of the approved notice of intent to drill **shall be** posted on each drilling rig;
3. The minimum amount of surface pipe as specified below **shall be set** by circulating cement to the top; in all cases surface pipe **shall be set** through all unconsolidated materials plus a minimum of 20 feet into the underlying formation.
4. If the well is dry hole, an agreement between the operator and the district office on plug length and placement is necessary **prior to plugging**;
5. The appropriate district office will be notified before well is either plugged or production casing is cemented in;
6. If an ALTERNATE II COMPLETION, production pipe shall be cemented from below any usable water to surface within **120 days** of spud date.  
Or pursuant to Appendix "B" - Eastern Kansas surface casing order #133,891-C, which applies to the KCC District 3 area, alternate II cementing must be completed within 30 days of the spud date or the well shall be plugged. **In all cases, NOTIFY district office** prior to any cementing.

I hereby certify that the statements made herein are true and to the best of my knowledge and belief.

Date: 01/12/06 Signature of Operator or Agent: [Signature] Title: VICE PRESIDENT

For KCC Use ONLY

API # 15 - 033-21459-00-00  
Conductor pipe required NONE feet  
Minimum surface pipe required 200 feet per Alt. 1  
Approved by: [Signature]  
This authorization expires: 8-2-06  
(This authorization void if drilling not started within 6 months of approval date.)  
Spud date: \_\_\_\_\_ Agent: \_\_\_\_\_

Remember to:

- File Drill Pit Application (form CDP-1) with Intent to Drill;
- File Completion Form ACO-1 within 120 days of spud date;
- File acreage attribution plat according to field proration orders;
- Notify appropriate district office 48 hours prior to workover or re-entry;
- Submit plugging report (CP-4) after plugging is completed;
- Obtain written approval before disposing or injecting salt water.
- If this permit has expired (See: authorized expiration date) please check the box below and return to the address below.

☐ Well Not Drilled - Permit Expired

Signature of Operator or Agent: \_\_\_\_\_  
Date: \_\_\_\_\_

Mail to: KCC - Conservation Division, 130 S. Market - Room 2078, Wichita, Kansas 67202

14 35 New

**IN ALL CASES PLOT THE INTENDED WELL ON THE PLAT BELOW***Plat of acreage attributable to a well in a prorated or spaced field*

If the intended well is in a prorated or spaced field, please fully complete this side of the form. If the intended well is in a prorated or spaced field complete the plat below showing that the well will be properly located in relationship to other wells producing from the common source of supply. Please show all the wells and within 1 mile of the boundaries of the proposed acreage attribution unit for gas wells and within 1/2 mile of the boundaries of the proposed acreage attribution unit for oil wells.

API No. 15 - \_\_\_\_\_  
 Operator: REDLAND RESOURCES, INC.  
 Lease: WILBUR  
 Well Number: 14-5  
 Field: AETNA GAS AREA

Number of Acres attributable to well: \_\_\_\_\_  
 QTR / QTR / QTR of acreage: S/2 - N/2 - NW

Location of Well: County: COMANCHE  
1100 feet from ☒ N / ☐ S Line of Section  
1320 feet from ☐ E / ☒ W Line of Section  
 Sec. 14 Twp. 35S S. R. 16 ☐ East ☒ West

Is Section: ☐ Regular or ☒ Irregular

If Section is Irregular, locate well from nearest corner boundary.

Section corner used: ☐ NE ☒ NW ☐ SE ☐ SW

**PLAT**

(Show location of the well and shade attributable acreage for prorated or spaced wells.)

(Show footage to the nearest lease or unit boundary line.)

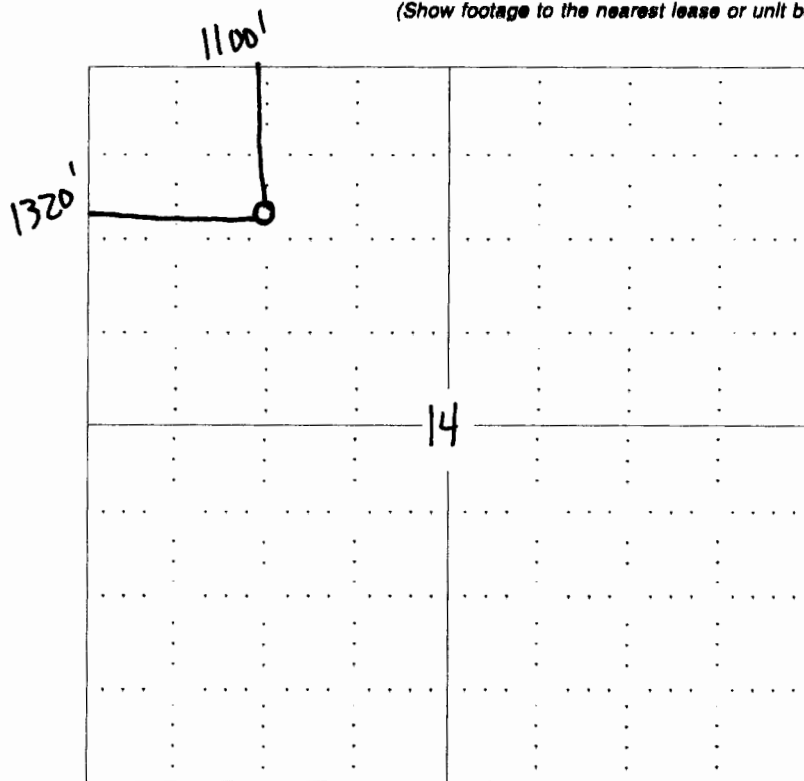

**RECEIVED**  
**KANSAS CORPORATION COMMISSION**  
**JAN 31 2006**  
**CONSERVATION DIVISION**  
**WICHITA KS**

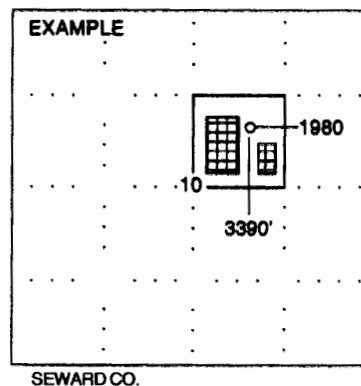

**NOTE: In all cases locate the spot of the proposed drilling location.**

**In plotting the proposed location of the well, you must show:**

1. The manner in which you are using the depicted plat by identifying section lines, i.e. 1 section, 1 section with 8 surrounding sections, 4 sections, etc.
2. The distance of the proposed drilling location from the section's south / north and east / west.
3. The distance to the nearest lease or unit boundary line.
4. If proposed location is located within a prorated or spaced field a certificate of acreage attribution plat must be attached: (CO-7 for oil wells; CG-8 for gas wells).

# KANSAS

CORPORATION COMMISSION

KATHLEEN SEBELIUS, GOVERNOR

BRIAN J. MOLINE, CHAIR

ROBERT E. KREHBIEL, COMMISSIONER

MICHAEL C. MOFFET, COMMISSIONER

February 2, 2006

Alan Thrower  
Redland Resources, Inc.  
6001 NW 23<sup>rd</sup> Street  
Oklahoma City, OK 73127

Re: Drilling Pit Application  
Wilbur Lease Well No. 14-5  
NW/4 14-35S-16W  
Comanche County, Kansas

Dear Mr. Thrower:

District staff has inspected the above referenced location and has determined that the reserve pit shall be constructed **without slots**, the bottom shall be flat and reasonably level and the free fluids must be removed. The fluids are to be removed from the reserve pit as soon as the Hutchinson Salt section has been drilled through and displacement of the fluids into the reserve pit has occurred. The fluids should be removed again as soon as practical after drilling operations have ceased.

**If production casing is set all completion fluids shall be removed from the working pits daily. NO completion fluids or non-exempt wastes shall be placed in the reserve pit.**

The fluids should be taken to an authorized disposal well. Please call the District Office at (620) 225-8888 when the fluids have been removed. Please file form CDP-5 (August 2004), Exploration and Production Waste Transfer, within 30 days of fluid removal. Conservation division forms are available through our office and on the KCC web site: [www.kcc.state.ks.us/conservation/forms/](http://www.kcc.state.ks.us/conservation/forms/)

**A copy of this letter should be posted in the doghouse along with the approved Intent to Drill.** If you have any questions or concerns please feel free to contact the undersigned at the above address.

Sincerely,



Jonelle Rains, Supervisor  
Department of Environmental Protection and Remediation

cc: Steve Durrant ✓  
File