

STATE OF KANSAS
STATE CORPORATION COMMISSION

WELL PLUGGING RECORD

Give All Information Completely
Make Required Affidavit
Mail or Deliver Report to:
Conservation Division
State Corporation Commission
212 North Market, Insurance Bldg.
Wichita, Kansas

Sheridan County. Sec. 29 Twp. 7S Rge. 28W (E) (W)

Location as "NE/CNW%SW%" or footage from lines NE/4 NE/4 NE/4

Lease Owner John O. Farmer, Inc.

Lease Name Keller Well No. 1

Office Address P.O. Box 352, Russell, Kansas

Character of Well (completed as Oil, Gas or Dry Hole) Dryhole

Date well completed 3/29 19 68

Application for plugging filed 3/29 19 68

Application for plugging approved 3/29 19 68

Plugging commenced 3/29 19 68

Plugging completed 1:30 P.M. 3/29 19 68

Reason for abandonment of well or producing formation Dry

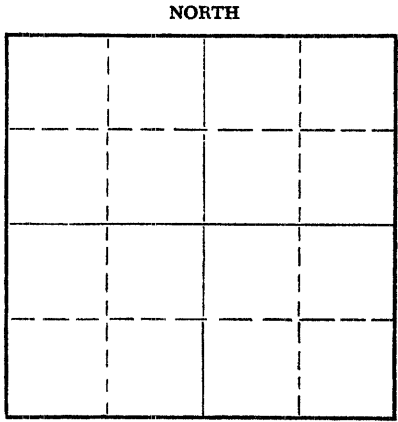

Locate well correctly on above Section Plat

If a producing well is abandoned, date of last production 19

Was permission obtained from the Conservation Division or its agents before plugging was commenced? Yes

Name of Conservation Agent who supervised plugging of this well W. L. Nichols, Morland, Kansas

Producing formation Depth to top Bottom Total Depth of Well 4190 Feet

Show depth and thickness of all water, oil and gas formations.

OIL, GAS OR WATER RECORDS

CASING RECORD

FORMATION	CONTENT	FROM	TO	SIZE	PUT IN	PULLED OUT

Describe in detail the manner in which the well was plugged, indicating where the mud fluid was placed and the method or methods used in introducing it into the hole. If cement or other plugs were used, state the character of same and depth placed, from feet to feet for each plug set.

Plug # 1 1550' 100 sx. cement
Plug # 2 275' 20 sx. cement
Plug # 3 40' 10 sx. cement
Completed: 1:30 P.M. 3/29/68

RECEIVED
STATE CORPORATION COMMISSION

APR 3 1968 APR 3, 1968

CONSERVATION DIVISION
Wichita, Kansas

(If additional description is necessary, use BACK of this sheet)
Name of Plugging Contractor John O. Farmer, Inc.
Address P.O. Box 352, Russell, Kansas 67665

STATE OF KANSAS, COUNTY OF RUSSELL, ss.
JOHN O. FARMER, (employee of owner) or (owner or operator) of the above-described well, being first duly sworn on oath, says: That I have knowledge of the facts, statements, and matters herein contained and the log of the above-described well and that the same are true and correct. So help me God.

(Signature) John O. Farmer
370 W. Wichita, Russell, Kansas (Address)

Described and sworn to before me this 2nd day of April, 1968

My commission expires February 15, 1971
Helen Carlson Notary Public.

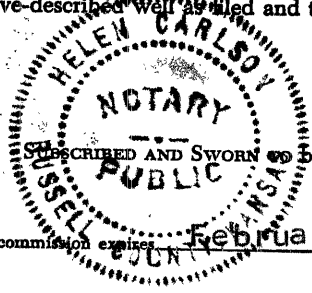

OPERATOR John O. Farmer, Inc.
 ADDRESS Box 352, Russell, Kansas

FORMATION RECORD

Give detailed description and thickness of all formation drilled through, contents of sand, whether dry, water, oil or gas.

Formation	Top	Bottom	Formation	Top	Bottom
Surface		245			
Shale	245	1945			
Shale shells	1945	2484			
Anhydrite	2484	2520			
Shale shells	2520	2750			
Shale lime	2750	3420			
Lime shale	3420	4190			
			Sample Tops		Top
			Anhydrite		2484'
			Wabaunsee		3603'
			Topeka		3689'
			Heebner		3902'
			Toronto		3924'
			Lansing		3921'
			Base Kansas City		4171'
			Rotary T.D.		4190'

RECEIVED
 STATE CORPORATION COMMISSION
 APR 3 1968 APR 3 1968
 CONSERVATION DIVISION
 Wichita, Kansas

I, the undersigned, being first duly sworn upon oath, state that this well record is true, correct and complete according to the records of this office and to the best of my knowledge and belief.

John O. Farmer
 Name and title of representative of company
 President
 Subscribed and sworn to before me this 2nd day of April, 1968

Helen Carlson
 My Commission expires 2/15/71
 Helen Carlson Notary Public

15-17A-20083-00-00
 FARM NAME KELLER
 WELL NO. 1 COUNTY Sheridan SEC. 29 TWP. 7S RGE. 28W

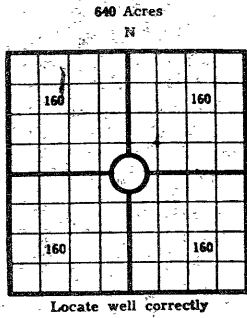

COUNTY Sheridan SEC. 29 TWP. 7S RGE. 28W
 COMPANY OPERATING John O. Farmer, Inc.
 OFFICE ADDRESS Box 352, Russell, Ks.
 DRILLING STARTED 3/22 68, DRILLING FINISHED 3/29 68
 DATE OF FIRST PRODUCTION _____ COMPLETED _____
 WELL LOCATED NE 1/4 NE 1/4 NE 1/4, North of South
 Line and _____ ft. East of West Line of Quarter Section
 Elevation (Relative to sea level) DERRICK FLOOR 2772 GROUND 2769
 CHARACTER OF WELL (Oil, gas or dryhole) Dryhole

OIL OR GAS SANDS OR ZONES

Name	From	To	Name	From	To
1			4		
2			5		
3			6		

Perforating Record If Any

Shot Record

Formation	From	To	No. of Shots	Formation	From	To	Size of Shot

CASING RECORD

Amount Set						Amount Pulled		Packer Record	
Size	Wt.	Thds.	Make	Ft.	In.	Size	Length	Depth Set	Make

Liner Record, Amount _____ Kind _____ Top _____ Bottom _____

CEMENTING AND MUDDING

Size	Amount Set		Sacks Cement	Chemical		Method of Cementing	Amount	Mudding Method	Results (See Note)
	Ft.	In.		Gal.	Make				
8 5/8	245		150	SX					

Note: What method was used to protect sands if outer strings were pulled?

NOTE: Were bottom hole plugs used? _____ If so, state kind, depth set and results obtained _____

TOOLS USED

Rotary Tools were used from 0 feet to R.T.D. Cable tools were used from _____ feet to _____ feet, and from _____ feet to _____ feet and from _____ feet to _____ feet

Type Rig Rotary

INITIAL PRODUCTION TEST

Describe initial test: whether by flow through tubing or casing or by pumping _____

Amount of Oil Production _____ bbls. Size of choke, if any _____ Length of test _____ Water

Production _____ bbls. Gravity of oil _____ Type of Pump if pump is used, describe _____