

EFFECTIVE DATE: 5-11-99
DISTRICT # 4

State of Kansas
CATHODIC PROTECTION BOREHOLE INTENT DRAFT

FORM MUST BE TYPED
FORM MUST BE SIGNED
ALL BLANKS MUST BE FILLED IN

SGA? ... Yes... No Must be approved by the K.C.C. sixty (60) days prior to commencing well.

Expected Spud (Starting) Date 6 25 99
month day year

Spot (Location) Q/Q/Q
SW WSE SW Sec. 31 Twp. 7 S, Rg. 33 X East
127 feet from South / ~~North~~ line of Section
1326 feet from ~~East~~ / West line of Section
(Circle directions from nearest outside corner boundaries)

OPERATOR: License # 31089

Name: MIDWEST ENERGY, INC.
Address: 1330 Canterbury Rd
City/State/Zip: Hays, Ks 67601

IS SECTION X REGULAR _____ IRREGULAR?
(Spot well on the Section Plat on Reverse Side)
County: Thomas

Contact Person: De Sultzer

Lease Name: N/A Well #: N/A

Phone: 785-625-1437

Facility Name: Colby School # (CPI)

CONTRACTOR: License #: 31308

Name: Rick Young Drilling

Ground Surface Elevation: 3176 MSL.
* Cathodic Borehole Total Depth 115 ft.
Depth to Bedrock 250 SHALE ft.

Type Drilling Equipment: Mud Rotary Cable
 Air Rotary Other

WATER INFORMATION:
Aquifer Penetration: None Single Multiple
Depth to ~~bottom~~ TOP of fresh water: TOP OF AQUIFER ? APPROX 130'

CONSTRUCTION FEATURES

Length of Cathodic Surface (Non-Metallic) Casing
Planned to be set: 20 ft.
Length of Conductor pipe (if any?): 0 ft.

Depth to bottom of usable water: _____
Water well within one-quarter mile: yes no
Public water supply well within one mile: yes no
Water Source for Drilling Operations:
 well farm pond stream other

Size of the borehole (I.D.): 12 1/4 inches
Cathodic surface casing size: 8 inches
Cathodic surface casing centralizers set at depths of: 5 ;
15 ; ... ; ... ; ... ; ... ; ... ; ... ; ... ; ... ; ... ;

Water Well Location: _____
DWR Permit #: _____
Standard Dimension Ratio (SDR) is = 8" SDR-26
(cathodic surface OD csg. in inches / MWT in inches = SDR)

Cathodic surface casing will terminate at:
 Above surface Surface Vault Below Surface Vault

Annular space between borehole and casing will be grouted
with: Concrete Bentonite Cement
 Neat cement Bentonite clay

Pitless casing adaptor will be used: Yes/No at Depth .3 ft.

Anode vent pipe will be set at: .3 ft. above surface

Anode installation depths are: 30 ; 38 ; 46 ; 54 ;
62 ; 70 ; 78 ; 86 ; ... ; ... ; ... ; ... ; ... ;

Anode conductor (backfill) material TYPE: Loresco-DW-1

Depth to BASE of Backfill installation material: 115 ...
Depth to TOP of Backfill installation material: 20 ...

AFFIDAVIT

The undersigned hereby affirms that the drilling, completion and eventual plugging of this well will comply with K.S.A. 55-101, et. seq. It is agreed that the following minimum requirements will be met:

1. Notify the appropriate district office prior to spudding of and again before plugging well;
2. A copy of the approved notice of intent to drill shall be posted on each drilling rig;
3. The minimum amount of cathodic surface casing as specified below shall be set by grouting to the top.
4. An agreement between the operator and the district office on plugs and placement is necessary prior to plugging;
5. The appropriate district office will be notified before well is either plugged or casing is grouted in;
6. IN ALL CASES, NOTIFY DISTRICT OFFICE PRIOR TO ANY CEMENTING.

I hereby certify that the statements made herein are true and to the best of my knowledge and belief.

Date: 4-30-99 Signature of Operator or Agent: De Sultzer Title: CORROSION TECH.

* MAX. CATHODIC
BOREHOLE DEPTH
= 115'

FOR KCC USE:
API # 15- 193-206670000
Conductor pipe required NONE feet
Minimum cathodic surface casing required 20 feet (AL3)
Approved by: JK 5-6-99
This authorization expires: 11-6-99
(This authorization void if drilling not started within 6 months of effective date.)
Spud date: _____ Agent: _____

RECEIVED
STATE CORPORATION COMMISSION
MAY 03 1999
MAY 03 1999

REMEMBER TO:

- File Drill Pit Application (form CDP-1) with Intent to Install;
- File Completion Form CB-2 within 30 days of spud date;
- Notify appropriate district office 48 hours prior to workover or re-entry;
- Submit plugging report (CB-4) within 30 days after plugging is completed.

Mail to: Conservation Division, 200 Colorado Derby Building, 202 W. First St., Wichita, Kansas 67202-1286.

31
7
330

cathodic borehole. Please show all the wells, existing cathodic boreholes, pipelines or facilities within 1/2 mile of the proposed borehole.

API NO. 15- _____
 OPERATOR MIDWEST ENERGY, INC. LOCATION OF WELL: COUNTY Thomas
 LEASE N/A 127 feet from south/north line of section
 WELL NUMBER N/A 1326 feet from east/west line of section
 FACILITY NAME Colby School SECTION 31 TWP 7 RG 33

SPOT: QTR/QTR/QTR/QTR OF ACREAGE
SW - WSE - SW - SW
 IS SECTION x REGULAR or _____ IRREGULAR
IF SECTION IS IRREGULAR, LOCATE WELL FROM NEAREST CORNER BOUNDARY.
 Section corner used: _____ NE _____ NW _____ SE x SW

PLAT

(Show location of intended cathodic borehole.)
 (Show footage from nearest lease, unit or outside section boundary line.)

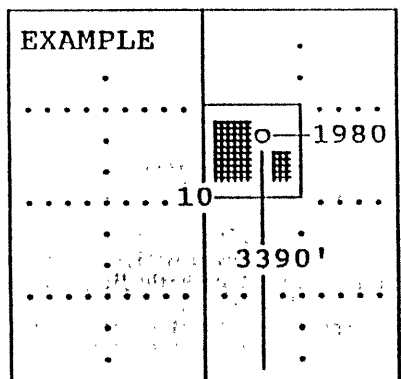
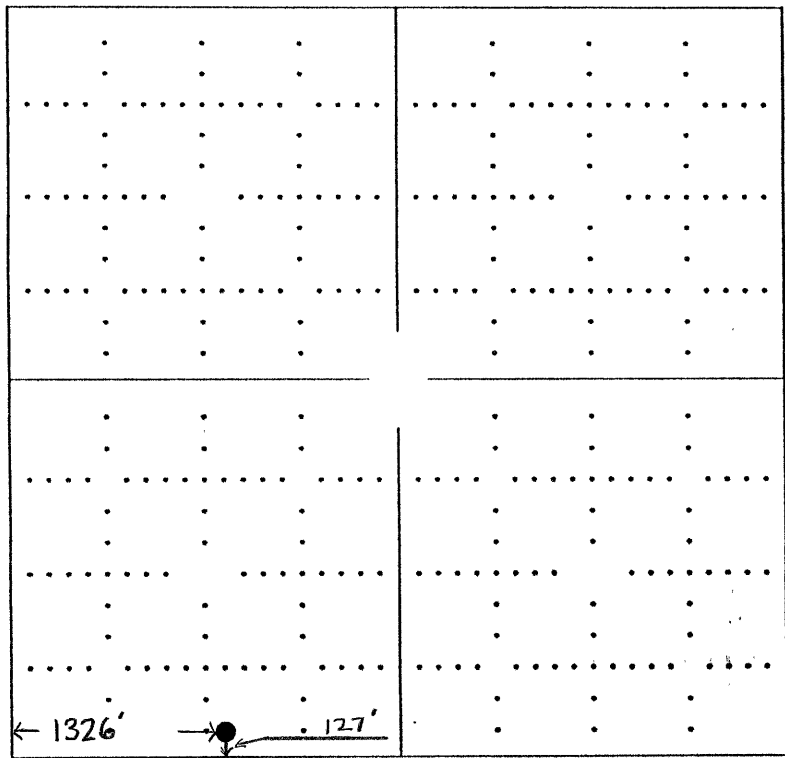

SEWARD CO.

In plotting the proposed location of the well, you must show:

- 1) The manner in which you are using the depicted plat by identifying section lines, i.e. 1 section, 1 section with 8 surrounding sections, 4 sections, etc.;
- 2) the distance of the proposed drilling location from the section's south/north and east/west; and
- 3) the distance to the nearest lease, unit or outside section boundary line.