

STATE CORPORATION COMMISSION OF KANSAS
OIL & GAS CONSERVATION DIVISION

WELL COMPLETION OR RECOMPLETION FORM
ACO-1 WELL HISTORY

DESCRIPTION OF WELL AND LEASE

Operator: license # 9123
name Diamond Shamrock Exploration Company
address P.O. Box 400
City State Zip Amarillo, Texas 79188

Operator Contact Person Todd Lovett
Phone 806-378-3848

Contractor: license # 5418
name Allen Drilling Company

Wellsite Geologist Dave TenEyck
Phone 806-378-3682

PURCHASER

Designate Type of Completion
 New Well Re-Entry Workover
 Oil SWD Temp Abd
 Gas Inj Delayed Comp.
 Dry Other (Core, Water Supply etc.)

If OWWO: old well info as follows:
 Operator
 Well Name
 Comp. Date Old Total Depth

WELL HISTORY

Drilling Method: Mud Rotary Air Rotary Cable
 11-28-84 12-05-84 12-06-84
 Spud Date Date Reached TD Completion Date
 3985
 Total Depth PBSD
 Amount of Surface Pipe Set and Cemented at 328 feet
 Multiple Stage Cementing Collar Used? Yes No
 If Yes, Show Depth Set feet
 If alternate 2 completion, cement circulated
 from feet depth to w/ SX cmt

API NO. 15 - 179-20,774 -00-00
 County Sheridan
 SE NE SW Sec 35 Twp 7S Rge 26W
 (location)
 1650 South
 East
 2970 West
 (Note: locate well in section plat below)

Lease Name John C. Scheetz "A" Well# 1
 Field Name
 Producing Formation
 Elevation: Ground 2541 KB 2546 (est)

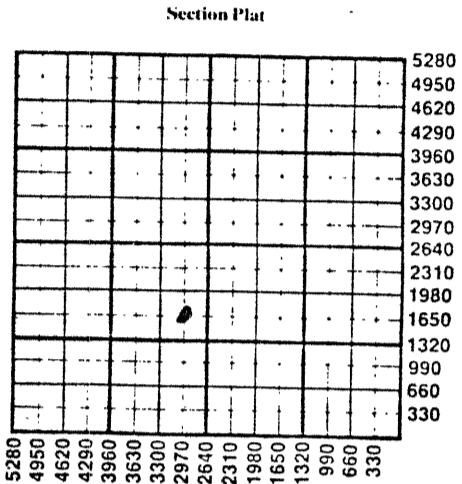

WATER SUPPLY INFORMATION

Source of Water:
 Division of Water Resources Permit #
 Groundwater Ft North From Southeast Corner and
 (Well) Ft West From Southeast Corner o
 Sec Twp Rge East West
 Surface Water Ft North From Southeast Corner and
 (Stream, Pond etc.) Ft West From Southeast Corner
 Sec Twp Rge East West
 Other (explain)
 (purchased from city, R.W.D.#)
 Disposition of Produced Water: Disposal
 Repressuring
 Docket #

INSTRUCTIONS: This form shall be completed in duplicate and filed with the Kansas Corporation Commission, 200 Colorado Derby Building, Wichita, Kansas 67202, within 90 days after completion or recompletion of any well. Rules 82-3-130 and 82-3-107 apply.
 Information on side two of this form will be held confidential for a period of 12 months if requested in writing and submitted with the form. See rule 82-3-107 for confidentiality in excess of 12 months.
 One copy of all wireline logs and drillers time log shall be attached with this form. Submit CP-4 form with all plugged wells. Submit CP-111 form with all temporarily abandoned wells.

All requirements of the statutes, rules, and regulations promulgated to regulate the oil and gas industry have been fully complied with and the statements herein are complete and correct to the best of my knowledge.

Signature Peggy Rogers
 Title Drilling & Production Assistant Date 1-10-85
 Subscribed and sworn to before me this 15 day of January 19 85
 Notary Public Dale Jones
 Date Commission Expires 5-26-85

JAN 30 1985
 JAN 30 1985
 CONSERVATION DIVISION
 WICHITA, KANSAS

K.C.C. OFFICE USE ONLY
 F Letter of Confidentiality Attached
 C Wireline Log Received
 C Drillers Timelog Received
Distribution
 KCC SWD Rep NGPA
 KGS Plug Other
 (Specify)

Sec. 35 Twp. 7 Rge. 26W

WELL LOG

INSTRUCTIONS: Show important tops and base of formations penetrated. Detail all cores. Report all drill stem test giving interval tested, time tool open and closed, flowing and shut-in pressures, whether shut-in pressure reached static level, hydrostatic pressures, bottom hole temperature, fluid recovery, and flow rates if gas to surface during test. Attach extra sheet if more space is needed. Attach copy of log.

Drill Stem Tests Taken Yes No
Samples Sent to Geological Survey Yes No
Cores Taken Yes No

Formation Description
 Log Sample

DST #1 - 30/60/30/60. IFP 22-22, ISIP 685, FFP 27-29
FSIP 674. Rec 25' (2% oil, 18 % water, 80% mud).

DST #2 - 3795-3816 - 30/60/30/60. First open fair
blow build to strong off btm of bucket. FP 41/91,
SIP 1255. Second open same as first. FP 111/148,
SIP 1225. Rec 345' muddy salt water in pipe.

DST #3 - 3817-28' - 30/60/30/60. First open strong
blow off btm of bucket in 2 mins. FP 114/490, SIP
1283. Second open same as first. FP 525/777, SIP
1283. Rec 1040' salt water, no oil or gas.

Name	Top	Bottom
Stone Corral	2199	
Heebner Shale	3693	
Toronto Ls.	3715	
Lansing	3731	
BKC	3945	
T.D.	3985	

CASING RECORD <input type="checkbox"/> new <input type="checkbox"/> used							
Report all strings set - conductor, surface, intermediate, production, etc.							
Purpose of string	size hole drilled	size casing set (in O.D.)	weight lbs/ft.	setting depth	type of cement	# sacks used	type and percent additives
.....Surface.....	..12-1/4...	...8-5/8...	..24....	...328....	Class "A"	...250....	2% gel, 3% cc
.....
.....
.....
PERFORATION RECORD				Acid, Fracture, Shot, Cement Squeeze Record			
shots per foot	specify footage of each interval perforated			(amount and kind of material used)			Depth
.....
.....
.....
.....
TUBING RECORD				Liner Run <input type="checkbox"/> Yes <input type="checkbox"/> No			
size	set at	packer at					
.....					
Date of First Production	Producing method <input type="checkbox"/> flowing <input type="checkbox"/> pumping <input type="checkbox"/> gas lift <input type="checkbox"/> Other (explain)						
.....							
Estimated Production Per 24 Hours	Oil	Gas	Water	Gas-Oil Ratio	Gravity		
	Bbls	MCF	Bbls	CFPB			

Disposition of gas: vented
 sold
 used on lease

METHOD OF COMPLETION
 open hole perforation
 other (specify)

PRODUCTION INTERVAL

Dually Completed.
 Commingled