

AUG 18 2003

8-18-2003

Form C-1
September 1999

For KCC Use: 8.23.03
Effective Date: 8.23.03
District #: 4
SGA? Yes No

KANSAS CORPORATION COMMISSION
OIL & GAS CONSERVATION DIVISION
NOTICE OF INTENT TO DRILL

CONSERVATION DIVISION
WICHITA, KS

Form must be Typed
Form must be Signed
All blanks must be Filled

Must be approved by KCC five (5) days prior to commencing well

Apt 8's of

Expected Spud Date October 1, 2003
month day year

Spot NE SE NE Sec. 8 Twp. 7 S. R. 39 East West
1522 feet from 1 N (circle one) Line of Section
334 feet from E (circle one) Line of Section

OPERATOR: License# 33019
Name: Rosewood Resources, Inc.
Address: 2711 N. Haskell Ave. - Suite 2800, LB #22
City/State/Zip: Dallas, Texas 75204
Contact Person: Jenni Trietsch
Phone: 214-756-6607

Is SECTION Regular Irregular?

(Note: Locate well on the Section Plat on reverse side)

CONTRACTOR: License# 8273
Name: Excell Drilling Co.

County: Sherman

Lease Name: Bowman Well #: 1-8

Field Name: Goodland

Is this a Prorated / Spaced Field? Yes No

Target Formation(s): Niobrara

Nearest Lease or unit boundary: 334'

Ground Surface Elevation: 3585 feet MSL

Water well within one-quarter mile: Yes No

Public water supply well within one mile: Yes No

Depth to bottom of fresh water: 287'

Depth to bottom of usable water: 300'

Surface Pipe by Alternate: xxx 1 2

Length of Surface Pipe Planned to be set: 350'

Length of Conductor Pipe required: n/a None

Projected Total Depth: 1,400'

Formation at Total Depth: Niobrara

Water Source for Drilling Operations:

Well Farm Pond Other xxx

DWR Permit #: _____

(Note: Apply for Permit with DWR)

Will Cores be taken? Yes No

If Yes, proposed zone: _____

Well Drilled For:	Well Class:	Type Equipment:
<input type="checkbox"/> Oil	<input type="checkbox"/> Enh Rec	<input type="checkbox"/> Infield
<input checked="" type="checkbox"/> Gas	<input type="checkbox"/> Storage	<input checked="" type="checkbox"/> Mud Rotary
<input type="checkbox"/> OWWO	<input type="checkbox"/> Disposal	<input type="checkbox"/> Air Rotary
<input type="checkbox"/> Seismic;	# of Holes	<input type="checkbox"/> Cable
<input type="checkbox"/> Other	<input type="checkbox"/> Other	

If OWWO: old well information as follows:

Operator: _____

Well Name: _____

Original Completion Date: _____ Original Total Depth: _____

Directional, Deviated or Horizontal wellbore? Yes No

If Yes, true vertical depth: _____

Bottom Hole Location: _____

KCC DKT #: _____

AFFIDAVIT

The undersigned hereby affirms that the drilling, completion and eventual plugging of this well will comply with K.S.A. 55-101, et. seq.
It is agreed that the following minimum requirements will be met:

1. Notify the appropriate district office **prior** to spudding of well;
2. A copy of the approved notice of intent to drill **shall be** posted on each drilling rig;
3. The minimum amount of surface pipe as specified below **shall be set** by circulating cement to the top; in all cases surface pipe **shall be set** through all unconsolidated materials plus a minimum of 20 feet into the underlying formation.
4. If the well is dry hole, an agreement between the operator and the district office on plug length and placement is necessary **prior to plugging**;
5. The appropriate district office will be notified before well is either plugged or production casing is cemented in;
6. If an ALTERNATE II COMPLETION, production pipe shall be cemented from below any usable water to surface within **120 days** of spud date. **In all cases, NOTIFY district office** prior to any cementing.

I hereby certify that the statements made herein are true and to the best of my knowledge and belief.

Date: August 15, 2003 Signature of Operator or Agent: Jenni Trietsch Title: Senior Accountant

For KCC Use ONLY

API # 15 - 181-20334-00-00

Conductor pipe required NONE feet

Minimum surface pipe required 350 feet per Alt. 1

Approved by: RJP 8-18-03

This authorization expires: 2-18-04
(This authorization void if drilling not started within 6 months of effective date.)

Spud date: _____ Agent: _____

Remember to:

- File Drill Pit Application (form CDP-1) with Intent to Drill;
- File Completion Form ACO-1 within 120 days of spud date;
- File acreage attribution plat according to field proration orders;
- Notify appropriate district office 48 hours prior to workover or re-entry;
- Submit plugging report (CP-4) after plugging is completed;
- Obtain written approval before disposing or injecting salt water.

8
7
390

IN ALL CASES PLOT THE INTENDED WELL ON THE PLAT BELOW

Plat of acreage attributable to a well in a prorated or spaced field

If the intended well is in a prorated or spaced field, please fully complete this side of the form. If the intended well is in a prorated or spaced field complete the plat below showing that the well will be properly located in relationship to other wells producing from the common source of supply. Please show all the wells and within 1 mile of the boundaries of the proposed acreage attribution unit for gas wells and within 1/2 mile of the boundaries of the proposed acreage attribution unit for oil wells.

API No. 15 - _____
 Operator: Rosewood Resources, Inc.
 Lease: Bowman
 Well Number: 1-8
 Field: Goodland

Location of Well: County: Sherman

 1522 _____ feet from ~~S~~ N (circle one) Line of Section
 334 _____ feet from ~~E~~ W (circle one) Line of Section
 Sec. 8 Twp. 7 S. R. 39 East West

Number of Acres attributable to well: 160
 QTR / QTR / QTR of acreage: NE - SE - NE

Is Section Regular or _____ Irregular

If Section is Irregular, locate well from nearest corner boundary.
 Section corner used: ___NE ___NW ___SE ___SW

PLAT

(Show location of the well and shade attributable acreage for prorated or spaced wells.)
(Show footage to the nearest lease or unit boundary line.)

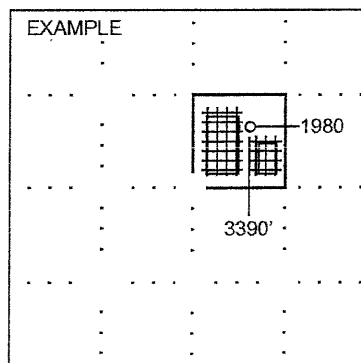
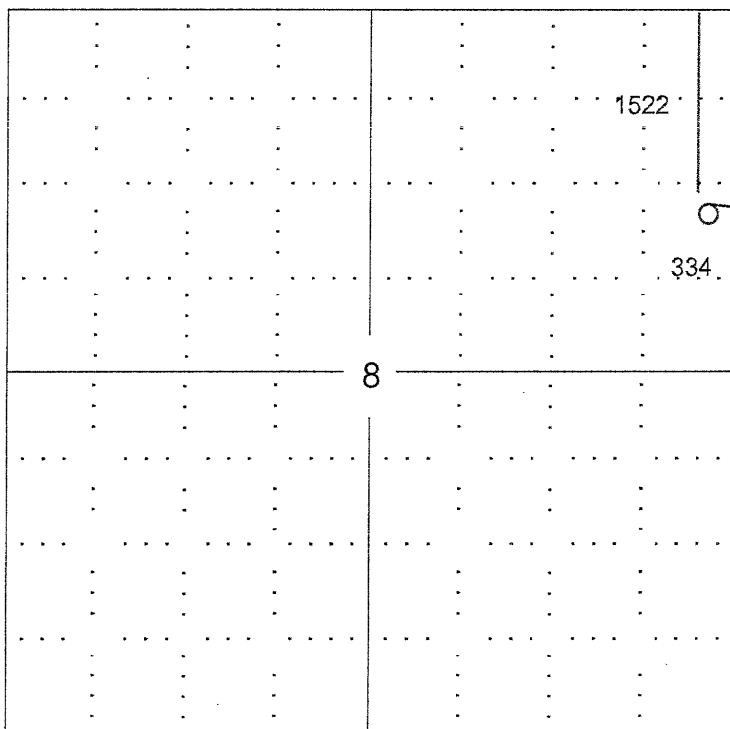

NOTE: In all cases locate the spot of the proposed drilling locaton.

In plotting the proposed location of the well, you must show:

1. The manner in which you are using the depicted plat by identifying section lines, i.e. 1 section, 1 section with 8 surrounding sections, 4 sections, etc.
2. The distance of the proposed drilling location from the section's south / north and east / west.
3. The distance to the nearest lease or unit boundary line.
4. If proposed location is located within a prorated or spaced field a certificate of acreage attribution plat must be attached: (C0-7 for oil wells; CG-8 for gas wells).