

15-065-21128-00-00

STATE OF KANSAS
STATE CORPORATION COMMISSION

Give All Information Completely
Make Required Affidavit
Mail or Deliver Report to:
Conservation Division
State Corporation Commission
212 North Market, Insurance Bldg.
Wichita, Kansas

WELL PLUGGING RECORD

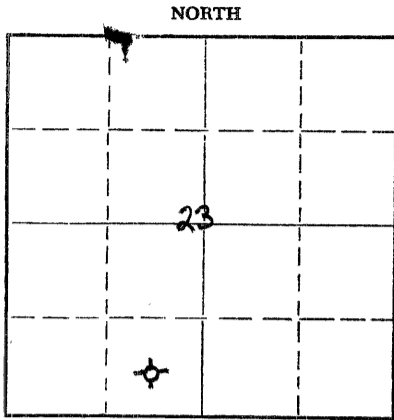

Locate well correctly on above
Section Plat

Graham County, Sec. 23 Twp. 7S Rge. 23W (X) (W)
Location as "NE/CNW/SW" or footage from lines C SE SW
Lease Owner John O. Farmer, Inc.
Lease Name JoMar Well No. #1
Office Address Box 352, Russell, KS 67665
Character of Well (completed as Oil, Gas or Dry Hole) Dry Hole
Date well completed 6-20-79 19
Application for plugging filed Yes 19
Application for plugging approved 19
Plugging commenced 19
Plugging completed 6:30 a.m., 6-20-79 19
Reason for abandonment of well or producing formation

If a producing well is abandoned, date of last production 19
Was permission obtained from the Conservation Division or its agents before plugging was commenced? Yes

Name of Conservation Agent who supervised plugging of this well Gilbert Balthazor
Producing formation Depth to top Bottom Total Depth of Well Feet
Show depth and thickness of all water, oil and gas formations.

OIL, GAS OR WATER RECORDS

CASING RECORD

| FORMATION | CONTENT | FROM | TO | SIZE | PUT IN | PULLED OUT |
|-----------|---------|------|----|------|--------|------------|
| | | | | | | |
| | | | | | | |
| | | | | | | |
| | | | | | | |
| | | | | | | |
| | | | | | | |
| | | | | | | |
| | | | | | | |
| | | | | | | |

Describe in detail the manner in which the well was plugged, indicating where the mud fluid was placed and the method or methods used in introducing it into the hole. If cement or other plugs were used, state the character of same and depth placed, from feet to feet for each plug set.

Plug #1 @ 900' w/70 sacks cement
Plug #2 @ 200' w/20 sacks cement
Plug #3 @ 40' w/10 sacks cement

RECEIVED
STATE CORPORATION COMMISSION

JUN 24 1979

CONSERVATION DIVISION
Wichita, Kansas

6/25/79

(If additional description is necessary, use BACK of this sheet)
Name of Plugging Contractor John O. Farmer, Inc.
Address Box 352, Russell, KS 67665

STATE OF Kansas, COUNTY OF Russell, ss.
John O. Farmer (employee of owner) or (owner or operator) of the above-described well, being first duly sworn on oath, says: That I have knowledge of the facts, statements, and matters herein contained and the log of the above-described well as filed and that the same are true and correct. So help me God.

(Signature) John O. Farmer
Box 352, Russell, KS 67665
(Address)

SUBSCRIBED AND SWORN TO before me this 22nd day of June, 1979

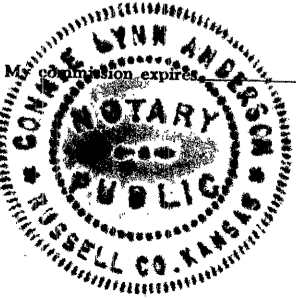

March 29, 1983

Connie Lynn Anderson
Notary Public.

KANSAS DRILLERS LOG

IMPORTANT
 Kans. Geo. Survey request
 samples on this well.

S. 23 T. 7 R. 23 ^{NE}/_{SW}

API No. 15 — 065 — 21,128 — 00 — 00
County Number

Loc. C SE SW
 County Graham

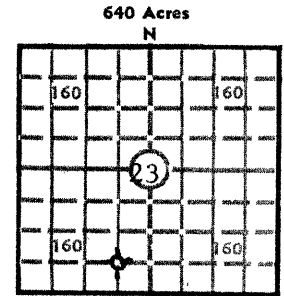

Locate well correctly
 Elev.: Gr. 2278'
 DF 2281' KB 2283'

Operator John O. Farmer, Inc.
 Address Box 352 Russell, Kansas 67665
 Well No. #1 Lease Name Jo Mar
 Footage Location 660 feet from (N) (S) line 660 feet from (E) (W) line
 Principal Contractor John O. Farmer, Inc. Geologist Sam Farmer
 Spud Date 6-13-79 Total Depth 3749' P.B.T.D.
 Date Completed 6-20-79 Oil Purchaser

CASING RECORD

Report of all strings set — surface, intermediate, production, etc.

| Purpose of string | Size hole drilled | Size casing set (in O.D.) | Weight lbs/ft. | Setting depth | Type cement | Sacks | Type and percent additives |
|-------------------|-------------------|---------------------------|----------------|---------------|-------------|-------|----------------------------|
| Surface | 12-1/4 | 8-5/8 | 28 | 202' | Common | 170 | |
| | | | | | | | |
| | | | | | | | |

LINER RECORD

PERFORATION RECORD

| Top, ft. | Bottom, ft. | Sacks cement | Shots per ft. | Size & type | Depth interval |
|----------|-------------|--------------|---------------|-------------|----------------|
| | | | | | |
| | | | | | |

TUBING RECORD

| Size | Setting depth | Packer set at |
|------|---------------|---------------|
| | | |

ACID, FRACTURE, SHOT, CEMENT SQUEEZE RECORD

Amount and kind of material used

RECEIVED
 STATE CORPORATION COMMISSION
 DEPT. OF REVENUE
 JUN 25 1979
 CONSERVATION DIVISION
 WICHITA, KANSAS

INITIAL PRODUCTION

6/25/79

Date of first production _____ Producing method (flowing, pumping, gas lift, etc.) _____

| RATE OF PRODUCTION PER 24 HOURS | Oil | Gas | Water | Gas-oil ratio |
|---------------------------------|-----|-----|-------|---------------|
| | | | | |

Disposition of gas (vented, used on lease or sold) _____ Producing interval (s) _____

INSTRUCTIONS: As provided in KCC Rule 82-2-125, within 90 days after completion of a well, one completed copy of this Drillers Log shall be transmitted to the State Geological Survey of Kansas, 4150 Monroe Street, Wichita, Kansas 67209. Copies of this form are available from the Conservation Division, State Corporation Commission, 3830 So. Meridian (P.O. Box 17027), Wichita, Kansas 66217. Phone AC 316-522-2206. If confidential custody is desired, please note Rule 82-2-125. Drillers Logs will be on open file in the Oil and Gas Division, State Geological Survey of Kansas, Lawrence, Kansas 66044.

DESIGNATE TYPE OF COMP.: OIL, GAS, DRY HOLE, SWDW, ETC.:

Operator

John O. Farmer, Inc.

Well No.

#1

Lease Name

JoMar

Dry Hole

S 23 T 7S R 23W ^{EX}_W

WELL LOG

Show all important zones of porosity and contents thereof; cored intervals, and all drill-stem tests, including depth interval tested, cushion used, time tool open, flowing and shut-in pressures, and recoveries.

SHOW GEOLOGICAL MARKERS LOGS RUN, OR OTHER DESCRIPTIVE INFORMATION.

| FORMATION DESCRIPTION, CONTENTS, ETC. | TOP | BOTTOM | NAME | DEPTH |
|---|------|--------|-----------|--------------|
| Clay Sand | -0- | 40 | Anhydrite | 1936 (+347) |
| Blue Shale | 40 | 202 | Heebner | 3502 (-1219) |
| Shale & Sand | 202 | 1450 | Toronto | 3528 (-1245) |
| Shale | 1450 | 1489 | Lansing | 3542 (-1259) |
| Sand | 1489 | 1699 | B/KC | 3742 (-1459) |
| Red Bed | 1699 | 1935 | | |
| Anhydrite | 1935 | 1968 | | |
| Shale & Shells | 1968 | 2215 | | |
| Shale & Lime | 2215 | 3525 | | |
| Lime | 3525 | 3749 | | |
| <p>DST #1 3640-3710 Tool open 30-45-60-60 with strong blow. Rec: 1340' saltwater FP: 148-675 BHP: 1114-989 Temp: 108</p> | | | | |

USE ADDITIONAL SHEETS, IF NECESSARY, TO COMPLETE WELL RECORD.

Date Received

John O. Farmer

 Signature

 President
 Title

June 22, 1979

Date