

15-065-21043-00-00

WELL PLUGGING RECORD

Give All Information Completely  
Make Required Affidavit  
Mail or Deliver Report to:  
Conservation Division  
State Corporation Commission  
212 North Market, Insurance Bldg.  
Wichita, Kansas

NORTH

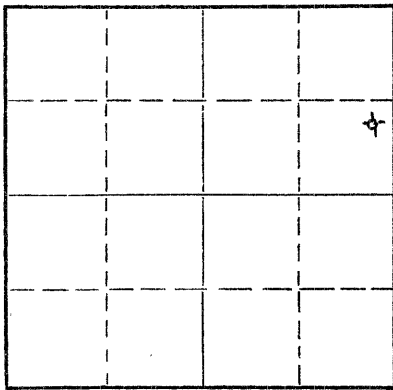

Locate well correctly on above  
Section Plat

Graham County. Sec. 24 Twp. 7S Rge. 23W (E) (W)  
Location as "NE/CNW/SW" or footage from lines NE SE NE  
Lease Owner John O. Farmer, Inc.  
Lease Name Trexler Well No. #1  
Office Address Box 352 Russell, Kansas 67665  
Character of Well (completed as Oil, Gas or Dry Hole) Dry Hole  
Date well completed 8-29-78 19  
Application for plugging filed yes 19  
Application for plugging approved 19  
Plugging commenced 19  
Plugging completed 1:00 A. M. 8-29-78 19  
Reason for abandonment of well or producing formation \_\_\_\_\_

If a producing well is abandoned, date of last production \_\_\_\_\_ 19  
Was permission obtained from the Conservation Division or its agents before plugging was commenced? Yes

Name of Conservation Agent who supervised plugging of this well Gilbert Balthazor  
Producing formation \_\_\_\_\_ Depth to top \_\_\_\_\_ Bottom \_\_\_\_\_ Total Depth of Well \_\_\_\_\_ Feet  
Show depth and thickness of all water, oil and gas formations.

OIL, GAS OR WATER RECORDS

CASING RECORD

FORMATION	CONTENT	FROM	TO	SIZE	PUT IN	PULLED OUT

Describe in detail the manner in which the well was plugged, indicating where the mud fluid was placed and the method or methods used in introducing it into the hole. If cement or other plugs were used, state the character of same and depth placed, from \_\_\_\_\_ feet to \_\_\_\_\_ feet for each plug set.

Plug #1 900' w/70 sx. Cement  
Plug #2 200' w/20 sx. Cement  
Plug #3 40' w/10 sx. Cement

RECEIVED  
STATE CORPORATION COMMISSION

SEP 05 1978 9/5/78

CONSERVATION DIVISION  
Wichita, Kansas

(If additional description is necessary, use BACK of this sheet)  
Name of Plugging Contractor John O. Farmer, Inc.  
Address Box 352 Russell, Kansas 67665

STATE OF Kansas, COUNTY OF Russell, ss.  
John O. Farmer (employee of owner) or (owner or operator) of the above-described well, being first duly sworn on oath, says: That I have knowledge of the facts, statements, and matters herein contained and the log of the above-described well as filed and that the same are true and correct. So help me God.

(Signature) John O. Farmer  
Box 352 Russell, Kansas 67665  
(Address)

SUBSCRIBED AND SWORN TO before me this 1st day of September 19 78

My commission expires February 15, 1979  
Helen Carlson Notary Public.

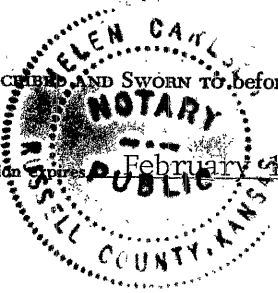

**KANSAS DRILLERS LOG**

API No. 15 — 065 — 21043-00-00  
 County Number

S. 24 T. 7S R. 23W <sup>E</sup>/<sub>W</sub>  
 Loc. NE SE NE  
 County Graham

Operator  
John O. Farmer, Inc.

Address  
Box 352 Russell, Kansas 67665

Well No. #1 Lease Name Trexler

Footage Location  
990' feet from (N) (S) line 330' feet from (E) (W) line

Principal Contractor John O. Farmer, Inc. Geologist Francis Whisler

Spud Date 8-22-78 Total Depth 3725' P.B.T.D.

Date Completed 8-29-78 Oil Purchaser

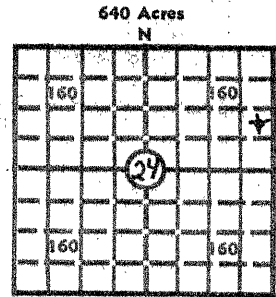

Locate well correctly  
 Elev.: Gr. 2260'  
 DF 2263' KB 2265'

**CASING RECORD**

Report of all strings set — surface, intermediate, production, etc.

Purpose of string	Size hole drilled	Size casing set (in O.D.)	Weight lbs/ft.	Setting depth	Type cement	Sacks	Type and percent additives
Surface	12 1/4"	8-5/8"	26	219'	Common	170	

**LINER RECORD**

**PERFORATION RECORD**

Top, ft.	Bottom, ft.	Sacks cement	Shots per ft.	Size & type	Depth interval

**TUBING RECORD**

Size	Setting depth	Packer set at

**ACID, FRACTURE, SHOT, CEMENT SQUEEZE RECORD**

Amount and kind of material used

RECEIVED  
 STATE CORPORATION COMMISSION  
 SEP 05 1978 9/5/78  
 CONSERVATION DIVISION  
 Wichita, Kansas

**INITIAL PRODUCTION**

Date of first production \_\_\_\_\_ Producing method (flowing, pumping, gas lift, etc.) \_\_\_\_\_

RATE OF PRODUCTION PER 24 HOURS	Oil	Gas	Water	Gas-oil ratio
	bbbls.	MCF	bbbls.	CFPB

Disposition of gas (vented, used on lease or sold) \_\_\_\_\_ Producing interval (s) \_\_\_\_\_

INSTRUCTIONS: As provided in KCC Rule 82-2-125, within 90 days after completion of a well, one completed copy of this Drillers Log shall be transmitted to the State Geological Survey of Kansas, 4150 Monroe Street, Wichita, Kansas 67209. Copies of this form are available from the Conservation Division, State Corporation Commission, 3830 So. Meridian (P.O. Box 17027), Wichita, Kansas 66217. Phone AC 316-522-2206. If confidential custody is desired, please note Rule 82-2-125. Drillers Logs will be on an open file in the Oil and Gas Division, State Geological Survey of Kansas, Lawrence, Kansas 66044.

DESIGNATE TYPE OF COMP.: OIL, GAS, DRY HOLE, SWDW, ETC.:

Operator

John O. Farmer, Inc.

Well No.

#1

Lease Name

Trexler

Dry Hole

S 24 T 7S R 23W<sup>E</sup><sub>W</sub>

**WELL LOG**

Show all important zones of porosity and contents thereof; cored intervals, and all drill-stem tests, including depth interval tested, cushion used, time tool open, flowing and shut-in pressures, and recoveries.

SHOW GEOLOGICAL MARKERS, LOGS RUN, OR OTHER DESCRIPTIVE INFORMATION.

FORMATION DESCRIPTION, CONTENTS, ETC.	TOP	BOTTOM	NAME	DEPTH
Shale	-0-	220	Anhydrite	1908' (+357)
Shale & Sand	220	1460	Heebner	3475' (-1210)
Sand	1460	1660	Toronto	3499' (-1234)
Red Bed	1660	1908	Lansing	3517' (-1252)
Anhydrite	1908	1932	B/KC	3715' (-1405)
Shale & Shells	1932	2475	RTD .	3725'
Shale & Lime	2475	3420		
Lime & Shale	3420	3515		
Lime	3515	3725		

DST #1 3650' to 3685' "I" & "J" zones  
 Tool open 45-45-30-30; weak blow 40 min.  
 2nd no blow  
 Rec: 30' slightly oil cut mud  
 IFP: 43-43 FFP: 54-54  
 IBHP: 491 FBHP: 65

USE ADDITIONAL SHEETS, IF NECESSARY, TO COMPLETE WELL RECORD.

Date Received

*John O. Farmer*  
 Signature

President

Title

September 1, 1978

Date