

STATE OF KANSAS
STATE CORPORATION COMMISSION

Give All Information Completely
Make Required Affidavit
Mail or Deliver Report to:
Conservation Division
State Corporation Commission
211 No. Broadway
Wichita, Kansas

15-179-00179-00-00

WELL PLUGGING RECORD

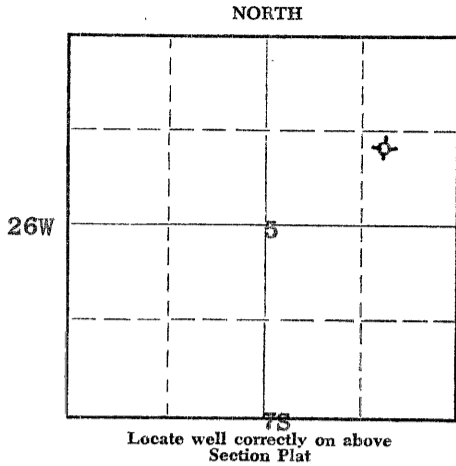

Sheridan County. Sec. 5 Twp. 7S Rge. 26 (E) W (W)
Location as "NE/CNW/SW" or footage from lines NW/4 SE/4 NE/4
Lease Owner Osage Oil & Gas Co.
Lease Name BANGLE Well No. 1
Office Address 531 Petroleum Building, Wichita, Kansas
Character of Well (completed as Oil, Gas or Dry Hole) Dry Hole
Date well completed 4-28-19 56
Application for plugging filed 4-28-19 56
Application for plugging approved 4-28-19 56
Plugging commenced 4-28-19 56
Plugging completed 4-28-19 56
Reason for abandonment of well or producing formation Dry and abandoned

If a producing well is abandoned, date of last production ----- 19
Was permission obtained from the Conservation Division or its agents before plugging was commenced? yes

Name of Conservation Agent who supervised plugging of this well Eldon Petty, Box 326, Hays, Kansas
Producing formation ----- Depth to top ----- Bottom ----- Total Depth of Well 4349 Feet
Show depth and thickness of all water, oil and gas formations.

OIL, GAS OR WATER RECORDS

CASING RECORD

FORMATION	CONTENT	FROM	TO	SIZE	PUT IN	PULLED OUT
				8-5/8" surf. csg.		
				cemented at 275.40'		
				w/150 sacks cement,		
				2 Calcium Chloride.		

Describe in detail the manner in which the well was plugged, indicating where the mud fluid was placed and the method or methods used in introducing it into the hole. If cement or other plugs were used, state the character of same and depth placed, from ----- feet to ----- feet for each plug set.

Stirred pit. Filled hole with heavy mud to 260'. Set bottom plug w/1/2 sack hulls 15 sacks cement. Filled hole to 40' w/ 1/2 sack hulls 10 sacks cement.

RECEIVED
STATE CORPORATION COMMISSION
MAY 12 1956
CONSERVATION DIVISION
Wichita, Kansas

572-56

(If additional description is necessary, use BACK of this sheet)
Name of Plugging Contractor Heathman-Seeligson Drilling Co.
Address 1015 E. Second, Wichita, Kansas

STATE OF Kansas, COUNTY OF Sedgwick, ss.
H. D. Shreve (employee of owner) or (owner or operator) of the above-described well, being first duly sworn on oath, says: That I have knowledge of the facts, statements, and matters herein contained and the log of the above-described well as filed and that the same are true and correct. So help me God.

(Signature) *[Signature]*
1015 E. Second, Wichita, Kansas (Address)

SUBSCRIBED AND SWORN TO before me this 6 day of May, 19 56

Patricia J. Lamkin

My commission expires April 3, 1960

Notary Public.

PLUGGING
FILE SEC 5 T 7 R 26W
BOOK PAGE 57 LINE 37

15-179-00175-00-00

DRILLERS' LOG

NAME: BANGLE #1 DATE SPUDDED: 4-15-56
 LOCATION: NW/4 SE/4 NE/4 Sec.5-78-26W ROTARY COMPLETED: 4-28-56
 Sheridan County, Kansas
 OPERATOR: Osage Oil & Gas Co. ELEVATION: 2617 GR
 2619 DF
 2622 KB
 CONTRACTOR: Heathman-Seeligson Drilling Co. ROTARY TOTAL DEPTH: 4349'
 SURFACE CASING: 3-5/8" cemented at 275.40' w/
 150 sacks cement, 2 Calcium
 Chloride. Cement Circulated.

OIL STRING: None run - Dry and abandoned 4-28-56

DRILL STEM TESTS

DST #1, 3826-43 open 1/2 hr., rec.
 4' mud. BHP-900#.
 DST #2, 3843-55 open 1 hr., rec.
 30' mud. BHP/1385#.
 DST #3, 3858-88 open 45 min. rec.
 40' mud w/few specks of oil.
 BHP-740#.
 DST #4, 3886-3906, open 1/2 hr.
 rec. 25' mud. BHP-680#.
 DST #5, 3959-4028 open 2 hrs., fail
 blow, rec. 2100' watery mud.
 BHP-1225#, IFP-100#, FFP-1070#.
 DST #6, 4139-4166 open 1 hr. weak
 blow, rec. 5' mud. BHP-0#.
 DST #7, 4199-4231, misrun
 Retested from 4139-4231, open
 1 hr. rec. 12' mud. BHP-120#.

GEOLOGICAL TOPS (KB)

Anhydrite	2280 (/342)
Heebner	3758 (-1136)
Lansing	3805 (-1183)
B. Kansas City	4016 (-1394)
Mississippian	4320 (-1698)
R.T.D.	4349

L O G

(Figures indicate bottom of formation)

Shale & Sand	0 - 275
Shale & Shells	1200
Shale & Sand	1335
Shale	1430
Sand	1480
Shale & Red Bed	1818
Blain Anhydrite	1860
Shale & Red Bed	2300
Anhydrite	2330
Shale & Shells	2700
Shale & Lime	3810
Lime	3906
Cherty Lime	3965
Shale & Lime	4197
Shale, Lime & Sand	4231
Shale & Lime	4278
Shale, Lime & Chert	4330
Lime & Chat	4349

The undersigned, H. D. Shreve, hereby certifies that the above log is a true and correct log of the formations encountered in drilling the above noted well as reflected by the Daily Drilling Report.

HEATHMAN- SEELIGSON DRILLING CO.

By: _____

Subscribed and sworn to before me the 7th day of May, 1956.

Notary Public

My commission expires: April 3, 1960

RECEIVED
STATE CORPORATION COMMISSION

MAY 12 1956

5-12-56

CONSERVATION DIVISION
Wichita, Kansas

PLUGGING
 FILE SEC 5 T 7 R 26W
 BOOK PAGE 57 LINE 37