

15-179-00130-00-00

STATE OF KANSAS
STATE CORPORATION COMMISSION

Give All Information Completely
Make Required Affidavit
Mail or Deliver Report to:
Conservation Division
State Corporation Commission
211 No. Broadway
Wichita, Kansas

WELL PLUGGING RECORD

NORTH

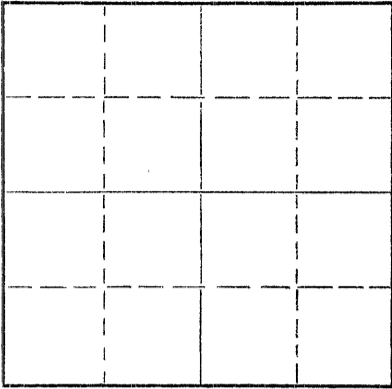

Locate well correctly on above
Section Plat

Sheridan County. Sec. 12 Twp. 7S Rge. (E) 26 (W)
Location as "NE/CNW $\frac{1}{2}$ SW $\frac{1}{2}$ " or footage from lines NE NE NE
Lease Owner JOHN O. FARMER, INC.
Lease Name MORSE Well No. 1
Office Address Russell, Kansas
Character of Well (completed as Oil, Gas or Dry Hole) Dry
Date well completed 1/3 19 59
Application for plugging filed 1/3 19 59
Application for plugging approved 1/3 19 59
Plugging commenced 1/3 19 59
Plugging completed 1/3 19 59
Reason for abandonment of well or producing formation Dry

If a producing well is abandoned, date of last production _____ 19____
Was permission obtained from the Conservation Division or its agents before plugging was commenced? yes

Name of Conservation Agent who supervised plugging of this well Fabricius,
Producing formation _____ Depth to top _____ Bottom _____ Total Depth of Well 3920 Feet
Show depth and thickness of all water, oil and gas formations.

OIL, GAS OR WATER RECORDS

CASING RECORD

FORMATION	CONTENT	FROM	TO	SIZE	PUT IN	PULLED OUT
				8-5/8	270*	None

Describe in detail the manner in which the well was plugged, indicating where the mud fluid was placed and the method or methods used in introducing it into the hole. If cement or other plugs were used, state the character of same and depth placed, from _____ feet to _____ feet for each plug set.

First plug set at 600 feet with 20 sacks cement
Second plug set at 270 feet with 20 sacks cement
Third plug set at 40 feet with 10 sacks cement

RECEIVED
STATE CORPORATION COMMISSION
JAN 9 1959
CONSERVATION DIVISION
Wichita, Kansas

(If additional description is necessary, use BACK of this sheet)
Name of Plugging Contractor JOHN O. FARMER, INC. 1-9-59
Address Russell, Kansas

STATE OF Kansas, COUNTY OF Russell, ss.
I, John O. Farmer (owner or operator) of the above-described well, being first duly sworn on oath, says: That I have knowledge of the facts, statements, and matters herein contained and the log of the above-described well as filed and that the same are true and correct. So help me God.

(Signature) John O. Farmer
Russell, Kansas (Address)

SUBSCRIBED AND SWORN TO before me this 5th day of January, 1959

My commission expires October 11, 1962

Lucille Kennedy
Lucille Kennedy Notary Public.

PLUGGING
FILE SEC 12 T 7 R 26W
BOOK PAGE 10 LINE 17

OPERATOR JOHN O. FARMER, INC.ADDRESS Russell, Kansas15-179-00130-00-00
FORMATION RECORD

Give detailed description and thickness of all formations drilled through, contents of sand, whether dry, water, oil or gas.

FARM NAME MORSE WELL NO. 1 COUNTY Sheridan SEC. 12 TWP. 7S RGE. 26W

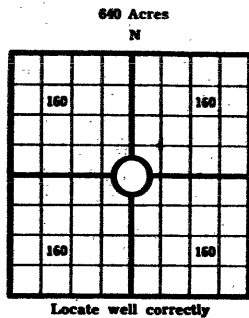

COUNTY Sheridan SEC. 12 TWP. 7S RGE. 26W
 COMPANY OPERATING John O. Farmer, Inc.
 OFFICE ADDRESS Russell, Kansas
 FARM NAME MORSE WELL NO. 1
 DRILLING STARTED 12/24, 1958 DRILLING FINISHED 1/3, 1959
 DATE OF FIRST PRODUCTION _____ COMPLETED _____
 WELL LOCATED NE 1/4 NE 1/4 NE 1/4 North of South
 Line and _____ ft. East of West Line of Quarter Section
 Elevation (Relative to sea level) DERRICK FLOOR 2565 GROUND 2562
 CHARACTER OF WELL (Oil, gas or dryhole) Dry

OIL OR GAS SANDS OR ZONES

Name	From	To	Name	From	To
1			4		
2			5		
3			6		

Perforating Record If Any

Shot Record

Formation	From	To	No. of Shots	Formation	From	To	Size of Shot

CASING RECORD

Amount Set						Amount Pulled		Packer Record	
Size	Wt.	Thds.	Make	Ft.	In.	Size	Length	Depth Set	Make
8-5/8				270					

Liner Record: Amount _____ Kind _____ Top _____ Bottom _____

CEMENTING AND MUDDING

Size	Amount Set		Sacks Cement	Chemical		Method of Cementing	Amount	Mudding Method	Results (See Note)
	Ft.	In.		Gal.	Make				
8-5/8	270		150						

Note: What method was used to protect sands if outer strings were pulled? _____

NOTE: Were bottom hole plugs used? _____ If so, state kind, depth set and results obtained _____

TOOLS USED

Rotary Tools were used from _____ feet to _____ Cable tools were used from _____ feet to _____ feet, and from _____ feet to _____ feet, and from _____ feet to _____ feet.

Type Rig _____

INITIAL PRODUCTION TEST

Describe initial test: whether by flow through tubing or casing or by pumping _____

Amount of Oil Production _____ bbls. Size of choke, if any _____ Length of test _____ Water

Production _____ bbls. Gravity of oil _____ Type of Pump if pump is used, describe _____

I, the undersigned, being first duly sworn upon oath, state that this well record is true, correct and complete according to the records of this office and to the best of my knowledge and belief.

John O. Farmer President
 Name and title of representative of company

Subscribed and sworn to before me this 5th day of January, 1959.
 My Commission expires 10/11/62
Lester R. ... Notary Public.

Formation	Top	Bottom	Formation	Top	Bottom
Shale	0	1010			
Shale & sand	1010	1590			
Shale & shells	1590	1640			
Shale & sand	1640	2040			
Shale (redbed)	2040	2166			
Anhydrite	2166	2208			
Shale & shells	2208	2660	ELEVATION:	RB	2567
Lime & shale	2660	3920	Anhydrite		2166
T.D.		3920	Heebner		3665
			Toronto		3687
			Lansing		3700
			B/KC		3910
			T.D.		3920

D & A

JAN 9 1959

REGISTRATION DIVISION
Topeka, Kansas

PLUGGING

FILE SEC. 12 T. 7 R. 26 W
BOOK PAGE 10 LINE 17