

For KCC Use:  
Effective Date: \_\_\_\_\_  
District # 4  
SGA?  Yes  No

KANSAS CORPORATION COMMISSION  
OIL & GAS CONSERVATION DIVISION

**NOTICE OF INTENT TO DRILL**

Must be approved by KCC five (5) days prior to commencing well

*"skidded rig"*

Form C-1

September 1999

Form must be Typed

Form must be Signed

All blanks must be Filled

Expected Spud Date \_\_\_\_\_  
month day year

OPERATOR: License# 30282  
Name: Lobo Production  
Address: 6715 Road 22  
City/State/Zip: Goodland, KS 67735  
Contact Person: John Sanders  
Phone: 785-899-5684

CONTRACTOR: License# Schall Drilling 32746  
Name: Stewart Bros Drilling 32765

Spot APPROX. W/2 W/2 SW  
SW - NW - SW Sec. 32 Twp. 7 S. R. 39  
 East  
 West  
1350 feet from S (circle one) Line of Section  
455 feet from E (circle one) Line of Section  
Is SECTION  Regular  Irregular?

(Note: Locate well on the Section Plat on reverse side)

County: Sherman

Lease Name: Schilders Well #: 5a-32

Field Name: Goodland Gas Field

Is this a Prorated / Spaced Field?  Yes  No

Target Information(s): Niobrara

Nearest Lease or unit boundary: 455'

Ground Surface Elevation: 3627.7 feet MSL

Water well within one-quarter mile:  Yes  No

Public water supply well within one mile:  Yes  No

Depth to bottom of fresh water: 250'

Depth to bottom of usable water: 300'

Surface Pipe by Alternate:  1  2

Length of Surface Pipe Planned to be set: 350'

Length of Conductor Pipe required: none

Projected Total Depth: 1200'

Producing Formation Target: 1000 - 1100'

Water Source for Drilling Operations:

Well  Farm Pond  Other City Water

DWR Permit #: \_\_\_\_\_

(Note: Apply for Permit with DWR )

Will Cores be taken?  Yes  No

If Yes, proposed zone: \_\_\_\_\_

Well Drilled For: Well Class: Type Equipment:  
 Oil  Enh Rec  Infield  Mud Rotary  
 Gas  Storage  Pool Ext.  Air Rotary  
 OWWO  Disposal  Wildcat  Cable  
 Seismic; # of Holes  Other  
 Other \_\_\_\_\_

If OWWO: old well information as follows:

Operator: \_\_\_\_\_

Well Name: \_\_\_\_\_

Original Completion Date: \_\_\_\_\_ Original Total Depth: \_\_\_\_\_

Directional, Deviated or Horizontal wellbore?  Yes  No

If Yes, true vertical depth: \_\_\_\_\_

Bottom Hole Location: \_\_\_\_\_

KCC DKT #: \_\_\_\_\_

**\*THE SCHIELDS 5A-32 WAS NOT PERMITTED AT THE TIME IT WAS DRILLED. THE WELL WAS SPAUDED 12-2-2000. JK**

**AFFIDAVIT**

NOTE: RIG SKID FROM SCHIELDS 5-32

The undersigned hereby affirms that the drilling, completion and eventual plugging of this well will comply with K.S.A. 55-101, et. seq.

It is agreed that the following minimum requirements will be met:

1. Notify the appropriate district office **prior** to spudding of well;
2. A copy of the approved notice of intent to drill **shall be** posted on each drilling rig;
3. The minimum amount of surface pipe as specified below **shall be set** by circulating cement to the top; in all cases surface pipe **shall be set** through all unconsolidated materials plus a minimum of 20 feet into the underlying formation.
4. If the well is dry hole, an agreement between the operator and the district office on plug length and placement is necessary **prior to plugging**;
5. The appropriate district office will be notified before well is either plugged or production casing is cemented in;
6. If an ALTERNATE II COMPLETION, production pipe shall be cemented from below any usable water to surface within **120 days** of spud date. **In all cases, NOTIFY district office** prior to any cementing.

I hereby certify that the statements made herein are true and to the best of my knowledge and belief.

Date: 5/01/01 Signature of Operator or Agent: John Sanders Title: President

For KCC Use ONLY

API # 15 - 181-20315-0000

Conductor pipe required NONE feet

Minimum surface pipe required 350 feet per Alt. (1)

Approved by: JK 6-21-2001

This authorization expires: 12-21-2001

(This authorization void if drilling not started within 6 months of effective date.)

Spud date: \_\_\_\_\_ Agent: \_\_\_\_\_

Remember to:

- File Drill Pit Application (form CDP-1) with Intent to Drill;
- File Completion Form ACO-1 within 120 days of spud date;
- File acreage attribution plat according to field proration orders;
- Notify appropriate district office 48 hours prior to workover or re-entry;
- Submit plugging report (CP-4) after plugging is completed;
- Obtain written approval before disposing or injecting salt water.

RECEIVED  
KANSAS CORPORATION COMMISSION  
5/4/01  
MAY 4 2001

Mail to: KCC - Conservation Division, 130 S. Market - Room 2078, Wichita, Kansas 67202

CONSERVATION DIVISION

**IN ALL CASES PLOT THE INTENDED WELL ON THE PLAT BELOW**

*Plat of acreage attributable to a well in a prorated or spaced field*

*If the intended well is in a prorated or spaced field, please fully complete this side of the form.* If the intended well is in a prorated or spaced field complete the plat below showing that the well will be properly located in relationship to other wells producing from the common source of supply. Please show all the wells and within 1 mile of the boundaries of the proposed acreage attribution unit for gas wells and within 1/2 mile of the boundaries of the proposed acreage attribution unit for oil wells.

API No. 15 - \_\_\_\_\_  
 Operator: \_\_\_\_\_  
 Lease: \_\_\_\_\_  
 Well Number: \_\_\_\_\_  
 Field: \_\_\_\_\_  
 Number of Acres attributable to well: \_\_\_\_\_  
 QTR / QTR / QTR of acreage: \_\_\_\_\_ - \_\_\_\_\_ - \_\_\_\_\_

Location of Well: County: \_\_\_\_\_  
 \_\_\_\_\_ feet from S / N (circle one) Line of Section  
 \_\_\_\_\_ feet from E / W (circle one) Line of Section  
 Sec. \_\_\_\_\_ Twp. \_\_\_\_\_ S. R. \_\_\_\_\_  East  West  
 Is Section \_\_\_\_\_ Regular or \_\_\_\_\_ Irregular  
**If Section is Irregular, locate well from nearest corner boundary.**  
 Section corner used: \_\_\_NE \_\_\_NW \_\_\_SE \_\_\_SW

**PLAT**

*(Show location of the well and shade attributable acreage for prorated or spaced wells.)  
 (Show footage to the nearest lease or unit boundary line.)*

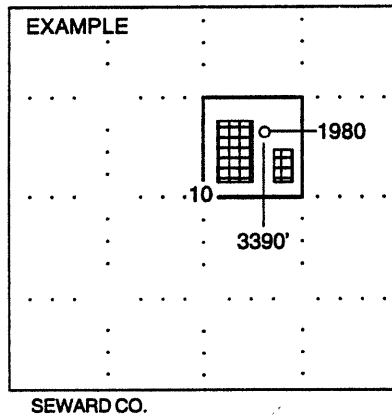
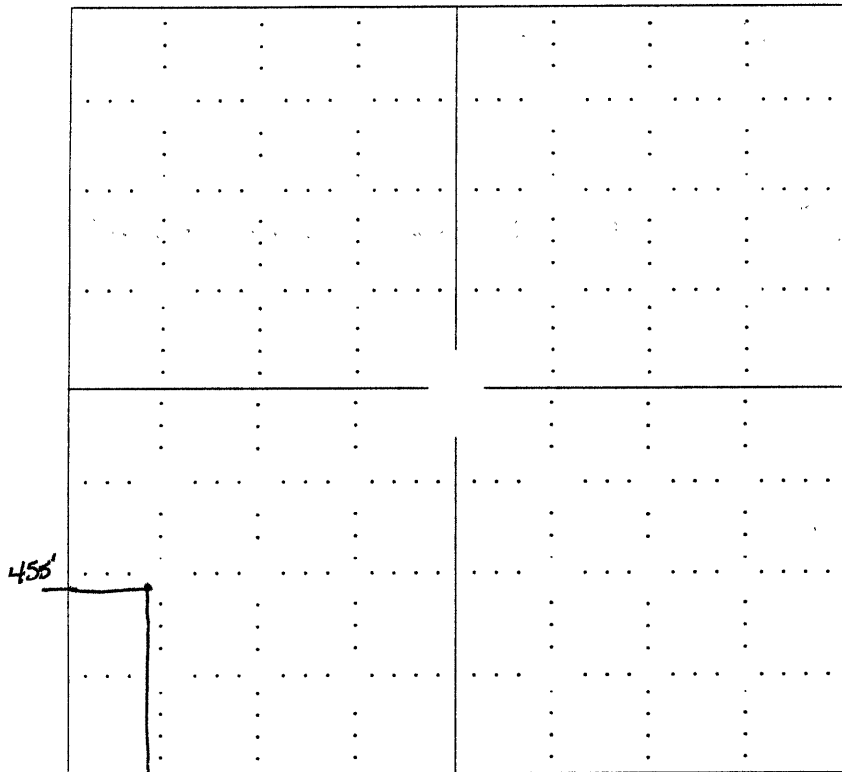

**NOTE:** *In all cases locate the spot of the proposed drilling locaton.*

**In plotting the proposed location of the well, you must show:**

1. The manner in which you are using the depicted plat by identifying section lines, i.e. 1 section, 1 section with 8 surrounding sections, 4 sections, etc.
2. The distance of the proposed drilling location from the section's south / north and east / west.
3. The distance to the nearest lease or unit boundary line.
4. If proposed location is located within a prorated or spaced field a certificate of acreage attribution plat must be attached: (CO-7 for oil wells; CG-8 for gas wells).

# LOBO PRODUCTION, INC.

15-181-20315-00-00

6715 Road 22 • Goodland, Kansas 67735  
Tele: (785) 899-5684 • Fax (785) 899-5966  
Email: jsanders@goodland.ixks.com  
Field Office:  
Tele: (785) 899-7342

May 3, 2001

Kansas Corporation Commission  
Jeff Klock  
Conservation Division  
130 S. Market – Room 2078  
Wichita, KS 67202

Dear Jeff,

Enclosed is an Intent to Drill for the Shields 5a-32 (skidded rig), which we spoke of on April 16, 2001.

If you have any questions regarding the Intent, call 785-899-5684.

Thank you,

Julie Crow  
Secretary

RECEIVED  
KANSAS CORPORATION COMMISSION

MAY 4 2001

CONSERVATION DIVISION

5/4/01