

For KCC Use: 2-12-06
Effective Date: 3
District # _____
SGA? Yes No

KANSAS CORPORATION COMMISSION
OIL & GAS CONSERVATION DIVISION

FEB 17 2006

Form C-1
December 2002

NOTICE OF INTENT TO DRILL

CONSERVATION DIVISION
WICHITA, KS
Form must be Typed
All blanks must be Filled

Must be approved by KCC five (5) days prior to commencing well

Expected Spud Date February 15 2006
month day year

Spot N 1/2 N 1/2 NE Sec. 8 Twp. 34 S. R. 10
 East West

OPERATOR: License# 30930
Name: PAR, Inc.
Address: 1211 North Shartel, Suite 405
City/State/Zip: Oklahoma City, Oklahoma 73103
Contact Person: Rod Dickens / Pat Rigual
Phone: (620) 331-9340 / (405) 235-2779

5110 feet from N / S Line of Section
1300 feet from E / W Line of Section
Is SECTION Regular Irregular?

CONTRACTOR: License# 33374
Name: L & S Well Service

(Note: Locate well on the Section Plat on reverse side)
County: Chautauqua
Lease Name: Bell Well #: 7
Field Name: Elgin Oil & Gas

Well Drilled For: Oil Gas OAWO Seismic; # of Holes Other
Well Class: Enh Rec Storage Disposal Infield Pool Ext. Wildcat Other
Type Equipment: Mud Rotary Air Rotary Cable

Is this a Prorated / Spaced Field? Yes No
Target Formation(s): Cattleman Sandstone
Nearest Lease or unit boundary: 170

If OWWO: old well information as follows:
Operator: _____
Well Name: _____
Original Completion Date: _____ Original Total Depth: _____

Ground Surface Elevation: 970 estimated feet MSL
Water well within one-quarter mile: Yes No
Public water supply well within one mile: Yes No

Directional, Deviated or Horizontal wellbore? Yes No
If Yes, true vertical depth: _____
Bottom Hole Location: _____
KCC DKT #: _____

Depth to bottom of fresh water: 200
Depth to bottom of usable water: 500
Surface Pipe by Alternate: 1 2

Length of Surface Pipe Planned to be set: 40' of 8 5/8"
Length of Conductor Pipe required: none
Projected Total Depth: 1850
Formation at Total Depth: Cherokee Shale

Water Source for Drilling Operations:
 Well Farm Pond Other _____
DWR Permit #: _____
(Note: Apply for Permit with DWR)

Will Cores be taken? Yes No
If Yes, proposed zone: _____

AFFIDAVIT

The undersigned hereby affirms that the drilling, completion and eventual plugging of this well will comply with K.S.A. 55 et. seq.
It is agreed that the following minimum requirements will be met:

1. Notify the appropriate district office **prior** to spudding of well;
2. A copy of the approved notice of intent to drill **shall be** posted on each drilling rig;
3. The minimum amount of surface pipe as specified below **shall be set** by circulating cement to the top; in all cases surface pipe **shall be set** through all unconsolidated materials plus a minimum of 20 feet into the underlying formation.
4. If the well is dry hole, an agreement between the operator and the district office on plug length and placement is necessary **prior to plugging**;
5. The appropriate district office will be notified before well is either plugged or production casing is cemented in;
6. If an ALTERNATE II COMPLETION, production pipe shall be cemented from below any usable water to surface within **120 days** of spud date.
Or pursuant to Appendix "B" - Eastern Kansas surface casing order #133,891-C, which applies to the KCC District 3 area, alternate II cementing must be completed within 30 days of the spud date or the well shall be plugged. **In all cases, NOTIFY district office** prior to any cementing.

I hereby certify that the statements made herein are true and to the best of my knowledge and belief.
Date: February 6, 2006 Signature of Operator or Agent: _____ Title: Geologist/Agent

For KCC Use ONLY
API # 15 - 019-26719-0000
Conductor pipe required NONE feet
Minimum surface pipe required 40 feet per Alt. \rightarrow (2)
Approved by: RJP 2-7-06
This authorization expires: 8-7-06
(This authorization void if drilling not started within 6 months of approval date.)
Spud date: _____ Agent: _____

Remember to:
- File Drill Pit Application (form CDP-1) with Intent to Drill;
- File Completion Form ACO-1 within 120 days of spud date;
- File acreage attribution plat according to field proration orders;
- Notify appropriate district office 48 hours prior to workover or re-entry;
- Submit plugging report (CP-4) after plugging is completed;
- Obtain written approval before disposing or injecting salt water.
- If this permit has expired (See: authorized expiration date) please check the box below and return to the address below.
 Well Not Drilled - Permit Expired
Signature of Operator or Agent: _____
Date: _____

00
34
103

FEB 07 2006

IN ALL CASES PLOT THE INTENDED WELL ON THE PLAT BELOW

Plat of acreage attributable to a well in a prorated or spaced field

CONSERVATION DIVISION
WICHITA, KS

If the intended well is in a prorated or spaced field, please fully complete this side of the form. If the intended well is in a prorated or spaced field complete the plat below showing that the well will be properly located in relationship to other wells producing from the common source of supply. Please show all the wells and within 1 mile of the boundaries of the proposed acreage attribution unit for gas wells and within 1/2 mile of the boundaries of the proposed acreage attribution unit for oil wells.

API No. 15 - _____

Operator: PAR, Inc.

Lease: Bell

Well Number: 7

Field: Elgin Oil & Gas

Number of Acres attributable to well: _____

QTR / QTR / QTR of acreage: N 1/2 - N 1/2 - NE

Location of Well: County: Chautauqua

5110 feet from N / S Line of Section

1300 feet from E / W Line of Section

Sec. 8 Twp. 34 S. R. 10 East West

Is Section: Regular or Irregular

If Section is Irregular, locate well from nearest corner boundary.

Section corner used: NE NW SE SW

PLAT

*(Show location of the well and shade acreage for prorated or spaced wells.)
(Show footage to the nearest lease or unit boundary line.)*

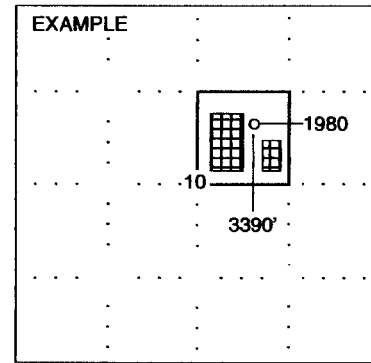
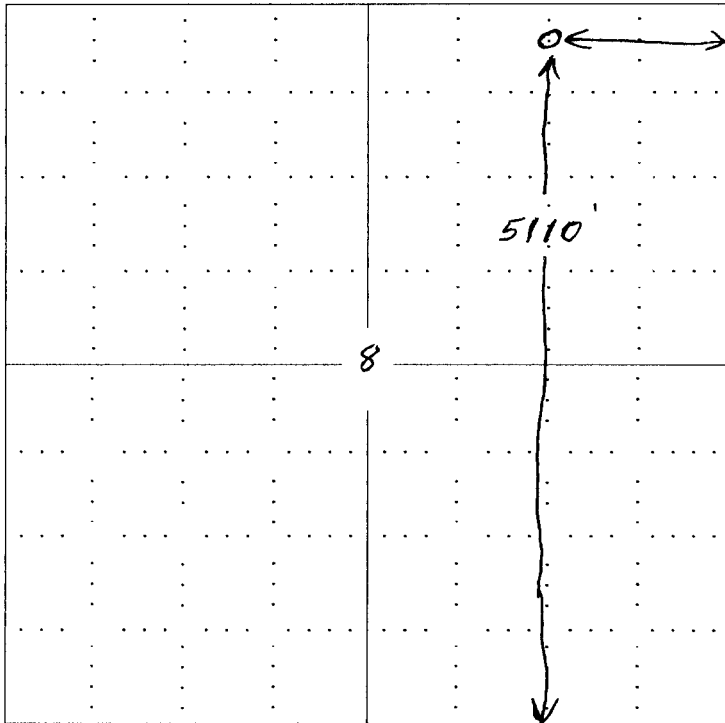

SEWARD CO.

NOTE: In all cases locate the spot of the proposed drilling locaton.

In plotting the proposed location of the well, you must show:

1. The manner in which you are using the depicted plat by identifying section lines, i.e. 1 section, 1 section with 8 surrounding sections, 4 sections, etc.
2. The distance of the proposed drilling location from the section's south / north and east / west.
3. The distance to the nearest lease or unit boundary line.
4. If proposed location is located within a prorated or spaced field a certificate of acreage attribution plat must be attached: (CO-7 for oil wells; CG-8 for gas wells).