

For KCC Use:
 Effective Date: 2-13-06
 District # _____
 SGA? Yes No

KANSAS CORPORATION COMMISSION
 OIL & GAS CONSERVATION DIVISION
NOTICE OF INTENT TO DRILL

Form C-1
 December 2002
 Form must be Typed
 Form must be Signed
 All blanks must be Filled

Must be approved by KCC five (5) days prior to commencing well

Expected Spud Date 02/01/2006
 month day year

OPERATOR: License# 32446
 Name: Merit Energy Company
 Address: 13727 Noel Road, Suite 500
 City/State/Zip: Dallas, TX 75240
 Contact Person: Elizabeth Lyon
 Phone: 972.628.1659

CONTRACTOR: License# 5147
 Name: Beredco Drilling Company

Spot
 E/2 NE SE SW Sec. 03 Twp. 33 S. R. 40 East West
936.6 feet from N / S Line of Section
2630.4 feet from E / W Line of Section
 is SECTION Regular Irregular?

(Note: Locate well on the Section Plat on reverse side)

County: Morton
 Lease Name: Stirrup Enhanced Recovery Unit Well #: 10-1
 Field Name: Stirrup
 Is this a Prorated / Spaced Field? Yes No
 Target Formation(s): Morrow "D"

<input checked="" type="checkbox"/> Oil	<input checked="" type="checkbox"/> Enh Rec	<input checked="" type="checkbox"/> Infield	<input checked="" type="checkbox"/> Mud Rotary
<input type="checkbox"/> Gas	<input type="checkbox"/> Storage	<input type="checkbox"/> Pool Ext.	<input type="checkbox"/> Air Rotary
<input type="checkbox"/> OWD	<input type="checkbox"/> Disposal	<input type="checkbox"/> Wildcat	<input type="checkbox"/> Cable
<input type="checkbox"/> Seismic; _____ # of Holes	<input type="checkbox"/> Other		
<input type="checkbox"/> Other			

Nearest Lease or unit boundary: 936.6 Lease & Unit
 Ground Surface Elevation: 3223.2' feet MSL
 Water well within one-quarter mile: Yes No
 Public water supply well within one mile: Yes No
 Depth to bottom of fresh water: 400
 Depth to bottom of usable water: 600

If OWWO: old well information as follows:
 Operator: _____
 Well Name: _____
 Original Completion Date: _____ Original Total Depth: _____

Surface Pipe by Alternate: 1 2
 Length of Surface Pipe Planned to be set: 1500'
 Length of Conductor Pipe required: None
 Projected Total Depth: 5400'
 Formation at Total Depth: Morrow "D"

Directional, Deviated or Horizontal wellbore? Yes No
 If Yes, true vertical depth: _____
 Bottom Hole Location: _____
 KCC DKT #: _____

Water Source for Drilling Operations:
 Well Farm Pond Other _____
 DWR Permit #: _____
 Will Cores be taken? Yes No
 If Yes, proposed zone: _____

***PRORATED & Spaced Hyston & Parana SERU UNIT.**

AFFIDAVIT

The undersigned hereby affirms that the drilling, completion and eventual plugging of this well will comply with K.S.A. 58-5001.
 It is agreed that the following minimum requirements will be met:

1. Notify the appropriate district office **prior** to spudding of well;
2. A copy of the approved notice of intent to drill **shall be posted** on each drilling rig;
3. The minimum amount of surface pipe as specified below **shall be set** by circulating cement to the top; in all cases surface pipe **shall be set** through all unconsolidated materials plus a minimum of 20 feet into the underlying formation.
4. If the well is dry hole, an agreement between the operator and the district office on plug length and placement is necessary **prior to plugging**;
5. The appropriate district office will be notified before well is either plugged or production casing is cemented in;
6. If an ALTERNATE II COMPLETION, production pipe shall be cemented from below any usable water to surface within **120 days** of spud date.
 Or pursuant to Appendix "B" - Eastern Kansas surface casing order #133,891-C, which applies to the KCC District 3 area, alternate II cementing must be completed within 30 days of the spud date or the well shall be plugged. **In all cases, NOTIFY district office** prior to any cementing.

I hereby certify that the statements made herein are true and to the best of my knowledge and belief.

Date: 01/25/2006 Signature of Operator or Agent: [Signature] Title: Regulatory Analyst

For KCC Use ONLY
 API # 15 - 129-21772-00-00
 Conductor pipe required NONE feet
 Minimum surface pipe required 620 feet per Alt. ①
 Approved by: [Signature]
 This authorization expires: 8.8.06
 (This authorization void if drilling not started within 6 months of approval date.)
 Spud date: _____ Agent: _____

Remember to:

- File Drill Pit Application (form CDP-1) with Intent to Drill;
- File Completion Form ACO-1 within 120 days of spud date;
- File acreage attribution plat according to field proration orders;
- Notify appropriate district office 48 hours prior to workover or re-entry;
- Submit plugging report (CP-4) after plugging is completed;
- Obtain written approval before disposing or injecting salt water.

- If this permit has expired (See: authorized expiration date) please check the box below and return to the address below.
 Well Not Drilled - Permit Expired
 Signature of Operator or Agent: [Signature]
 Date: 01-25-2006

RECEIVED
 KANSAS CORPORATION COMMISSION
 FEB 08 2006
 CONSERVATION DIVISION
 WICHITA, KS

W
 33
 40W

IN ALL CASES PLOT THE INTENDED WELL ON THE PLAT BELOW

Plat of acreage attributable to a well in a prorated or spaced field

If the intended well is in a prorated or spaced field, please fully complete this side of the form. If the intended well is in a prorated or spaced field complete the plat below showing that the well will be properly located in relationship to other wells producing from the common source of supply. Please show all the wells and within 1 mile of the boundaries of the proposed acreage attribution unit for gas wells and within 1/2 mile of the boundaries of the proposed acreage attribution unit for oil wells.

API No. 15 - 129-21759-00-00
 Operator: Merit Energy Company
 Lease: Stirrup Enhanced Recovery Unit
 Well Number: 10-1
 Field: Stirrup

Location of Well: County: Morton
936.6 feet from N / S Line of Section
2630.4 feet from E / W Line of Section
 Sec. 03 Twp. 33 S. R. 40 East West

Number of Acres attributable to well: _____
 QTR / QTR / QTR of acreage: E/2 NE - SE - SW

Is Section: Regular or Irregular

If Section is Irregular, locate well from nearest corner boundary.

Section corner used: NE NW SE SW

PLAT

(Show location of the well and shade attributable acreage for prorated or spaced wells.)

(Show footage to the nearest lease or unit boundary line.)

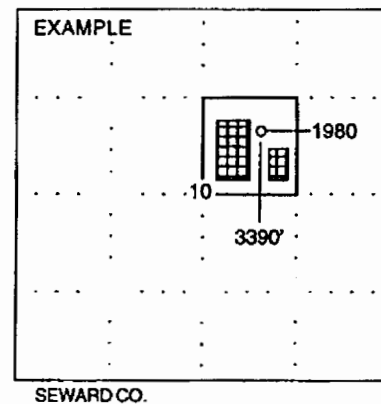
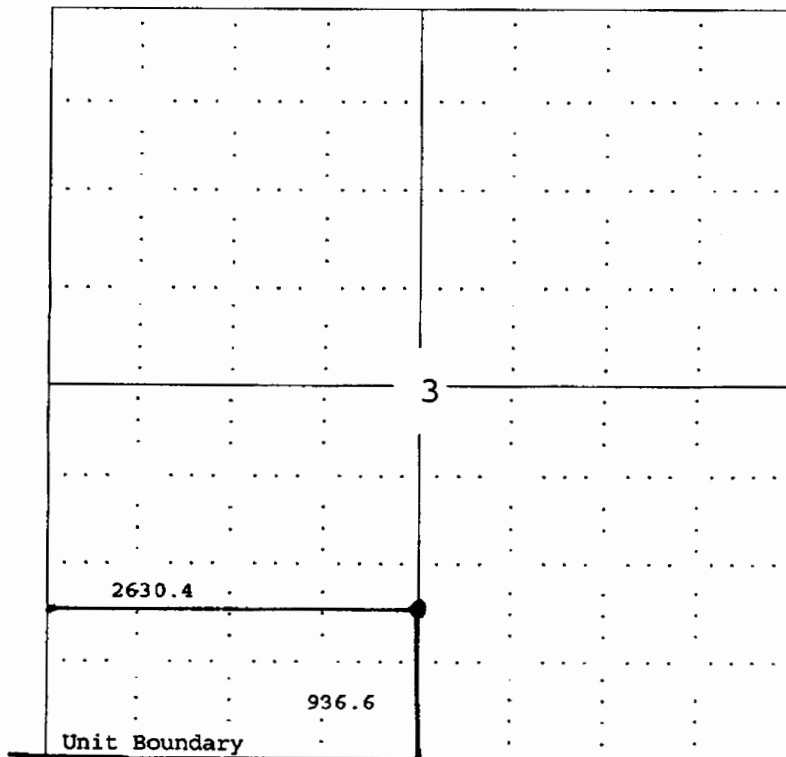

NOTE: In all cases locate the spot of the proposed drilling location.

In plotting the proposed location of the well, you must show:

1. The manner in which you are using the depicted plat by identifying section lines, i.e. 1 section, 1 section with 8 surrounding sections, 4 sections, etc.
2. The distance of the proposed drilling location from the section's south / north and east / west.
3. The distance to the nearest lease or unit boundary line.
4. If proposed location is located within a prorated or spaced field a certificate of acreage attribution plat must be attached: (CO-7 for oil wells; CG-8 for gas wells).

KANSAS

CORPORATION COMMISSION

KATHLEEN SEBELIUS, GOVERNOR
BRIAN J. MOLINE, CHAIR
ROBERT E. KREHBIEL, COMMISSIONER
MICHAEL C. MOFFET, COMMISSIONER

February 8, 2006

Ms. Elizabeth Lyon
Merit Energy Company
13727 Noel Rd, Ste 500
Dallas, TX 75240

Re: Drilling Pit Application
SERU Lease Well No. 10-1
SW/4 Sec. 03-33S-40W
Morton County, Kansas

Dear Ms. Lyon:

District staff has inspected the location and has determined that an unsealed condition will present a pollution threat to water resources.

District staff has instructed that no earthen pits are to be used at the location. Steel pits are to be used. Please inform the Commission in writing as to which disposal well you will utilize to dispose of the contents in the steel pits and the amount of fluid that will be disposed. **If a haul-off pit is necessary please file, form CDP-1, Application for Surface Pit.** This location will have to be inspected prior to approval of the haul-off pit application.

If fluids are taken to an authorized disposal well, please call the District Office at (620) 225-8888. Please file form CDP-5, Exploration and Production Waste Transfer, within 30 days of fluid removal. Conservation division forms are available through our office and on the KCC web site: www.kcc.state.ks.us/conservation/forms.

Sincerely,

Kathy Haynes

Environmental Protection and Remediation Department

Cc: S Durrant



KANSAS

CORPORATION COMMISSION

KATHLEEN SEBELIUS, GOVERNOR

BRIAN J. MOLINE, CHAIR

ROBERT E. KREHBIEL, COMMISSIONER

MICHAEL C. MOFFET, COMMISSIONER

NOTICE TO OPERATORS DRILLING IN THE PANOMA- COUNCIL GROVE GAS POOL SPACED AREA

The enclosed intent is located within the Panoma-Council Grove gas pool space area. In May 1978, Panoma-Council Grove Proration Order (as amended), Docket No. 60,024-C (C-7058) under FINDINGS OF FACT AND LAW on page 31, the following language is stated that:

“The Commission finds that in order to prevent waste and protect correlative rights, the following stated rules pertaining to wells already completed, in the process of being drilled or for future wells to be drilled in the Panoma Council Grove Gas Pool Spaced area, and for wells producing from the Council Grove Formation outside of the Panoma Council Grove Gas Pool Spaced area within the Hugoton Gas Field, should be adopted.”

1. “No dual completions between the Chase (Hugoton) and Council Grove Formations will be permitted for future wells drilled.”
2. “Casing shall not be set above the top of the Council Grove Formation for a Council Grove producing well.”
3. “The production casing of all new Council Grove wells should be cemented with a calculated volume of cement sufficient to encase the casing from the bottom of the casing to a point 500 feet above the Chase Formation.”
4. “The casing shall be encased in cement in the interval between the base of the Council Grove and the top of the Chase Formation on all wells, irrespective of depth, completed below the Council Grove Formation, if they are located within the space area.”
5. “The cement coverage heretofore required shall be confirmed by the running of a recognized survey, such as a temperature survey or cement bond log.”

A copy of this survey and the cement tickets(s) showing that all cement work has been completed, must be filed with the ACO-1 Completion Report within 120 days from the wells “spud date.”

Failure to comply with these provisions may cause the well to be shut-in until compliance has been achieved.

If you have any questions, please feel free to contact the Conservation Division’s Production Department at (316) 337-6200.