

For KCC Use: 2-14-06  
 Effective Date: 4  
 District # \_\_\_\_\_  
 SGA?  Yes  No

**KANSAS CORPORATION COMMISSION  
 OIL & GAS CONSERVATION DIVISION  
 NOTICE OF INTENT TO DRILL**

Form C-1  
 December 2002  
**Form must be Typed  
 Form must be Signed  
 All blanks must be Filled**

*Must be approved by KCC five (5) days prior to commencing well*

Expected Spud Date 2/15/06  
 month day year

Spot \_\_\_\_\_ East  
 SE NE NW Sec. 26 Twp. 5 S. R. 23  West  
 990' \_\_\_\_\_ feet from  N /  S Line of Section  
 2310' \_\_\_\_\_ feet from  E /  W Line of Section  
 Is SECTION  Regular \_\_\_\_\_ Irregular?

OPERATOR: License# 33629  
 Name: Great Plains Energy, Inc. a Nebraska Corporation  
 Address: 429 N Linden PO Box 292  
 City/State/Zip: Wahoo, NE 68066  
 Contact Person: Dan Blankenau  
 Phone: (402) 443-6125

RECEIVED  
 KANSAS CORPORATION COMMISSION  
 FEB 09 2006

(Note: Locate well on the Section Plat on reverse side)  
 County: Norton  
 Lease Name: Sprigg Well #: 1  
 Field Name: Wildcat  
 Is this a Prorated / Spaced Field?  Yes  No

CONTRACTOR: License# 33575  
 Name: WW Drilling, LLC

CONSERVATION DIVISION  
 WICHITA, KS

Well Drilled For: Well Class: Type Equipment:  
 Oil  Enh Rec  Infield  Mud Rotary  
 Gas  Storage  Pool Ext.  Air Rotary  
 OWWO  Disposal  Wildcat  Cable  
 Seismic; # of Holes \_\_\_\_\_  Other \_\_\_\_\_  
 Other \_\_\_\_\_

Target Formation(s): Reagan Sand  
 Nearest Lease or unit boundary: 990'  
 Ground Surface Elevation: 2338' feet MSL  
 Water well within one-quarter mile:  Yes  No  
 Public water supply well within one mile:  Yes  No  
 Depth to bottom of fresh water: 280' 250  
 Depth to bottom of usable water: 1200' 1200  
 Surface Pipe by Alternate:  ALT-2  
 Length of Surface Pipe Planned to be set: 300'  
 Length of Conductor Pipe required: None  
 Projected Total Depth: 2950' 3950?  
 Formation at Total Depth: Granite  
 Water Source for Drilling Operations:  
 Well  Farm Pond Other Hauled  
 DWR Permit #: \_\_\_\_\_

If OWWO: old well information as follows:  
 Operator: \_\_\_\_\_  
 Well Name: \_\_\_\_\_  
 Original Completion Date: \_\_\_\_\_ Original Total Depth: \_\_\_\_\_

Directional, Deviated or Horizontal wellbore?  Yes  No  
 If Yes, true vertical depth: \_\_\_\_\_  
 Bottom Hole Location: \_\_\_\_\_  
 KCC DKT #: \_\_\_\_\_

(Note: Apply for Permit with DWR )  
 Will Cores be taken?  Yes  No  
 If Yes, proposed zone: \_\_\_\_\_

**AFFIDAVIT**

The undersigned hereby affirms that the drilling, completion and eventual plugging of this well will comply with K.S.A. 55 et. seq.  
 It is agreed that the following minimum requirements will be met:

1. Notify the appropriate district office **prior** to spudding of well;
2. A copy of the approved notice of intent to drill **shall be** posted on each drilling rig;
3. The minimum amount of surface pipe as specified below **shall be set** by circulating cement to the top; in all cases surface pipe **shall be set** through all unconsolidated materials plus a minimum of 20 feet into the underlying formation.
4. If the well is dry hole, an agreement between the operator and the district office on plug length and placement is necessary **prior to plugging**;
5. The appropriate district office will be notified before well is either plugged or production casing is cemented in;
6. If an ALTERNATE II COMPLETION, production pipe shall be cemented from below any usable water to surface within **120 days** of spud date.  
 Or pursuant to Appendix "B" - Eastern Kansas surface casing order #133,891-C, which applies to the KCC District 3 area, alternate II cementing must be completed within 30 days of the spud date or the well shall be plugged. **In all cases, NOTIFY district office** prior to any cementing.

I hereby certify that the statements made herein are true and to the best of my knowledge and belief.

Date: 2/8/06 Signature of Operator or Agent: [Signature] Title: Secretary

**For KCC Use ONLY**  
 API # 15 - 137-20447-00-00  
 Conductor pipe required NONE feet  
 Minimum surface pipe required 300 feet per Alt. 2  
 Approved by: [Signature] 2-9-06  
 This authorization expires: 8-9-06  
 (This authorization void if drilling not started within 6 months of approval date.)  
 Spud date: \_\_\_\_\_ Agent: \_\_\_\_\_

**Remember to:**

- File Drill Pit Application (form CDP-1) with Intent to Drill;
- File Completion Form ACO-1 within 120 days of spud date;
- File acreage attribution plat according to field proration orders;
- Notify appropriate district office 48 hours prior to workover or re-entry;
- Submit plugging report (CP-4) after plugging is completed;
- Obtain written approval before disposing or injecting salt water.
- If this permit has expired (See: authorized expiration date) please check the box below and return to the address below.

**Well Not Drilled - Permit Expired**  
 Signature of Operator or Agent: \_\_\_\_\_  
 Date: \_\_\_\_\_

Mail to: KCC - Conservation Division, 130 S. Market - Room 2078, Wichita, Kansas 67202

265 23W

**IN ALL CASES PLOT THE INTENDED WELL ON THE PLAT BELOW**

FEB 09 2006

*Plat of acreage attributable to a well in a prorated or spaced field*

CONSERVATION DIVISION  
WICHITA, KS

*If the intended well is in a prorated or spaced field, please fully complete this side of the form.* If the intended well is in a prorated or spaced field complete the plat below showing that the well will be properly located in relationship to other wells producing from the common source of supply. Please show all the wells and within 1 mile of the boundaries of the proposed acreage attribution unit for gas wells and within 1/2 mile of the boundaries of the proposed acreage attribution unit for oil wells.

API No. 15 - \_\_\_\_\_  
Operator: Great Plains Energy, Inc. a Nebraska Corporation  
Lease: Sprigg  
Well Number: 1  
Field: Wildcat

Location of Well: County: Norton  
990' \_\_\_\_\_ feet from  N /  S Line of Section  
2310' \_\_\_\_\_ feet from  E /  W Line of Section  
Sec. 26 Twp. 5 S. R. 23  East  West

Number of Acres attributable to well: \_\_\_\_\_  
QTR / QTR / QTR of acreage: SE NE NW

Is Section:  Regular or  Irregular

If Section is Irregular, locate well from nearest corner boundary.  
Section corner used:  NE  NW  SE  SW

**PLAT**

*(Show location of the well and shade attributable acreage for prorated or spaced wells.)  
(Show footage to the nearest lease or unit boundary line.)*

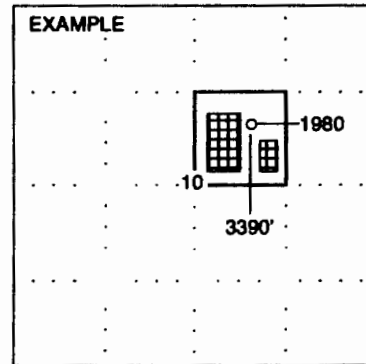
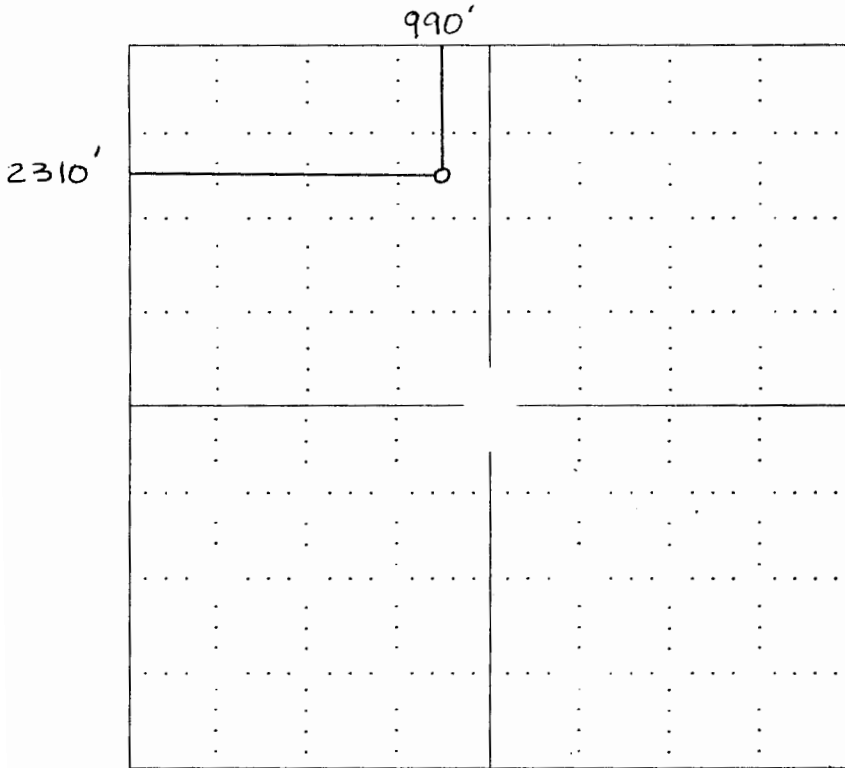

**NOTE: In all cases locate the spot of the proposed drilling location.**

**In plotting the proposed location of the well, you must show:**

1. The manner in which you are using the depicted plat by identifying section lines, i.e. 1 section, 1 section with 8 surrounding sections, 4 sections, etc.
2. The distance of the proposed drilling location from the section's south / north and east / west.
3. The distance to the nearest lease or unit boundary line.
4. If proposed location is located within a prorated or spaced field a certificate of acreage attribution plat must be attached: (C0-7 for all wells; CG-8 for gas wells).