

Use: 2-19-06  
 Effective Date: \_\_\_\_\_  
 District # 4  
 SGA?  Yes  No

KANSAS CORPORATION COMMISSION  
 OIL & GAS CONSERVATION DIVISION

Form C-1  
 September 1999  
 Form must be Typed  
 Form must be Signed  
 All blanks must be Filled

**NOTICE OF INTENT TO DRILL**

Must be approved by KCC five (5) days prior to commencing well

Expected Spud Date March 15 2006  
 month day year

OPERATOR: License# 33019  
 Name: Rosewood Resources, Inc.  
 Address: 2711 N. Haskell Ave. - Suite 2800, LB #22  
 City/State/Zip: Dallas, Texas 75204  
 Contact Person: Tina Morrison  
 Phone: 214-756-6626

CONTRACTOR: License# 33532  
 Name: Advanced Drilling Technologies LLC

Well Drilled For: Well Class: Type Equipment:  
 Oil  Enh Rec  Infield  Mud Rotary  
 Gas  Storage  Pool Ext.  Air Rotary  
 OWO  Disposal  Wildcat  Cable  
 Seismic; # of Holes  Other  
 Other

If OWWO: old well information as follows:  
 Operator: \_\_\_\_\_  
 Well Name: \_\_\_\_\_  
 Original Completion Date: \_\_\_\_\_ Original Total Depth: \_\_\_\_\_

Directional, Deviated or Horizontal wellbore?  Yes  No  
 If Yes, true vertical depth: RECEIVED  
 Bottom Hole Location: KANSAS CORPORATION COMMISSION  
 KCC DKT #: FEB 14 2006

Spot  East  
S42 - NE - NE Sec. 32 Twp. 7 S. R. 39  West  
974 feet from S N (circle one) Line of Section  
657 feet from E W (circle one) Line of Section

Is SECTION  Regular  Irregular?  
 (Note: Locate well on the Section Plat on reverse side)

County: Sherman  
 Lease Name: lhrg, C Well #: 41-32  
 Field Name: Goodland

Is this a Prorated / Spaced Field?  Yes  No  
 Target Formation(s): Niobrara  
 Nearest Lease or unit boundary: 657'

Ground Surface Elevation: 3630.2' feet MSL  
 Water well within one-quarter mile:  Yes  No  
 Public water supply well within one mile:  Yes  No

Depth to bottom of fresh water: 270 325  
 Depth to bottom of usable water: 270 325  
 Surface Pipe by Alternate: xxx 1 2 375 MIN

Length of Surface Pipe Planned to be set: \_\_\_\_\_  
 Length of Conductor Pipe required: None  
 Projected Total Depth: 1500  
 Formation at Total Depth: Niobrara

Water Source for Drilling Operations:  
 Well \_\_\_\_\_ Farm Pond \_\_\_\_\_ Other xxx  
 DWR Permit #: \_\_\_\_\_

(Note: Apply for Permit with DWR )  
 Will Cores be taken?  Yes  No  
 If Yes, proposed zone: \_\_\_\_\_

CONSERVATION DIVISION WICHITA, KS AFFIDAVIT

The undersigned hereby affirms that the drilling, completion and eventual plugging of this well will comply with K.S.A. 55-101, et. seq. It is agreed that the following minimum requirements will be met:

1. Notify the appropriate district office **prior** to spudding of well;
2. A copy of the approved notice of intent to drill **shall be** posted on each drilling rig;
3. The minimum amount of surface pipe as specified below **shall be set** by circulating cement to the top; in all cases surface pipe **shall be set** through all unconsolidated materials plus a minimum of 20 feet into the underlying formation.
4. If the well is dry hole, an agreement between the operator and the district office on plug length and placement is necessary **prior to plugging**;
5. The appropriate district office will be notified before well is either plugged or production casing is cemented in;
6. If an ALTERNATE II COMPLETION, production pipe shall be cemented from below any usable water to surface within **120 days** of spud date. **In all cases, NOTIFY district office** prior to any cementing.

I hereby certify that the statements made herein are true and to the best of my knowledge and belief.

Date: February 10, 2006 Signature of Operator or Agent: Tina Morrison Title: Land Administrator

**For KCC Use ONLY**  
 API # 15 - 181-20410-00-00  
 Conductor pipe required NONE feet  
 Minimum surface pipe required 375' feet per Alt. 1  
 Approved by RSP 2-14-06  
 This authorization expires: 8-14-06  
 (This authorization void if drilling not started within 6 months of effective date.)  
 Spud date: \_\_\_\_\_ Agent: \_\_\_\_\_

- Remember to:**
- File Drill Pit Application (form CDP-1) with Intent to Drill;
  - File Completion Form ACO-1 within 120 days of spud date;
  - File acreage attribution plat according to field proration orders;
  - Notify appropriate district office 48 hours prior to workover or re-entry;
  - Submit plugging report (CP-4) after plugging is completed;
  - Obtain written approval before disposing or injecting salt water.

327  
39w

**IN ALL CASES PLOT THE INTENDED WELL ON THE PLAT BELOW**

*Plat of acreage attributable to a well in a prorated or spaced field*

**If the intended well is in a prorated or spaced field, please fully complete this side of the form.** If the intended well is in a prorated or spaced field complete the plat below showing that the well will be properly located in relationship to other wells producing from the common source of supply. Please show all the wells and within 1 mile of the boundaries of the proposed acreage attribution unit for gas wells and within 1/2 mile of the boundaries of the proposed acreage attribution unit for oil wells.

API No. 15 - \_\_\_\_\_  
 Operator: Rosewood Resources, Inc.  
 Lease: Ihrig, C  
 Well Number: 41-32  
 Field: Goodland  
 Number of Acres attributable to well: 160  
 QTR / QTR / QTR of acreage: SE - NE - NE

Location of Well: County: Sherman  
974 feet from S (N) (circle one) Line of Section  
657 feet from (E) W (circle one) Line of Section  
 Sec. 32 Twp. 7 S. R. 39  East  West

Is Section  Regular or  Irregular

**If Section is Irregular, locate well from nearest corner boundary.**

Section corner used:  NE  NW  SE  SW

**RECEIVED**  
**KANSAS CORPORATION COMMISSION**

**FEB 14 2006**

**PLAT**

**CONSERVATION DIVISION** Show location of the well and shade attributable acreage for prorated or spaced wells.)  
**WICHITA, KS** (Show footage to the nearest lease or unit boundary line.)

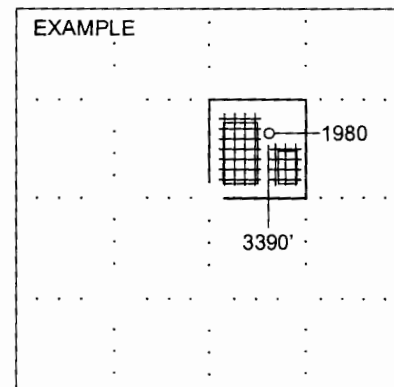
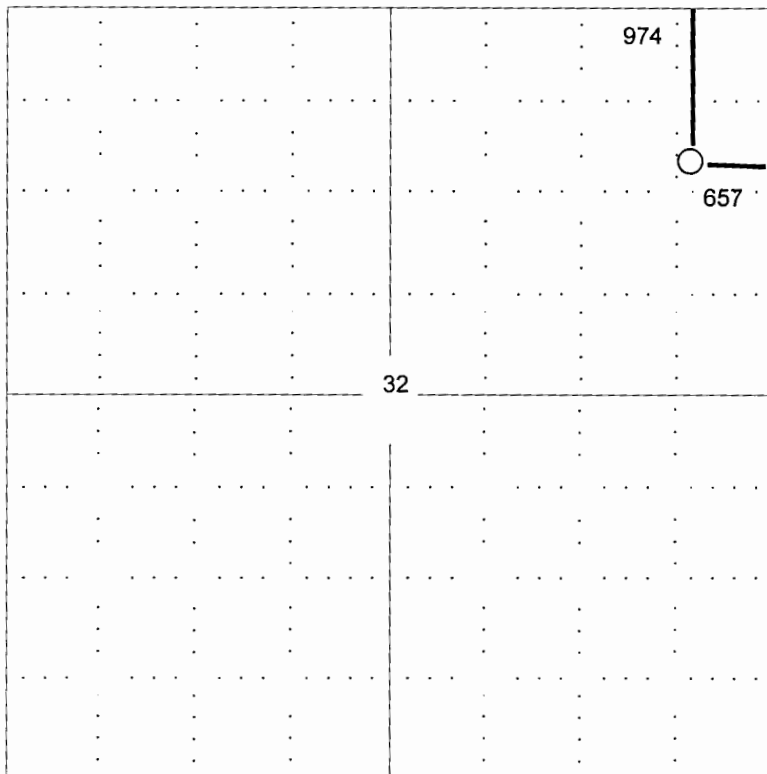

**NOTE: In all cases locate the spot of the proposed drilling locaton.**

**In plotting the proposed location of the well, you must show:**

1. The manner in which you are using the depicted plat by identifying section lines, i.e. 1 section, 1 section with 8 surrounding sections, 4 sections, etc.
2. The distance of the proposed drilling location from the section's south / north and east / west.
3. The distance to the nearest lease or unit boundary line.
4. If proposed location is located within a prorated or spaced field a certificate of acreage attribution plat must be attached: (CO-7 for oil wells; CG-8 for gas wells).