

For KCC Use:
 Effective Date: 3-15-06
 District # 1
 SGA? Yes No

**KANSAS CORPORATION COMMISSION
 OIL & GAS CONSERVATION DIVISION
 NOTICE OF INTENT TO DRILL**

Form C-1
 December 2002
 Form must be Typed
 Form must be signed
 All blanks must be Filled

Must be approved by KCC five (5) days prior to commencing well

Expected Spud Date 03/26/06
 month day year

Spot: AP. E/2 NE - SW - SW Sec. 16 Twp. 26S R. 33
 East West

OPERATOR: License # 5447

990 feet from N / S Line of Section

Name: OXY USA Inc.

1250 feet from E / W Line of Section

Address: P.O. Box 2528

Is SECTION X Regular _____ Irregular?

City/State/Zip: Liberal, KS 67905

(Note: Locate well on the Section Plat on reverse side)

Contact Person: Vicki Carder

County: Finney

Phone: (620) 629-4242

Lease Name: Walker A Well #: 3

CONTRACTOR: License # 33375

Field Name: Panama

Name: Cheyenne Drilling, LP

Is this a Prorated / Spaced Field? Yes No

Target Formation(s): Council Grove

Nearest Lease or unit Boundary: 990

Well Drilled For: Well Class: Type Equipment:

Ground Surface Elevation: 2906 feet MSL

Oil Enh Rec Infield Mud Rotary

Water well within one-quarter mile Yes No

Gas Storage Pool Ext Air Rotary

Public water supply well within one mile: Yes No

OWWO Disposal Wildcat Cable

Depth to bottom of fresh water: 520'

Seismic: # of Holes Other Field Development

Depth to bottom of usable water: 820'

Other _____

Surface Pipe by Alternate: 1 2

If OWWO: old well information as follows:

* Length of Surface Pipe Planned to be set: 840'

Operator: _____

Well Name: _____

Original Completion Date: _____ Original Total Depth: _____

Length of Conductor Pipe Required: _____

Projected Total Depth: 3000

Formation at Total Depth: Council Grove

Directional, Deviated or Horizontal Yes No

Water Source for Drilling Operations:

IF Yes, true vertical depth _____

Well Farm Pond Other X

Bottom Hole Location _____

DWR Permit # _____

(Note: Apply for Permit with DWR)

* KCC DKT #: 06-CONS-112-CWLE

Will Cores be Taken? Yes No

If Yes, Proposed zone: _____

* MIN. ALT. 1 = 840' Surface Cas. WICHITA, KS

AFFIDAVIT

The undersigned hereby affirms that the drilling, completion and eventual plugging of this well will comply with K.S.A. 55-101, et. Seq. It is agreed that the following minimum requirements will be met:

1. Notify the appropriate district office **prior** to spudding of well;
2. A copy of the approved notice of intent to drill **shall be** posted on each drilling rig;
3. The minimum amount of surface pipe as specified below **shall be set** by circulating cement to the top; in all cases surface pipe **shall be set** through all unconsolidated materials plus a minimum of 20 feet into the underlying formation.
4. If the well is dry hole, an agreement between the operator and the district office on plug length and placement is necessary **prior to plugging**;
5. The appropriate district office will be notified before well is either plugged or production casing is cemented in;
6. If an ALTERNATE II COMPLETION, production pipe shall be cemented from below any usable water to surface within **120 days** of spud date. Or pursuant to Appendix "B" - Eastern Kansas surface casing order #133,891-C, which applies to the KCC District 3 area, alternate II cementing must be completed within 30 days of the spud date or the well shall be plugged. **In all cases, NOTIFY district office** prior to any cementing.

I hereby certify that the statements made herein are true and to the best of my knowledge and belief.

Date: 2/2/06 Signature of Operator or Agent: _____ Title: attorney as agent

For KCC Use ONLY

API # 15 - 055-21911-00-00

Conductor pipe required NONE feet

Minimum Surface pipe required 840' feet per Alt. X

Approved by: DPW 3-10-06

This authorization expires: 9-10-06

(This authorization void if drilling not started within 6 months of effective date.)

Spud date: _____ Agent: _____

Remember to:

- File Drill Pit Application (form CDP-1) with Intent to Drill;
- File Completion Form ACO-1 within 120 days of spud date;
- File acreage attribution plat according to field proation orders;
- Notify appropriate district office 48 hours prior to workover or re-entry;
- Submit plugging report (CP-4) after plugging is completed;
- Obtain written approval before disposing or injecting salt water.
- If this permit has expired (see: authorized expiration date) please check the box below and return to the address below.

Well Not Drilled - Permit Expired

Signature of Operator or Agent: _____

Date: _____

16
20
33

IN ALL CASES PLOT THE INTENDED WELL ON THE PLAT BELOW

Plat of acreage attributable to a well in a prorated or spaced field

If the intended well is in a prorated or spaced field, please fully complete this side of the form. If the intended well is in a prorated or spaced field complete the plat below showing that the well will be properly located in relationship to other wells producing from the common source of supply. Please show all the wells and within 1 mile of the boundaries of the proposed acreage attribution unit for gas wells and within 1/2 mile of the boundaries of the proposed acreage attribution unit for oil wells.

API No. 15 - _____
 Operator: OXY USA Inc.
 Lease: Walker A
 Well Number: 3
 Field: Panoma

Number of Acres attributable to well: 640
 QTR / QTR / QTR of acreage: NE - SW - SW

Location of Well: County Finney
 _____ 990 feet from N / S Line of Section
 _____ 1250 feet from E / W Line of Section
 Sec. 16 Twp. 26S R. 33 East West

Is Section Regular or Irregular

IF Section is Irregular, locate well from nearest corner boundary.

Section corner used: NE NW SE SW

PLAT

(Show location of the well and shade attributable acreage for prorated or spaced wells.)

(Show footage to the nearest lease or unit boundary line.)

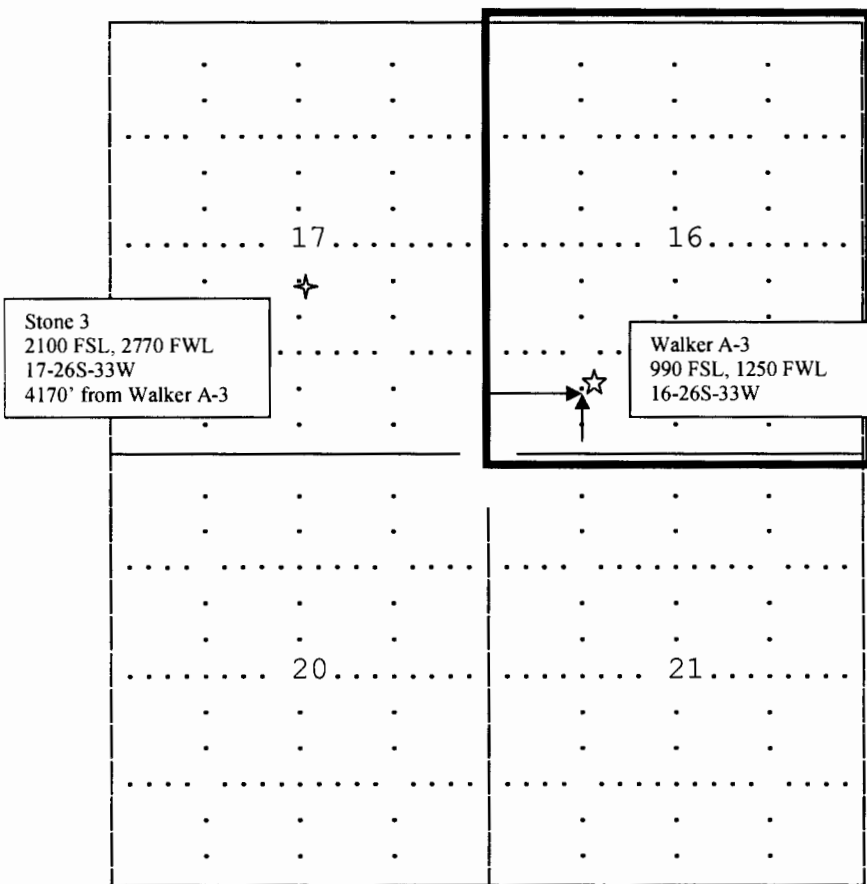

RECEIVED
KANSAS CORPORATION COMMISSION
FEB 02 2006
CONSERVATION DIVISION
WICHITA, KS

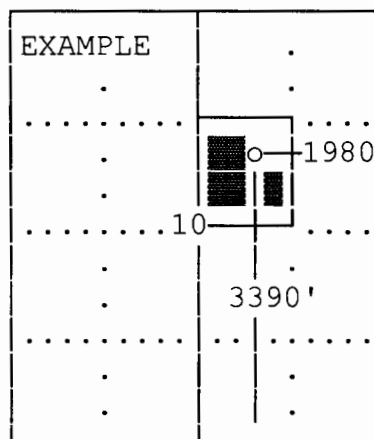

SEWARD CO.

Note: In all cases locate the spot of the proposed drilling location.

Finney County

In plotting the proposed location of the well, you must show:

1. The manner in which you are using the depicted plat by identifying section lines, i.e. 1 section, 1 section with 8 surrounding sections, 4 sections, etc.
2. The distance of the proposed drilling location from the sections south / north and east / west.
3. The distance to the nearest lease or unit boundary line.
4. If proposed location is located within a prorated or spaced field a certificate of acreage attribution plat must be attached: (CO-7 for oil wells; CG-8 for gas wells).



KANSAS

CORPORATION COMMISSION

KATHLEEN SEBELIUS, GOVERNOR

BRIAN J. MOLINE, CHAIR

ROBERT E. KREHBIEL, COMMISSIONER

MICHAEL C. MOFFET, COMMISSIONER

NOTICE TO OPERATORS DRILLING IN THE PANOMA- COUNCIL GROVE GAS POOL SPACED AREA

The enclosed intent is located within the Panoma-Council Grove gas pool space area. In May 1978, Panoma-Council Grove Proration Order (as amended), Docket No. 60,024-C (C-7058) under FINDINGS OF FACT AND LAW on page 31, the following language is stated that:

“The Commission finds that in order to prevent waste and protect correlative rights, the following stated rules pertaining to wells already completed, in the process of being drilled or for future wells to be drilled in the Panoma Council Grove Gas Pool Spaced area, and for wells producing from the Council Grove Formation outside of the Panoma Council Grove Gas Pool Spaced area within the Hugoton Gas Field, should be adopted.”

1. “No dual completions between the Chase (Hugoton) and Council Grove Formations will be permitted for future wells drilled.”
2. “Casing shall not be set above the top of the Council Grove Formation for a Council Grove producing well.”
3. “The production casing of all new Council Grove wells should be cemented with a calculated volume of cement sufficient to encase the casing from the bottom of the casing to a point 500 feet above the Chase Formation.”
4. “The casing shall be encased in cement in the interval between the base of the Council Grove and the top of the Chase Formation on all wells, irrespective of depth, completed below the Council Grove Formation, if they are located within the space area.”
5. “The cement coverage heretofore required shall be confirmed by the running of a recognized survey, such as a temperature survey or cement bond log.”

A copy of this survey and the cement tickets(s) showing that all cement work has been completed, must be filed with the ACO-1 Completion Report within 120 days from the wells “spud date.”

Failure to comply with these provisions may cause the well to be shut-in until compliance has been achieved.

If you have any questions, please feel free to contact the Conservation Division’s Production Department at (316) 337-6200.