

OWWO

For KCC Use: Effective Date: 3-20-06
District #: 4
SGA? Yes No

KANSAS CORPORATION COMMISSION OIL & GAS CONSERVATION DIVISION NOTICE OF INTENT TO DRILL

Form C-1
December 2002
Form must be Typed
Form must be Signed
All blanks must be Filled

Must be approved by KCC five (5) days prior to commencing well

Expected Spud Date March 20 2006
month day year

OPERATOR: License# 5386
Name: Production Drilling Inc
Address: P O Box 680
City/State/Zip: Hays Ks 67601
Contact Person: Aven Weaverling
Phone: 785-625-1189

CONTRACTOR: License# 32128
Name: Western Well Service

Well Drilled For: Oil Gas OWWO Seismic; # of Holes _____
Well Class: Enh Rec Storage Disposal Infield Pool Ext. Wildcat Other _____
Type Equipment: Mud Rotary Air Rotary Cable

If OWWO: old well information as follows:
Operator: Petroleum Inc
Well Name: Veverka #1
Original Completion Date: 12-1948 Original Total Depth: 3384

Directional, Deviated or Horizontal wellbore? Yes No
If Yes, true vertical depth: _____
Bottom Hole Location: _____
KCC DKT #: _____

Spot SW SW NW Sec. 34 Twp. 8 S. R. 19 East West
2310 feet from N S Line of Section 11
330 feet from E W Line of Section

Is SECTION Regular Irregular?
(Note: Locate well on the Section Plat on reverse side)
County: Rooks
Lease Name: Rome Well #: 2
Field Name: Webster
Is this a Prorated / Spaced Field? Yes No
Target Formation(s): Arb
Nearest Lease or unit boundary: 330
Ground Surface Elevation: 1955 feet MSL
Water well within one-quarter mile: Yes No
Public water supply well within one mile: Yes No
Depth to bottom of fresh water: 180
Depth to bottom of usable water: 800
Surface Pipe by Alternate: 1 2
Length of Surface Pipe ~~_____~~ set: set at 250
Length of Conductor Pipe required: none
Projected Total Depth: 3385
Formation at Total Depth: arb
Water Source for Drilling Operations: Well Farm Pond Other Wash down
DWR Permit #: _____
(Note: Apply for Permit with DWR [])
Will Cores be taken? Yes No
If Yes, proposed zone: _____

AFFIDAVIT

The undersigned hereby affirms that the drilling, completion and eventual plugging of this well will comply with K.S.A. 55 et. seq.
It is agreed that the following minimum requirements will be met:
1. Notify the appropriate district office **prior** to spudding of well;
2. A copy of the approved notice of intent to drill **shall be** posted on each drilling rig;
3. The minimum amount of surface pipe as specified below **shall be set** by circulating cement to the top; in all cases surface pipe **shall be set** through all unconsolidated materials plus a minimum of 20 feet into the underlying formation.
4. If the well is dry hole, an agreement between the operator and the district office on plug length and placement is necessary **prior to plugging**;
5. The appropriate district office will be notified before well is either plugged or production casing is cemented in;
6. If an ALTERNATE II COMPLETION, production pipe shall be cemented from below any usable water to surface within **120 days** of spud date.
Or pursuant to Appendix "B" - Eastern Kansas surface casing order #133,891-C, which applies to the KCC District 3 area, alternate II cementing must be completed within 30 days of the spud date or the well shall be plugged. **In all cases, NOTIFY district office** prior to any cementing.

I hereby certify that the statements made herein are true and to the best of my knowledge and belief.
Date: 3-7-06 Signature of Operator or Agent: Aven Weaverling Title: Foreman

For KCC Use ONLY
API # 15 - 163-01423-00-01
Conductor pipe required NONE feet
Minimum surface pipe required 250 feet per Alt. 2
Approved by: DPW 3-15-06
This authorization expires: 9-15-06
(This authorization void if drilling not started within 6 months of approval date.)
Spud date: _____ Agent: _____

Remember to:
- File Drill Pit Application (form CDP-1) with Intent to Drill;
- File Completion Form ACO-1 within 120 days of spud date;
- File acreage attribution plat according to field proration orders;
- Notify appropriate district office 48 hours prior to workover or re-entry;
- Submit plugging report (CP-4) after plugging is completed;
- Obtain written approval before disposing or injecting salt water.
- If this permit has expired (See: authorized expiration date) please check the box below and return to the address below.
 Well Not Drilled - Permit Expired
Signature of Operator or Agent: _____
Date: _____

Mail to: KCC - Conservation Division, 130 S. Market - Room 2078, Wichita, Kansas 67202

RECEIVED
MAR 11 2006
KCC WICHITA

34
8
19w

IN ALL CASES PLOT THE INTENDED WELL ON THE PLAT BELOW

Plat of acreage attributable to a well in a prorated or spaced field

If the intended well is in a prorated or spaced field, please fully complete this side of the form. If the intended well is in a prorated or spaced field complete the plat below showing that the well will be properly located in relationship to other wells producing from the common source of supply. Please show all the wells and within 1 mile of the boundaries of the proposed acreage attribution unit for gas wells and within 1/2 mile of the boundaries of the proposed acreage attribution unit for oil wells.

API No. 15 - _____

Operator: Production Drilling Inc

Lease: Rome

Well Number: 2

Field: Webster

Number of Acres attributable to well: _____

QTR / QTR / QTR of acreage: SW - SW - NW

Location of Well: County: Rooks

2310 feet from N / S Line of Section

330 feet from E / W Line of Section

Sec. 34 Twp. 8 S. R. 19 East West

Is Section: Regular or Irregular

If Section is Irregular, locate well from nearest corner boundary.

Section corner used: NE NW SE SW

PLAT

(Show location of the well and shade attributable acreage for prorated or spaced wells.)

(Show footage to the nearest lease or unit boundary line.)

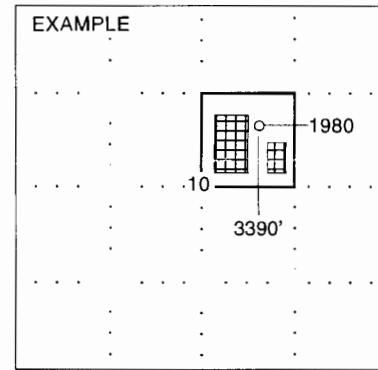
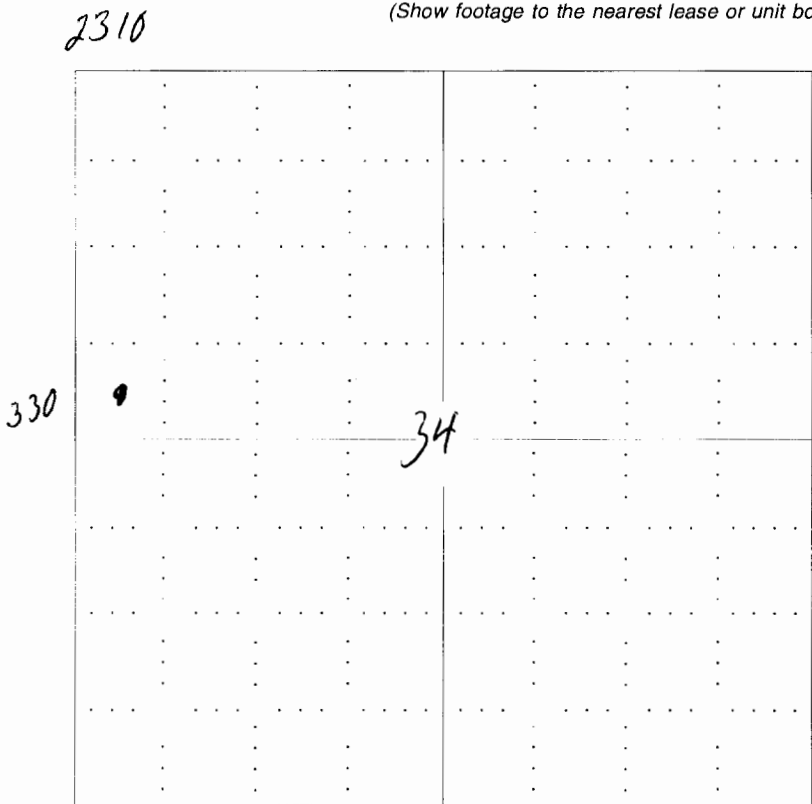

SEWARD CO.

RECEIVED
MAR 1 2006
KCC WICHITA

NOTE: In all cases locate the spot of the proposed drilling location.

In plotting the proposed location of the well, you must show:

1. The manner in which you are using the depicted plat by identifying section lines, i.e. 1 section, 1 section with 8 surrounding sections, 4 sections, etc.
2. The distance of the proposed drilling location from the section's south / north and east / west.
3. The distance to the nearest lease or unit boundary line.
4. If proposed location is located within a prorated or spaced field a certificate of acreage attribution plat must be attached: (CO-7 for oil wells; CG-8 for gas wells).

KANSAS

CORPORATION COMMISSION

KATHLEEN SEBELIUS, GOVERNOR
BRIAN J. MOLINE, CHAIR
ROBERT E. KREHBIEL, COMMISSIONER
MICHAEL C. MOFFET, COMMISSIONER

March 13, 2006

Mr. Aven Weaverling
Production Drilling, Inc.
PO Box 680
Hays, KS 67601

RE: Drilling Pit Application
Rome Lease Well No. 2
NW/4 Sec. 34-08S-19W
Rooks County, Kansas

Dear Mr. Weaverling:

This office has been informed that steel pits are to be used at the above referenced location. **If a haul-off pit is necessary please file form CDP-1, Application for Surface Pit.** This location will have to be inspected prior to approval of the haul-off pit application.

If fluids are taken to an authorized disposal well, please call the District Office at (785) 625-0550. Please file form CDP-5, Exploration and Production Waste Transfer, within 30 days of fluid removal.

Conservation division forms are available through our office and on the KCC web site: www.kcc.state.ks.us/conservation/forms.

Sincerely,

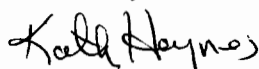

Kathy Haynes
Environmental Protection and Remediation Department

Cc: H Deines