

For KCC Use: Effective Date: 3-21-06
District #: 4
SGA? Yes No

KANSAS CORPORATION COMMISSION
OIL & GAS CONSERVATION DIVISION
NOTICE OF INTENT TO DRILL

Form C-1
September 1999
Form must be Typed
Form must be Signed
All blanks must be Filled

Must be approved by KCC five (5) days prior to commencing well

Expected Spud Date March 15 2006
month day year

Spot NW NE NW Sec. 21 Twp. 7 S. R. 39 East West
125 feet from S N (circle one) Line of Section
1760 feet from E W (circle one) Line of Section
Is SECTION Regular Irregular?

OPERATOR: License# 33019
Name: Rosewood Resources, Inc.
Address: 2711 N. Haskell Ave. - Suite 2800, LB #22
City/State/Zip: Dallas, Texas 75204
Contact Person: Tina Morrison
Phone: 214-756-6626

(Note: Locate well on the Section Plat on reverse side)
County: Sherman
Lease Name: Ihrig, C Well #: 21-21H
Field Name: Goodland

CONTRACTOR: License# 33532
Name: Advanced Drilling Technologies LLC

Is this a Prorated / Spaced Field? Yes No
Target Formation(s): Niobrara

Well Drilled For: Well Class: Type Equipment:
 Oil Enh Rec Infield Mud Rotary
 Gas Storage Pool Ext. Air Rotary
 QW/O Disposal Wildcat Cable
 Seismic; # of Holes Other

Nearest Lease or unit boundary: 330' @ B.H.L.
Ground Surface Elevation: 3580 feet MSL
Water well within one-quarter mile: Yes No
Public water supply well within one mile: Yes No

If OWWO: old well information as follows:
Operator: _____
Well Name: _____
Original Completion Date: _____ Original Total Depth: _____

Depth to bottom of fresh water: 300' 250' ✓
Depth to bottom of usable water: 300' 250' ✓
Surface Pipe by Alternate: XXX 1 _____ 2 _____
Length of Surface Pipe Planned to be set: 300' ✓
Length of Conductor Pipe required: None

Directional, Deviated or Horizontal wellbore? Yes No
If Yes, true vertical depth: 1040'
Bottom Hole Location: 2264 FNL 625 FWL

Projected Total Depth: _____
Formation at Total Depth: Niobrara
Water Source for Drilling Operations:
Well _____ Farm Pond _____ Other XXX

KCC DKT #: _____

DWR Permit #: _____
(Note: Apply for Permit with DWR)
Will Cores be taken? Yes No
If Yes, proposed zone: _____

#06-cons-125-CHOR

RECEIVED
KANSAS CORPORATION COMMISSION
MAR 10 2006

AFFIDAVIT

The undersigned hereby affirms that the drilling, completion and eventual plugging of this well will comply with K.S.A. 55-101, et. seq. It is agreed that the following minimum requirements will be met:

1. Notify the appropriate district office **prior** to spudding of well;
2. A copy of the approved notice of intent to drill **shall be** posted on each drilling rig;
3. The minimum amount of surface pipe as specified below **shall be set** by circulating cement to the top; in all cases surface pipe **shall be set** through all unconsolidated materials plus a minimum of 20 feet into the underlying formation.
4. If the well is dry hole, an agreement between the operator and the district office on plug length and placement is necessary **prior to plugging**;
5. The appropriate district office will be notified before well is either plugged or production casing is cemented in;
6. If an ALTERNATE II COMPLETION, production pipe shall be cemented from below any usable water to surface within **120 days** of spud date. **In all cases, NOTIFY district office** prior to any cementing.

I hereby certify that the statements made herein are true and to the best of my knowledge and belief.

Date: March 6, 2006 Signature of Operator or Agent: Tina Morrison Title: Land Administrator

For KCC Use ONLY
API # 15 - 181-20428-01-00
Conductor pipe required NONE feet
Minimum surface pipe required 300' feet per Alt. X
Approved by: DPW 3-16-06
This authorization expires: 9-16-06
(This authorization void if drilling not started within 6 months of effective date.)
Spud date: _____ Agent: _____

- Remember to:**
- File Drill Pit Application (form CDP-1) with Intent to Drill;
 - File Completion Form ACO-1 within 120 days of spud date;
 - File acreage attribution plat according to field proration orders;
 - Notify appropriate district office 48 hours prior to workover or re-entry;
 - Submit plugging report (CP-4) after plugging is completed;
 - Obtain written approval before disposing or injecting salt water.

21
7
396

IN ALL CASES PLOT THE INTENDED WELL ON THE PLAT BELOW

Plat of acreage attributable to a well in a prorated or spaced field

If the intended well is in a prorated or spaced field, please fully complete this side of the form. If the intended well is in a prorated or spaced field complete the plat below showing that the well will be properly located in relationship to other wells producing from the common source of supply. Please show all the wells and within 1 mile of the boundaries of the proposed acreage attribution unit for gas wells and within 1/2 mile of the boundaries of the proposed acreage attribution unit for oil wells.

API No. 15 - _____
 Operator: Rosewood Resources, Inc.
 Lease: Ihrig, C
 Well Number: 21-21H
 Field: Goodland
 Number of Acres attributable to well: 160
 QTR / QTR / QTR of acreage: NW - NE - NW

Location of Well: County: Sherman
125 feet from S N (circle one) Line of Section
1760 feet from E W (circle one) Line of Section
 Sec. 21 Twp. 7 S. R. 39 East West

Is Section Regular or _____ Irregular

If Section is Irregular, locate well from nearest corner boundary.

Section corner used: ___ NE ___ NW ___ SE ___ SW

PLAT

*(Show location of the well and shade attributable acreage for prorated or spaced wells.)
 (Show footage to the nearest lease or unit boundary line.)*

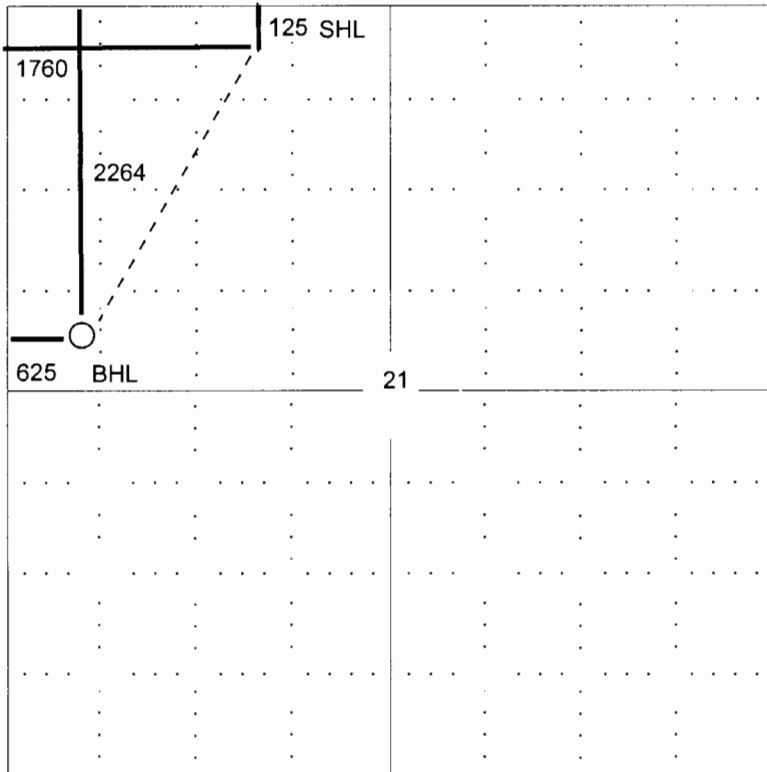

RECEIVED
KANSAS CORPORATION COMMISSION
MAR 10 2006
CONSERVATION DIVISION
WICHITA, KS

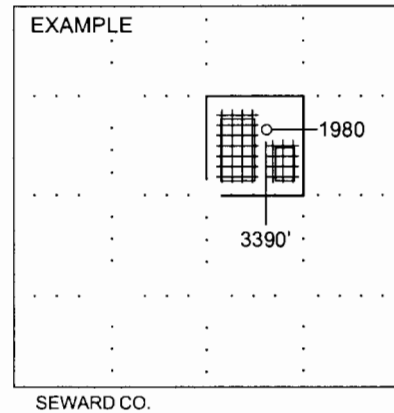

NOTE: In all cases locate the spot of the proposed drilling location.

In plotting the proposed location of the well, you must show:

1. The manner in which you are using the depicted plat by identifying section lines, i.e. 1 section, 1 section with 8 surrounding sections, 4 sections, etc.
2. The distance of the proposed drilling location from the section's south / north and east / west.
3. The distance to the nearest lease or unit boundary line.
4. If proposed location is located within a prorated or spaced field a certificate of acreage attribution plat must be attached: (CO-7 for oil wells; CG-8 for gas wells).