

For KCC Use: 3-26-06
Effective Date: 3-26-06
District # 1
SGA? Yes No

KANSAS CORPORATION COMMISSION
OIL & GAS CONSERVATION DIVISION
NOTICE OF INTENT TO DRILL

Form C-1
December 2002
Form must be Typed
Form must be Signed
All blanks must be Filled

Must be approved by KCC five (5) days prior to commencing well

Expected Spud Date April 28, 2006
month day year

Spot East
NE - NE - SW Sec. 5 Twp. 33S S. R. 31 West
2310' feet from N / S Line of Section
2970' feet from E / W Line of Section
Is SECTION Regular Irregular?

OPERATOR: License# 8061 ✓
Name: Oil Producers Inc. of Kansas
Address: 1710 Waterfront Parkway
City/State/Zip: Wichita, KS 67206
Contact Person: Lori Wedel
Phone: 316-681-0231

CONTRACTOR: License# 33375 ✓
Name: Cheyenne Drilling, LP

Well Drilled For: Oil Enh Rec Gas Storage QW/O Disposal Seismic; # of Holes Other
Well Class: Infield Pool Ext. Wildcat Other
Type Equipment: Mud Rotary Air Rotary Cable

If OWWO: old well information as follows:
Operator: _____
Well Name: _____
Original Completion Date: _____ Original Total Depth: _____

Directional, Deviated or Horizontal wellbore? Yes No
If Yes, true vertical depth: _____
Bottom Hole Location: _____
KCC DKT #: _____

(Note: Locate well on the Section Plat on reverse side)
County: Seward
Lease Name: Massoni Well #: 1-5
Field Name: Hugoton
Is this a Prorated / Spaced Field? Yes No ✓
Target Formation(s): Council Grove & Chase Group
Nearest Lease or unit boundary: 330'
Ground Surface Elevation: Est 2770 feet MSL
Water well within one-quarter mile: Yes No ✓
Public water supply well within one mile: Yes No ✓
Depth to bottom of fresh water: 500' ✓
Depth to bottom of usable water: 580' ✓
Surface Pipe by Alternate: 1 2
Length of Surface Pipe Planned to be set: 1550' ✓
Length of Conductor Pipe required: _____
Projected Total Depth: 3100' ✓
Formation at Total Depth: Council Grove ✓
Water Source for Drilling Operations: Well Farm Pond Other Haul ✓
DWR Permit #: _____
(Note: Apply for Permit with DWR)
Will Cores be taken? Yes No ✓
If Yes, proposed zone: _____

AFFIDAVIT

The undersigned hereby affirms that the drilling, completion and eventual plugging of this well will comply with K.S.A. 55 et. seq.
It is agreed that the following minimum requirements will be met:

1. Notify the appropriate district office **prior** to spudding of well;
2. A copy of the approved notice of intent to drill **shall be** posted on each drilling rig;
3. The minimum amount of surface pipe as specified below **shall be set** by circulating cement to the top; in all cases surface pipe **shall be set** through all unconsolidated materials plus a minimum of 20 feet into the underlying formation.
4. If the well is dry hole, an agreement between the operator and the district office on plug length and placement is necessary **prior to plugging**;
5. The appropriate district office will be notified before well is either plugged or production casing is cemented in;
6. If an ALTERNATE II COMPLETION, production pipe shall be cemented from below any usable water to surface within **120 days** of spud date.
Or pursuant to Appendix "B" - Eastern Kansas surface casing order #133,891-C, which applies to the KCC District 3 area, alternate II cementing must be completed within 30 days of the spud date or the well shall be plugged. **In all cases, NOTIFY district office** prior to any cementing.

I hereby certify that the statements made herein are true and to the best of my knowledge and belief.

Date: 3/14/2006 Signature of Operator or Agent: TJ [Signature] Title: Vice President

For KCC Use ONLY
API # 15 - 175-22041-0000
Conductor pipe required NONE feet
Minimum surface pipe required 600' feet per Alt. X
Approved by: DPW 3-21-06
This authorization expires: 9-21-06
(This authorization void if drilling not started within 6 months of approval date.)
Spud date: _____ Agent: _____

Remember to:

- File Drill Pit Application (form CDP-1) with Intent to Drill;
- File Completion Form ACO-1 within 120 days of spud date;
- File acreage attribution plat according to field proration orders;
- Notify appropriate district office 48 hours prior to workover or re-entry;
- Submit plugging report (CP-4) after plugging is completed;
- Obtain written approval before disposing or injecting salt water.
- If this permit has expired (See: authorized expiration date) please check the box below and return to the address below.

Well Not Drilled - Permit Expired

Signature of Operator or Agent: _____
Date: _____

Mail to: KCC - Conservation Division, 130 S. Market - Room 2078, Wichita, Kansas 67202

RECEIVED
KANSAS CORPORATION COMMISSION

MAR 15 2006

CONSERVATION DIVISION
WICHITA, KS

5
33
3/14

IN ALL CASES PLOT THE INTENDED WELL ON THE PLAT BELOW

Plat of acreage attributable to a well in a prorated or spaced field

If the intended well is in a prorated or spaced field, please fully complete this side of the form. If the intended well is in a prorated or spaced field complete the plat below showing that the well will be properly located in relationship to other wells producing from the common source of supply. Please show all the wells and within 1 mile of the boundaries of the proposed acreage attribution unit for gas wells and within 1/2 mile of the boundaries of the proposed acreage attribution unit for oil wells.

API No. 15 - _____
 Operator: Oil Producers Inc. of Kansas _____
 Lease: Massoni _____
 Well Number: 1-5 _____
 Field: Hugoton _____

Location of Well: County: Seward _____
 2310' _____ feet from N / S Line of Section
 2970' _____ feet from E / W Line of Section
 Sec. 5 Twp. 33S S. R. 31 East West

Number of Acres attributable to well: 160
 QTR / QTR / QTR of acreage: NE - NE - SW

Is Section: Regular or Irregular

If Section is Irregular, locate well from nearest corner boundary.

Section corner used: NE NW SE SW

PLAT

(Show location of the well and shade attributable acreage for prorated or spaced wells.)

(Show footage to the nearest lease or unit boundary line.)

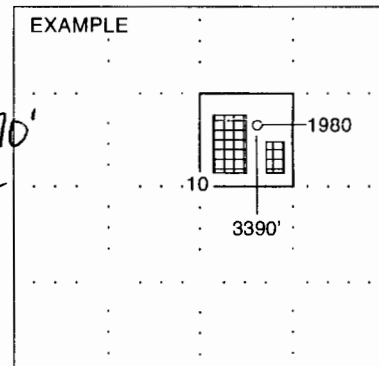
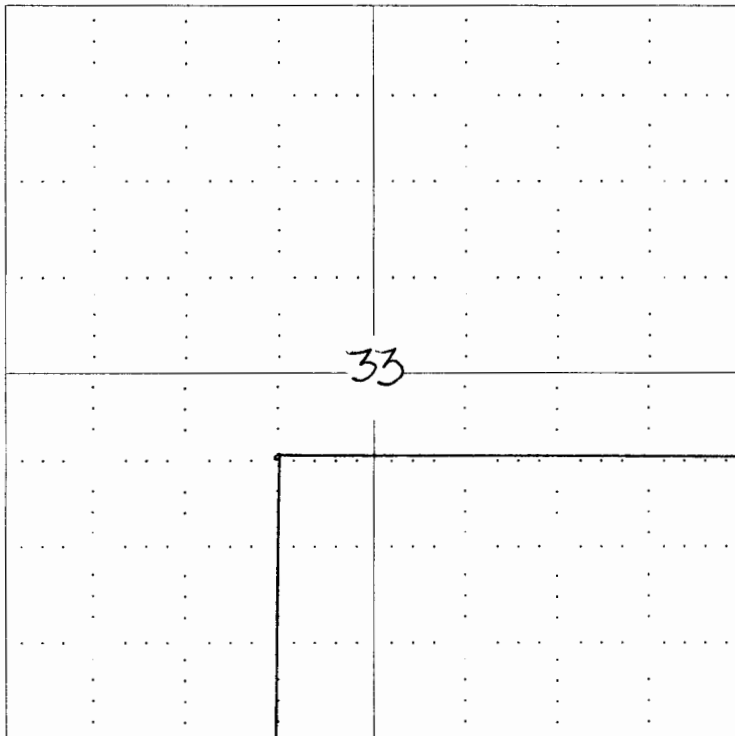

SEWARD CO.

RECEIVED
KANSAS CORPORATION COMMISSION
MAR 15 2006

NOTE: In all cases locate the spot of the proposed drilling location.

In plotting the proposed location of the well, you must show:

1. The manner in which you are using the depicted plat by identifying section lines, i.e. 1 section, 1 section with 8 surrounding sections, 4 sections, etc.
2. The distance of the proposed drilling location from the section's south / north and east / west.
3. The distance to the nearest lease or unit boundary line.
4. If proposed location is located within a prorated or spaced field a certificate of acreage attribution plat must be attached: (CO-7 for oil wells; CG-8 for gas wells).

CONSERVATION DIVISION
WIC-ITA, KS

KANSAS

CORPORATION COMMISSION

KATHLEEN SEBELIUS, GOVERNOR
BRIAN J. MOLINE, CHAIR
ROBERT E. KREHBIEL, COMMISSIONER
MICHAEL C. MOFFET, COMMISSIONER

March 17, 2006

Ms. Lori Wedel
Oil Producers, Inc. of Kansas
1710 Waterfront Parkway
Wichita, KS 67206

Re: Drilling Pit Application
Massoni Lease Well No. 1-5
SW/4 Sec. 05-33S-31W
Seward County, Kansas

Dear Ms. Wedel:

District staff has inspected the above referenced location and has determined that the reserve pit shall be constructed **without slots**, the bottom shall be flat and reasonably level and the free fluids must be removed. The fluids are to be removed from the reserve pit as soon as the Hutchinson Salt section has been drilled through and displacement of the fluids into the reserve pit has occurred. The fluids should be removed again as soon as practical after drilling operations have ceased.

If production casing is set all completion fluids shall be removed from the working pits daily. NO completion fluids or non-exempt wastes shall be placed in the reserve pit.

The fluids should be taken to an authorized disposal well. Please call the District Office at (620) 225-8888 when the fluids have been removed. Please file form CDP-5 (August 2004), Exploration and Production Waste Transfer, within 30 days of fluid removal. Conservation division forms are available through our office and on the KCC web site: www.kcc.state.ks.us/conservation/forms.

A copy of this letter should be posted in the doghouse along with the approved Intent to Drill.

If you have any questions or concerns please feel free to contact the undersigned at the above address.

Sincerely,

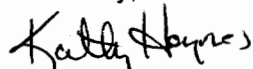

Kathy Haynes
Department of Environmental Protection and Remediation

cc: Steve Durrant
File