

For KCC Use: 4-10-06
 Effective Date: _____
 District # 1
 SGA? Yes No

KANSAS CORPORATION COMMISSION
 OIL & GAS CONSERVATION DIVISION

RECEIVED

APR 03 2006

Form C-1

December 2002

Form must be Typed

Form must be Signed

blanks must be Filled

NOTICE OF INTENT TO DRILL

Must be approved by KCC five (5) days prior to commencing work

KCC WICHITA

Expected Spud Date April 20, 2006
 month day year

Spot Approximately
 NE SW SW Sec. 23 Twp. 32 S. R. 32
 East
 West
1250' feet from N / S Line of Section
1250' feet from E / W Line of Section

OPERATOR: License# 8061
 Name: Oil Producers Inc. of Kansas
 Address: 1710 Waterfront Parkway
 City/State/Zip: Wichita, KS 67206
 Contact Person: Lori Wedel
 Phone: 316-681-0231

Is SECTION Regular Irregular?

(Note: Locate well on the Section Plat on reverse side)

CONTRACTOR: License# 33375
 Name: Cheyenne Drilling, LP

County: Seward
 Lease Name: Stanley Well #: 2A-23
 Field Name: Fedder

Is this a Prorated / Spaced Field? Yes No

Target Formation(s): Chase Group

Nearest Lease or unit boundary: 1250'

Ground Surface Elevation: Est. 2810 feet MSL

Water well within one-quarter mile: Yes No

Public water supply well within one mile: Yes No

Depth to bottom of fresh water: 460'

Depth to bottom of usable water: 460'

Surface Pipe by Alternate: 1 2

Length of Surface Pipe Planned to be set: 1660'

Length of Conductor Pipe required: _____

Projected Total Depth: 2800'

Formation at Total Depth: Chase Group

Water Source for Drilling Operations:

Well Farm Pond Other Haul

DWR Permit #: _____

(Note: Apply for Permit with DWR)

Will Cores be taken? Yes No

If Yes, proposed zone: _____

Well Drilled For:	Well Class:	Type Equipment:
<input checked="" type="checkbox"/> Oil <input checked="" type="checkbox"/> Gas	<input type="checkbox"/> Enh Rec <input type="checkbox"/> Storage	<input checked="" type="checkbox"/> Infield <input type="checkbox"/> Pool Ext.
<input type="checkbox"/> OWO <input type="checkbox"/> Disposal	<input type="checkbox"/> Wildcat <input type="checkbox"/> Other	<input checked="" type="checkbox"/> Mud Rotary <input type="checkbox"/> Air Rotary
<input type="checkbox"/> Seismic; _____ # of Holes	<input type="checkbox"/> Other	<input type="checkbox"/> Cable
<input type="checkbox"/> Other		

If OWWO: old well information as follows:
 Operator: _____
 Well Name: _____
 Original Completion Date: _____ Original Total Depth: _____

Directional, Deviated or Horizontal wellbore? Yes No

If Yes, true vertical depth: _____

Bottom Hole Location: _____

KCC DKT #: _____

AFFIDAVIT

The undersigned hereby affirms that the drilling, completion and eventual plugging of this well will comply with K.S.A. 55 et. seq.

It is agreed that the following minimum requirements will be met:

1. Notify the appropriate district office **prior** to spudding of well;
2. A copy of the approved notice of intent to drill **shall be** posted on each drilling rig;
3. The minimum amount of surface pipe as specified below **shall be set** by circulating cement to the top; in all cases surface pipe **shall be set** through all unconsolidated materials plus a minimum of 20 feet into the underlying formation.
4. If the well is dry hole, an agreement between the operator and the district office on plug length and placement is necessary **prior to plugging**;
5. The appropriate district office will be notified before well is either plugged or production casing is cemented in;
6. If an ALTERNATE II COMPLETION, production pipe shall be cemented from below any usable water to surface within **120 days** of spud date. Or pursuant to Appendix "B" - Eastern Kansas surface casing order #133,891-C, which applies to the KCC District 3 area, alternate II cementing must be completed within 30 days of the spud date or the well shall be plugged. **In all cases, NOTIFY district office** prior to any cementing.

I hereby certify that the statements made herein are true and to the best of my knowledge and belief.

Date: 3/31/2006 Signature of Operator or Agent: T.B. M... Title: Vice President

For KCC Use ONLY
 API # 15 - 175-22043-00-00
 Conductor pipe required None feet
 Minimum surface pipe required 480 feet per Alt. 1
 Approved by: DPW 4-5-06
 This authorization expires: 10-5-06
 (This authorization void if drilling not started within 6 months of approval date.)
 Spud date: _____ Agent: _____

Remember to:

- File Drill Pit Application (form CDP-1) with Intent to Drill;
- File Completion Form ACO-1 within 120 days of spud date;
- File acreage attribution plat according to field proration orders;
- Notify appropriate district office 48 hours prior to workover or re-entry;
- Submit plugging report (CP-4) after plugging is completed;
- Obtain written approval before disposing or injecting salt water.
- If this permit has expired (See: authorized expiration date) please check the box below and return to the address below.

Well Not Drilled - Permit Expired

Signature of Operator or Agent: _____

Date: _____

Mail to: KCC - Conservation Division, 130 S. Market - Room 2078, Wichita, Kansas 67202

23
32
32

IN ALL CASES PLOT THE INTENDED WELL ON THE PLAT BELOW

Plat of acreage attributable to a well in a prorated or spaced field

RECEIVED

APR 03 2006

KCC WICHITA

If the intended well is in a prorated or spaced field, please fully complete this side of the form. If the intended well is in a prorated or spaced field complete the plat below showing that the well will be properly located in relationship to other wells producing from the common source of supply. Please show all the wells and within 1 mile of the boundaries of the proposed acreage attribution unit for gas wells and within 1/2 mile of the boundaries of the proposed acreage attribution unit for oil wells.

API No. 15 - _____
Operator: Oil Producers Inc. of Kansas
Lease: Stanley
Well Number: 2A-23
Field: Fedder

Location of Well: County: Seward
1250' feet from N / S Line of Section
1250' feet from E / W Line of Section
Sec. 23 Twp. 32 S. R. 32 East West

Number of Acres attributable to well: 640
QTR / QTR / QTR of acreage: NE SW SW

Is Section: Regular or Irregular

If Section is Irregular, locate well from nearest corner boundary.

Section corner used: NE NW SE SW

Approximately

PLAT

(Show location of the well and shade attributable acreage for prorated or spaced wells.)

(Show footage to the nearest lease or unit boundary line.)

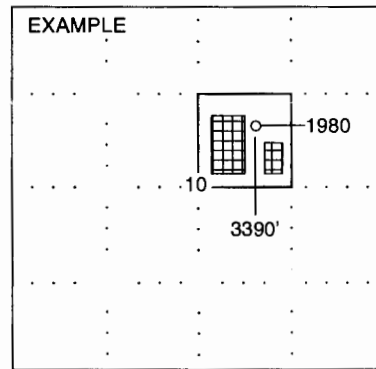
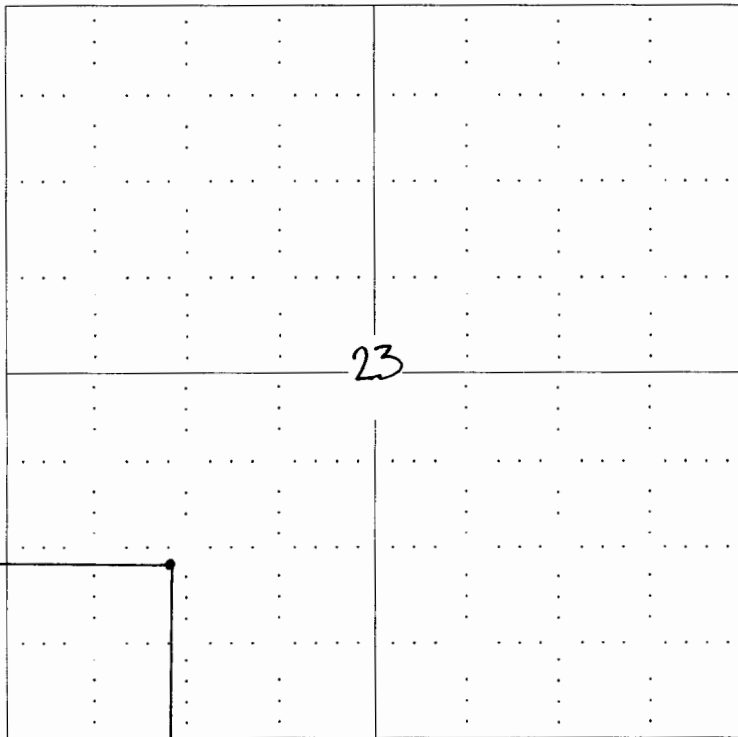

SEWARD CO.

NOTE: In all cases locate the spot of the proposed drilling location.

In plotting the proposed location of the well, you must show:

- 1. The manner in which you are using the depicted plat by identifying section lines, i.e. 1 section, 1 section with 8 surrounding sections, 4 sections, etc.
- 2. The distance of the proposed drilling location from the section's south / north and east / west.
- 3. The distance to the nearest lease or unit boundary line.
- 4. If proposed location is located within a prorated or spaced field a certificate of acreage attribution plat must be attached: (CO-7 for oil wells; CG-8 for gas wells).

KANSAS CORPORATION COMMISSION
OIL & GAS CONSERVATION DIVISION

RECEIVED

Form CDP-1
April 2004
Form must be Typed

APPLICATION FOR SURFACE PIT

APR 03 2006

Submit in Duplicate

KCC WICHITA

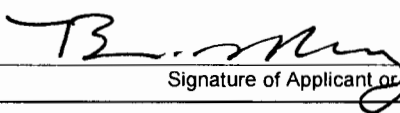
Operator Name: Oil Producers Inc. of Kansas		License Number: 8061	
Operator Address: 1710 Waterfront Parkway, Wichita, KS 67206			
Contact Person: Lori Wedel		Phone Number: (316) 681 - 0231	
Lease Name & Well No.: Stanley #2A-23		Pit Location (QQQQ): <u>Approximately</u> _____ NE _____ SW _____ SW	
Type of Pit: <input type="checkbox"/> Emergency Pit <input type="checkbox"/> Burn Pit <input type="checkbox"/> Settling Pit <input checked="" type="checkbox"/> Drilling Pit <input type="checkbox"/> Workover Pit <input type="checkbox"/> Haul-Off Pit (If WP Supply API No. or Year Drilled)		Pit is: <input checked="" type="checkbox"/> Proposed <input type="checkbox"/> Existing If Existing, date constructed: _____ Pit capacity: 512 _____ (bbls)	
Is the pit located in a Sensitive Ground Water Area? <input type="checkbox"/> Yes <input checked="" type="checkbox"/> No		Chloride concentration: _____ mg/l (For Emergency Pits and Settling Pits only)	
Is the bottom below ground level? <input checked="" type="checkbox"/> Yes <input type="checkbox"/> No		Artificial Liner? <input type="checkbox"/> Yes <input checked="" type="checkbox"/> No	
How is the pit lined if a plastic liner is not used?			
Pit dimensions (all but working pits): <u>80</u> Length (feet) <u>8</u> Width (feet) _____ N/A: Steel Pits Depth from ground level to deepest point: <u>6</u> (feet)			
If the pit is lined give a brief description of the liner material, thickness and installation procedure.		Describe procedures for periodic maintenance and determining liner integrity, including any special monitoring.	
Distance to nearest water well within one-mile of pit <u>2333</u> feet Depth of water well <u>300</u> feet		Depth to shallowest fresh water <u>210</u> feet. <u>Industrial</u> Source of information: <u>JR-KGS</u> _____ measured _____ well owner _____ electric log _____ KDWR	
Emergency, Settling and Burn Pits ONLY: Producing Formation: _____ Number of producing wells on lease: _____ Barrels of fluid produced daily: _____ Does the slope from the tank battery allow all spilled fluids to flow into the pit? <input type="checkbox"/> Yes <input type="checkbox"/> No		Drilling, Workover and Haul-Off Pits ONLY: Type of material utilized in drilling/workover: <u>Chemical</u> Number of working pits to be utilized: <u>2</u> Abandonment procedure: <u>Evaporate & Restore</u> _____ Drill pits must be closed within 365 days of spud date.	
I hereby certify that the above statements are true and correct to the best of my knowledge and belief.			
3/31/2006 Date		 Signature of Applicant or Agent	
KCC OFFICE USE ONLY			
Date Received: <u>4/3/06</u> Permit Number: _____ Permit Date: <u>4/3/06</u> Lease Inspection: <input type="checkbox"/> Yes <input checked="" type="checkbox"/> No			

15175 220430000