

For KCC Use: 4-12-06
Effective Date: _____
District #: 3
SGA? Yes No

KANSAS CORPORATION COMMISSION
OIL & GAS CONSERVATION DIVISION

Form C-1
December 2002
Form must be Typed
Form must be Signed
All blanks must be Filled

Must be approved by KCC five (5) days prior to commencing well

Expected Spud Date April 10, 2006
month day year

OPERATOR: License# 33365 ✓
Name: Layne Energy Operating, LLC
Address: 1900 Shawnee Mission Parkway
City/State/Zip: Mission Woods, KS 66205
Contact Person: M. B. Natrass
Phone: 913-748-3987

CONTRACTOR: License# 33606 ✓
Name: Thorton Air

Well Drilled For:	Well Class:	Type Equipment:
<input type="checkbox"/> Oil	<input type="checkbox"/> Enh Rec	<input checked="" type="checkbox"/> Infield ✓
<input checked="" type="checkbox"/> Gas ✓	<input type="checkbox"/> Storage	<input type="checkbox"/> Pool Ext.
<input type="checkbox"/> OWWO	<input type="checkbox"/> Disposal	<input type="checkbox"/> Wildcat
<input type="checkbox"/> Seismic; # of Holes	<input type="checkbox"/> Other	<input type="checkbox"/> Mud Rotary
<input type="checkbox"/> Other		<input checked="" type="checkbox"/> Air Rotary ✓
		<input type="checkbox"/> Cable

If OWWO: old well information as follows:
Operator: _____
Well Name: _____
Original Completion Date: _____ Original Total Depth: _____

Directional, Deviated or Horizontal wellbore? Yes No

If Yes, true vertical depth: _____

Bottom Hole Location: _____

KCC DKT #: _____

* 40' minimum surface casing Alt 2.

Spot _____ NE _____ NW _____ Sec. 36 Twp. 30 S. R. 14 East West
660 feet from N / S Line of Section
1979 feet from E / W Line of Section
Is SECTION Regular Irregular?

(Note: Locate well on the Section Plat on reverse side)

County: Wilson
Lease Name: Gorton Well #: 3-36

Field Name: Cherokee Basin Coal

Is this a Prorated / Spaced Field? Yes No ✓

Target Formation(s): Cherokee Coals

Nearest Lease or unit boundary: 660' ✓

Ground Surface Elevation: 924' feet MSL

Water well within one-quarter mile: Yes No ✓

Public water supply well within one mile: Yes No ✓

Depth to bottom of fresh water: 150

Depth to bottom of usable water: 200

Surface Pipe by Alternate: 1 2

* Length of Surface Pipe Planned to be set: 20' 40' min

Length of Conductor Pipe required: None

Projected Total Depth: 1500 Feet

Formation at Total Depth: Mississippian

Water Source for Drilling Operations: Well Farm Pond Other X

DWR Permit #: _____

(Note: Apply for Permit with DWR)

Will Cores be taken? Yes No ✓

If Yes, proposed zone: _____

AFFIDAVIT

The undersigned hereby affirms that the drilling, completion and eventual plugging of this well will comply with K.S.A. 55 et. seq. **APR 05 2006**

It is agreed that the following minimum requirements will be met:

1. Notify the appropriate district office **prior** to spudding of well;
2. A copy of the approved notice of intent to drill **shall be** posted on each drilling rig;
3. The minimum amount of surface pipe as specified below **shall be set** by circulating cement to the top; in all cases surface pipe **shall be set** through all unconsolidated materials plus a minimum of 20 feet into the underlying formation.
4. If the well is **dry hole**, an agreement between the operator and the district office on plug length and placement is necessary **prior to plugging**;
5. The appropriate district office will be notified before well is either plugged or production casing is cemented in;
6. If an ALTERNATE II COMPLETION, production pipe shall be cemented from below any usable water to surface within **120 days** of spud date.
Or pursuant to Appendix "B" - Eastern Kansas surface casing order #133,891-C, which applies to the KCC District 3 area, alternate II cementing must be completed within 30 days of the spud date or the well shall be plugged. **In all cases, NOTIFY district office** prior to any cementing.

I hereby certify that the statements made herein are true and to the best of my knowledge and belief.

Date: April 4, 2006 Signature of Operator or Agent: MR. Natrass Title: Agent

For KCC Use ONLY

API # 15 - 205-26517-00-00

Conductor pipe required None feet

Minimum surface pipe required 40 feet per Alt. X2

Approved by: Ritt 4-7-06

This authorization expires: 10-7-06

(This authorization void if drilling not started within 6 months of effective date.)

Spud date: _____ Agent: _____

Remember to:

- File Drill Pit Application (form CDP-1) with Intent to Drill;
- File Completion Form ACO-1 within 120 days of spud date;
- File acreage attribution plat according to field proration orders;
- Notify appropriate district office 48 hours prior to workover or re-entry;
- Submit plugging report (CP-4) after plugging is completed;
- Obtain written approval before disposing or injecting salt water.
- If this permit has expired (See: authorized expiration date) please check the box below and return to the address below.

Well Not Drilled - Permit Expired

Signature of Operator or Agent: _____

Date: _____

Mail to: KCC - Conservation Division, 130 S. Market - Room 2078, Wichita, Kansas 67202

RECEIVED
KANSAS CORPORATION COMMISSION

CONSERVATION DIVISION
WICHITA, KS

36
30
14E

IN ALL CASES PLOT THE INTENDED WELL ON THE PLAT BELOW

Plat of acreage attributable to a well in a prorated or spaced field

If the intended well is in a prorated or spaced field, please fully complete this side of the form. If the intended well is in a prorated or spaced field complete the plat below showing that the well will be properly located in relationship to other wells producing from the common source of supply. Please show all the wells and within 1 mile of the boundaries of the proposed acreage attribution unit for gas wells and within 1/2 mile of the boundaries of the proposed acreage attribution unit for oil wells.

API No. 15 - 205-26517-00-00
 Operator: Layne Energy Operating, LLC
 Lease: Gorton
 Well Number: 3-36
 Field: Cherokee Basin Coal
 Number of Acres attributable to well: _____
 QTR / QTR / QTR of acreage: _____ - NE - NW

Location of Well: County: Wilson
660 feet from N / S Line of Section
1979 feet from E / W Line of Section
 Sec. 36 Twp. 30 S. R. 14 East West

Is Section: Regular or Irregular

If Section is Irregular, locate well from nearest corner boundary.

Section corner used: NE NW SE SW

PLAT

*(Show location of the well and shade attributable acreage for prorated or spaced wells.)
 (Show footage to the nearest lease or unit boundary line.)*

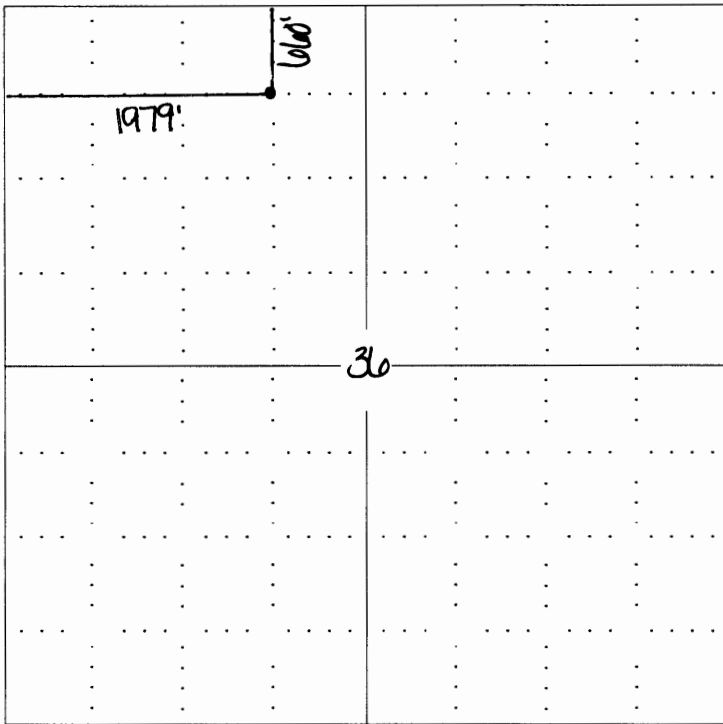

RECEIVED
 KANSAS CORPORATION COMMISSION
 APR 05 2006
 CONSERVATION DIVISION
 WICHITA, KS

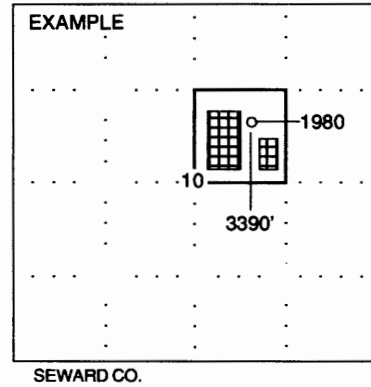

NOTE: In all cases locate the spot of the proposed drilling location.

In plotting the proposed location of the well, you must show:

1. The manner in which you are using the depicted plat by identifying section lines, i.e. 1 section, 1 section with 8 surrounding sections, 4 sections, etc.
2. The distance of the proposed drilling location from the section's south / north and east / west.
3. The distance to the nearest lease or unit boundary line.
4. If proposed location is located within a prorated or spaced field a certificate of acreage attribution plat must be attached: (CO-7 for oil wells; CG-8 for gas wells).

KANSAS CORPORATION COMMISSION
OIL & GAS CONSERVATION DIVISION
APPLICATION FOR SURFACE PIT

Form CDP-1
April 2004
Form must be Typed

Submit in Duplicate

Operator Name: Layne Energy Operating, LLC		License Number: 33365
Operator Address: 1900 Shawnee Mission Parkway, Mission Woods, KS 66205		
Contact Person: M. B. Natrass		Phone Number: (913) 748 - 3987
Lease Name & Well No.: Gorton 3-36		Pit Location (QQQQ): _____ - _____ - NE - NW
Type of Pit: <input type="checkbox"/> Emergency Pit <input type="checkbox"/> Burn Pit <input type="checkbox"/> Settling Pit <input checked="" type="checkbox"/> Drilling Pit <input type="checkbox"/> Workover Pit <input type="checkbox"/> Haul-Off Pit <small>(If WP Supply API No. or Year Drilled)</small>	Pit is: <input checked="" type="checkbox"/> Proposed <input type="checkbox"/> Existing If Existing, date constructed: _____ Pit capacity: _____ (bbls)	Sec. 36 Twp. 30 R. 14 <input checked="" type="checkbox"/> East <input type="checkbox"/> West 660 Feet from <input checked="" type="checkbox"/> North / <input type="checkbox"/> South Line of Section 1979 Feet from <input type="checkbox"/> East / <input checked="" type="checkbox"/> West Line of Section Wilson _____ County
Is the pit located in a Sensitive Ground Water Area? <input type="checkbox"/> Yes <input checked="" type="checkbox"/> No		Chloride concentration: _____ mg/l <small>(For Emergency Pits and Settling Pits only)</small>
Is the bottom below ground level? <input checked="" type="checkbox"/> Yes <input type="checkbox"/> No	Artificial Liner? <input type="checkbox"/> Yes <input checked="" type="checkbox"/> No	How is the pit lined if a plastic liner is not used? Self-sealing pit
Pit dimensions (all but working pits): 30' Length (feet) 20' Width (feet) _____ N/A: Steel Pits Depth from ground level to deepest point: 3' (feet)		
If the pit is lined give a brief description of the liner material, thickness and installation procedure.		Describe procedures for periodic maintenance and determining liner integrity, including any special monitoring. <div style="text-align: right;">APR 05 2006 KANSAS CORPORATION COMMISSION CONSERVATION DIVISION WICHITA, KS</div>
Distance to nearest water well within one-mile of pit N/A feet Depth of water well _____ feet	Depth to shallowest fresh water _____ feet. Source of information: _____ measured _____ well owner _____ electric log _____ KDWR	
Emergency, Settling and Burn Pits ONLY: Producing Formation: _____ Number of producing wells on lease: _____ Barrels of fluid produced daily: _____ Does the slope from the tank battery allow all spilled fluids to flow into the pit? <input type="checkbox"/> Yes <input type="checkbox"/> No	Drilling, Workover and Haul-Off Pits ONLY: Type of material utilized in drilling/workover: Fresh Water Mud Number of working pits to be utilized: Two Abandonment procedure: Let Evaporate until dry and then backfill restore. Drill pits must be closed within 365 days of spud date.	
I hereby certify that the above statements are true and correct to the best of my knowledge and belief.		
_____ April 4, 2006 _____ Date		_____ MB Natrass _____ Signature of Applicant or Agent
KCC OFFICE USE ONLY		
Date Received: 4/5/06 Permit Number: _____ Permit Date: 4/5/06 Lease Inspection: <input type="checkbox"/> Yes <input checked="" type="checkbox"/> No		

Mall to: KCC - Conservation Division, 130 S. Market - Room 2078, Wichita, Kansas 67202

15-205-20517-00-00