

RECEIVED

APR 07 2006

Form C-1

December 2002

Form must be Typed

All blanks must be Filled

For KCC Use: 415-00
Effective Date: _____
District # 1
SGA? Yes No

KANSAS CORPORATION COMMISSION
OIL & GAS CONSERVATION DIVISION

NOTICE OF INTENT TO DRILL

KCC WICHITA

Must be approved by KCC five (5) days prior to commencing well

Expected Spud Date April 11 2006
month day year

OPERATOR: License# KLN 4767 ✓
Name: Ritchie Exploration, Inc.
Address: PO 783188
City/State/Zip: Wichita, KS 67278-3188
Contact Person: Craig Caulk
Phone: 316-691-9500

CONTRACTOR: License# KLN 30684 ✓
Name: Abercrombie RTD, Inc.

Well Drilled For: Oil ✓ Enh Rec Infield Mud Rotary ✓
 Gas ✓ Storage Pool Ext. Air Rotary
 OWWO Disposal Wildcat ✓ Cable
 Seismic; _____ # of Holes Other
 Other _____

If OWWO: old well information as follows:
Operator: _____
Well Name: _____
Original Completion Date: _____ Original Total Depth: _____

Directional, Deviated or Horizontal wellbore? Yes No
If Yes, true vertical depth: _____
Bottom Hole Location: _____
KCC DKT #: _____

Spot _____ East
C - SE - SE Sec. 8 Twp. 29 S. R. 31 West
660 feet from N / S Line of Section
660 feet from E / W Line of Section
Is SECTION Regular Irregular?

(Note: Locate well on the Section Plat on reverse side)

County: Haskell
Lease Name: Shriners Well #: 1
Field Name: Wildcat

Is this a Prorated / Spaced Field? Yes No ✓

Target Formation(s): Mississippian

Nearest Lease or unit boundary: 660' ✓

Ground Surface Elevation: 2869.1 feet MSL

Water well within one-quarter mile: Yes No ✓

Public water supply well within one mile: Yes No ✓

Depth to bottom of fresh water: 700 ✓

Depth to bottom of usable water: 700 ✓

Surface Pipe by Alternate: 1 2

Length of Surface Pipe Planned to be set: 1,750 ✓

Length of Conductor Pipe required: NONE ✓

Projected Total Depth: 5750'

Formation at Total Depth: Mississippian

Water Source for Drilling Operations:

Well Farm Pond Other X

DWR Permit #: _____

(Note: Apply for Permit with DWR)

Will Cores be taken? Yes No

If Yes, proposed zone: _____

AFFIDAVIT

The undersigned hereby affirms that the drilling, completion and eventual plugging of this well will comply with K.S.A. 55 et. seq.

It is agreed that the following minimum requirements will be met:

1. Notify the appropriate district office **prior** to spudding of well;
2. A copy of the approved notice of intent to drill **shall be** posted on each drilling rig;
3. The minimum amount of surface pipe as specified below **shall be set** by circulating cement to the top; in all cases surface pipe **shall be set** through all unconsolidated materials plus a minimum of 20 feet into the underlying formation.
4. If the well is dry hole, an agreement between the operator and the district office on plug length and placement is necessary **prior to plugging**;
5. The appropriate district office will be notified before well is either plugged or production casing is cemented in;
6. If an ALTERNATE II COMPLETION, production pipe shall be cemented from below any usable water to surface within **120 days** of spud date.
Or pursuant to Appendix "B" - Eastern Kansas surface casing order #133,891-C, which applies to the KCC District 3 area, alternate II cementing must be completed within 30 days of the spud date or the well shall be plugged. **In all cases, NOTIFY district office** prior to any cementing.

I hereby certify that the statements made herein are true and to the best of my knowledge and belief.

Date: April 6, 2006 Signature of Operator or Agent: [Signature] Title: GIS Specialist / Geological Technician

For KCC Use ONLY
API # 15 - 081-21659-00-00
Conductor pipe required None feet
Minimum surface pipe required 720 feet per Alt. OX
Approved by: RCH 4-10-06
This authorization expires: 10-10-06
(This authorization void if drilling not started within 6 months of effective date.)
Spud date: _____ Agent: _____

Remember to:

- File Drill Pit Application (form CDP-1) with Intent to Drill;
- File Completion Form ACO-1 within 120 days of spud date;
- File acreage attribution plat according to field proration orders;
- Notify appropriate district office 48 hours prior to workover or re-entry;
- Submit plugging report (CP-4) after plugging is completed;
- Obtain written approval before disposing or injecting salt water.
- If this permit has expired (See: authorized expiration date) please check the box below and return to the address below.

Well Not Drilled - Permit Expired

Signature of Operator or Agent: _____

Date: _____

Mail to: KCC - Conservation Division, 130 S. Market - Room 2078, Wichita, Kansas 67202

8 29 31 W

RECEIVED

APR 07 2006

KCC WICHITA

IN ALL CASES PLOT THE INTENDED WELL ON THE PLAT BELOW

Plat of acreage attributable to a well in a prorated or spaced field

If the intended well is in a prorated or spaced field, please fully complete this side of the form. If the intended well is in a prorated or spaced field complete the plat below showing that the well will be properly located in relationship to other wells producing from the common source of supply. Please show all the wells and within 1 mile of the boundaries of the proposed acreage attribution unit for gas wells and within 1/2 mile of the boundaries of the proposed acreage attribution unit for oil wells.

API No. 15 - 081-21659-00-00
Operator: Ritchie Exploration, Inc.
Lease: Shriners
Well Number: 1
Field: Wildcat

Location of Well: County: Haskell
660 feet from N / S Line of Section
660 feet from E / W Line of Section
Sec. 8 Twp. 29 S. R. 31 East West

Number of Acres attributable to well:
QTR / QTR / QTR of acreage: C SE SE

Is Section: Regular or Irregular
If Section is Irregular, locate well from nearest corner boundary.
Section corner used: NE NW SE SW

PLAT

(Show location of the well and shade attributable acreage for prorated or spaced wells.)

(Show footage to the nearest lease or unit boundary line.)

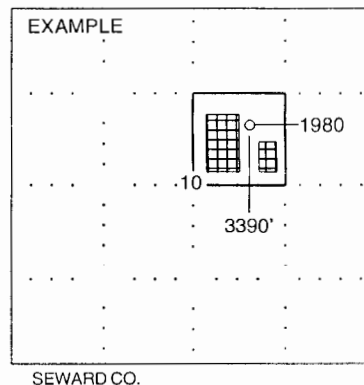
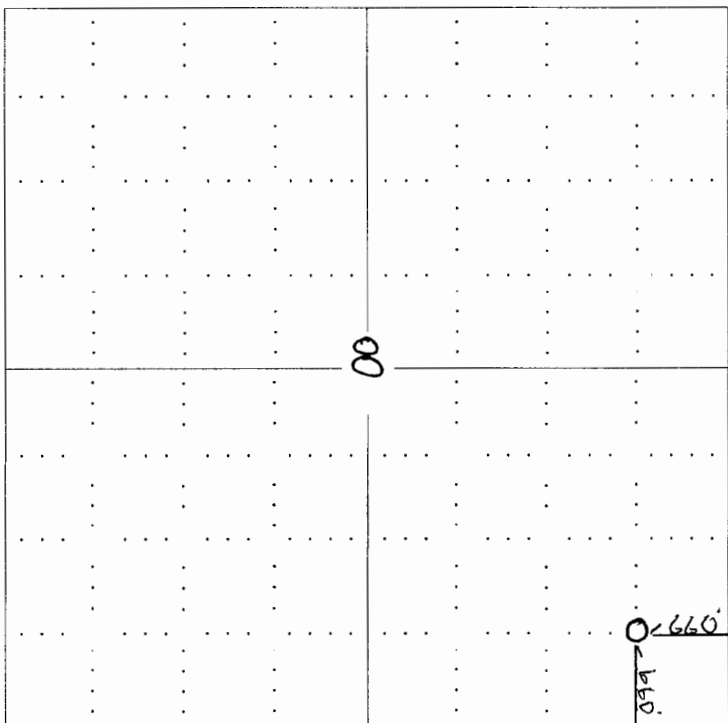

NOTE: In all cases locate the spot of the proposed drilling location.

In plotting the proposed location of the well, you must show:

- 1. The manner in which you are using the depicted plat by identifying section lines, i.e. 1 section, 1 section with 8 surrounding sections, 4 sections, etc.
2. The distance of the proposed drilling location from the section's south / north and east / west.
3. The distance to the nearest lease or unit boundary line.
4. If proposed location is located within a prorated or spaced field a certificate of acreage attribution plat must be attached: (CO-7 for oil wells; CG-8 for gas wells).

KANSAS CORPORATION COMMISSION
OIL & GAS CONSERVATION DIVISION
APPLICATION FOR SURFACE PIT

RECEIVED
APR 07 2006
KCC WICHITA

Form CDP-1
April 2004
Form must be Typed

Submit in Duplicate

Operator Name: Ritchie Exploration, Inc.		License Number: KLN 4767
Operator Address: PO 783188 Wichita, KS 67278-3188		
Contact Person: Craig Caulk		Phone Number: (316) 691 - 9500
Lease Name & Well No.: #1 Shriners		Pit Location (QQQQ): C SE SE
Type of Pit: <input type="checkbox"/> Emergency Pit <input type="checkbox"/> Burn Pit <input type="checkbox"/> Settling Pit <input checked="" type="checkbox"/> Drilling Pit <input type="checkbox"/> Workover Pit <input type="checkbox"/> Haul-Off Pit <i>(If WP Supply API No. or Year Drilled)</i>	Pit is: <input checked="" type="checkbox"/> Proposed <input type="checkbox"/> Existing If Existing, date constructed: _____ Pit capacity: 20,517 (bbls)	Sec. 8 Twp. 29S R. 31 <input type="checkbox"/> East <input checked="" type="checkbox"/> West 660 Feet from <input type="checkbox"/> North / <input checked="" type="checkbox"/> South Line of Section 660 Feet from <input checked="" type="checkbox"/> East / <input type="checkbox"/> West Line of Section Haskell County
Is the pit located in a Sensitive Ground Water Area? <input type="checkbox"/> Yes <input checked="" type="checkbox"/> No		Chloride concentration: _____ mg/l <i>(For Emergency Pits and Settling Pits only)</i>
Is the bottom below ground level? <input checked="" type="checkbox"/> Yes <input type="checkbox"/> No	Artificial Liner? <input type="checkbox"/> Yes <input checked="" type="checkbox"/> No	How is the pit lined if a plastic liner is not used? Cottonseed Hulls / AquaGel
Pit dimensions (all but working pits): 120 Length (feet) 120 Width (feet) N/A: Steel Pits Depth from ground level to deepest point: 8 (feet)		
If the pit is lined give a brief description of the liner material, thickness and installation procedure.		Describe procedures for periodic maintenance and determining liner integrity, including any special monitoring.
Distance to nearest water well within one-mile of pit 467 feet Depth of water well 407 feet		Depth to shallowest fresh water 208 feet Source of information: KH Co 1 _____ measured _____ well owner _____ electric log _____ KDWR
Emergency, Settling and Burn Pits ONLY: Producing Formation: _____ Number of producing wells on lease: _____ Barrels of fluid produced daily: _____ Does the slope from the tank battery allow all spilled fluids to flow into the pit? <input type="checkbox"/> Yes <input type="checkbox"/> No		Drilling, Workover and Haul-Off Pits ONLY: Type of material utilized in drilling/workover: Fresh / Chemical Mud Number of working pits to be utilized: 3 Abandonment procedure: Backfill Drill pits must be closed within 365 days of spud date.
I hereby certify that the above statements are true and correct to the best of my knowledge and belief.		
_____ April 6, 2006 Date		_____ Signature of Applicant or Agent
KCC OFFICE USE ONLY		
Date Received: 4/7/06 Permit Number: _____ Permit Date: 4/2/06 Lease Inspection: <input type="checkbox"/> Yes <input checked="" type="checkbox"/> No		

15-081-21659-00-00

Mail to: KCC - Conservation Division, 130 S. Market - Room 2078, Wichita, Kansas 67202