

For KCC Use: 4-16-06
Effective Date: _____
District # 1
SGA? Yes No

KANSAS CORPORATION COMMISSION
OIL & GAS CONSERVATION DIVISION

Form C-1
September 1999
Form must be Typed
Form must be Signed
All blanks must be Filled

NOTICE OF INTENT TO DRILL

Must be approved by KCC five (5) days prior to commencing well

Expected Spud Date May 01, 2006
month day year

Spot _____ East
_____ C _____ NW Sec. 22 Twp. 32S S. R. 35 West

OPERATOR: License# 5208 ✓
Name: ExxonMobil Oil Corporation
Address: P.O. Box 4358
City/State/Zip: Houston, TX 77210-4358
Contact Person: Roy Springfield
Phone: 281-654-1932

1250 feet from S / (N) (circle one) Line of Section
1250 feet from E / (W) (circle one) Line of Section
Is SECTION Regular _____ Irregular?

(Note: Locate well on the Section Plat on reverse side)

CONTRACTOR: License# 33545 ✓
Name: Pioneer Drilling Services

RECEIVED
KANSAS CORPORATION COMMISSION
APR 07 2006
CONSERVATION DIVISION
WICHITA, KS

Lease Name: Moore Well #: 4-22
Field Name: Panoma

Is this a Prorated / Spaced Field? Yes No

Well Drilled For: Well Class: Type Equipment:
 Oil Enh Rec Infield Mud Rotary
 Gas Storage Pool Ext. Air Rotary
 OWWO Disposal Wildcat Cable
 Seismic: _____ # of Holes Other
 Other _____

Target Formation(s): Council Grove
Nearest Lease or unit boundary: 1250
Ground Surface Elevation: 2999 feet MSL

Water well within one-quarter mile: Yes No

Public water supply well within one mile: Yes No

Depth to bottom of fresh water: 500

Depth to bottom of usable water: 571

Surface Pipe by Alternate: X 1 _____ 2

Length of Surface Pipe Planned to be set: 640

Length of Conductor Pipe required: NA

Projected Total Depth: 3600

Formation at Total Depth: Council Grove

Water Source for Drilling Operations:
Well _____ Farm Pond _____ Other Hauled

DWR Permit #: _____

(Note: Apply for Permit with DWR)

Will Cores be taken? Yes No

If Yes, proposed zone: _____

If OWWO: old well information as follows:
Operator: _____
Well Name: _____
Original Completion Date: _____ Original Total Depth: _____
Directional, Deviated or Horizontal wellbore? Yes No
If Yes, true vertical depth: _____
Bottom Hole Location: _____
KCC DKT #: _____

AFFIDAVIT

The undersigned hereby affirms that the drilling, completion and eventual plugging of this well will comply with K.S.A. 55-101, et. seq.
It is agreed that the following minimum requirements will be met:

1. Notify the appropriate district office **prior** to spudding of well;
2. A copy of the approved notice of intent to drill **shall be** posted on each drilling rig;
3. The minimum amount of surface pipe as specified below **shall be set** by circulating cement to the top; in all cases surface pipe **shall be set** through all unconsolidated materials plus a minimum of 20 feet into the underlying formation.
4. If the well is dry hole, an agreement between the operator and the district office on plug length and placement is necessary **prior to plugging**;
5. The appropriate district office will be notified before well is either plugged or production casing is cemented in;
6. If an ALTERNATE II COMPLETION, production pipe shall be cemented from below any usable water to surface within **120 days** of spud date. **In all cases, NOTIFY district office** prior to any cementing.

I hereby certify that the statements made herein are true and to the best of my knowledge and belief.

Date: 04/06/2006 Signature of Operator or Agent: [Signature] Title: Staff Regulatory Specialist

For KCC Use ONLY
API # 15 - 189-22514-0000
Conductor pipe required None feet
Minimum surface pipe required 600 feet per Alt. 1
Approved by: RH 4-16-06
This authorization expires: 10-11-06
(This authorization void if drilling not started within 6 months of effective date.)
Spud date: _____ Agent: _____

Remember to:

- File Drill Pit Application (form CDP-1) with Intent to Drill;
- File Completion Form ACO-1 within 120 days of spud date;
- File acreage attribution plat according to field proration orders;
- Notify appropriate district office 48 hours prior to workover or re-entry;
- Submit plugging report (CP-4) after plugging is completed;
- Obtain written approval before disposing or injecting salt water.

Mail to: KCC - Conservation Division, 130 S. Market - Room 2078, Wichita, Kansas 67202

22
32
35W

IN ALL CASES PLOT THE INTENDED WELL ON THE PLAT BELOW

Plat of acreage attributable to a well in a prorated or spaced field

If the intended well is in a prorated or spaced field, please fully complete this side of the form. If the intended well is in a prorated or spaced field complete the plat below showing that the well will be properly located in relationship to other wells producing from the common source of supply. Please show all the wells and within 1 mile of the boundaries of the proposed acreage attribution unit for gas wells and within 1/2 mile of the boundaries of the proposed acreage attribution unit for oil wells.

API No. 15 - _____
 Operator: ExxonMobil Oil Corporation
 Lease: Moore
 Well Number: 4-22
 Field: Panoma
 Number of Acres attributable to well: 640
 QTR / QTR / QTR of acreage: _____ - C - _____ NW

Location of Well: County: Stevens
 1250 _____ feet from S N (circle one) Line of Section
 1250 _____ feet from E / W (circle one) Line of Section
 Sec. 22 Twp. 32S S. R. 35 East West

Is Section Regular or _____ Irregular

If Section is Irregular, locate well from nearest corner boundary.
 Section corner used: ___ NE ___ NW ___ SE ___ SW

PLAT

*(Show location of the well and shade attributable acreage for prorated or spaced wells.)
 (Show footage to the nearest lease or unit boundary line.)*

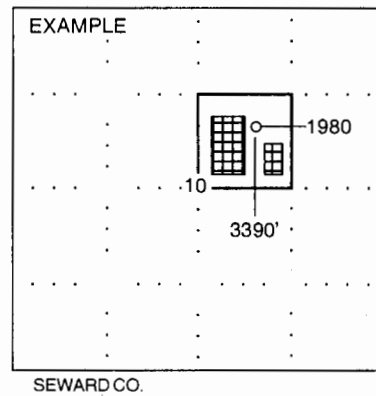
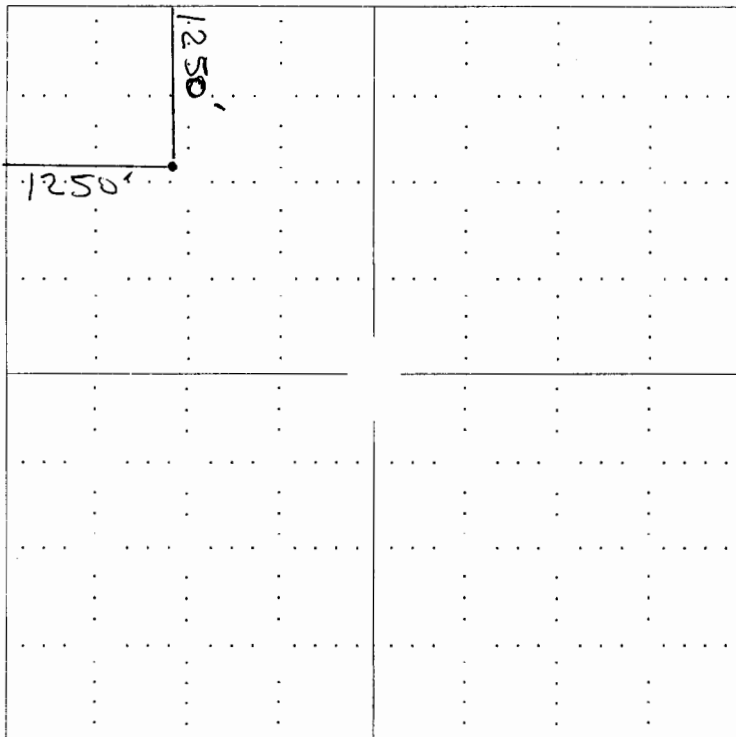

NOTE: In all cases locate the spot of the proposed drilling locaton.

In plotting the proposed location of the well, you must show:

1. The manner in which you are using the depicted plat by identifying section lines, i.e. 1 section, 1 section with 8 surrounding sections, 4 sections, etc.
2. The distance of the proposed drilling location from the section's south / north and east / west.
3. The distance to the nearest lease or unit boundary line.
4. If proposed location is located within a prorated or spaced field a certificate of acreage attribution plat must be attached: (CO-7 for oil wells; CG-8 for gas wells).

RECEIVED
KANSAS CORPORATION COMMISSION 12/91

KANSAS CORPORATION COMMISSION
CONSERVATION DIVISION
130 S MARKET ROOM 2078
WICHITA KS 67202

APR 07 2006

CONSERVATION DIVISION
WICHITA, KS

APPLICATION FOR SURFACE POND

FORM MUST BE TYPED

SUBMIT IN DUPLICATE

OPERATOR NAME <u>ExxonMobil Oil Corporation</u>		LICENSE NO. <u>5208</u>
OPERATOR ADDRESS <u>PO Box 4358 Houston, TX 77210-4358</u>		
CONTACT PERSON <u>Roy Springfield</u>		PHONE NUMBER <u>(281) 654-1932</u>
LEASE NAME <u>Moore 4-22</u>	PIT IS: <input checked="" type="checkbox"/> Proposed <input type="checkbox"/> Existing If existing, date constructed: _____ PIT CAPACITY: _____ (bbls)	PIT LOCATION <u>NW</u> Qtr. Sec <u>22</u> Twp <u>32S</u> Rng <u>35</u> <u>EMW</u> <u>1250</u> Ft from <u>N</u> (circle one) Line of Sec. <u>1250</u> Ft from <u>E/W</u> (circle one) Line of Sec. <u>Stevens</u> COUNTY
TYPE OF POND: <input type="checkbox"/> BURN PIT <input type="checkbox"/> EMERGENCY PIT <input type="checkbox"/> TREATMENT PIT <input type="checkbox"/> WORKOVER PIT <input checked="" type="checkbox"/> DRILLING PIT (If WP Supply API No. or Year Drilled)		Is the pit located in a Sensitive Ground Water Area? <input type="checkbox"/> Yes <input checked="" type="checkbox"/> No Chloride concentration: <u><3000</u> mg/l (For Emergency and Treatment Pits only)
Is Pit bottom below ground level? <input checked="" type="checkbox"/> Yes <input type="checkbox"/> No	Artificial Liner? <input type="checkbox"/> Yes <input checked="" type="checkbox"/> No	How is pit lined if a plastic liner is not used? <u>NA</u>
Pit dimensions (all but working pits): <u>80</u> Length (ft) <u>80</u> Width (ft) Depth from ground level to deepest point <u>7</u> (ft)		
If the pit is lined give a brief description of the liner material, thickness and installation procedure. <u>NA</u>	Describe procedures for periodic maintenance and determining liner integrity, including any special monitoring. <u>NA</u>	
Distance to nearest water well within one-mile of pit <u>1547</u> ft. Depth of water well <u>400</u> ft.	Depth to shallowest fresh water <u>220</u> feet. Source of information: <input type="checkbox"/> measured <input type="checkbox"/> well owner <input type="checkbox"/> electric log <input checked="" type="checkbox"/> KDWR	
EMERGENCY, TREATMENT AND BURN PITS ONLY: Producing Formation: _____ Number of producing wells on lease: _____ Barrels of fluid produced daily: _____ Does the slope from the tank battery allow all spilled fluids to flow into the pond? <input type="checkbox"/> Yes <input type="checkbox"/> No	DRILLING AND WORKOVER PITS ONLY: Type of material utilized in drilling/workover: <u>FW Gel Mud</u> Number of working pits to be utilized: <u>2</u> Abandonment procedure: <u>Remove clear water, air dry and backfill.</u> Drill pits must be closed within 365 days of spud date.	
I hereby certify that the above statements are true and correct to the best of my knowledge and belief. <u>04/06/2006</u> Date <u>Roy Springfield</u> Signature of Applicant or Agent		
KCC OFFICE USE ONLY		
Date Rec'd <u>4/7/06</u> Permit No. _____ Permit Date <u>4/7/06</u> Lease Inspection <input type="checkbox"/> Yes <input checked="" type="checkbox"/> No		

15-189-22514-0000