

For KCC Use: 4-17-06
Effective Date: _____
District # 3
SGA? Yes No

KANSAS CORPORATION COMMISSION
OIL & GAS CONSERVATION DIVISION

APR 11 2006

Form C-1
December 2002
Form must be Typed
Form must be Signed
blanks must be Filled

NOTICE OF INTENT TO DRILL

Must be approved by KCC five (5) days prior to commencing well

WICHITA, KS

Expected Spud Date April 20, 2006
month day year

OPERATOR: License# 33344
Name: Quest Cherokee, LLC
Address: 9520 N. May Ave, Suite 300
City/State/Zip: Oklahoma City, OK 73120
Contact Person: Richard Marlin
Phone: 405-488-1304

CONTRACTOR: License# Will be licensed by KCC
Name: Will Advise on ACO -1

Spot E/28 SW SE Sec. 28 Twp. 27 S. R. 18
 East West
660 feet from N / S Line of Section
1500 feet from E / W Line of Section
Is SECTION Regular Irregular?

(Note: Locate well on the Section Plat on reverse side)

County: Neosho
Lease Name: Beachner Bros Well #: 28-27-18-1
Field Name: Cherokee Basin CBM

Is this a Prorated / Spaced Field? Yes No
Target Formation(s): Arbuckle Dolomite

Nearest Lease or unit boundary: 330
Ground Surface Elevation: 924 feet MSL

Water well within one-quarter mile: Yes No

Public water supply well within one mile: Yes No

Depth to bottom of fresh water: 100
Depth to bottom of usable water: 200 / 150

Surface Pipe by Alternate: 1 2

Length of Surface Pipe Planned to be set: 25

Length of Conductor Pipe required: _____
Projected Total Depth: 1500

Formation at Total Depth: Arbuckle Dolomite

Water Source for Drilling Operations:
 Well Farm Pond Other Air

DWR Permit #: _____
(Note: Apply for Permit with DWR)

Will Cores be taken? Yes No
If Yes, proposed zone: _____

Well Drilled For: Oil Gas CWMO Seismic; _____ # of Holes Other
Well Class: Enh Rec Storage Disposal Other
Type Equipment: Infield Pool Ext. Wildcat Other
 Mud Rotary Air Rotary Cable

If OWWO: old well information as follows:
Operator: _____
Well Name: _____
Original Completion Date: _____ Original Total Depth: _____

Directional, Deviated or Horizontal wellbore? Yes No

If Yes, true vertical depth: _____

Bottom Hole Location: _____
KCC DKT #: _____

AFFIDAVIT

The undersigned hereby affirms that the drilling, completion and eventual plugging of this well will comply with K.S.A. 55 et. seq.
It is agreed that the following minimum requirements will be met:

1. Notify the appropriate district office **prior** to spudding of well;
2. A copy of the approved notice of intent to drill **shall be** posted on each drilling rig;
3. The minimum amount of surface pipe as specified below **shall be set** by circulating cement to the top; in all cases surface pipe **shall be set** through all unconsolidated materials plus a minimum of 20 feet into the underlying formation.
4. If the well is dry hole, an agreement between the operator and the district office on plug length and placement is necessary **prior to plugging**;
5. The appropriate district office will be notified before well is either plugged or production casing is cemented in;
6. If an ALTERNATE II COMPLETION, production pipe shall be cemented from below any usable water to surface within **120 days** of spud date.
Or pursuant to Appendix "B" - Eastern Kansas surface casing order #133,891-C, which applies to the KCC District 3 area, alternate II cementing must be completed within 30 days of the spud date or the well shall be plugged. **In all cases, NOTIFY district office** prior to any cementing.

I hereby certify that the statements made herein are true and to the best of my knowledge and belief
Date: 4/10/06 Signature of Operator or Agent: R. Marlin Title: Vice President

For KCC Use ONLY
API # 15 - 133-26603-0000
Conductor pipe required None feet
Minimum surface pipe required 20 feet per Alt. X2
Approved by: Put 4-12-06
This authorization expires: 10-12-06
(This authorization void if drilling not started within 6 months of effective date.)
Spud date: _____ Agent: _____

Remember to:

- File Drill Pit Application (form CDP-1) with Intent to Drill;
- File Completion Form ACO-1 within 120 days of spud date;
- File acreage attribution plat according to field proration orders;
- Notify appropriate district office 48 hours prior to workover or re-entry;
- Submit plugging report (CP-4) after plugging is completed;
- Obtain written approval before disposing or injecting salt water.
- If this permit has expired (See: authorized expiration date) please check the box below and return to the address below.

Well Not Drilled - Permit Expired
Signature of Operator or Agent: _____
Date: _____

Mail to: KCC - Conservation Division, 130 S. Market - Room 2078, Wichita, Kansas 67202

28
27
18E

IN ALL CASES PLOT THE INTENDED WELL ON THE PLAT BELOW

** Plat of acreage attributable to a well in a prorated or spaced field*

If the intended well is in a prorated or spaced field, please fully complete this side of the form. If the intended well is in a prorated or spaced field complete the plat below showing that the well will be properly located in relationship to other wells producing from the common source of supply. Please show all the wells and within 1 mile of the boundaries of the proposed acreage attribution unit for gas wells and within 1/2 mile of the boundaries of the proposed acreage attribution unit for oil wells.

API No. 15 - 133-26603-0000
 Operator: Quest Cherokee, LLC
 Lease: Beachner Bros
 Well Number: 28-27-18-1
 Field: Cherokee Basin CBM
 Number of Acres attributable to well: 40
 QTR / QTR / QTR of acreage: SE - SW - SE

Location of Well: County: Neosho
 660 feet from N / S Line of Section
 1500 feet from E / W Line of Section
 Sec. 28 Twp. 27 S. R. 18 East West

Is Section: Regular or Irregular

If Section is Irregular, locate well from nearest corner boundary.

Section corner used: NE NW SE SW

PLAT

*(Show location of the well and shade attributable acreage for prorated or spaced wells.)
 (Show footage to the nearest lease or unit boundary line.)*

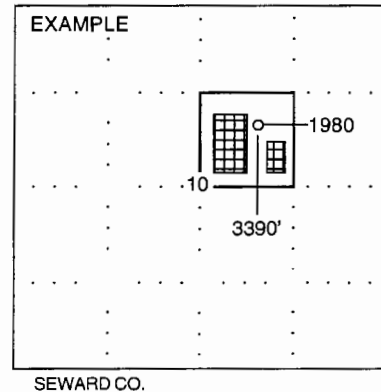
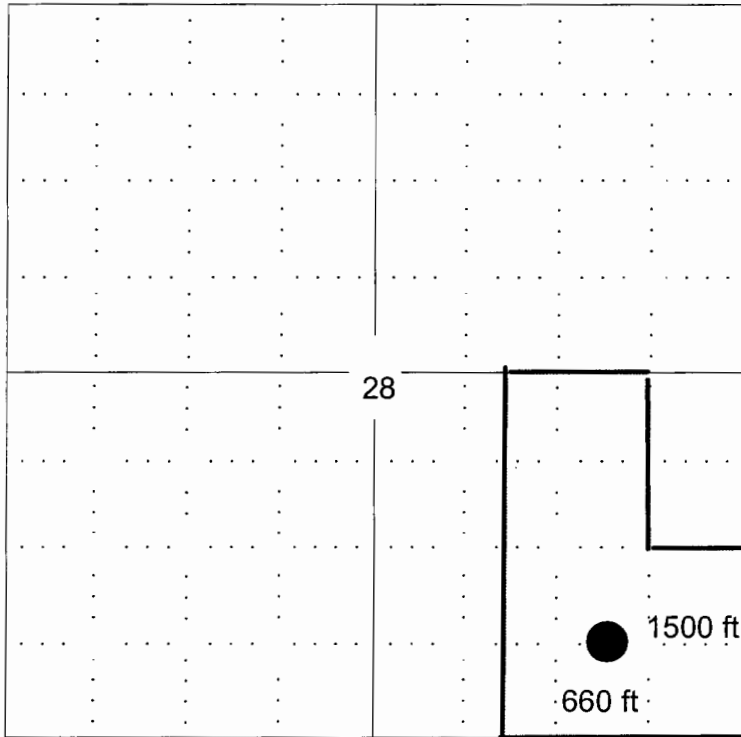

NOTE: In all cases locate the spot of the proposed drilling location.

In plotting the proposed location of the well, you must show:

1. The manner in which you are using the depicted plat by identifying section lines, i.e. 1 section, 1 section with 8 surrounding sections, 4 sections, etc.
2. The distance of the proposed drilling location from the section's south / north and east / west.
3. The distance to the nearest lease or unit boundary line.
4. If proposed location is located within a prorated or spaced field a certificate of acreage attribution plat must be attached: (C0-7 for oil wells; CG-8 for gas wells).

KANSAS CORPORATION COMMISSION
OIL & GAS CONSERVATION DIVISION
APPLICATION FOR SURFACE PIT

RECEIVED

APR 11 2006

Form CDP-1
 April 2004
 Form must be Typed

Submit in Duplicate

CONSERVATION DIVISION
 WICHITA, KS

Operator Name: Quest Cherokee, LLC		License Number: 33344
Operator Address: 9520 N. May Ave, Suite		
Contact Person: Richard Marlin		Phone Number: (405) 488 - 1304
Lease Name & Well No.: Beachner Bros 28-27-18-1		Pit Location (QQQQ): _____ SE _____ SW _____ SE Sec. 28 Twp. 27 R. 18 <input checked="" type="checkbox"/> East <input type="checkbox"/> West 600 Feet from <input type="checkbox"/> North / <input checked="" type="checkbox"/> South Line of Section 1500 Feet from <input checked="" type="checkbox"/> East / <input type="checkbox"/> West Line of Section Neosho _____ County
Type of Pit: <input type="checkbox"/> Emergency Pit <input type="checkbox"/> Burn Pit <input type="checkbox"/> Settling Pit <input checked="" type="checkbox"/> Drilling Pit <input type="checkbox"/> Workover Pit <input type="checkbox"/> Haul-Off Pit <i>(If WP Supply API No. or Year Drilled)</i>	Pit is: <input checked="" type="checkbox"/> Proposed <input type="checkbox"/> Existing If Existing, date constructed: _____ Pit capacity: 300 _____ (bbls)	
Is the pit located in a Sensitive Ground Water Area? <input checked="" type="checkbox"/> Yes <input checked="" type="checkbox"/> No		Chloride concentration: _____ mg/l <i>(For Emergency Pits and Settling Pits only)</i>
Is the bottom below ground level? <input type="checkbox"/> Yes <input checked="" type="checkbox"/> No	Artificial Liner? <input type="checkbox"/> Yes <input checked="" type="checkbox"/> No	How is the pit lined if a plastic liner is not used?
Pit dimensions (all but working pits): 30 Length (feet) 10 Width (feet) _____ N/A: Steel Pits Depth from ground level to deepest point: 10 (feet)		
If the pit is lined give a brief description of the liner material, thickness and installation procedure.		Describe procedures for periodic maintenance and determining liner integrity, including any special monitoring. Air Drilling Operation lasting approx. 3 days
Distance to nearest water well within one-mile of pit 2315 feet Depth of water well 34 feet		Depth to shallowest fresh water 16 feet. Source of information: KHKG 6 _____ measured _____ well owner _____ electric log _____ KDWR
Emergency, Settling and Burn Pits ONLY: Producing Formation: _____ Number of producing wells on lease: _____ Barrels of fluid produced daily: _____ Does the slope from the tank battery allow all spilled fluids to flow into the pit? <input type="checkbox"/> Yes <input type="checkbox"/> No		Drilling, Workover and Haul-Off Pits ONLY: Type of material utilized in drilling/workover: Air Drilled Number of working pits to be utilized: One Abandonment procedure: Air dry, backfill and cover _____ Drill pits must be closed within 365 days of spud date.
I hereby certify that the above statements are true and correct to the best of my knowledge and belief.		
_____ 4/10/06 Date		_____ Signature of Applicant or Agent

KCC OFFICE USE ONLY

- D16T

Date Received: **4/11/06** Permit Number: _____ Permit Date: **4/11/06** Lease Inspection: Yes No

Mail to: KCC - Conservation Division, 130 S. Market - Room 2078, Wichita, Kansas 67202

15-183-26603-0000