

CARD MUST BE TYPED

State of Kansas
NOTICE OF INTENTION TO DRILL
HUGOTON INFILL

CARD MUST BE SIGNED

RECEIVED
APR 11 2006

SCA - NO

EFFECTIVE DATE 4-05-2006

Starting Date Expected May 3 2006
month day year

API Number 15 - 081-21660-0000

KCC WICHITA

OPERATOR: License # 31006
Name Western Pacific Farms, Inc.
Address 2257 100th Road
City/State/Zip Capeland, KS 67837
Contact Person Preston Withers
Phone 620-668-5630 272-1376

NW SW NE IS SECTION X REGULAR IRREGULAR
Sec 2 Twp 29 S, Rg 32 W
3460! 3140! Ft. from South Line of Section
2600! Ft. from East Line of Section

CONTRACTOR: License # 33375
Name Cheyenne Drlg LP
City/State Garden City, KS
Well Drilled as: X New Recompletion OWWO
Projected Total Depth 2900 feet
Formation Hugoton Krider

NOTE: Attach acreage attribution plat locating both Chase (Hugoton) wells
Total number of acres attributed to unit 6.40 ac
Nearest producing well from
same common source of supply 2273! 2535! feet
Nearest lease or unit boundary line 2140! feet
County Haskell
Lease Name Brown Well # 2
Ground surface elevation 2980! feet MSL
Depth to bottom of fresh water 600!
Depth to bottom of usable water 820!
Surface pipe by Alternate: 1 X 2
Surface pipe planned to be set 900!

If OWWO or Recompletion: old well info as follows:
Operator
Well Name
Comp. Date Old Total Depth

Water Source for Drilled Operations:
DWR Permit #: X well farm pond other

I certify that well will comply with K.S.A. 55-101, et seq., plus eventually plugging hole to KCC specifications.
Date 4-05-2006 Signature of Operator or Agent Preston Withers Title Owner

For KCC Use:
Conductor Pipe Required None feet; Minimum Surface Pipe Required 240 feet per Alt. 1
This Authorization Expires 10-13-06 Approved By [Signature] 4-13-06

9/95

Must be filed with K.C.C. five (5) days prior to commencing well
This card void if drilling not started within six (6) months of date received by K.C.C.

A Regular Section of Land
1 Mile = 5,280 Ft.

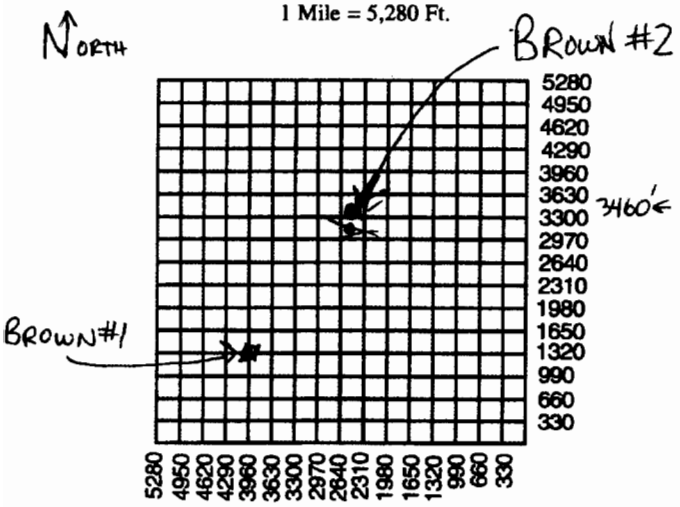

Important procedures to follow:

1. Notify District office before setting surface casing.
2. Set surface casing by circulating cement to the top.
3. File completion forms ACO-1 with K.C.C. within 120 days of well spud date, following instructions on ACO-1, side 1, and including copies of wireline logs.
4. Notify District office 48 hours prior to old well workover or re-entry.
5. Submit plugging report (CP-4) to K.C.C. after plugging is completed.
6. If an alternate 2 completion, cement in the production pipe from below any useable water to surface within 120 days of spud date.

State Corporation Commission of Kansas
Conservation Division
130 S. Market Room 2078
Wichita, Kansas 67202-1212
(316) 337-6231



KANSAS

CORPORATION COMMISSION

KATHLEEN SEBELIUS, GOVERNOR

BRIAN J. MOLINE, CHAIR

ROBERT E. KREHBIEL, COMMISSIONER

MICHAEL C. MOFFET, COMMISSIONER

NOTICE TO OPERATORS DRILLING IN THE PANOMA- COUNCIL GROVE GAS POOL SPACED AREA

The enclosed intent is located within the Panoma-Council Grove gas pool space area. In May 1978, Panoma-Council Grove Proration Order (as amended), Docket No. 60,024-C (C-7058) under FINDINGS OF FACT AND LAW on page 31, the following language is stated that:

“The Commission finds that in order to prevent waste and protect correlative rights, the following stated rules pertaining to wells already completed, in the process of being drilled or for future wells to be drilled in the Panoma Council Grove Gas Pool Spaced area, and for wells producing from the Council Grove Formation outside of the Panoma Council Grove Gas Pool Spaced area within the Hugoton Gas Field, should be adopted.”

1. “No dual completions between the Chase (Hugoton) and Council Grove Formations will be permitted for future wells drilled.”
2. “Casing shall not be set above the top of the Council Grove Formation for a Council Grove producing well.”
3. “The production casing of all new Council Grove wells should be cemented with a calculated volume of cement sufficient to encase the casing from the bottom of the casing to a point 500 feet above the Chase Formation.”
4. “The casing shall be encased in cement in the interval between the base of the Council Grove and the top of the Chase Formation on all wells, irrespective of depth, completed below the Council Grove Formation, if they are located within the space area.”
5. “The cement coverage heretofore required shall be confirmed by the running of a recognized survey, such as a temperature survey or cement bond log.”

A copy of this survey and the cement tickets(s) showing that all cement work has been completed, must be filed with the ACO-1 Completion Report within 120 days from the wells “spud date.”

Failure to comply with these provisions may cause the well to be shut-in until compliance has been achieved.

If you have any questions, please feel free to contact the Conservation Division’s Production Department at (316) 337-6200.

KANSAS CORPORATION COMMISSION
OIL & GAS CONSERVATION DIVISION
APPLICATION FOR SURFACE PIT

RECEIVED

Form CDP-1

April 2004

APR 11 2006

Form must be Typed

KCC WICHITA

Submit in Duplicate

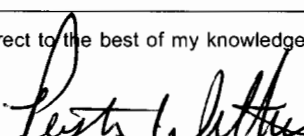
Operator Name: Western Pacific Farms, Inc.		License Number: 31006
Operator Address: 2257 100th Road Copeland KS 67837		
Contact Person: Preston Withers 620 272 1376 cell		Phone Number: (620) 668 - 5630
Lease Name & Well No.: Brown #2-02		Pit Location (QQQQ): _____ NW _____ SW _____ NE Sec. 02 Twp. 29 R. 32 <input type="checkbox"/> East <input checked="" type="checkbox"/> West 3460 Feet from <input type="checkbox"/> North / <input checked="" type="checkbox"/> South Line of Section 2600 Feet from <input checked="" type="checkbox"/> East / <input type="checkbox"/> West Line of Section Haskell Co KS _____ County
Type of Pit: <input type="checkbox"/> Emergency Pit <input type="checkbox"/> Burn Pit <input type="checkbox"/> Settling Pit <input checked="" type="checkbox"/> Drilling Pit <input type="checkbox"/> Workover Pit <input type="checkbox"/> Haul-Off Pit <i>(If WP Supply API No. or Year Drilled)</i>	Pit is: <input checked="" type="checkbox"/> Proposed <input type="checkbox"/> Existing If Existing, date constructed: _____ Pit capacity: 500-1000 (bbls)	
Is the pit located in a Sensitive Ground Water Area? <input type="checkbox"/> Yes <input checked="" type="checkbox"/> No		Chloride concentration: _____ mg/l <i>(For Emergency Pits and Settling Pits only)</i>
Is the bottom below ground level? <input checked="" type="checkbox"/> Yes <input type="checkbox"/> No	Artificial Liner? <input type="checkbox"/> Yes <input checked="" type="checkbox"/> No	How is the pit lined if a plastic liner is not used? Clay Soil Native
Pit dimensions (all but working pits): 200 Length (feet) 200 Width (feet) _____ N/A: Steel Pits Depth from ground level to deepest point: 4' (feet)		
If the pit is lined give a brief description of the liner material, thickness and installation procedure.		Describe procedures for periodic maintenance and determining liner integrity, including any special monitoring.
Distance to nearest water well within one-mile of pit 640' feet Depth of water well 510' feet		Depth to shallowest fresh water 375' feet. Source of information: _____ measured <input checked="" type="checkbox"/> well owner _____ electric log _____ KDWR
Emergency, Settling and Burn Pits ONLY: Producing Formation: _____ Number of producing wells on lease: _____ Barrels of fluid produced daily: _____ Does the slope from the tank battery allow all spilled fluids to flow into the pit? <input type="checkbox"/> Yes <input type="checkbox"/> No		Drilling, Workover and Haul-Off Pits ONLY: Type of material utilized in drilling/workover: Drilling Mud Common Number of working pits to be utilized: _____ Abandonment procedure: Backfilled, Evaporated, Smoothed Drill pits must be closed within 365 days of spud date.
I hereby certify that the above statements are true and correct to the best of my knowledge and belief.		
April 3, 2006 Date		 Signature of Applicant or Agent

15-281-21660-0000

KCC OFFICE USE ONLY			
Date Received: 4/11/06	Permit Number: _____	Permit Date: 4/11/06	Lease Inspection: <input type="checkbox"/> Yes <input checked="" type="checkbox"/> No

Mail to: KCC - Conservation Division, 130 S. Market - Room 2078, Wichita, Kansas 67202