

For KCC Use: 4-22-06
Effective Date: 4
District #: 4
SGA? Yes No

KANSAS CORPORATION COMMISSION
OIL & GAS CONSERVATION DIVISION

RECEIVED

APR 14 2006

Form C-1

December 2002

Form must be Typed

Form must be Signed

Blank must be Filled

NOTICE OF INTENT TO DRILL

Must be approved by KCC five (5) days prior to commencing work

KCC WICHITA

Expected Spud Date 4/22/06
month day year

OPERATOR: License# 30606 ✓
Name: Murfin Drilling Company, Inc.
Address: 250 N. Water, Suite 300
City/State/Zip: Wichita, KS 67202
Contact Person: David Doyel
Phone: 316-267-3241

CONTRACTOR: License# 30606 ✓
Name: Murfin Drilling Company, Inc.

Well Drilled For: Oil Gas O/W/O Seismic; # of Holes Other
 Enh Rec Storage Disposal Other
Well Class: Infield Pool Ext. Wildcat Other
Type Equipment: Mud Rotary Air Rotary Cable

If OWWO: old well information as follows:
Operator: _____
Well Name: _____
Original Completion Date: _____ Original Total Depth: _____
Directional, Deviated or Horizontal wellbore? Yes No
If Yes, true vertical depth: _____
Bottom Hole Location: _____
KCC DKT #: _____

Spot 165'S + 140'W
E/2 - NW - SW Sec. 3 Twp. 11 S. R. 21
 East West
1815 feet from N / S Line of Section
850 feet from E / W Line of Section
Is SECTION Regular Irregular?

(Note: Locate well on the Section Plat on reverse side)

County: Trego
Lease Name: KEJA Well #: 1-3
Field Name: unknown
Is this a Prorated / Spaced Field? Yes No
Target Formation(s): Lansing, Marmaton, Arbuckle
Nearest Lease or unit boundary: 330'
Ground Surface Elevation: 2101' feet MSL
Water well within one-quarter mile: Yes No
Public water supply well within one mile: Yes No
Depth to bottom of fresh water: 150' 180'
Depth to bottom of usable water: 900'
Surface Pipe by Alternate: 1 2
Length of Surface Pipe Planned to be set: 300'
Length of Conductor Pipe required: none
Projected Total Depth: 3800'
Formation at Total Depth: Arbuckle
Water Source for Drilling Operations:
 Well Farm Pond Other X
DWR Permit #: _____
(Note: Apply for Permit with DWR)
Will Cores be taken? Yes No
If Yes, proposed zone: _____

AFFIDAVIT

The undersigned hereby affirms that the drilling, completion and eventual plugging of this well will comply with K.S.A. 55 et. seq.

It is agreed that the following minimum requirements will be met:

1. Notify the appropriate district office **prior** to spudding of well;
2. A copy of the approved notice of intent to drill **shall be** posted on each drilling rig;
3. The minimum amount of surface pipe as specified below **shall be set** by circulating cement to the top; in all cases surface pipe **shall be set** through all unconsolidated materials plus a minimum of 20 feet into the underlying formation.
4. If the well is dry hole, an agreement between the operator and the district office on plug length and placement is necessary **prior to plugging**;
5. The appropriate district office will be notified before well is either plugged or production casing is cemented in;
6. If an ALTERNATE II COMPLETION, production pipe shall be cemented from below any usable water to surface within **120 days** of spud date. Or pursuant to Appendix "B" - Eastern Kansas surface casing order #133,891-C, which applies to the KCC District 3 area, alternate II cementing must be completed within 30 days of the spud date or the well shall be plugged. **In all cases, NOTIFY district office** prior to any cementing.

I hereby certify that the statements made herein are true and to the best of my knowledge and belief.

Date: 4/13/06 Signature of Operator or Agent: Shauna Dumlaman Title: Agent

For KCC Use ONLY
API # 15 - 195-22357-0000
Conductor pipe required None feet
Minimum surface pipe required 200 feet per Alt. X(2)
Approved by: RH 4-17-06
This authorization expires: 10-17-06
(This authorization void if drilling not started within 6 months of approval date.)
Spud date: _____ Agent: _____

Remember to:

- File Drill Pit Application (form CDP-1) with Intent to Drill;
- File Completion Form ACO-1 within 120 days of spud date;
- File acreage attribution plat according to field proration orders;
- Notify appropriate district office 48 hours prior to workover or re-entry;
- Submit plugging report (CP-4) after plugging is completed;
- Obtain written approval before disposing or injecting salt water.
- If this permit has expired (See: authorized expiration date) please check the box below and return to the address below.

Well Not Drilled - Permit Expired

Signature of Operator or Agent: _____
Date: _____

Mail to: KCC - Conservation Division, 130 S. Market - Room 2078, Wichita, Kansas 67202

3
11
21W

IN ALL CASES PLOT THE INTENDED WELL ON THE PLAT BELOW

Plat of acreage attributable to a well in a prorated or spaced field

If the intended well is in a prorated or spaced field, please fully complete this side of the form. If the intended well is in a prorated or spaced field complete the plat below showing that the well will be properly located in relationship to other wells producing from the common source of supply. Please show all the wells and within 1 mile of the boundaries of the proposed acreage attribution unit for gas wells and within 1/2 mile of the boundaries of the proposed acreage attribution unit for oil wells.

API No. 15 - 195-22357-0000
 Operator: Murfin Drilling Company, Inc.
 Lease: KEJA
 Well Number: 1-3
 Field: unknown

Number of Acres attributable to well: _____
 QTR / QTR / QTR of acreage: E/2 - NW - SW

Location of Well: County: Trego
 1815 _____ feet from N / S Line of Section
 850 _____ feet from E / W Line of Section
 Sec. 3 Twp. 11 S. R. 21 East West

Is Section: Regular or Irregular

If Section Is Irregular, locate well from nearest corner boundary.

Section corner used: NE NW SE SW

PLAT

(Show location of the well and shade attributable acreage for prorated or spaced wells.)

(Show footage to the nearest lease or unit boundary line.)

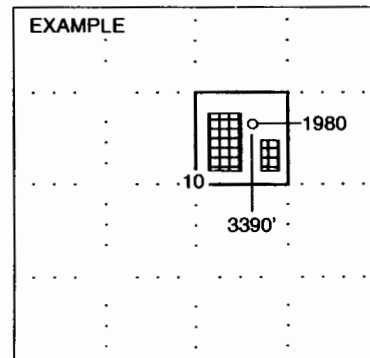
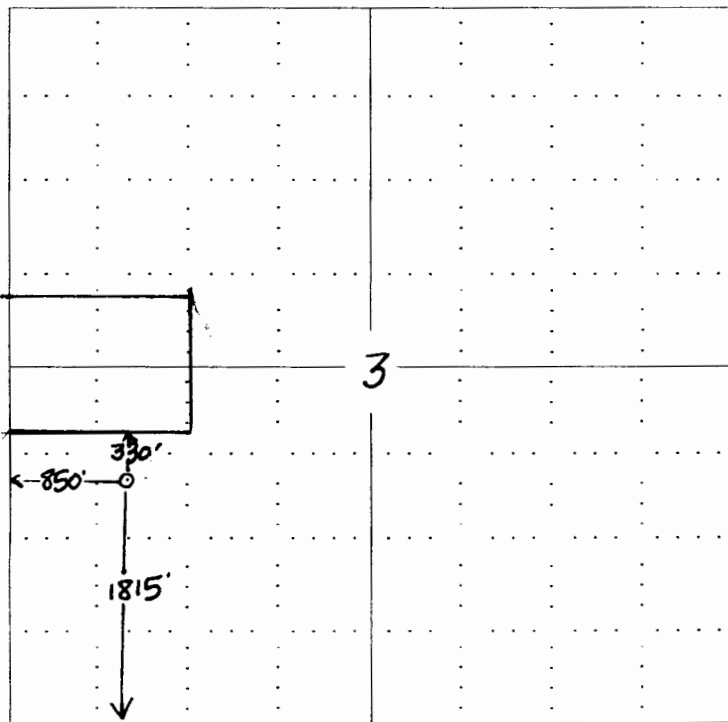

SEWARD CO.

NOTE: In all cases locate the spot of the proposed drilling location.

In plotting the proposed location of the well, you must show:

1. The manner in which you are using the depicted plat by identifying section lines, i.e. 1 section, 1 section with 8 surrounding sections, 4 sections, etc.
2. The distance of the proposed drilling location from the section's south / north and east / west.
3. The distance to the nearest lease or unit boundary line.
4. If proposed location is located within a prorated or spaced field a certificate of acreage attribution plat must be attached: (CO-7 for oil wells; CG-8 for gas wells).

KANSAS CORPORATION COMMISSION
OIL & GAS CONSERVATION DIVISION
APPLICATION FOR SURFACE PIT

RECEIVED

APR 14 2006 Form must be Typed

Form GDP-1
April 2004

KCC WICHITA

Submit in Duplicate

Operator Name: Murfin Drilling Company, Inc.		License Number: 30606
Operator Address: 250 N. Water, Suite 300, Wichita, KS 67202		
Contact Person: David Doyel		Phone Number: (316) 267 - 3241
Lease Name & Well No.: Keja #1-3		Pit Location (QQQQ): app E/2 NW SW
Type of Pit: <input type="checkbox"/> Emergency Pit <input type="checkbox"/> Burn Pit <input type="checkbox"/> Settling Pit <input checked="" type="checkbox"/> Drilling Pit <input type="checkbox"/> Workover Pit <input type="checkbox"/> Haul-Off Pit <small>(If WP Supply API No. or Year Drilled)</small>	Pit is: <input checked="" type="checkbox"/> Proposed <input type="checkbox"/> Existing If Existing, date constructed: _____ Pit capacity: 600 (bbls)	Sec. 3 Twp. 11S R. 21 <input type="checkbox"/> East <input checked="" type="checkbox"/> West 1815 Feet from <input type="checkbox"/> North / <input checked="" type="checkbox"/> South Line of Section 850 Feet from <input type="checkbox"/> East / <input checked="" type="checkbox"/> West Line of Section Trego County
Is the pit located in a Sensitive Ground Water Area? <input checked="" type="checkbox"/> Yes <input type="checkbox"/> No		Chloride concentration: _____ mg/l <small>(For Emergency Pits and Settling Pits only)</small>
Is the bottom below ground level? <input checked="" type="checkbox"/> Yes <input type="checkbox"/> No	Artificial Liner? <input type="checkbox"/> Yes <input checked="" type="checkbox"/> No	How is the pit lined if a plastic liner is not used? Bentonite & solids from drlg. oper. self seal pits.
Pit dimensions (all but working pits): 100 Length (feet) 100 Width (feet) N/A N/A: Steel Pits Depth from ground level to deepest point: 4 (feet)		
If the pit is lined give a brief description of the liner material, thickness and installation procedure.		Describe procedures for periodic maintenance and determining liner integrity, including any special monitoring.
Distance to nearest water well within one-mile of pit 4823 feet Depth of water well 53 feet		Depth to shallowest fresh water 29 feet (2) Source of information: KMKS _____ measured _____ well owner _____ electric log <input checked="" type="checkbox"/> KDWR
Emergency, Settling and Burn Pits ONLY: Producing Formation: _____ Number of producing wells on lease: _____ Barrels of fluid produced daily: _____ Does the slope from the tank battery allow all spilled fluids to flow into the pit? <input type="checkbox"/> Yes <input type="checkbox"/> No		Drilling, Workover and Haul-Off Pits ONLY: Type of material utilized in drilling/workover: Bentonite Number of working pits to be utilized: 4 Abandonment procedure: Allow pits to evaporate until dry then backfill when conditions allow Drill pits must be closed within 365 days of spud date.
I hereby certify that the above statements are true and correct to the best of my knowledge and belief.		
Date: 4/13/06		Signature of Applicant or Agent: Shauna Gammelman
KCC OFFICE USE ONLY		
Date Received: 4/14/06	Permit Number: _____	Permit Date: 4/14/06 Lease Inspection: <input checked="" type="checkbox"/> Yes <input type="checkbox"/> No

Mail to: KCC - Conservation Division, 130 S. Market - Room 2078, Wichita, Kansas 67202

15-195-20357-0000

RFA C

KANSAS

CORPORATION COMMISSION

KATHLEEN SEBELIUS, GOVERNOR
BRIAN J. MOLINE, CHAIR
ROBERT E. KREHBIEL, COMMISSIONER
MICHAEL C. MOFFET, COMMISSIONER

April 14, 2006

Mr. David Doyel
Murfin Drilling Company, Inc.
250 N. Water Ste 300
Wichita, KS 67202

RE: Drilling Pit Application
Keja Lease Well No. 1-3
SW/4 Sec. 03-11S-21W
Trego County, Kansas

Dear Mr. Doyel:

District staff has inspected the above referenced location and has determined that the reserve pit shall be constructed **without slots**, the bottom shall be flat and reasonably level, and the free fluids must be removed. The fluids are to be removed from the reserve pit as soon as practical after drilling operations have ceased. **Please keep all pits away from any draws.**

If production casing is set all completion fluids shall be removed from the working pits daily. NO completion fluids or non-exempt wastes shall be placed in the reserve pit.

The fluids should be taken to an authorized disposal well. Please call the District Office at (785) 625-0550 when the fluids have been removed. Please file form CDP-5 (August 2004), Exploration and Production Waste Transfer, within 30 days of fluid removal. Conservation division forms are available through our office and on the KCC web site:
www.kcc.state.ks.us/conservation/forms.

A copy of this letter should be posted in the doghouse along with the approved Intent to Drill. If you have any questions or concerns please feel free to contact the undersigned at the above address.

Sincerely,

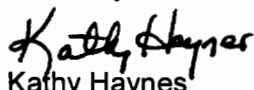

Kathy Haynes
Environmental Protection and Remediation Department

cc: H Deines