

For KCC Use: 4-22-06  
 Effective Date: \_\_\_\_\_  
 District #: 3  
 SGA?  Yes  No

KANSAS CORPORATION COMMISSION  
 OIL & GAS CONSERVATION DIVISION  
**NOTICE OF INTENT TO DRILL**

**RECEIVED**  
 KANSAS CORPORATION COMMISSION  
 APR 14 2006  
 Form C-1  
 December 2002  
 Form must be Typed  
 Form must be Signed  
 All blanks must be Filled

Must be approved by KCC five (5) days prior to commencing

Expected Spud Date April 20, 2006  
 month day year

OPERATOR: License# 33344 ✓  
 Name: Quest Cherokee LLC  
 Address: 9520 North May Avenue, Suite 300  
 City/State/Zip: Oklahoma City, Oklahoma 73120  
 Contact Person: Richard Marlin  
 Phone: (405) 286-9316

CONTRACTOR: License# Will be licensed by the KCC ✓  
 Name: Will advise on the ACO-1

Well Drilled For:	Well Class:	Type Equipment:
<input type="checkbox"/> Oil	<input type="checkbox"/> Enh Rec	<input type="checkbox"/> Mud Rotary
<input checked="" type="checkbox"/> Gas	<input type="checkbox"/> Storage	<input checked="" type="checkbox"/> Air Rotary
<input type="checkbox"/> OWWO	<input type="checkbox"/> Disposal	<input type="checkbox"/> Cable
<input type="checkbox"/> Seismic: _____ # of Holes	<input type="checkbox"/> Wildcat	
<input checked="" type="checkbox"/> Other: <u>COALBED METHANE</u>	<input type="checkbox"/> Other	

If OWWO: old well information as follows:  
 Operator: \_\_\_\_\_  
 Well Name: \_\_\_\_\_  
 Original Completion Date: \_\_\_\_\_ Original Total Depth: \_\_\_\_\_

Directional, Deviated or Horizontal wellbore?  Yes  No  
 If Yes, true vertical depth: \_\_\_\_\_  
 Bottom Hole Location: \_\_\_\_\_  
 KCC DKT #: \_\_\_\_\_

Spot \_\_\_\_\_ SE \_\_\_\_\_ SW \_\_\_\_\_ Sec. 32 Twp. 28 S. R. 16  
 East  West  
877 feet from  N /  S Line of Section  
1979 feet from  E /  W Line of Section  
 Is SECTION  Regular  Irregular?

(Note: Locate well on the Section Plat on reverse side)  
 County: Wilson  
 Lease Name: Brown, Doyle C. Well #: 32-3  
 Field Name: Cherokee Basin CBM

Is this a Prorated / Spaced Field?  Yes  No  
 Target Formation(s): Cherokee Coals  
 Nearest Lease or unit boundary: 877

Ground Surface Elevation: 820 feet MSL  
 Water well within one-quarter mile:  Yes  No  
 Public water supply well within one mile:  Yes  No

Depth to bottom of fresh water: 100  
 Depth to bottom of usable water: 200 / 150  
 Surface Pipe by Alternate:  1  2  
 Length of Surface Pipe Planned to be set: 25

Length of Conductor Pipe required: \_\_\_\_\_  
 Projected Total Depth: 1500  
 Formation at Total Depth: Cherokee Coals

Water Source for Drilling Operations:  
 Well  Farm Pond Other Air  
 DWR Permit #: \_\_\_\_\_

(Note: Apply for Permit with DWR )  
 Will Cores be taken?  Yes  No  
 If Yes, proposed zone: \_\_\_\_\_

**AFFIDAVIT**

The undersigned hereby affirms that the drilling, completion and eventual plugging of this well will comply with K.S.A. 55 et. seq.

It is agreed that the following minimum requirements will be met:

1. Notify the appropriate district office **prior** to spudding of well;
2. A copy of the approved notice of intent to drill **shall be** posted on each drilling rig;
3. The minimum amount of surface pipe as specified below **shall be set** by circulating cement to the top; in all cases surface pipe **shall be set** through all unconsolidated materials plus a minimum of 20 feet into the underlying formation.
4. If the well is dry hole, an agreement between the operator and the district office on plug length and placement is necessary **prior to plugging**;
5. The appropriate district office will be notified before well is either plugged or production casing is cemented in;
6. If an ALTERNATE II COMPLETION, production pipe shall be cemented from below any usable water to surface within **120 days** of spud date.  
 Or pursuant to Appendix "B" - Eastern Kansas surface casing order #133,891-C, which applies to the KCC District 3 area, alternate II cementing must be completed within 30 days of the spud date or the well shall be plugged. **In all cases, NOTIFY district office** prior to any cementing.

I hereby certify that the statements made herein are true and to the best of my knowledge and belief.

Date: 4/13/2006 Signature of Operator or Agent: Richard Marlin Title: VP

For KCC Use ONLY	
API # 15 - <u>205-26542-0000</u>	
Conductor pipe required <u>None</u> feet	
Minimum surface pipe required <u>20</u> feet per Alt. <b>X(2)</b>	
Approved by: <u>Per 4-17-06</u>	
This authorization expires: <u>10-17-06</u>	
(This authorization void if drilling not started within 6 months of approval date.)	
Spud date: _____	Agent: _____

- Remember to:**
- File Drill Pit Application (form CDP-1) with Intent to Drill;
  - File Completion Form ACO-1 within 120 days of spud date;
  - File acreage attribution plat according to field proration orders;
  - Notify appropriate district office 48 hours prior to workover or re-entry;
  - Submit plugging report (CP-4) after plugging is completed;
  - Obtain written approval before disposing or injecting salt water.
- If this permit has expired (See: authorized expiration date) please check the box below and return to the address below.
- Well Not Drilled - Permit Expired  
 Signature of Operator or Agent: \_\_\_\_\_  
 Date: \_\_\_\_\_

32  
28  
10E

**IN ALL CASES PLOT THE INTENDED WELL ON THE PLAT BELOW**

*Plat of acreage attributable to a well in a prorated or spaced field*

**If the intended well is in a prorated or spaced field, please fully complete this side of the form.** If the intended well is in a prorated or spaced field complete the plat below showing that the well will be properly located in relationship to other wells producing from the common source of supply. Please show all the wells and within 1 mile of the boundaries of the proposed acreage attribution unit for gas wells and within 1/2 mile of the boundaries of the proposed acreage attribution unit for oil wells.

API No. 15 - 205-26542-0000  
 Operator: Quest Cherokee LLC  
 Lease: Brown, Doyle C.  
 Well Number: 32-3  
 Field: Cherokee Basin CBM  
 Number of Acres attributable to well: \_\_\_\_\_  
 QTR / QTR / QTR of acreage: \_\_\_\_\_ SE \_\_\_\_\_ SW

Location of Well: County: Wilson  
877 feet from  N /  S Line of Section  
1979 feet from  E /  W Line of Section  
 Sec. 32 Twp. 28 S. R. 16  East  West

Is Section:  Regular or  Irregular

If Section is Irregular, locate well from nearest corner boundary.

Section corner used:  NE  NW  SE  SW

**PLAT**

*(Show location of the well and shade attributable acreage for prorated or spaced wells.)*

*(Show footage to the nearest lease or unit boundary line.)*

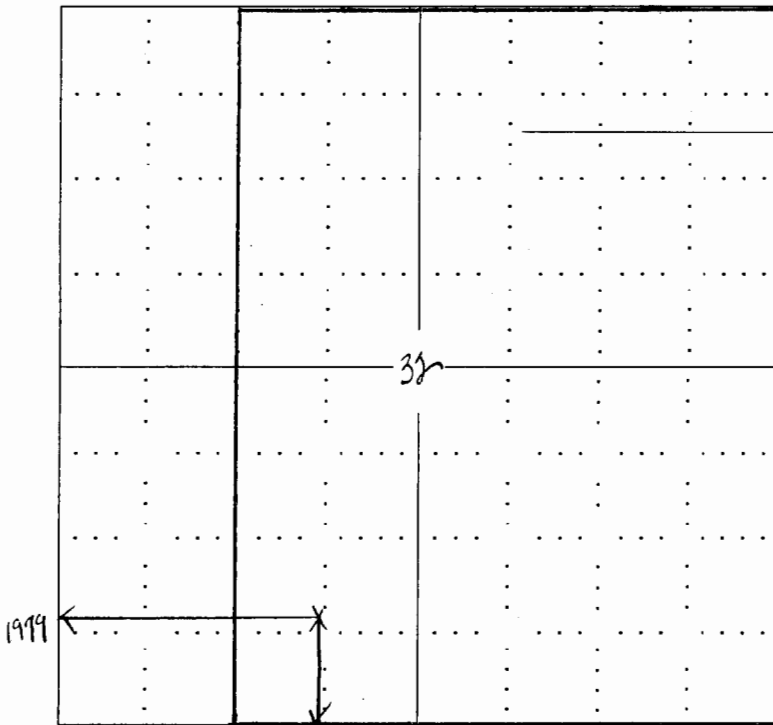

**NOTE: In all cases locate the spot of the proposed drilling location.**

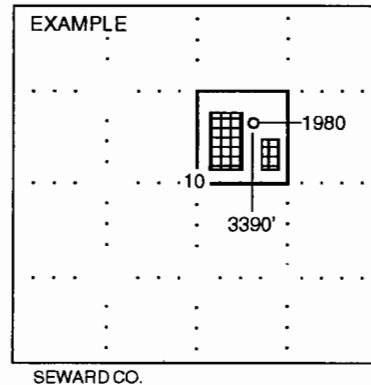

**In plotting the proposed location of the well, you must show:**

1. The manner in which you are using the depicted plat by identifying section lines, i.e. 1 section, 1 section with 8 surrounding sections, 4 sections, etc.
2. The distance of the proposed drilling location from the section's south / north and east / west.
3. The distance to the nearest lease or unit boundary line.
4. If proposed location is located within a prorated or spaced field a certificate of acreage attribution plat must be attached: (CO-7 for oil wells; CG-8 for gas wells).

KANSAS CORPORATION COMMISSION  
OIL & GAS CONSERVATION DIVISION

RECEIVED  
KANSAS CORPORATION COMMISSION Form CDP-1  
APR 14 2006 April 2004  
Form must be Typed

APPLICATION FOR SURFACE PIT

CONSERVATION DIVISION  
WICHITA, KS

Submit In Duplicate

Operator Name: <b>Quest Cherokee LLC</b>		License Number: <b>33344</b>
Operator Address: <b>9520 North May Avenue, Suite 300 Oklahoma City, Oklahoma 73120</b>		
Contact Person: <b>Richard Marlin</b>		Phone Number: ( <b>405</b> ) <b>286 - 9316</b>
Lease Name & Well No.: <b>Brown, Doyle C. #32-3</b>		Pit Location (QQQQ): _____ - _____ - <b>SE</b> - <b>SW</b> Sec. <b>32</b> Twp. <b>28</b> R. <b>16</b> <input checked="" type="checkbox"/> East <input type="checkbox"/> West <b>877</b> Feet from <input type="checkbox"/> North / <input checked="" type="checkbox"/> South Line of Section <b>1979</b> Feet from <input type="checkbox"/> East / <input checked="" type="checkbox"/> West Line of Section <b>Wilson</b> County
Type of Pit: <input type="checkbox"/> Emergency Pit <input type="checkbox"/> Burn Pit <input type="checkbox"/> Settling Pit <input checked="" type="checkbox"/> Drilling Pit <input type="checkbox"/> Workover Pit <input type="checkbox"/> Haul-Off Pit <small>(If WP Supply API No. or Year Drilled)</small>	Pit is: <input checked="" type="checkbox"/> Proposed <input type="checkbox"/> Existing If Existing, date constructed: _____ Pit capacity: <b>300</b> (bbls)	
Is the pit located in a Sensitive Ground Water Area? <input type="checkbox"/> Yes <input checked="" type="checkbox"/> No		Chloride concentration: _____ mg/l <small>(For Emergency Pits and Settling Pits only)</small>
Is the bottom below ground level? <input type="checkbox"/> Yes <input checked="" type="checkbox"/> No	Artificial Liner? <input type="checkbox"/> Yes <input checked="" type="checkbox"/> No	How is the pit lined if a plastic liner is not used?
Pit dimensions (all but working pits): <b>30</b> Length (feet) <b>10</b> Width (feet) <b>N/A: Steel Pits</b> Depth from ground level to deepest point: <b>10</b> (feet)		
If the pit is lined give a brief description of the liner material, thickness and installation procedure.		Describe procedures for periodic maintenance and determining liner integrity, including any special monitoring. <b>Air Drilling Operation lasting approx 3 days</b>
Distance to nearest water well within one-mile of pit <b>3826</b> feet Depth of water well <b>80</b> feet		Depth to shallowest fresh water <b>12</b> feet. <sup>①</sup> Source of information: <b>KH KCS</b> _____ measured _____ well owner _____ electric log _____ KDWR
<b>Emergency, Settling and Burn Pits ONLY:</b> Producing Formation: _____ Number of producing wells on lease: _____ Barrels of fluid produced daily: _____ Does the slope from the tank battery allow all spilled fluids to flow into the pit? <input type="checkbox"/> Yes <input type="checkbox"/> No		<b>Drilling, Workover and Haul-Off Pits ONLY:</b> Type of material utilized in drilling/workover: <b>Air Drilled</b> Number of working pits to be utilized: <b>One</b> Abandonment procedure: <b>Air Dry, Back Fill and Cover</b> Drill pits must be closed within 365 days of spud date.
I hereby certify that the above statements are true and correct to the best of my knowledge and belief.  <b>4/13/2006</b> Date <b>Richard Marlin</b> Signature of Applicant or Agent		
<b>KCC OFFICE USE ONLY</b>		
Date Received: <b>4/14/06</b> Permit Number: _____ Permit Date: <b>4/14/06</b> Lease Inspection: <input type="checkbox"/> Yes <input checked="" type="checkbox"/> No		Enctr Allusion 10-c REAC

15-205-26542-0000

# KANSAS

CORPORATION COMMISSION

KATHLEEN SEBELIUS, GOVERNOR  
BRIAN J. MOLINE, CHAIR  
ROBERT E. KREHBIEL, COMMISSIONER  
MICHAEL C. MOFFET, COMMISSIONER

April 14, 2006

Mr. Richard Marlin  
Quest Cherokee LLC  
9520 North May Ave, Ste 300  
Oklahoma City, OK 73120

RE: Drilling Pit Application  
Brown, Doyle C. Lease Well No. 32-3  
SW/4 Sec. 32-28S-18E  
Wilson County, Kansas

Dear Mr. Marlin:

District staff has reviewed the above referenced location and has determined that if the pit construction is within the top clay layers there will be no need for a pit liner. If construction encounters the alluvium then the pit must be lined with a 10 mil plastic liner. The free fluids must be removed from the reserve pit as soon as practical after drilling operations have ceased.

**If production casing is set all completion fluids shall be removed from the working pits daily. NO completion fluids or non-exempt wastes shall be placed in the reserve pit.**

The fluids should be taken to an authorized disposal well. Please call the District Office at (620) 432-2300 when the fluids have been removed. Please file form CDP-5 (August 2004), Exploration and Production Waste Transfer, within 30 days of fluid removal. Conservation division forms are available through our office and on the KCC web site:  
[www.kcc.state.ks.us/conservation/forms](http://www.kcc.state.ks.us/conservation/forms).

**A copy of this letter should be posted in the doghouse along with the approved Intent to Drill.** If you have any questions or concerns you may contact the undersigned at the above address.

Sincerely,

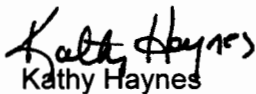

Kathy Haynes  
Department of Environmental Protection and Remediation

cc: S Korf