

For KCC Use: 4-2206
 Effective Date: _____
 District # 4
 SGA? Yes No

KANSAS CORPORATION COMMISSION
 OIL & GAS CONSERVATION DIVISION

Form C-1
 December 2002
 Form must be Typed
 Form must be Signed
 All blanks must be Filled

NOTICE OF INTENT TO DRILL
 Must be approved by KCC five (5) days prior to commencing well

Expected Spud Date May 2 2006
 month day year

Spot 165'S of 120'E
 NW SW NW Sec. 3 Twp. 11 S. R. 21
 East West
3465 feet from N / S Line of Section
450 feet from E / W Line of Section
 Is SECTION Regular Irregular?

OPERATOR: License# 5552
 Name: Gore Oil Company
 Address: 202 S. St. Francis
Wichita, Kansas 67202
 Contact Person: Larry M Jack
 Phone: 316-263-3535

(Note: Locate well on the Section Plat on reverse side)
 County: Trego
 Lease Name: Ella Lewis Well #: #7
 Field Name: Wildcat

CONTRACTOR: License# 30606
 Name: Murfin Drilling Company

Is this a Prorated / Spaced Field? Yes No

Well Drilled For: Oil Enh Rec Infield Mud Rotary
 Gas Storage Pool Ext. Air Rotary
 OWWO Disposal Wildcat Cable
 Seismic; # of Holes Other
 Other

Target Formation(s): Lansing, Arbuckle
 Nearest Lease or unit boundary: 330
 Ground Surface Elevation: 2131 feet MSL

If OWWO: old well information as follows:
 Operator: _____
 Well Name: _____
 Original Completion Date: _____ Original Total Depth: _____

Water well within one-quarter mile: Yes No
 Public water supply well within one mile: Yes No

Directional, Deviated or Horizontal wellbore? Yes No

Depth to bottom of fresh water: 150
 Depth to bottom of usable water: 900
 Surface Pipe by Alternate: 1 2

If Yes, true vertical depth: _____
 Bottom Hole Location: _____
 KCC DKT #: _____

Length of Surface Pipe Planned to be set: 300
 Length of Conductor Pipe required: none
 Projected Total Depth: 3850

Formation at Total Depth: ARBUCKLE
 Water Source for Drilling Operations:
 Well Farm Pond Other

DWR Permit #: _____
 *(Note: Apply for Permit with DWR)

Will Cores be taken? Yes No
 If Yes, proposed zone: _____

AFFIDAVIT

The undersigned hereby affirms that the drilling, completion and eventual plugging of this well will comply with K.S.A. **RECEIVED KANSAS CORPORATION COMMISSION**

It is agreed that the following minimum requirements will be met:

APR 17 2006

1. Notify the appropriate district office **prior** to spudding of well;
2. A copy of the approved notice of intent to drill **shall be** posted on each drilling rig;
3. The minimum amount of surface pipe as specified below **shall be set** by circulating cement to the top; in all cases **shall be set** through all unconsolidated materials plus a minimum of 20 feet into the underlying formation.
4. If the well is dry hole, an agreement between the operator and the district office on plug length and placement is necessary **prior to plugging**;
5. The appropriate district office will be notified before well is either **plugged or production casing is cemented in**;
6. If an ALTERNATE II COMPLETION, production pipe shall be cemented from below any usable water to surface within **120 days** of spud date. Or pursuant to Appendix "B" - Eastern Kansas surface casing order #133,891-C, which applies to the KCC District 3 area, alternate II cementing must be completed within 30 days of the spud date or the well shall be plugged. **In all cases, NOTIFY district office** prior to any cementing.

I hereby certify that the statements made herein are true and to the best of my knowledge and belief.

Date: 4/13/06 Signature of Operator or Agent: Larry M Jack Title: Operations Manager

For KCC Use ONLY
 API # 15 - 195-22358-0000
 Conductor pipe required None feet
 Minimum surface pipe required 200 feet per Alt. **XO 2**
 Approved by: Pat 4-17-06
 This authorization expires: 10-17-06
 (This authorization void if drilling not started within 6 months of approval date.)
 Spud date: _____ Agent: _____

Remember to:
 - File Drill Pit Application (form CDP-1) with Intent to Drill;
 - File Completion Form ACO-1 within 120 days of spud date;
 - File acreage attribution plat according to field proration orders;
 - Notify appropriate district office 48 hours prior to workover or re-entry;
 - Submit plugging report (CP-4) after plugging is completed;
 - Obtain written approval before disposing or injecting salt water.
 - If this permit has expired (See: authorized expiration date) please check the box below and return to the address below.
 Well Not Drilled - Permit Expired
 Signature of Operator or Agent: _____
 Date: _____

Mail to: KCC - Conservation Division, 130 S. Market - Room 2078, Wichita, Kansas 67202

6
11
210

IN ALL CASES PLOT THE INTENDED WELL ON THE PLAT BELOW

Plat of acreage attributable to a well in a prorated or spaced field

If the intended well is in a prorated or spaced field, please fully complete this side of the form. If the intended well is in a prorated or spaced field complete the plat below showing that the well will be properly located in relationship to other wells producing from the common source of supply. Please show all the wells and within 1 mile of the boundaries of the proposed acreage attribution unit for gas wells and within 1/2 mile of the boundaries of the proposed acreage attribution unit for oil wells.

API No. 15 - 195-22358-000
 Operator: Gore Oil Company
 Lease: Ella Lewis
 Well Number: #7
 Field: Wildcat

Location of Well: County: Trego
 3465 feet from N / S Line of Section
 450 feet from E / W Line of Section
 Sec. 3 Twp. 11 S. R. 21 East West

Number of Acres attributable to well: _____
 QTR / QTR / QTR of acreage: NW - SW - NW

Is Section: Regular or Irregular

If Section is Irregular, locate well from nearest corner boundary.

Section corner used: NE NW SE SW

PLAT

(Show location of the well and shade attributable acreage for prorated or spaced wells.)

(Show footage to the nearest lease or unit boundary line.)

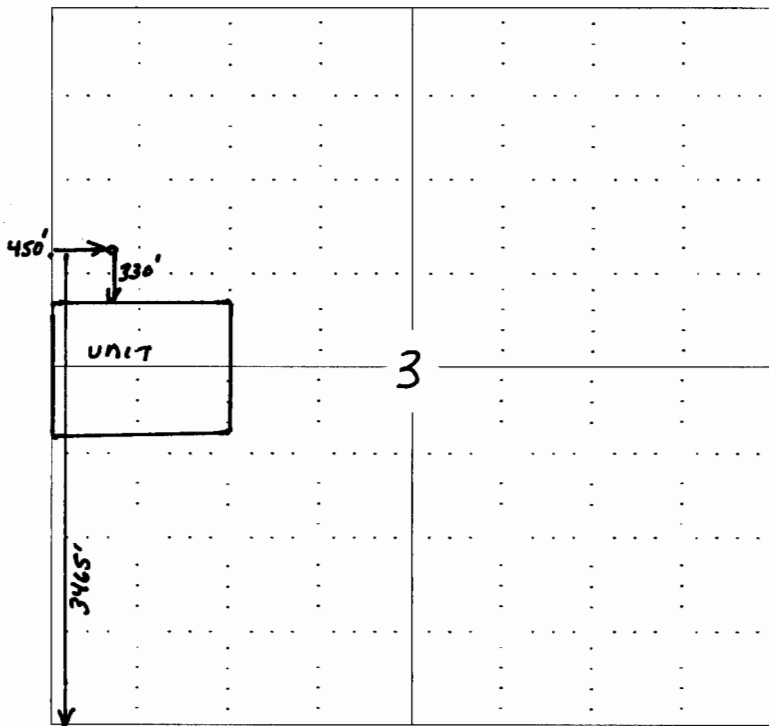

NOTE: In all cases locate the spot of the proposed drilling location.

RECEIVED
 KANSAS CORPORATION COMMISSION
 APR 17 2006
 CONSERVATION DIVISION
 WICHITA, KS

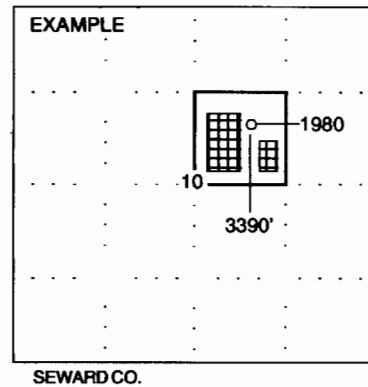

In plotting the proposed location of the well, you must show:

1. The manner in which you are using the depicted plat by identifying section lines, i.e. 1 section, 1 section with 8 surrounding sections, 4 sections, etc.
2. The distance of the proposed drilling location from the section's south / north and east / west.
3. The distance to the nearest lease or unit boundary.
4. If proposed location is located within a prorated or spaced field a certificate of acreage attribution plat must be attached: (CO-7 for oil wells; CG-8 for gas wells).

KANSAS CORPORATION COMMISSION
OIL & GAS CONSERVATION DIVISION
APPLICATION FOR SURFACE PIT

APR 17 2006

Form CDP-1
April 2004

CONSERVATION DIVISION
WICHITA, KS

Form must be Typed

Submit in Duplicate

Operator Name: Gore Oil Company		License Number: 5552
Operator Address: P.O. Box 2757, Wichita, KS 67201-2757		
Contact Person: Larry M. Jack		Phone Number: (316) 263 - 3535
Lease Name & Well No.: Ella Lewis #7		Pit Location (QQQQ): NW SW NW Sec. 3 Twp. 11 R. 21 <input type="checkbox"/> East <input checked="" type="checkbox"/> West 3465 Feet from <input type="checkbox"/> North / <input checked="" type="checkbox"/> South Line of Section 450 Feet from <input type="checkbox"/> East / <input checked="" type="checkbox"/> West Line of Section Trego County
Type of Pit: <input type="checkbox"/> Emergency Pit <input type="checkbox"/> Burn Pit <input type="checkbox"/> Settling Pit <input checked="" type="checkbox"/> Drilling Pit <input type="checkbox"/> Workover Pit <input type="checkbox"/> Haul-Off Pit <small>(If WP Supply API No. or Year Drilled)</small>	Pit is: <input checked="" type="checkbox"/> Proposed <input type="checkbox"/> Existing If Existing, date constructed: Pit capacity: _____ (bbls)	
Is the pit located in a Sensitive Ground Water Area? <input checked="" type="checkbox"/> Yes <input type="checkbox"/> No		Chloride concentration: _____ mg/l <small>(For Emergency Pits and Settling Pits only)</small>
Is the bottom below ground level? <input checked="" type="checkbox"/> Yes <input type="checkbox"/> No	Artificial Liner? <input type="checkbox"/> Yes <input checked="" type="checkbox"/> No	How is the pit lined if a plastic liner is not used? Bentonite & solids from drig oper self seal pits
Pit dimensions (all but working pits): 100 Length (feet) 100 Width (feet) N/A: Steel Pits Depth from ground level to deepest point: 4 (feet)		
If the pit is lined give a brief description of the liner material, thickness and installation procedure.		Describe procedures for periodic maintenance and determining liner integrity, including any special monitoring.
Distance to nearest water well within one-mile of pit 3495 feet Depth of water well 31 feet		Depth to shallowest fresh water 13 feet Source of information: KWK&S (1) _____ measured _____ well owner _____ electric log _____ KDWR
Emergency, Settling and Burn Pits ONLY: Producing Formation: _____ Number of producing wells on lease: _____ Barrels of fluid produced daily: _____ Does the slope from the tank battery allow all spilled fluids to flow into the pit? <input type="checkbox"/> Yes <input type="checkbox"/> No		Drilling, Workover and Haul-Off Pits ONLY: Type of material utilized in drilling/workover: Bentonite Number of working pits to be utilized: 4 Abandonment procedure: allow pits to evaporate until dry, then backfill Drill pits must be closed within 365 days of spud date.
I hereby certify that the above statements are true and correct to the best of my knowledge and belief.		
Date: 4-13-06		Signature of Applicant or Agent: 
KCC OFFICE USE ONLY		
RFAC		
Date Received: 4/17/06 Permit Number: _____ Permit Date: 4/17/06 Lease Inspection: <input type="checkbox"/> Yes <input checked="" type="checkbox"/> No		

15-195-22358-0220

KANSAS

CORPORATION COMMISSION

KATHLEEN SEBELIUS, GOVERNOR
BRIAN J. MOLINE, CHAIR
ROBERT E. KREHBIEL, COMMISSIONER
MICHAEL C. MOFFET, COMMISSIONER

April 17, 2006

Mr. Larry M. Jack
Gore Oil Company
202 S. St. Francis
Wichita, KS 67202

RE: Drilling Pit Application
Ella Lewis Lease Well No. 7
NW/4 Sec. 03-11S-21W
Trego County, Kansas

Dear Mr. Jack:

District staff has inspected the above referenced location and has determined that the reserve pit shall be constructed **without slots**, the bottom shall be flat and reasonably level, and the free fluids must be removed. The fluids are to be removed from the reserve pit as soon as practical after drilling operations have ceased. **Please keep all pits away from any draws.**

If production casing is set all completion fluids shall be removed from the working pits daily. NO completion fluids or non-exempt wastes shall be placed in the reserve pit.

The fluids should be taken to an authorized disposal well. Please call the District Office at (785) 625-0550 when the fluids have been removed. Please file form CDP-5 (August 2004), Exploration and Production Waste Transfer, within 30 days of fluid removal. Conservation division forms are available through our office and on the KCC web site:
www.kcc.state.ks.us/conservation/forms.

A copy of this letter should be posted in the doghouse along with the approved Intent to Drill. If you have any questions or concerns please feel free to contact the undersigned at the above address.

Sincerely,

Kathy Haynes
Environmental Protection and Remediation Department

cc: H Deines