

For KCC Use: 4-29-06  
Effective Date: \_\_\_\_\_  
District # 3  
SGA?  Yes  No

KANSAS CORPORATION COMMISSION  
OIL & GAS CONSERVATION DIVISION

NOTICE OF INTENT TO DRILL

Must be approved by KCC five (5) days prior to commencing well

RECEIVED

APR 21 2006

KCC WICHITA

Form C-1

December 2002

Form must be Typed

Form must be Signed

All blanks must be Filled

Expected Spud Date April 24th 2006  
month day year

Spot NW - NW - NW Sec. 33 Twp. 27 S. R. 19  East  West  
550 feet from  N /  S Line of Section  
525 feet from  E /  W Line of Section

OPERATOR: License# 33658 ✓  
Name: Big Creek Oil  
Address: 20702 Harper Road  
City/State/Zip: Chanute, Ks. 66720  
Contact Person: Wanda Parish  
Phone: 620-431-0354

Is SECTION  Regular  Irregular?  
(Note: Locate well on the Section Plat on reverse side)  
County: Neosho  
Lease Name: Meyer Well #: 2

CONTRACTOR: ADVISED OPERATOR  
Name: BE LICENSED WITH KCC

Field Name: \_\_\_\_\_  
Is this a Prorated / Spaced Field?  Yes  No

Well Drilled For:  Oil  Gas  OWWO  Seismic; # of Holes \_\_\_\_\_  
 Enh Rec  Storage  Disposal  Other \_\_\_\_\_  
Well Class:  Infield  Pool Ext.  Wildcat  Other \_\_\_\_\_  
Type Equipment:  Mud Rotary  Air Rotary  Cable

Target Formation(s): Cherokee ✓  
Nearest Lease or unit boundary: 525  
Ground Surface Elevation: 880 feet MSL  
Water well within one-quarter mile:  Yes  No  
Public water supply well within one mile:  Yes  No

If OWWO: old well information as follows:  
Operator: \_\_\_\_\_  
Well Name: \_\_\_\_\_  
Original Completion Date: \_\_\_\_\_ Original Total Depth: \_\_\_\_\_

Depth to bottom of fresh water: N/A 150  
Depth to bottom of usable water: N/A 150  
Surface Pipe by Alternate:  1  2  
Length of Surface Pipe Planned to be set: 20 feet  
Length of Conductor Pipe required: None  
Projected Total Depth: 800 feet

Directional, Deviated or Horizontal wellbore?  Yes  No  
If Yes, true vertical depth: \_\_\_\_\_  
Bottom Hole Location: \_\_\_\_\_  
KCC DKT #: \_\_\_\_\_

Formation at Total Depth: XXXXXXXXXX Bartlesville  
Water Source for Drilling Operations:  Well  Farm Pond  Other \_\_\_\_\_  
DWR Permit #: \_\_\_\_\_  
(Note: Apply for Permit with DWR )  
Will Cores be taken?  Yes  No

AFFIDAVIT

The undersigned hereby affirms that the drilling, completion and eventual plugging of this well will comply with K.S.A. 55 et. seq.  
It is agreed that the following minimum requirements will be met:

1. Notify the appropriate district office **prior** to spudding of well;
2. A copy of the approved notice of intent to drill **shall be** posted on each drilling rig;
3. The minimum amount of surface pipe as specified below **shall be set** by circulating cement to the top; in all cases surface pipe **shall be set** through all unconsolidated materials plus a minimum of 20 feet into the underlying formation.
4. If the well is dry hole, an agreement between the operator and the district office on plug length and placement is necessary **prior to plugging**;
5. The appropriate district office will be notified before well is either plugged or production casing is cemented in;
6. If an ALTERNATE II COMPLETION, production pipe shall be cemented from below any usable water to surface within **120 days** of spud date. Or pursuant to Appendix "B" - Eastern Kansas surface casing order #133,891-C, which applies to the KCC District 3 area, alternate II cementing must be completed within 30 days of the spud date or the well shall be plugged. **In all cases, NOTIFY district office** prior to any cementing.

I hereby certify that the statements made herein are true and to the best of my knowledge and belief.  
Date: 4-19-06 Signature of Operator or Agent: Wanda Parish Title: President

For KCC Use ONLY  
API # 15 - 133-26615-0000  
Conductor pipe required None feet  
Minimum surface pipe required 20 feet per Alt. X2  
Approved by: Rut 42406  
This authorization expires: 10-24-06  
(This authorization void if drilling not started within 6 months of approval date.)  
Spud date: \_\_\_\_\_ Agent: \_\_\_\_\_

Remember to:  
- File Drill Pit Application (form CDP-1) with Intent to Drill;  
- File Completion Form ACO-1 within 120 days of spud date;  
- File acreage attribution plat according to field proration orders;  
- Notify appropriate district office 48 hours prior to workover or re-entry;  
- Submit plugging report (CP-4) after plugging is completed;  
- Obtain written approval before disposing or injecting salt water.  
- If this permit has expired (See: authorized expiration date) please check the box below and return to the address below.  
 Well Not Drilled - Permit Expired  
Signature of Operator or Agent: \_\_\_\_\_  
Date: \_\_\_\_\_

Mail to: KCC - Conservation Division, 130 S. Market - Room 2078, Wichita, Kansas 67202

33  
27  
19E

RECEIVED

APR 21 2006

KCC WICHITA

IN ALL CASES PLOT THE INTENDED WELL ON THE PLAT BELOW

Plat of acreage attributable to a well in a prorated or spaced field

If the intended well is in a prorated or spaced field, please fully complete this side of the form. If the intended well is in a prorated or spaced field complete the plat below showing that the well will be properly located in relationship to other wells producing from the common source of supply. Please show all the wells and within 1 mile of the boundaries of the proposed acreage attribution unit for gas wells and within 1/2 mile of the boundaries of the proposed acreage attribution unit for oil wells.

API No. 15 - 133-26615-0000  
Operator: Big Creek Oil  
Lease: Meyer  
Well Number: 2  
Field: \_\_\_\_\_

Location of Well: County: Neosho  
550 feet from  N /  S Line of Section  
525 feet from  E /  W Line of Section  
Sec. 33 Twp. 27 S. R. 19  East  West

Number of Acres attributable to well: \_\_\_\_\_  
QTR / QTR / QTR of acreage: NW - NW - NW

Is Section:  Regular or  Irregular  
If Section is Irregular, locate well from nearest corner boundary.  
Section corner used:  NE  NW  SE  SW

PLAT

(Show location of the well and shade attributable acreage for prorated or spaced wells.)  
(Show footage to the nearest lease or unit boundary line.)

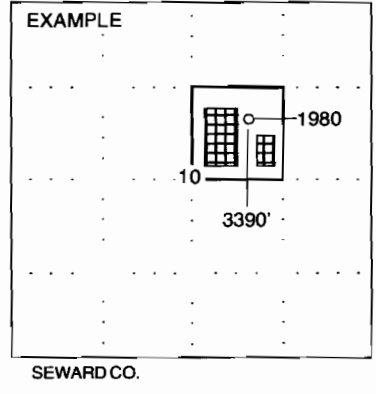
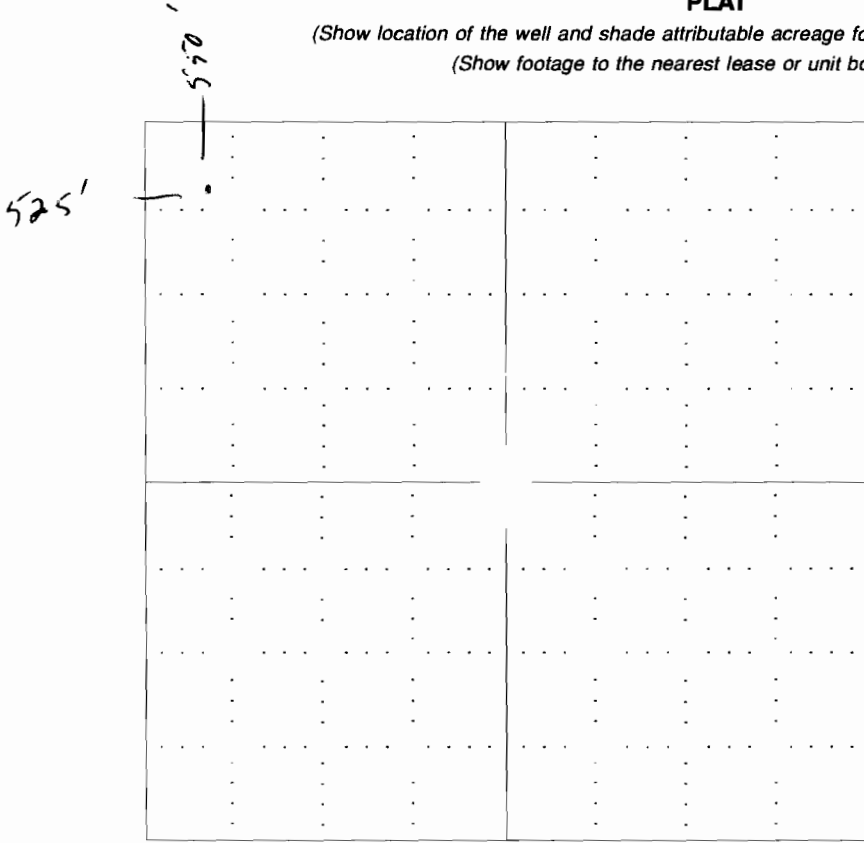

NOTE: In all cases locate the spot of the proposed drilling location.

In plotting the proposed location of the well, you must show:

- 1. The manner in which you are using the depicted plat by identifying section lines, i.e. 1 section, 1 section with 8 surrounding sections, 4 sections, etc.
- 2. The distance of the proposed drilling location from the section's south / north and east / west.
- 3. The distance to the nearest lease or unit boundary line.
- 4. If proposed location is located within a prorated or spaced field a certificate of acreage attribution plat must be attached: (CO-7 for oil wells; CG-8 for gas wells).

KANSAS CORPORATION COMMISSION  
OIL & GAS CONSERVATION DIVISION  
APPLICATION FOR SURFACE PIT

RECEIVED  
APR 21 2006  
KCC WICHITA

Form GDP-1  
April 2004  
Form must be Typed

Submit in Duplicate

Operator Name: <u>Big Creek Oil</u>		License Number: <u>33658</u>
Operator Address: <u>20702 Harper Road</u>		
Contact Person: <u>Wanda Parish</u>		Phone Number: ( <u>620</u> ) <u>-431-0354</u>
Lease Name & Well No.: <u>Meyer No. 2</u>		Pit Location (QQQQ): <u>NW - NW - NW - SE</u>
Type of Pit: <input type="checkbox"/> Emergency Pit <input type="checkbox"/> Burn Pit <input type="checkbox"/> Settling Pit <input checked="" type="checkbox"/> Drilling Pit <input type="checkbox"/> Workover Pit <input type="checkbox"/> Haul-Off Pit <small>(If WP Supply API No. or Year Drilled)</small>	Pit is: <input checked="" type="checkbox"/> Proposed <input type="checkbox"/> Existing If Existing, date constructed: _____ Pit capacity: <u>250</u> (bbls)	Sec. <u>33</u> Twp. <u>27</u> R. <u>19</u> <input checked="" type="checkbox"/> East <input type="checkbox"/> West <u>550</u> Feet from <input checked="" type="checkbox"/> North / <input type="checkbox"/> South Line of Section <u>525</u> Feet from <input type="checkbox"/> East / <input checked="" type="checkbox"/> West Line of Section <u>Neosho</u> County
Is the pit located in a Sensitive Ground Water Area? <input type="checkbox"/> Yes <input checked="" type="checkbox"/> No		Chloride concentration: _____ mg/l <small>(For Emergency Pits and Settling Pits only)</small>
Is the bottom below ground level? <input checked="" type="checkbox"/> Yes <input type="checkbox"/> No	Artificial Liner? <input type="checkbox"/> Yes <input type="checkbox"/> No	How is the pit lined if a plastic liner is not used?
Pit dimensions (all but working pits): <u>35</u> Length (feet) <u>8</u> Width (feet) <u>N/A</u> : Steel Pits Depth from ground level to deepest point: <u>4</u> (feet)		
If the pit is lined give a brief description of the liner material, thickness and installation procedure.		Describe procedures for periodic maintenance and determining liner integrity, including any special monitoring.
Distance to nearest water well within one-mile of pit _____ feet    Depth of water well _____ feet		Depth to shallowest fresh water <u>N/A</u> feet. Source of information: _____ measured    _____ well owner    _____ electric log    _____ KDWR
<b>Emergency, Settling and Burn Pits ONLY:</b> Producing Formation: _____ Number of producing wells on lease: _____ Barrels of fluid produced daily: _____ Does the slope from the tank battery allow all spilled fluids to flow into the pit? <input type="checkbox"/> Yes <input type="checkbox"/> No		<b>Drilling, Workover and Haul-Off Pits ONLY:</b> Type of material utilized in drilling/workover: <u>Fresh Water</u> Number of working pits to be utilized: <u>One</u> Abandonment procedure: <u>Haul Off if needed</u> Drill pits must be closed within 365 days of spud date.
I hereby certify that the above statements are true and correct to the best of my knowledge and belief.		
<u>4-19-06</u> Date		<u>Wanda Parish</u> Signature of Applicant or Agent

15-133-26615-0580

<b>KCC OFFICE USE ONLY</b>			
Date Received: <u>4/21/06</u>	Permit Number: _____	Permit Date: <u>4/21/06</u>	Lease Inspection: <input type="checkbox"/> Yes <input checked="" type="checkbox"/> No

Mail to: KCC - Conservation Division, 130 S. Market - Room 2078, Wichita, Kansas 67202