

RECEIVED

APR 24 2006

For KCC Use: 4-30-06
Effective Date: _____
District #: 4
SGA? Yes No

KANSAS CORPORATION COMMISSION
OIL & GAS CONSERVATION DIVISION

KCC WICHITA

Form C-1

December 2002

Form must be Typed

Form must be Signed

All blanks must be Filled

NOTICE OF INTENT TO DRILL

Must be approved by KCC five (5) days prior to commencing well

Expected Spud Date not determined yet
month day year

Spot SW - SW - SW Sec. 6 Twp. 10 S. R. 19 East West

OPERATOR: License# 32638
Name: Nadel and Gussman, L.L.C.
Address: 15 E. 5th St., Suite 3200
City/State/Zip: Tulsa, OK 74103
Contact Person: Marlin Taylor
Phone: 918/583-3333

330' feet from N / S Line of Section
330' feet from E / W Line of Section
Is SECTION Regular Irregular?

CONTRACTOR: License# ADVISE ON ACO-1; MUST BE LICENSED WITH KCC
Name: _____

(Note: Locate well on the Section Plat on reverse side)
County: Rooks
Lease Name: Gish Well #: 9
Field Name: Marcotte

Well Drilled For: Oil Gas OWWO Seismic; # of Holes _____
 Enh Rec Storage Disposal Other _____
Well Class: Infield Pool Ext. Wildcat Other _____
Type Equipment: Mud Rotary Air Rotary Cable

Is this a Prorated / Spaced Field? Yes No
Target Information(s): Arbuckle
Nearest Lease or unit boundary: 330'

If OWWO: old well information as follows:
Operator: _____
Well Name: _____
Original Completion Date: _____ Original Total Depth: _____

Ground Surface Elevation: 2233' approx feet MSL
Water well within one-quarter mile: Yes No
Public water supply well within one mile: Yes No

Directional, Deviated or Horizontal wellbore? Yes No
If Yes, true vertical depth: _____
Bottom Hole Location: _____
KCC DKT #: _____

Depth to bottom of fresh water: 185'
Depth to bottom of usable water: 965'
Surface Pipe by Alternate: 1 2
Length of Surface Pipe Planned to be set: 250'

Length of Conductor Pipe required: None
Projected Total Depth: 3800'
Formation at Total Depth: Arbuckle
Water Source for Drilling Operations:
 Well Farm Pond Other _____

DWR Permit #: _____
(Note: Apply for Permit with DWR)
Will Cores be taken? Yes No
If Yes, proposed zone: _____

AFFIDAVIT

The undersigned hereby affirms that the drilling, completion and eventual plugging of this well will comply with K.S.A. 55 et. seq.

It is agreed that the following minimum requirements will be met:

1. Notify the appropriate district office **prior** to spudding of well;
2. A copy of the approved notice of intent to drill **shall be** posted on each drilling rig;
3. The minimum amount of surface pipe as specified below **shall be set** by circulating cement to the top; in all cases surface pipe **shall be set** through all unconsolidated materials plus a minimum of 20 feet into the underlying formation.
4. If the well is dry hole, an agreement between the operator and the district office on plug length and placement is necessary **prior to plugging**;
5. The appropriate district office will be notified before well is either plugged or production casing is cemented in;
6. If an ALTERNATE II COMPLETION, production pipe shall be cemented from below any usable water to surface within **120 days** of spud date. Or pursuant to Appendix "B" - Eastern Kansas surface casing order #133,891-C, which applies to the KCC District 3 area, alternate II cementing must be completed within 30 days of the spud date or the well shall be plugged. **In all cases, NOTIFY district office** prior to any cementing.

I hereby certify that the statements made herein are true and to the best of my knowledge and belief.

Date: 4/19/06 Signature of Operator or Agent: Marlin Taylor Title: Manager of Production

For KCC Use ONLY
API # 15 - 163-23528-0000
Conductor pipe required None feet
Minimum surface pipe required 205 feet per Alt. **X2**
Approved by: RHT 4-25-06
This authorization expires: 10-25-06
(This authorization void if drilling not started within 6 months of effective date.)
Spud date: _____ Agent: _____

Remember to:
- File Drill Pit Application (form CDP-1) with Intent to Drill;
- File Completion Form ACO-1 within 120 days of spud date;
- File acreage attribution plat according to field proration orders;
- Notify appropriate district office 48 hours prior to workover or re-entry;
- Submit plugging report (CP-4) after plugging is completed;
- Obtain written approval before disposing or injecting salt water.
- If this permit has expired (See: authorized expiration date) please check the box below and return to the address below.
 Well Not Drilled - Permit Expired
Signature of Operator or Agent: _____
Date: _____

Mail to: KCC - Conservation Division, 130 S. Market - Room 2078, Wichita, Kansas 67202

6
17
19

IN ALL CASES PLOT THE INTENDED WELL ON THE PLAT BELOW

Plat of acreage attributable to a well in a prorated or spaced field

If the intended well is in a prorated or spaced field, please fully complete this side of the form. If the intended well is in a prorated or spaced field complete the plat below showing that the well will be properly located in relationship to other wells producing from the common source of supply. Please show all the wells and within 1 mile of the boundaries of the proposed acreage attribution unit for gas wells and within 1/2 mile of the boundaries of the proposed acreage attribution unit for oil wells.

API No. 15 - 163-23528-0000
 Operator: Nadel and Gussman, L.L.C.
 Lease: Gish
 Well Number: 9
 Field: Marcotte

Number of Acres attributable to well: _____
 QTR / QTR / QTR of acreage: SW - SW - SW

Location of Well: County: _____ Rooks _____
 _____ 330' feet from N / S Line of Section
 _____ 330' feet from E / W Line of Section
 Sec. 6 Twp. 10 S. R. 19 East West

Is Section: Regular or Irregular

If Section Is Irregular, locate well from nearest corner boundary.

Section corner used: NE NW SE SW

PLAT

*(Show location of the well and shade attributable acreage for prorated or spaced wells.)
 (Show footage to the nearest lease or unit boundary line.)*

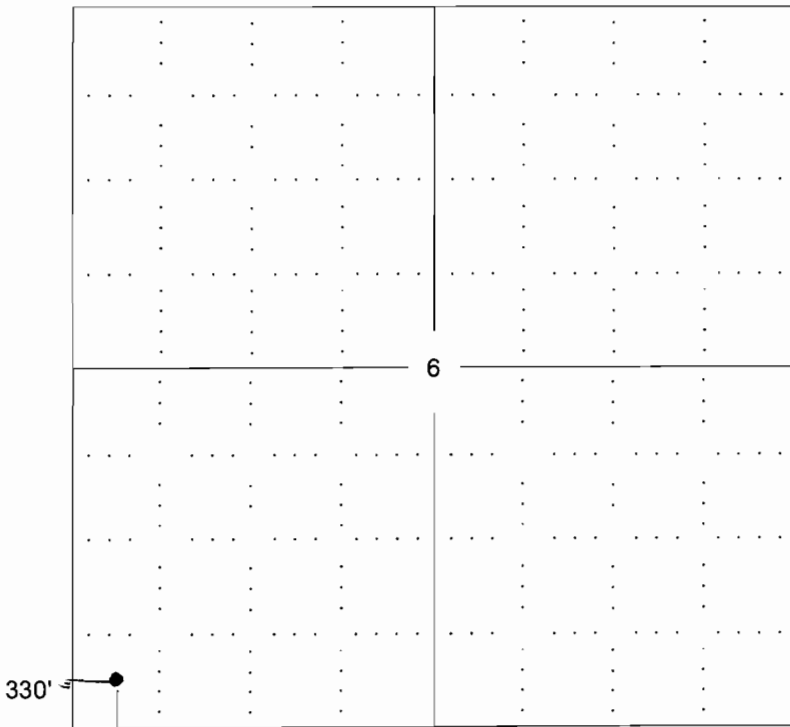

NOTE: In all cases locate the spot of the proposed drilling location.

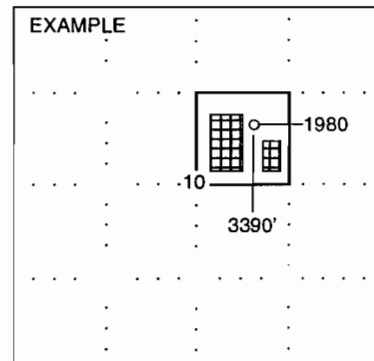

In plotting the proposed location of the well, you must show:

1. The manner in which you are using the depicted plat by identifying section lines, i.e. 1 section, 1 section with 8 surrounding sections, 4 sections, etc.
2. The distance of the proposed drilling location from the section's south / north and east / west.
3. The distance to the nearest lease or unit boundary line.
4. If proposed location is located within a prorated or spaced field a certificate of acreage attribution plat must be attached: (CO-7 for oil wells; CG-8 for gas wells).

