

FOR KCC USE:

EFFECTIVE DATE: 9-6-95

DISTRICT # 4
SSA? Yes No

State of Kansas
NOTICE OF INTENTION TO DRILL

FORM 6-1 7/9
FORM MUST BE FILLED
ALL BLANKS MUST BE FILLED

Must be approved by the K.C.C. five (5) days prior to commencing well

Expected Spud Date: 9 month 22 day 1995 year

Sec 29 Twp 8 S. Rg 17 East
SW/4 NW/4 SE/4

OPERATOR: License # 3218
Name: American Trading and Production Corporation
Address: 7676 Hillmont, Suite 350
City/State/Zip: Houston, Texas 77040
Contact Person: Donald W. Garrett
Phone: (713) 460-2355 EXT. 227

1650 feet from South / North line of Section
2310 feet from East / West line of Section
SECTION X REGULAR IRREGULAR

(NOTE: Locate well on the Section Plat on Reverse Side)
County: Rooks
Lease Name: Stamper Well # 4
Field Name: Dopita

CONTRACTOR: License #: Unknown ADVISE ON ACO-1
Name: Unknown

Is this a Prepacked/Soaked Field? yes X no
Target Formation(s): Lansing-Kansas City
Nearest Lease or Unit Boundary: 330

Well Drilled For:	Well Class:	Type Equipment:
<input checked="" type="checkbox"/> Oil	Enh Rec	Infield
<input type="checkbox"/> Gas	Storage	Pool Exp.
<input type="checkbox"/> OWD	Disposal	Air Rotary
<input type="checkbox"/> Seismic	# of Holes	Wildcat
<input type="checkbox"/> Other	Other	Cable

Ground Surface Elevation: 1950 feet MSL
Water well within one-quarter mile: yes X no
Public water supply well within one mile: yes X no

If OWD: old well information as follows:
Operator:
Well Name:
Comp. Date: Old Total Depth

Depth to bottom of fresh water: 180
Depth to bottom of usable water: 880 780
Surface Pipe by Alternate: X 1 2
Length of Surface Pipe Planned to be set: 1300
Length of Conductor pipe required: None

Directional, Deviated or Horizontal wellbore? yes X no
If yes, true vertical depth:
Bottom Hole Location:

Projected Total Depth: 3400
Formation at Total Depth: Arbuckle
Water Source for Drilling Operations:
... well X farm pond ... other

AFFIDAVIT

The undersigned hereby affirms that the drilling, completion and eventual plugging of this well will comply with K.S.A. 55-101, et. seq.
It is agreed that the following minimum requirements will be met:

RECEIVED
STATE CORPORATION COMMISSION
SEP 01 1995
9-1-1995
CONSERVATION DIVISION
NIGHT MANAGER

1. Notify the appropriate district office prior to spudding or well;
2. A copy of the approved notice of intent to drill shall be posted on each drilling rig;
3. The minimum amount of surface pipe as specified below shall be set by circulating cement in all cases surface pipe shall be set through all unconsolidated materials plus a minimum of 25 feet into the underlying formation;
4. If the well is dry hole, an agreement between the operator and the district office on plug length and placement is necessary prior to plugging;
5. The appropriate district office will be notified before well is either plugged or production casing is cemented in;
6. IF AN ALTERNATE IS COMPLETED, PRODUCTION PIPE SHALL BE CEMENTED FROM BELOW ANY USABLE WATER TO SURFACE WITHIN 120 DAYS OF SPUD DATE. IN ALL CASES, NOTIFY DISTRICT OFFICE PRIOR TO ANY CEMENTING.

I hereby certify that the statements made herein are true and to the best of my knowledge and belief.
Date: 9-30-95 Signature of Operator or Agent: Donald W. Garrett Title: Operations Manager

FOR KCC USE:
API # 15- 163-232670000
Conductor pipe required NONE feet
Minimum surface pipe required 800 feet per Alt. ① X
Approved by: JK 9-1-95
This authorization expires: 3-1-96
(This authorization void if drilling not started within 6 months of effective date.)
Spud date: Agent:

REVENUE TO:

- File Drill Site Application (form 639-1) with Intent to Drill;
 - File Completion Form ACO-1 within 120 days of spud date;
 - File acreage attribution plat according to field production orders;
 - Notify appropriate district office 48 hours prior to ventover or re-entry;
 - Submit plugging report (63-4) after plugging is completed;
 - Obtain written approval before disposing or injecting salt water.
- Mail to: Conservation Division, 200 Delaware Berry Building, 222 W. First St., Wichita, Kansas 67202-1236.

29
8
1725

IN ALL CASES PLOT THE INTENDED WELL ON THE PLAT BELOW
PLAT OF ACREAGE ATTRIBUTABLE TO A WELL IN A PRORATED OR SPACED FIELD

If the intended well is in a prorated or spaced field, please fully complete this side of the form. If the intended well is in a prorated or spaced field complete the plat below showing that the well will be properly located in relationship to other wells producing from the common source of supply. Please show all the wells within 1 mile of the boundaries of the proposed acreage attribution unit for gas wells and within 1/2 mile of the boundaries of the proposed acreage attribution unit for oil wells.

API NO. 15- _____
 OPERATOR _____
 LEASE _____
 WELL NUMBER _____
 FIELD _____

LOCATION OF WELL: COUNTY _____
 _____ feet from south/north line of section
 _____ feet from east/west line of section
 SECTION _____ TWP _____ RG _____

NUMBER OF ACRES ATTRIBUTABLE TO WELL _____ IS SECTION _____ REGULAR or _____ IRREGULAR
 QTR/QTR/QTR OF ACREAGE _____ IF SECTION IS IRREGULAR, LOCATE WELL FROM NEAREST CORNER BOUNDARY.
 Section corner used: _____ NE _____ NW _____ SE _____ SW
 PLAT

(Show location of the well and shade attributable acreage for prorated or spaced wells.)
 (Show footage to the nearest lease or unit boundary line.)

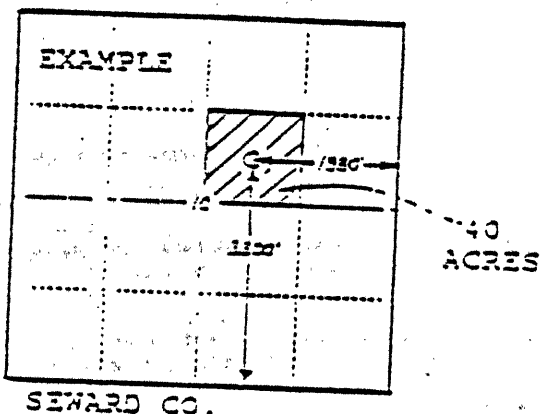
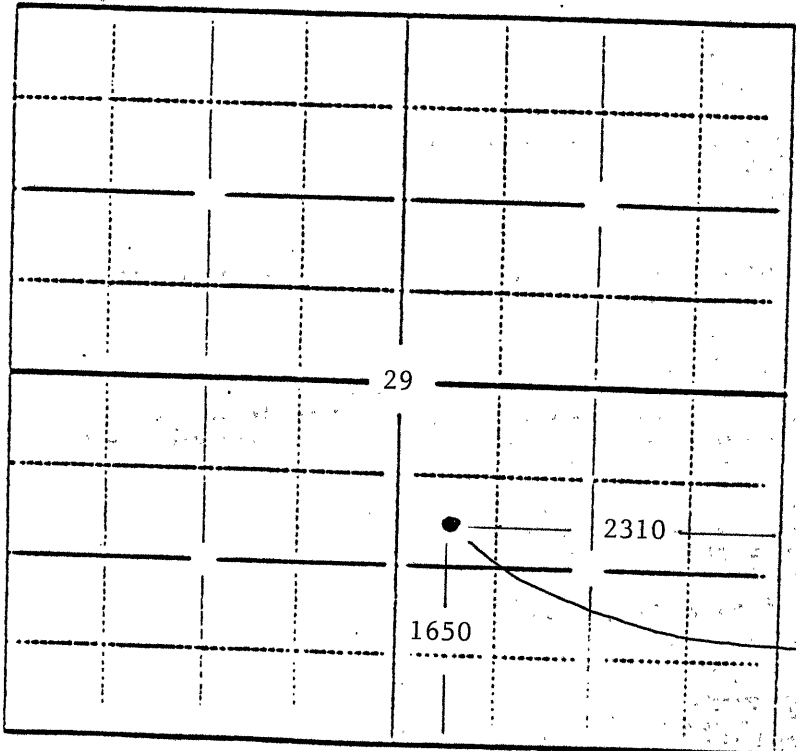

- In plotting the proposed location of the well you must show:
- 1) The manner in which you are using the depicted plat by identifying section lines, i.e. 1 section, 1 section with 3 surrounding sections, 4 sections, etc.;
 - 2) the distance of the proposed drilling location from the section's south/north and east/west lines; and
 - 3) the distance to the nearest lease or unit boundary line.