

FOR KCC USE:

EFFECTIVE DATE: 5-14-95

DISTRICT # 4
SSAT Yes No

State of Kansas
NOTICE OF INTENTION TO DRILL

FORM 5-1 7/9
FORM MUST BE TYPE
FORM MUST BE STAMPED
ALL BLANKS MUST BE FILLED

Must be approved by the K.C.C. five (5) days prior to commencing well

Expected Spud Date 6 21 95
month day year

SE/4 SE/4 SE/4 29 8 17 East
Sec Twp S. Rq. West

OPERATOR: License # 03218
Name: American Trading & Production Corp.
Address: 1331 Lamar, Suite 1250
City/State/Zip: Houston, TX 77010
Contact Person: Donald W. Garrett
Phone: 713 / 7658-0445

330 feet from South / North line of Section
330 feet from East / West line of Section
IS SECTION REGULAR IRREGULAR

CONTRACTOR: License #: Unknown
Name: Unknown

(NOTE: Locate well on the Section Plat on Reverse Side)
County: Rooks
Lease Name: Stamper "A" Well #: 13
Field Name: Dopita

Well Drilled For: Well Class: Type Equipment:
 Oil Enh Rec Infield Mud Rotary
 Gas Storage Pool Ext. Air Rotary
 OWD Disposal Wildcat Cable
 Seismic: # of Holes Other

Is this a Propped/Spaced Field? yes no
Target Formation(s): Lansing-Kansas City
Nearest Lease or Unit Boundary: 330'
Ground Surface Elevation: 1990' feet MSL

If OWD: old well information as follows:
Operator: N/A
Well Name: N/A
Comp. Date: N/A Old Total Depth: N/A

Water well within one-quarter mile: yes no
Public water supply well within one mile: yes no
Depth to bottom of fresh water: 75' 180'
Depth to bottom of usable water: 800' 880'

Directional, Deviated or Horizontal wellbore? yes no
If yes, true vertical depth: N/A
Bottom Hole Location: N/A

Surface Pipe by Alternate: 1 2
Length of Surface Pipe Planned to be set: 1300'
Length of Conductor pipe required: None
Projected Total Depth: 3400'

AFFIDAVIT

The undersigned hereby affirms that the drilling, completion and eventual plugging of this well will comply with K.S.A. SECTION 101, et. seq.
It is agreed that the following minimum requirements will be set:

5-8-1995
MAY 08 1995

1. Notify the appropriate district office prior to spudding or well.
 2. A copy of the approved notice of intent to drill shall be posted on each drilling rig;
 3. The minimum amount of surface pipe as specified below shall be set by circulating cement to the top in all cases surface pipe shall be set through all unconsolidated materials plus a minimum of 20 feet into the underlying formation;
 4. If the well is dry hole, an agreement between the operator and the district office on plug length and placement is necessary prior to plugging;
 5. The appropriate district office will be notified before well is either plugged or production casing is cemented in;
 6. IF AN ALTERNATE IS COMPLETED, PRODUCTION PIPE SHALL BE CEMENTED FROM BELOW ANY USABLE WATER TO SURFACE WITHIN 120 DAYS OF SPUD DATE. IN ALL CASES, NOTIFY DISTRICT OFFICE PRIOR TO ANY CEMENTING.
- I hereby certify that the statements made herein are true and to the best of my knowledge and belief.

Date: 5/02/95 Signature of Operator or Agent: Donald W. Garrett Title: Operations Manager

FOR KCC USE:
API # 15- 163-232620000
Conductor pipe required NONE feet
Minimum surface pipe required 900 feet per Alt. (1) X
Approved by: JK 5-8-95
This authorization expires: 11-8-95
(This authorization void if drilling not started within 6 months of effective date.)
Spud date: _____ Agent: _____

LENDER TO:

- File Drill Site Application (Form 509-1) with Intent to Drill;
- File Completion Form 509-1 within 120 days of spud date;
- File acreage attribution plat according to field operation orders;
- Notify appropriate district office 48 hours prior to ventover or re-entry;
- Submit plugging report (509-4) after plugging is completed;
- Obtain written approval before discarding or injecting salt water.

Mail to: Conservation Division, 200 Colorado Berry Building, 222 W. First St., Wichita, Kansas 67222-1236.

22
8
173

IN ALL CASES PLOT THE INTENDED WELL ON THE PLAT BELOW

PLAT OF ACREAGE ATTRIBUTABLE TO A WELL IN A PRORATED OR SPACED FIELD

If the intended well is in a prorated or spaced field, please fully complete this side of the form. If the intended well is in a prorated or spaced field complete the plat below showing that the well will be properly located in relationship to other wells producing from the common source of supply. Please show all the wells within 1 mile of the boundaries of the proposed acreage attribution unit for gas wells and within 1/2 mile of the boundaries of the proposed acreage attribution unit for oil wells.

API NO. 15- _____
 OPERATOR _____
 LEASE _____
 WELL NUMBER _____
 FIELD _____

LOCATION OF WELL: COUNTY _____
 _____ feet from south/north line of section
 _____ feet from east/west line of section
 SECTION _____ TWP _____ RG _____

NUMBER OF ACRES ATTRIBUTABLE TO WELL _____
 QTR/QTR/QTR OF ACREAGE _____

IS SECTION _____ REGULAR or _____ IRREGULAR
 IF SECTION IS IRREGULAR, LOCATE WELL FROM NEAREST CORNER BOUNDARY.

Section corner used: _____ NE _____ NW _____ SE _____ SW
 PLAT

(Show location of the well and shade attributable acreage for prorated or spaced wells.)
 (Show footage to the nearest lease or unit boundary line.)

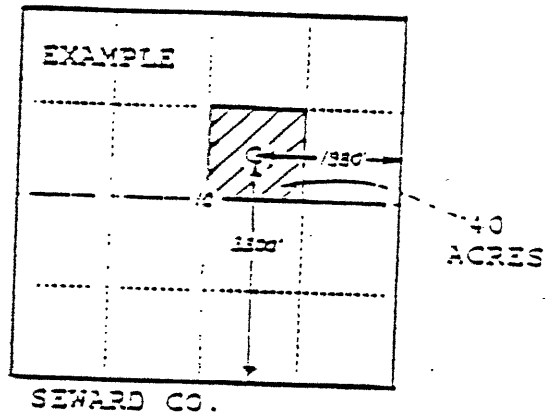
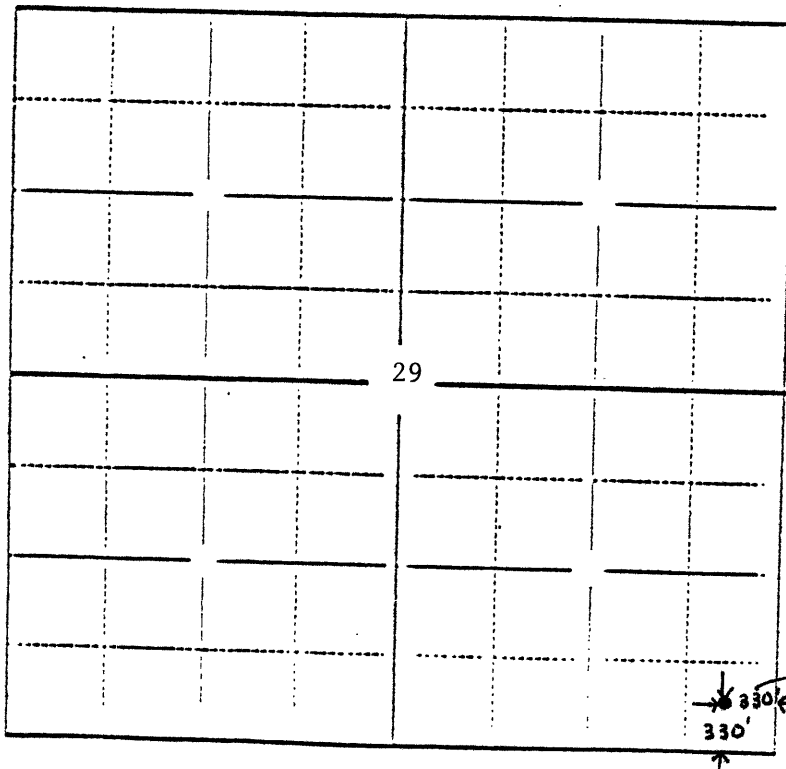

In plotting the proposed location of the well, you must show:

- 1) The manner in which you are using the depicted plat by identifying section lines, i.e. 1 section, 1 section with 3 surrounding sections, 4 sections, etc.;
- 2) the distance of the proposed drilling location from the section's south/north and east/west lines; and
- 3) the distance to the nearest lease or unit boundary line.