

EFFECTIVE DATE: 5-14-95

FORM MUST BE FILED

DISTRICT 4

NOTICE OF INTENTION TO DRILL

ALL BLANKS MUST BE FILLED

Must be approved by the C.C.C. five (5) days prior to commencing well

Expected Soud Date: 6 month, 7 day, 95 year. SW/4 SE/4 SE/4 Sec 29 Twp 8 S. Rq 17 East

OPERATOR: License # 03218 American Trading and Production Corp. 1331 Lamar, Suite 1250 Houston, Texas 77010 Donald W. Garrett (713) 658-0445

330 feet from South / North line of Section 990 feet from East / West line of Section IS SECTION X REGULAR IRREGULAR

CONTRACTOR: License # Unknown Name: Unknown at this time

NOTE: Locates well on the Section Plat on reverse side. County: Stamer "A" Well #: 11 Lease Name: Dopita Field Name: Is this a Protected/Spaced Field? yes X no Target formation(s): Lansing-Kansas City Nearest lease or unit boundary: 330 Ground Surface Elevation: 1970 Water well within one-quarter mile: yes X no Public water supply well within one mile: yes X no Depth to bottom of fresh water: 15' 180' Depth to bottom of usable water: 800' 880' Surface pipe by Alternate: X 1 2 Length of surface pipe planned to be set: 1300' Length of conductor pipe required: None Projected Total Depth: 3400' Formation at Total Depth: Arbuckle Water Source for Drilling Operations: N/A well X farm pond other OWR Permit #: N/A Will cores be taken? yes X no If yes, proposed zone: N/A

Well Drilled For: Well Class: Type Equipment: Oil X Enh Rec X Infield X Mud Rotary Gas Storage Pool Exp. Air Rotary OWD Disposal Wildcat Cable Seismic: A of Holes Other If OWD: old well information is follows: Operator: N/A Well Name: N/A Comp. Date: N/A Old Total Depth: N/A Directional, Deviated or Horizontal wellbore? yes X no If yes, true vertical depth: N/A Bottom Hole Location:

AFFIDAVIT

The undersigned hereby affirms that the drilling, completion and eventual plugging of this well will comply with K.S.A. 55-101, et. seq. It is agreed that the following minimum requirements will be met:

STATE CORPORATION COMMISSION 5-8-1995 MAY 08 1995

- 1. Notify the appropriate district office prior to spudding or well; 2. A copy of the approved notice of intent to drill shall be posted on each drilling rig; 3. The minimum amount of surface pipe as specified below shall be set by circulating cement to the top; in all cases surface pipe shall be set through all unconsolidated materials plus a minimum of 20 feet into the underlying formation; 4. If the well is dry hole, an agreement between the operator and the district office on plugging and abandonment is necessary prior to plugging; 5. The appropriate district office will be notified before well is either plugged or production casing is cemented in; 6. IF AN ALTERNATE IS COMPLETED, PRODUCTION PIPE SHALL BE CEMENTED FROM BELOW ANY USABLE WATER TO SURFACE WITHIN 120 DAYS OF SPOD DATE. IN ALL CASES, NOTIFY DISTRICT OFFICE PRIOR TO ANY CEMENTING.

I hereby certify that the statements made herein are true and to the best of my knowledge and belief. April 21, 1995 Date: Signature of Operator or Agent: Donald W. Garrett Operations Manager

FOR USE: API # 15- 163-232600000 * Conductor pipe required NONE feet Minimum surface pipe required 900' feet per Alt. (X) Approved by: JK 5-8-95 This authorization expires: 11-8-95 (This authorization void if drilling not started within 6 months of effective date.) Soud date: Agent:

EXHIBIT TO:

- File Drill Plat Application (Form 329-1) with intent to drill; - File Completion Form 100-1 within 120 days of soud date; - File service distribution plat according to field operation orders; - Notify appropriate district office 48 hours prior to ventover or re-entry; - Submit plugging report (32-4) after plugging is completed; - Obtain written approval before plugging or injecting salt water.

Mail to: Conservation Division, 200 Governor Jerry Building, 12th V. Floor St., Wichita, Kansas 67202-1226.

29 8 1713

IN ALL CASES PLOT THE INTENDED WELL ON THE PLAT BELOW

PLAT OF ACREAGE ATTRIBUTABLE TO A WELL IN A PRORATED OR SPACED FIELD

If the intended well is in a prorated or spaced field, please fully complete this side of the form. If the intended well is in a prorated or spaced field complete the plat below showing that the well will be properly located in relationship to other wells producing from the common source of supply. Please show all the wells within 1 mile of the boundaries of the proposed acreage attribution unit for gas wells and within 1/2 mile of the boundaries of the proposed acreage attribution unit for oil wells.

API NO. 15- _____
 OPERATOR _____
 LEASE _____
 WELL NUMBER _____
 FIELD _____

LOCATION OF WELL: COUNTY _____
 _____ feet from south/north line of section
 _____ feet from east/west line of section
 SECTION _____ TWP _____ RG _____

NUMBER OF ACRES ATTRIBUTABLE TO WELL _____
 QTR/QTR/QTR OF ACREAGE _____

IS SECTION _____ REGULAR or _____ IRREGULAR
 IF SECTION IS IRREGULAR LOCATE WELL FROM NEAREST
 CORNER BOUNDARY
 Section corner used: _____ NE _____ NW _____ SE _____ SW
 PLAT _____

(Show location of the well and shade attributable acreage for prorated or spaced wells.)
 (Show footage to the nearest lease or unit boundary line.)

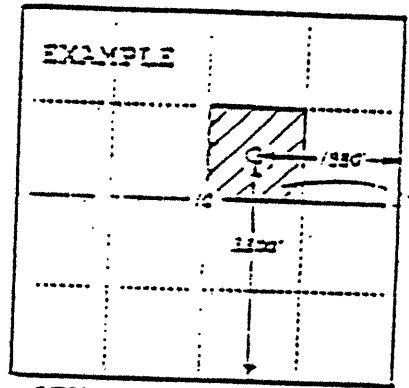
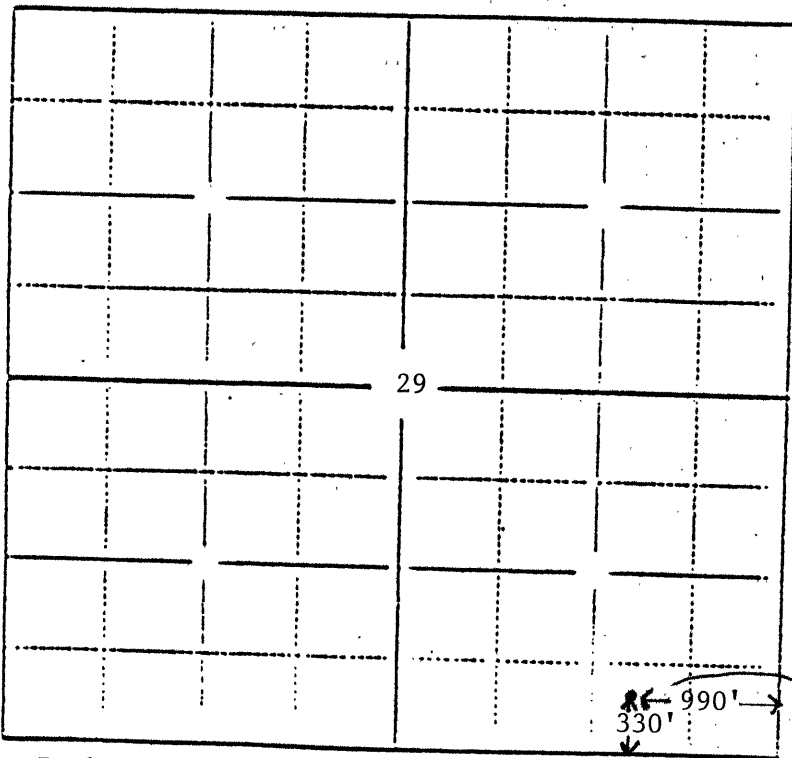

40
ACRES

In plotting the proposed location of the well you must show:

- 1) The manner in which you are using the depicted plat by identifying section lines, i. e. 1 section 1 section with 8 surrounding sections, 4 sections, etc.;
- 2) the distance of the proposed drilling location from the section's south/north and east/west lines; and
- 3) the distance to the nearest lease or unit boundary line.