

STATE OF KANSAS
STATE CORPORATION COMMISSION

Give All Information Completely
Make Required Affidavit
Mail or Deliver Report to:
Conservation Division
State Corporation Commission
212 North Market, Insurance Bldg.
Wichita, Kansas

WELL PLUGGING RECORD

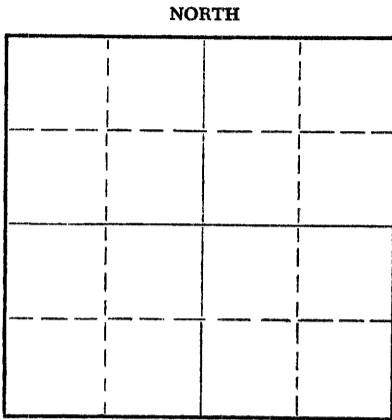

Sheridan County. Sec. 1 Twp. 7s Rge. 27w(E) (W)
Location as "NE/CNWxSWx" or footage from lines SW, SW, NW,
Lease Owner John O. Farmer, Inc.
Lease Name Leidig Well No. 1
Office Address P.O. Box 352, Russell, Kansas
Character of Well (completed as Oil, Gas or Dry Hole) Dry hole
Date well completed 7/18 19 67
Application for plugging filed 7/18 19 67
Application for plugging approved 7/18 19 67
Plugging commenced 7/18 19 67
Plugging completed 7 A. M. 7/18 19 67
Reason for abandonment of well or producing formation Dryhole

If a producing well is abandoned, date of last production _____ 19____
Was permission obtained from the Conservation Division or its agents before plugging was commenced? Yes

Name of Conservation Agent who supervised plugging of this well W. L. Nichols, Morland, Kansas
Producing formation _____ Depth to top _____ Bottom _____ Total Depth of Well 4081' Feet
Show depth and thickness of all water, oil and gas formations.

OIL, GAS OR WATER RECORDS

CASING RECORD

FORMATION	CONTENT	FROM	TO	SIZE	PUT IN	PULLED OUT

Describe in detail the manner in which the well was plugged, indicating where the mud fluid was placed and the method or methods used in introducing it into the hole. If cement or other plugs were used, state the character of same and depth placed, from _____ feet to _____ feet for each plug set.

Plug with pump truck
1860' to 1560' with 100 sx. cement
Plug 300' 20 sx. cement
Plug 40' 10 sx. cement
Completed: 7 A.M. 7/18/67

RECEIVED
STATE CORPORATION COMMISSION

JUL 24 1967
JUL 24, 1967
CONSERVATION DIVISION
Wichita, Kansas

Name of Plugging Contractor John O. Farmer, Inc.
Address P.O. Box 352, Russell, Kansas

STATE OF KANSAS, COUNTY OF RUSSELL, ss.
JOHN O. FARMER, President (employee of owner) or (owner or operator) of the above-described

well, being first duly sworn on oath, says: That I have knowledge of the facts, statements, and matters herein contained and the log of the above-described well as filed and that the same are true and correct. So help me God.

(Signature) John O. Farmer
P.O. Box 352, Russell, Kansas
(Address)

SUBSCRIBED AND SWORN to before me this 20th day of July, 19 67

My commission expires February 25, 1971

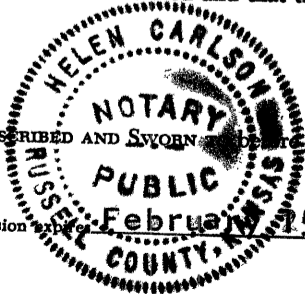

Helen Carlson
Notary Public.

15-179-20030-00-00

FORMATION RECORD

Give detailed description and thickness of all formation drilled through, contents of sand, whether dry, water, oil or gas.

Formation	Top	Bottom	Formation	Top	Bottom
Surface					
Shale	290	500			
Shale & shells	500	880			
Shale & Sand	880	2320			
Shale & Shells	2320	2378			
Anhydrite	2378	2412			
Shale & shells	2412	2660			
Shale & Lime	2660	3380			
Lime & shale	3380	3890			
Lime	3890	3900			
Shale & lime	3900	4020			
Lime	4090	4081'			

Sample Tops

Heebner 3821'
 Toronto 3844'
 Lansing 3862'
 Base Kansas City 4070'
 Rotary T.D. 4081'

RECEIVED
 STATE CORPORATION COMMISSION
 JUL 24 1967
 JUL 24 1967
 CONSERVATION DIVISION
 Wichita, Kansas

OPERATOR JOHN O. FARMER, INC.
 ADDRESS P.O. Box 352, Russell, Kansas

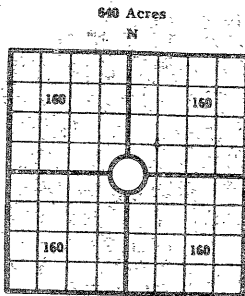

COUNTY Sheridan SEC. 1 TWP. 7s RGE. 27W
 COMPANY OPERATING JOHN O. FARMER, INC.
 OFFICE ADDRESS Box 352, Russell, Ks.
 DRILLING STARTED 7/10/67 DRILLING FINISHED 7/18/67
 DATE OF FIRST PRODUCTION _____ COMPLETED _____
 WELL LOCATED SW 1/4 SW 1/4 NW 1/4, North of South
 Line and _____ ft. East of West Line of Quarter Section
 Elevation (Relative to sea level) DERRICK FLOOR 2677 GROUND 2674
 CHARACTER OF WELL (Oil, gas or dryhole) Dryhole

OIL OR GAS SANDS OR ZONES

Name	From	To	Name	From	To
1			4		
2			5		
3			6		

Perforating Record If Any

Formation	From	To	No. of Shots	Formation	From	To	Size of Shot

CASING RECORD

Amount Set						Amount Pulled				Packer Record	
Size	Wt.	Thds.	Make	Ft.	In.	Ft.	In.	Size	Length	Depth Set	Make

Liner Record: Amount _____ Kind _____ Top _____ Bottom _____

CEMENTING AND MUDDING

Size	Amount Set		Sacks Cement	Chemical		Method of Cementing	Amount	Mudding Method	Results (See Note)
	Ft.	In.		Gal.	Make				
8	5/8"	286'	150	sx.					

Note: What method was used to protect sands if outer strings were pulled? _____

NOTE: Were bottom hole plugs used? _____ If so, state kind, depth set and results obtained _____

TOOLS USED

Rotary Tools were used from 0 feet to R.T.D. Cable tools were used from _____ feet to _____ feet, and from _____ feet to _____ feet, and from _____ feet to _____ feet to _____

Type Rig Rotary

INITIAL PRODUCTION TEST

Describe initial test: whether by flow through tubing or casing or by pumping _____

Amount of Oil Production _____ bbls. Size of choke, if any _____ Length of test _____ Water

Production _____ bbls. Gravity of oil _____ Type of Pump if pump is used, describe _____

I, the undersigned, being first duly sworn upon oath, state that this well record is true, correct and complete according to the records of this office and to the best of my knowledge and belief.

John O. Farmer
 Name and title of representative of company
 President

Subscribed and sworn to before me this 20th day of July, 1967

My Commission expires 2/15/71

Helen Carlson Notary Public.

WELL NO. _____ COUNTY Sheridan TWP. 7s RGE. 27W
 FARM NAME LEIDIG SEC. 1