

RECEIVED

APR 28 2006

Form C-1  
December 2002

For KCC Use:  
Effective Date: 5-7-06  
District # 1  
SGA?  Yes  No

KANSAS CORPORATION COMMISSION  
OIL & GAS CONSERVATION DIVISION  
**NOTICE OF INTENT TO DRILL**

KCC WICHITA

Form must be Typed  
Form must be Signed  
All blanks must be Filled

Must be approved by KCC five (5) days prior to commencing well

Expected Spud Date May 06 2006  
month day year

1601 E

Spot 1601 E East   
N/2 - NW - NE Sec. 6 Twp. 34 S. R. 20 West   
330 feet from  N /  S Line of Section  
1820 feet from  E /  W Line of Section

OPERATOR: License# 31691  
Name: Coral Coast Petroleum, L.C.  
Address: 8100 E. 22nd St. N. Building 100 Suite 2  
City/State/Zip: Wichita/Kansas/67226  
Contact Person: Daniel M. Reynolds  
Phone: 316-269-1233

Is SECTION  Regular  Irregular?  
(Note: Locate well on the Section Plat on reverse side)  
County: Comanche  
Lease Name: Butts Well #: 1  
Field Name: Harper Ranch East

CONTRACTOR: License# 5822  
Name: Val Energy, Inc.

Is this a Prorated / Spaced Field?  Yes  No  
Target Formation(s): Mississippi  
Nearest Lease or unit boundary: 330

Well Drilled For: Well Class: Type Equipment:  
 Oil  Enh Rec  Infield  Mud Rotary  
 Gas  Storage  Pool Ext.  Air Rotary  
 OWWO  Disposal  Wildcat  Cable  
 Seismic; # of Holes  Other  
 Other

Ground Surface Elevation: 1774 feet MSL  
Water well within one-quarter mile:  Yes  No  
Public water supply well within one mile:  Yes  No

If OWWO: old well information as follows:  
Operator: \_\_\_\_\_  
Well Name: \_\_\_\_\_  
Original Completion Date: \_\_\_\_\_ Original Total Depth: \_\_\_\_\_

Depth to bottom of fresh water: 100  
Depth to bottom of usable water: 100 180  
Surface Pipe by Alternate:  1  2  
Length of Surface Pipe Planned to be set: 600  
Length of Conductor Pipe required: 60  
Projected Total Depth: 5400  
Formation at Total Depth: Mississippi

Directional, Deviated or Horizontal wellbore?  Yes  No  
If Yes, true vertical depth: \_\_\_\_\_  
Bottom Hole Location: \_\_\_\_\_  
KCC DKT #: \_\_\_\_\_

Water Source for Drilling Operations:  Well  Farm Pond  Other  
DWR Permit #: \_\_\_\_\_  
(Note: Apply for Permit with DWR )  
Will Cores be taken?  Yes  No  
If Yes, proposed zone: \_\_\_\_\_

**AFFIDAVIT**

The undersigned hereby affirms that the drilling, completion and eventual plugging of this well will comply with K.S.A. 55 et. seq.  
It is agreed that the following minimum requirements will be met:

1. Notify the appropriate district office **prior** to spudding of well;
2. A copy of the approved notice of intent to drill **shall be** posted on each drilling rig;
3. The minimum amount of surface pipe as specified below **shall be set** by circulating cement to the top; in all cases surface pipe **shall be set** through all unconsolidated materials plus a minimum of 20 feet into the underlying formation.
4. If the well is dry hole, an agreement between the operator and the district office on plug length and placement is necessary **prior to plugging**;
5. The appropriate district office will be notified before well is either plugged or production casing is cemented in;
6. If an ALTERNATE II COMPLETION, production pipe shall be cemented from below any usable water to surface within **120 days** of spud date.  
Or pursuant to Appendix "B" - Eastern Kansas surface casing order #133,891-C, which applies to the KCC District 3 area, alternate II cementing must be completed within 30 days of the spud date or the well shall be plugged. **in all cases, NOTIFY district office** prior to any cementing.

I hereby certify that the statements made herein are true and to the best of my knowledge and belief.

Date: April 25, 2006 Signature of Operator or Agent: Daniel M. Reynolds Title: Managing Member

For KCC Use ONLY  
API # 15 - 033-21471-0000  
Conductor pipe required None feet  
Minimum surface pipe required 200 feet per Alt. 1  
Approved by: RH 5-2-06  
This authorization expires: 11-2-06  
(This authorization void if drilling not started within 6 months of approval date.)  
Spud date: \_\_\_\_\_ Agent: \_\_\_\_\_

**Remember to:**

- File Drill Pit Application (form CDP-1) with Intent to Drill;
- File Completion Form ACO-1 within 120 days of spud date;
- File acreage attribution plat according to field proration orders;
- Notify appropriate district office 48 hours prior to workover or re-entry;
- Submit plugging report (CP-4) after plugging is completed;
- Obtain written approval before disposing or injecting salt water.
- If this permit has expired (See: authorized expiration date) please check the box below and return to the address below.

Well Not Drilled - Permit Expired  
Signature of Operator or Agent: \_\_\_\_\_  
Date: \_\_\_\_\_

Mail to: KCC - Conservation Division, 130 S. Market - Room 2078, Wichita, Kansas 67202

6  
34  
20W

IN ALL CASES PLOT THE INTENDED WELL ON THE PLAT BELOW

Plat of acreage attributable to a well in a prorated or spaced field

If the intended well is in a prorated or spaced field, please fully complete this side of the form. If the intended well is in a prorated or spaced field complete the plat below showing that the well will be properly located in relationship to other wells producing from the common source of supply. Please show all the wells and within 1 mile of the boundaries of the proposed acreage attribution unit for gas wells and within 1/2 mile of the boundaries of the proposed acreage attribution unit for oil wells.

API No. 15 - 033-21471-0000
Operator: Coral Coast Petroleum, L.C.
Lease: Butts
Well Number: 1
Field: Harper Ranch East
Number of Acres attributable to well:
QTR / QTR / QTR of acreage: N/2 - NW - NE

Location of Well: County: Comanche
330 feet from N / S Line of Section
1820 feet from E / W Line of Section
Sec. 6 Twp. 34 S. R. 20 East West

Is Section: Regular or Irregular

If Section is Irregular, locate well from nearest corner boundary.
Section corner used: NE NW SE SW

PLAT

(Show location of the well and shade attributable acreage for prorated or spaced wells.)
(Show footage to the nearest lease or unit boundary line.)

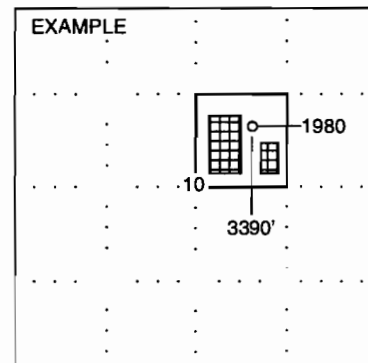
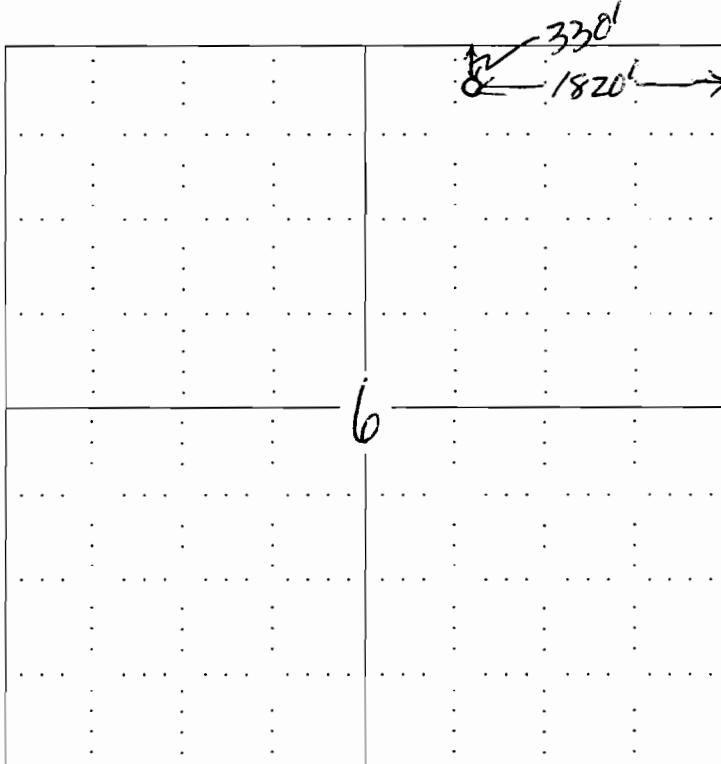

SEWARD CO.

NOTE: In all cases locate the spot of the proposed drilling locaton.

In plotting the proposed location of the well, you must show:

- 1. The manner in which you are using the depicted plat by identifying section lines, i.e. 1 section, 1 section with 8 surrounding sections, 4 sections, etc.
2. The distance of the proposed drilling location from the section's south / north and east / west.
3. The distance to the nearest lease or unit boundary line.
4. If proposed location is located within a prorated or spaced field a certificate of acreage attribution plat must be attached: (C0-7 for oil wells; CG-8 for gas wells).

RECEIVED

KANSAS CORPORATION COMMISSION  
OIL & GAS CONSERVATION DIVISION

APR 28 2006

Form CDP-1  
April 2004

Form must be Typed

APPLICATION FOR SURFACE PIT KCC WICHITA

Submit in Duplicate

Operator Name: Coral Coast Petroleum, L.C.		License Number: 31691
Operator Address: 8100 E. 22nd St. N. Building 100 Suite 2 Wichita, Kansas 67226		
Contact Person: Daniel M. Reynolds		Phone Number: ( 316 ) 269 - 1233
Lease Name & Well No.: Butts #1		Pit Location (QQQQ): 160'E _ N/2 _ NW _ NE
Type of Pit: <input type="checkbox"/> Emergency Pit <input type="checkbox"/> Burn Pit <input type="checkbox"/> Settling Pit <input checked="" type="checkbox"/> Drilling Pit <input type="checkbox"/> Workover Pit <input type="checkbox"/> Haul-Off Pit <small>(If WP Supply API No. or Year Drilled)</small>	Pit is: <input checked="" type="checkbox"/> Proposed <input type="checkbox"/> Existing If Existing, date constructed: _____ Pit capacity: 800 _____ (bbbls)	Sec. 6 Twp. 34 R. 20 <input type="checkbox"/> East <input checked="" type="checkbox"/> West 330 Feet from <input checked="" type="checkbox"/> North / <input type="checkbox"/> South Line of Section 1820 Feet from <input checked="" type="checkbox"/> East / <input type="checkbox"/> West Line of Section Comanche _____ County
Is the pit located in a Sensitive Ground Water Area? <input checked="" type="checkbox"/> Yes <input checked="" type="checkbox"/> No		Chloride concentration: _____ mg/l <small>(For Emergency Pits and Settling Pits only)</small>
Is the bottom below ground level? <input checked="" type="checkbox"/> Yes <input type="checkbox"/> No	Artificial Liner? <input type="checkbox"/> Yes <input type="checkbox"/> No	How is the pit lined if a plastic liner is not used? Compacted Earth
Pit dimensions (all but working pits): 80 Length (feet) 80 Width (feet)    N/A: Steel Pits Depth from ground level to deepest point: 3 (feet)		
If the pit is lined give a brief description of the liner material, thickness and installation procedure.		Describe procedures for periodic maintenance and determining liner integrity, including any special monitoring.
Distance to nearest water well within one-mile of pit 400 feet    Depth of water well 100 feet		Depth to shallowest fresh water 80 feet. Source of information: _____ measured <input checked="" type="checkbox"/> well owner    _____ electric log    _____ KDWR
<b>Emergency, Settling and Burn Pits ONLY:</b> Producing Formation: _____ Number of producing wells on lease: _____ Barrels of fluid produced daily: _____ Does the slope from the tank battery allow all spilled fluids to flow into the pit? <input type="checkbox"/> Yes <input type="checkbox"/> No		<b>Drilling, Workover and Haul-Off Pits ONLY:</b> Type of material utilized in drilling/workover: Drilling mud Number of working pits to be utilized: 1 Abandonment procedure: Allow to dry and then backfill _____ Drill pits must be closed within 365 days of spud date.
I hereby certify that the above statements are true and correct to the best of my knowledge and belief.		
4/25/2006 Date		 Signature of Applicant or Agent
<b>KCC OFFICE USE ONLY</b>		
Date Received: 4/28/06    Permit Number: _____		Permit Date: 5/2/06    Lease Inspection: <input checked="" type="checkbox"/> Yes <input type="checkbox"/> No

15-033-21471-0000

Mail to: KCC - Conservation Division, 130 S. Market - Room 2078, Wichita, Kansas 67202

# KANSAS

CORPORATION COMMISSION

KATHLEEN SEBELIUS, GOVERNOR

BRIAN J. MOLINE, CHAIR

ROBERT E. KREHBIEL, COMMISSIONER

MICHAEL C. MOFFET, COMMISSIONER

May 2, 2006

Mr. Daniel M. Reynolds  
Coral Coast Petroleum, LC  
8100 E. 22<sup>nd</sup> St. N. Bldg. 100 Ste 2  
Wichita, KS 67226

Re: Drilling Pit Application  
Butts Lease Well No. 1  
NE/4 Sec. 06-34S-20W  
Comanche County, Kansas

Dear Mr. Reynolds:

District staff has inspected the above referenced location and has determined that the reserve pit shall be constructed **without slots**, the bottom shall be flat and reasonably level and the free fluids must be removed. The fluids are to be removed from the reserve pit as soon as the Hutchinson Salt section has been drilled through and displacement of the fluids into the reserve pit has occurred. The fluids should be removed again as soon as practical after drilling operations have ceased.

**If production casing is set all completion fluids shall be removed from the working pits daily. NO completion fluids or non-exempt wastes shall be placed in the reserve pit.**

The fluids should be taken to an authorized disposal well. Please call the District Office at (620) 225-8888 when the fluids have been removed. Please file form CDP-5 (August 2004), Exploration and Production Waste Transfer, within 30 days of fluid removal. Conservation division forms are available through our office and on the KCC web site: [www.kcc.state.ks.us/conservation/forms](http://www.kcc.state.ks.us/conservation/forms).

**A copy of this letter should be posted in the doghouse along with the approved Intent to Drill.**

If you have any questions or concerns please feel free to contact the undersigned at the above address.

Sincerely,

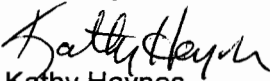

Kathy Haynes

Department of Environmental Protection and Remediation

cc: File