

RECEIVED

MAY 01 2006

Form C-1

December 2002

Form must be Typed

Form must be Signed

blanks must be Filled

For KCC Use: Effective Date: 5-10-06 District # 1 SGA? Yes No

KANSAS CORPORATION COMMISSION OIL & GAS CONSERVATION DIVISION

NOTICE OF INTENT TO DRILL KCC WICHITA

Must be approved by KCC five (5) days prior to commencing well

Expected Spud Date May 25 2006

OPERATOR: License# 6622 Jason Oil Company PO Box 701 Russell, KS 67665 Contact Person: Jim Schoenberger Phone: 785-483-4204

CONTRACTOR: License# 33350 Southwind Drilling, Inc.

Well Drilled For: Oil, Gas, OWWO, Seismic, Other Well Class: Enh Rec, Storage, Disposal, Other Type Equipment: Mud Rotary, Air Rotary, Cable

If OWWO: old well information as follows: Operator: Well Name: Original Completion Date: Original Total Depth:

Directional, Deviated or Horizontal wellbore? Yes No

If Yes, true vertical depth:

Bottom Hole Location:

KCC DKT #:

Spot 150' W & 60' S of 2040 810 feet from N/E Line of Section Is SECTION Regular Irregular?

County: Ness Lease Name: Sutton Well #: 1 Field Name:

Is this a Prorated / Spaced Field? Target Formation(s): Mississippi Nearest Lease or unit boundary: 810' Ground Surface Elevation: est 2300' feet MSL Water well within one-quarter mile: Public water supply well within one mile: Depth to bottom of fresh water: 180 Depth to bottom of usable water: 780 Surface Pipe by Alternate: 1 2 Length of Surface Pipe Planned to be set: 200 Length of Conductor Pipe required: None Projected Total Depth: 4400 Formation at Total Depth: Mississippi Water Source for Drilling Operations: Well Farm Pond Other Haul DWR Permit #:

(Note: Apply for Permit with DWR) Will Cores be taken? Yes No If Yes, proposed zone:

AFFIDAVIT

The undersigned hereby affirms that the drilling, completion and eventual plugging of this well will comply with K.S.A. 55 et. seq. It is agreed that the following minimum requirements will be met:

- 1. Notify the appropriate district office prior to spudding of well; 2. A copy of the approved notice of intent to drill shall be posted on each drilling rig; 3. The minimum amount of surface pipe as specified below shall be set by circulating cement to the top; in all cases surface pipe shall be set through all unconsolidated materials plus a minimum of 20 feet into the underlying formation. 4. If the well is dry hole, an agreement between the operator and the district office on plug length and placement is necessary prior to plugging; 5. The appropriate district office will be notified before well is either plugged or production casing is cemented in; 6. If an ALTERNATE II COMPLETION, production pipe shall be cemented from below any usable water to surface within 120 days of spud date. Or pursuant to Appendix "B" - Eastern Kansas surface casing order #133,891-C, which applies to the KCC District 3 area, alternate II cementing must be completed within 30 days of the spud date or the well shall be plugged. In all cases, NOTIFY district office prior to any cementing.

I hereby certify that the statements made herein are true and to the best of my knowledge and belief.

Date: 04-28-06 Signature of Operator or Agent: Todd S. Moynihan Title: Agent

For KCC Use ONLY API # 15 - 135-24501-0000 Conductor pipe required None feet Minimum surface pipe required 200 feet per Alt. Approved by: RTH 5-5-06 This authorization expires: 11-5-06 (This authorization void if drilling not started within 6 months of approval date.) Spud date: Agent:

Remember to:

- File Drill Pit Application (form CDP-1) with Intent to Drill; - File Completion Form ACO-1 within 120 days of spud date; - File acreage attribution plat according to field proration orders; - Notify appropriate district office 48 hours prior to workover or re-entry; - Submit plugging report (CP-4) after plugging is completed; - Obtain written approval before disposing or injecting salt water. - If this permit has expired (See: authorized expiration date) please check the box below and return to the address below.

Well Not Drilled - Permit Expired Signature of Operator or Agent: Date:

Mail to: KCC - Conservation Division, 130 S. Market - Room 2078, Wichita, Kansas 67202

3 18 24 W

RECEIVED
MAY 01 2006
KCC WICHITA

IN ALL CASES PLOT THE INTENDED WELL ON THE PLAT BELOW

Plat of acreage attributable to a well in a prorated or spaced field

If the intended well is in a prorated or spaced field, please fully complete this side of the form. If the intended well is in a prorated or spaced field complete the plat below showing that the well will be properly located in relationship to other wells producing from the common source of supply. Please show all the wells and within 1 mile of the boundaries of the proposed acreage attribution unit for gas wells and within 1/2 mile of the boundaries of the proposed acreage attribution unit for oil wells.

API No. 15 - 135-24501-0000
Operator: Jason Oil Company
Lease: Sutton
Well Number: 1
Field: _____
Number of Acres attributable to well: _____
QTR / QTR / QTR of acreage: _____ - SE - NE

Location of Well: County: Ness
2040 feet from N / S Line of Section
810 feet from E / W Line of Section
Sec. 3 Twp. 18 S. R. 24 East West

Is Section: Regular or Irregular

If Section is Irregular, locate well from nearest corner boundary.

Section corner used: NE NW SE SW

PLAT

(Show location of the well and shade attributable acreage for prorated or spaced wells.)
(Show footage to the nearest lease or unit boundary line.)

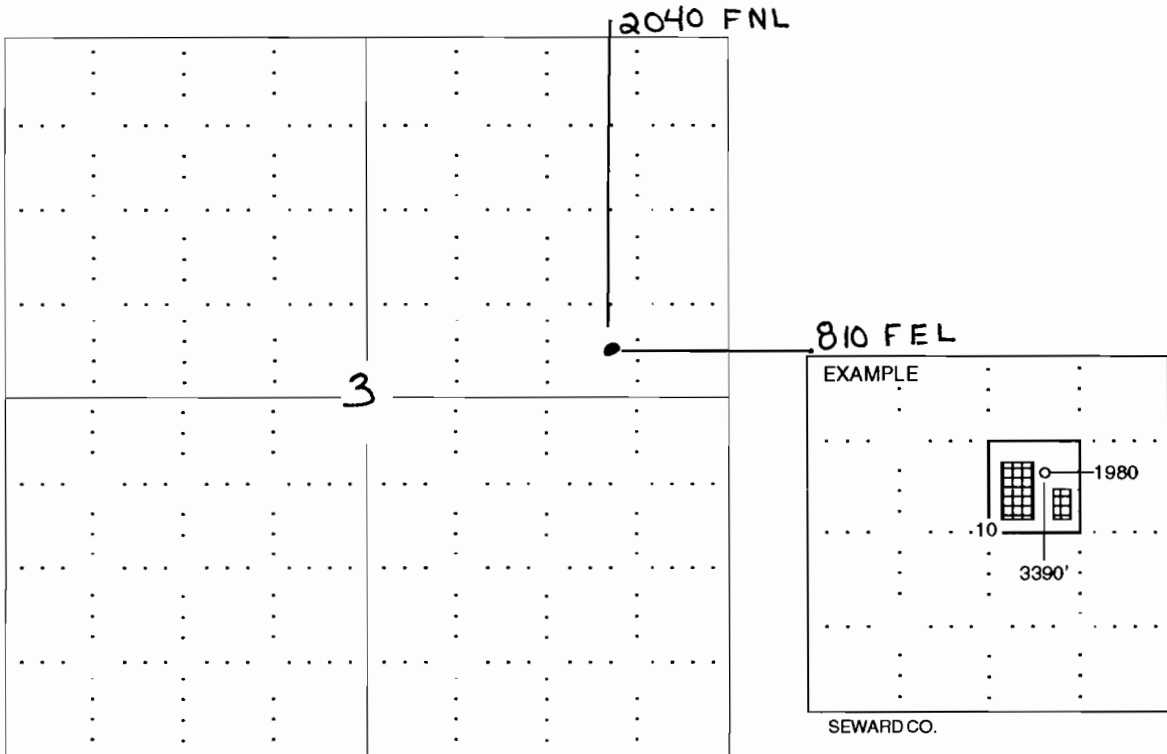

NOTE: In all cases locate the spot of the proposed drilling location.

In plotting the proposed location of the well, you must show:

1. The manner in which you are using the depicted plat by identifying section lines, i.e. 1 section, 1 section with 8 surrounding sections, 4 sections, etc.
2. The distance of the proposed drilling location from the section's south / north and east / west.
3. The distance to the nearest lease or unit boundary line.
4. If proposed location is located within a prorated or spaced field a certificate of acreage attribution plat must be attached: (C0-7 for oil wells; CG-8 for gas wells).

RECEIVED

KANSAS CORPORATION COMMISSION
OIL & GAS CONSERVATION DIVISION

MAY 01 2006

Form CDP-1
April 2004
Form must be Typed

APPLICATION FOR SURFACE PIT KCC WICHITA

Submit in Duplicate

| | | |
|--|---|--|
| Operator Name: Jason Oil Company | | License Number: 6622 |
| Operator Address: PO Box 701, Russell, KS 67665 | | |
| Contact Person: Jim Schoenberger | | Phone Number: (785) 483 - 4204 |
| Lease Name & Well No.: SUTTON # 1 | | Pit Location (QQQQ): 150°W 60°S SE NE Sec. 3 Twp. 18S R. 24 <input type="checkbox"/> East <input checked="" type="checkbox"/> West 2040 Feet from <input checked="" type="checkbox"/> North / <input type="checkbox"/> South Line of Section 810 Feet from <input checked="" type="checkbox"/> East / <input type="checkbox"/> West Line of Section Ness County |
| Type of Pit: <input type="checkbox"/> Emergency Pit <input type="checkbox"/> Burn Pit <input type="checkbox"/> Settling Pit <input checked="" type="checkbox"/> Drilling Pit <input type="checkbox"/> Workover Pit <input type="checkbox"/> Haul-Off Pit <small>(If WP Supply API No. or Year Drilled)</small> | Pit is: <input checked="" type="checkbox"/> Proposed <input type="checkbox"/> Existing If Existing, date constructed: Pit capacity: 4500 (bbls) | |
| Is the pit located in a Sensitive Ground Water Area? <input checked="" type="checkbox"/> Yes <input type="checkbox"/> No | | Chloride concentration: _____ mg/l <small>(For Emergency Pits and Settling Pits only)</small> |
| Is the bottom below ground level? <input checked="" type="checkbox"/> Yes <input type="checkbox"/> No | Artificial Liner? <input type="checkbox"/> Yes <input checked="" type="checkbox"/> No | How is the pit lined if a plastic liner is not used? Earthen clay |
| Pit dimensions (all but working pits): 80 Length (feet) 80 Width (feet) N/A: Steel Pits Depth from ground level to deepest point: 4 (feet) | | |
| If the pit is lined give a brief description of the liner material, thickness and installation procedure. | | Describe procedures for periodic maintenance and determining liner integrity, including any special monitoring. |
| Distance to nearest water well within one-mile of pit 0 3207 feet Depth of water well NA 66 feet | | Depth to shallowest fresh water 28 feet. Source of information: KKKGS _____ measured _____ well owner _____ electric log _____ KDWR |
| Emergency, Settling and Burn Pits ONLY: Producing Formation: _____ Number of producing wells on lease: _____ Barrels of fluid produced daily: _____ Does the slope from the tank battery allow all spilled fluids to flow into the pit? <input type="checkbox"/> Yes <input type="checkbox"/> No | | Drilling, Workover and Haul-Off Pits ONLY: Type of material utilized in drilling/workover: chemical drilling mud Number of working pits to be utilized: 3 Abandonment procedure: Allow fluid to evaporate: refill with excavated dirt Drill pits must be closed within 365 days of spud date. |
| I hereby certify that the above statements are true and correct to the best of my knowledge and belief. | | |
| 04-28-06 Date | | <i>Godd S. Morgan</i> Signature of Applicant or Agent |
| KCC OFFICE USE ONLY | | |
| Date Received: 5/1/06 Permit Number: _____ Permit Date: 5/4/06 | | Lease Inspection: <input checked="" type="checkbox"/> Yes <input type="checkbox"/> No |

15-135-24501-0000