

For KCC Use: 5-14-06
 Effective Date: _____
 District # 1
 SGA? Yes No

KANSAS CORPORATION COMMISSION
 OIL & GAS CONSERVATION DIVISION

Form C-1
 December 2002
Form must be Typed
Form must be Signed
All blanks must be Filled

NOTICE OF INTENT TO DRILL

Must be approved by KCC five (5) days prior to commencing well

Expected Spud Date May 15 2006
month day year

Spot C - NW - SW Sec. 29 Twp. 27 S. R. 30 East West
1980 feet from N / S Line of Section
660 feet from E / W Line of Section
 Is SECTION Regular Irregular?

OPERATOR: License# 33573 ✓
 Name: Arena Resources, Inc.
 Address: 4920 S Lewis, Ste 107
 City/State/Zip: Tulsa, Ok 74105
 Contact Person: Mike Barnhart
 Phone: 918-747-6060

(Note: Locate well on the Section Plat on reverse side)
 County: Gray
 Lease Name: Schmidt Well #: 2-29
 Field Name: _____

CONTRACTOR: License# 5382 33375 ✓
 Name: Cheyenne Drilling LP

Is this a Prorated / Spaced Field? Yes No ✓
 Target Formation(s): Chase
 Nearest Lease or unit boundary: 660

Well Drilled For: Well Class: Type Equipment:
 Oil Enh Rec Infield Mud Rotary ✓
 Gas Storage Pool Ext. Air Rotary
 QWFO Disposal Wildcat Cable
 Seismic; # of Holes Other
 Other

Ground Surface Elevation: 2811 feet MSL
 Water well within one-quarter mile: Yes No ✓
 Public water supply well within one mile: Yes No ✓

If OWWO: old well information as follows:
 Operator: _____
 Well Name: _____
 Original Completion Date: _____ Original Total Depth: _____

Depth to bottom of fresh water: 520
 Depth to bottom of usable water: 1000
 Surface Pipe by Alternate: 1 2
 Length of Surface Pipe Planned to be set: 550
 Length of Conductor Pipe required: None
 Projected Total Depth: 2800
 Formation at Total Depth: Chase

Directional, Deviated or Horizontal wellbore? Yes No
 If Yes, true vertical depth: _____
 Bottom Hole Location: _____
 KCC DKT #: _____

Water Source for Drilling Operations:
 Well Farm Pond Other
 DWR Permit #: * (Note: Apply for Permit with DWR)
 Will Cores be taken? Yes No
 If Yes, proposed zone: _____

AFFIDAVIT

The undersigned hereby affirms that the drilling, completion and eventual plugging of this well will comply with K.S.A. 55 et. seq.
 It is agreed that the following minimum requirements will be met:
 1. Notify the appropriate district office **prior** to spudding of well;
 2. A copy of the approved notice of intent to drill **shall be** posted on each drilling rig;
 3. The minimum amount of surface pipe as specified below **shall be set** by circulating cement to the top; in all cases surface pipe **shall be set** through all unconsolidated materials plus a minimum of 20 feet into the underlying formation.
 4. If the well is dry hole, an agreement between the operator and the district office on plug length and placement is necessary **prior to plugging**;
 5. The appropriate district office will be notified before well is either plugged or production casing is cemented in;
 6. If an ALTERNATE II COMPLETION, production pipe shall be cemented from below any usable water to surface within **120 days** of spud date. Or pursuant to Appendix "B" - Eastern Kansas surface casing order #133,891-C, which applies to the KCC District 3 area, alternate II cementing must be completed within 30 days of the spud date or the well shall be plugged. **In all cases, NOTIFY district office** prior to any cementing.

I hereby certify that the statements made herein are true and to the best of my knowledge and belief.

Date: 5-4-06 Signature of Operator or Agent: Mike Barnhart Title: P.M.

RECEIVED
 MAY 04 2006
 KCC WICHITA

For KCC Use ONLY
 API # 15 - 069-20288-0000
 Conductor pipe required None feet
 Minimum surface pipe required 540 feet per Alt. X2
 Approved by: RH 5-9-06
 This authorization expires: 11-9-06
 (This authorization void if drilling not started within 6 months of approval date.)
 Spud date: _____ Agent: _____

Remember to:
 - File Drill Pit Application (form CDP-1) with Intent to Drill;
 - File Completion Form ACO-1 within 120 days of spud date;
 - File acreage attribution plat according to field proration orders;
 - Notify appropriate district office 48 hours prior to workover or re-entry;
 - Submit plugging report (CP-4) after plugging is completed;
 - Obtain written approval before disposing or injecting salt water.
 - If this permit has expired (See: authorized expiration date) please check the box below and return to the address below.
 Well Not Drilled - Permit Expired
 Signature of Operator or Agent: _____
 Date: _____

29
 87
 30W

Mail to: KCC - Conservation Division, 130 S. Market - Room 2078, Wichita, Kansas 67202

IN ALL CASES PLOT THE INTENDED WELL ON THE PLAT BELOW

Plat of acreage attributable to a well in a prorated or spaced field

If the intended well is in a prorated or spaced field, please fully complete this side of the form. If the intended well is in a prorated or spaced field complete the plat below showing that the well will be properly located in relationship to other wells producing from the common source of supply. Please show all the wells and within 1 mile of the boundaries of the proposed acreage attribution unit for gas wells and within 1/2 mile of the boundaries of the proposed acreage attribution unit for oil wells.

API No. 15 - 069-20288-0000
 Operator: Arena Resources, Inc.
 Lease: Schmidt
 Well Number: 2-29
 Field: _____
 Number of Acres attributable to well: _____
 QTR / QTR / QTR of acreage: _____ - NW - SW

Location of Well: County: Gray
 1980 _____ feet from N / S Line of Section
 660 _____ feet from E / W Line of Section
 Sec. 29 Twp. 27 S. R. 30 East West

Is Section: Regular or Irregular

If Section is Irregular, locate well from nearest corner boundary.
 Section corner used: NE NW SE SW

PLAT

*(Show location of the well and shade attributable acreage for prorated or spaced wells.)
 (Show footage to the nearest lease or unit boundary line.)*

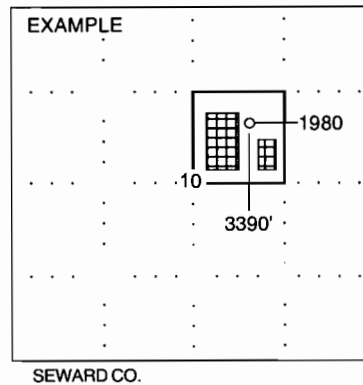
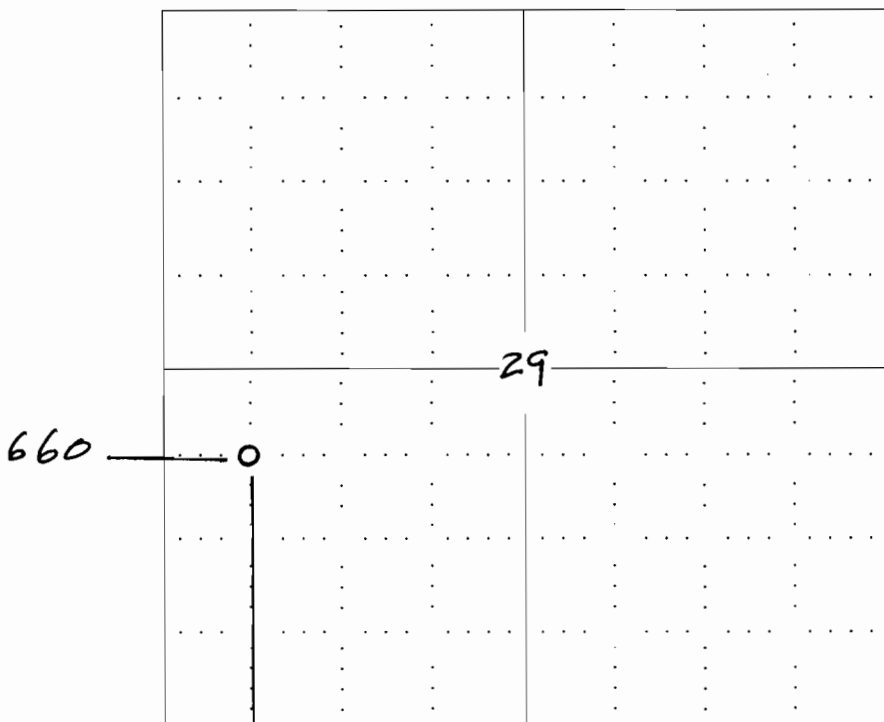

**RECEIVED
 MAY 04 2006
 KCC WICHITA**

NOTE: In all cases locate the spot of the proposed drilling locaton.

1980

In plotting the proposed location of the well, you must show:

1. The manner in which you are using the depicted plat by identifying section lines, i.e. 1 section, 1 section with 8 surrounding sections, 4 sections, etc.
2. The distance of the proposed drilling location from the section's south / north and east / west.
3. The distance to the nearest lease or unit boundary line.
4. If proposed location is located within a prorated or spaced field a certificate of acreage attribution plat must be attached: (CO-7 for oil wells; CG-8 for gas wells).

**KANSAS CORPORATION COMMISSION
OIL & GAS CONSERVATION DIVISION
APPLICATION FOR SURFACE PIT**

Form CDP-1
April 2004
Form must be Typed

Submit in Duplicate

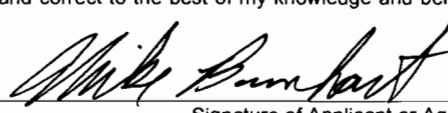
Operator Name: Arena Resources, Inc.		License Number: 33573
Operator Address: 4920 S Lewis, Ste 107		
Contact Person: Mike Barnhart		Phone Number: (918) 747 - 6060
Lease Name & Well No.: Schmidt No. 2-29		Pit Location (QQQQ): _____ - _____ - NW - SW Sec. 29 Twp. 27 R. 30 <input type="checkbox"/> East <input checked="" type="checkbox"/> West 1980 Feet from <input type="checkbox"/> North / <input checked="" type="checkbox"/> South Line of Section 660 Feet from <input type="checkbox"/> East / <input checked="" type="checkbox"/> West Line of Section Gray County
Type of Pit: <input type="checkbox"/> Emergency Pit <input type="checkbox"/> Burn Pit <input type="checkbox"/> Settling Pit <input checked="" type="checkbox"/> Drilling Pit <input type="checkbox"/> Workover Pit <input type="checkbox"/> Haul-Off Pit <small>(If WP Supply API No. or Year Drilled)</small>	Pit is: <input checked="" type="checkbox"/> Proposed <input type="checkbox"/> Existing If Existing, date constructed: _____ Pit capacity: 23000 (bbls)	
Is the pit located in a Sensitive Ground Water Area? <input type="checkbox"/> Yes <input checked="" type="checkbox"/> No		Chloride concentration: _____ mg/l <small>(For Emergency Pits and Settling Pits only)</small>
Is the bottom below ground level? <input checked="" type="checkbox"/> Yes <input type="checkbox"/> No	Artificial Liner? <input type="checkbox"/> Yes <input checked="" type="checkbox"/> No	How is the pit lined if a plastic liner is not used?
Pit dimensions (all but working pits): 150 Length (feet) 150 Width (feet) _____ N/A: Steel Pits Depth from ground level to deepest point: 8 (feet)		
If the pit is lined give a brief description of the liner material, thickness and installation procedure.		Describe procedures for periodic maintenance and determining liner integrity, including any special monitoring.
		RECEIVED MAY 04 2006 KCC WICHITA
Distance to nearest water well within one-mile of pit 1043 feet Depth of water well 410 feet	Depth to shallowest fresh water 175 feet. Source of information: KAKG ^① _____ measured _____ well owner _____ electric log _____ KDWR	
Emergency, Settling and Burn Pits ONLY: Producing Formation: _____ Number of producing wells on lease: _____ Barrels of fluid produced daily: _____ Does the slope from the tank battery allow all spilled fluids to flow into the pit? <input type="checkbox"/> Yes <input type="checkbox"/> No	Drilling, Workover and Haul-Off Pits ONLY: Type of material utilized in drilling/workover: Gel mud Number of working pits to be utilized: 1 Abandonment procedure: Dewater, evaporate, close Drill pits must be closed within 365 days of spud date.	
I hereby certify that the above statements are true and correct to the best of my knowledge and belief.		
_____ 5-4-06 _____ Date	 Signature of Applicant or Agent	

15-069-2008-0000

KCC OFFICE USE ONLY			
Date Received: 5/8/06	Permit Number: _____	Permit Date: 5/8/06	Lease Inspection: <input type="checkbox"/> Yes <input checked="" type="checkbox"/> No

Mail to: KCC - Conservation Division, 130 S. Market - Room 2078, Wichita, Kansas 67202