

1024
*** CORRECTED API #**

For KCC Use: 5-14-06
Effective Date: 4
District # 7
SGA? Yes No

KANSAS CORPORATION COMMISSION
OIL & GAS CONSERVATION DIVISION
NOTICE OF INTENT TO DRILL
Must be approved by KCC five (5) days prior to commencing well

Form C-1
December 2002
Form must be Typed
Form must be Signed
All blanks must be Filled

Expected Spud Date _____
month day year

OPERATOR: License# 03553
Name: Citation Oil & Gas Corp.
Address: P O Box 690688
Houston, Texas 77269
City/State/Zip: _____
Contact Person: Sharon Ward / Jeff Lewis
Phone: 281-517-7309 / 405-681-9400

CONTRACTOR: License# 9431
Name: Vonfeldt Drilling Inc.

Well Drilled For:	Well Class:	Type Equipment:
<input checked="" type="checkbox"/> Oil	<input type="checkbox"/> Enh Rec	<input checked="" type="checkbox"/> Mud Rotary
<input type="checkbox"/> Gas	<input type="checkbox"/> Storage	<input type="checkbox"/> Air Rotary
<input type="checkbox"/> OWWO	<input type="checkbox"/> Disposal	<input type="checkbox"/> Cable
<input type="checkbox"/> Seismic; # of Holes	<input type="checkbox"/> Wildcat	
<input type="checkbox"/> Other	<input type="checkbox"/> Other	

If OWWO: old well information as follows:
Operator: _____
Well Name: _____
Original Completion Date: _____ Original Total Depth: _____

Directional, Deviated or Horizontal wellbore? Yes No
If Yes, true vertical depth: _____
Bottom Hole Location: _____
KCC DKT #: _____

*** WAS: API 15-051-22530-0000**
IS: API 15-051-25530-0000

Spot SW SE SE Sec. 1 Twp. 13 S. R. 16 East
 West
409 feet from N / S Line of Section
2326 feet from E / W Line of Section
Is SECTION Regular Irregular?

(Note: Locate well on the Section Plat on reverse side)

County: Ellis
Lease Name: Wieland Unit Well #: 6-11
Field Name: Fairport

Is this a Prorated / Spaced Field? Yes No
Target Formation(s): Topeka, Lansing Kansas City, Arbuckle

Nearest Lease or unit boundary: 409'
Ground Surface Elevation: 1924' feet MSL

Water well within one-quarter mile: Yes No
Public water supply well within one mile: Yes No

Depth to bottom of fresh water: 180'
Depth to bottom of usable water: 500' (Dakota)

Surface Pipe by Alternate: 1 2
Length of Surface Pipe Planned to be set: 925'

Length of Conductor Pipe required: None
Projected Total Depth: 3445'

Formation at Total Depth: Arbuckle

Water Source for Drilling Operations:
 Well Farm Pond Other _____
DWR Permit #: N/A

(Note: Apply for Permit with DWR)

Will Cores be taken? Yes No
If Yes, proposed zone: _____

AFFIDAVIT

The undersigned hereby affirms that the drilling, completion and eventual plugging of this well will comply with K.S.A. 55 et. seq.

It is agreed that the following minimum requirements will be met:

1. Notify the appropriate district office **prior** to spudding of well;
2. A copy of the approved notice of intent to drill **shall be posted** on each drilling rig;
3. The minimum amount of surface pipe as specified below **shall be set** by circulating cement to the top; in all cases surface pipe **shall be set** through all unconsolidated materials plus a minimum of 20 feet into the underlying formation.
4. If the well is dry hole, an agreement between the operator and the district office on plug length and placement is necessary **prior to plugging**;
5. The appropriate district office will be notified before well is either plugged or production casing is cemented in;
6. If an ALTERNATE II COMPLETION, production pipe shall be cemented from below any usable water to surface within **120 days** of spud date. Or pursuant to Appendix "B" - Eastern Kansas surface casing order #133,891-C, which applies to the KCC District 3 area, alternate II cementing must be completed within 30 days of the spud date or the well shall be plugged. **In all cases, NOTIFY district office** prior to any cementing.

I hereby certify that the statements made herein are true and to the best of my knowledge and belief.

Date: May 5, 2006 Signature of Operator or Agent: Sharon Ward Title: Permitting Manager

For KCC Use ONLY
API # 15 - 051-25530-0000
Conductor pipe required None feet
Minimum surface pipe required 520 feet per Alt. 1
Approved by: Per 5-9-06 / Per 5-10-06
This authorization expires: 11-9-06
(This authorization void if drilling not started within 6 months of effective date.)
Spud date: _____ Agent: _____

Remember to:

- File Drill Pit Application (form CDP-1) with Intent to Drill;
 - File Completion Form ACO-1 within 120 days of spud date;
 - File acreage attribution plat according to field proration orders;
 - Notify appropriate district office 48 hours prior to workover or re-entry;
 - Submit plugging report (CP-4) after plugging is completed;
 - Obtain written approval before disposing or injecting salt water.
- If this permit has expired (See: authorized expiration date) please check the box below and return to the address below.

Well Not Drilled - Permit Expired
Signature of Operator or Agent: _____
Date: _____

Mail to: KCC - Conservation Division, 130 S. Market - Room 2078, Wichita, Kansas 67202

RECEIVED
MAY 04 2006

KCC WICHITA

1-13-16W

6024

CORRECTED
API #

Side Two

IN ALL CASES PLOT THE INTENDED WELL ON THE PLAT BELOW

Plat of acreage attributable to a well in a prorated or spaced field

If the intended well is in a prorated or spaced field, please fully complete this side of the form. If the intended well is in a prorated or spaced field complete the plat below showing that the well will be properly located in relationship to other wells producing from the common source of supply. Please show all the wells and within 1 mile of the boundaries of the proposed acreage attribution unit for gas wells and within 1/2 mile of the boundaries of the proposed acreage attribution unit for oil wells.

API No. 15 - 051-25530-0000
Operator: Citation Oil & Gas Corp.
Lease: Wieland Unit
Well Number: 6-11
Field: Fairport
Number of Acres attributable to well: _____
QTR / QTR / QTR of acreage: SW - SE - SE

Location of Well: County: Ellis
409 feet from N / S Line of Section
2326 feet from E / W Line of Section
Sec. 1 Twp. 13 S. R. 16 East West
Is Section: Regular or Irregular
If Section is Irregular, locate well from nearest corner boundary.
Section corner used: NE NW SE SW

PLAT

*(Show location of the well and shade attributable acreage for prorated or spaced wells.)
(Show footage to the nearest lease or unit boundary line.)*

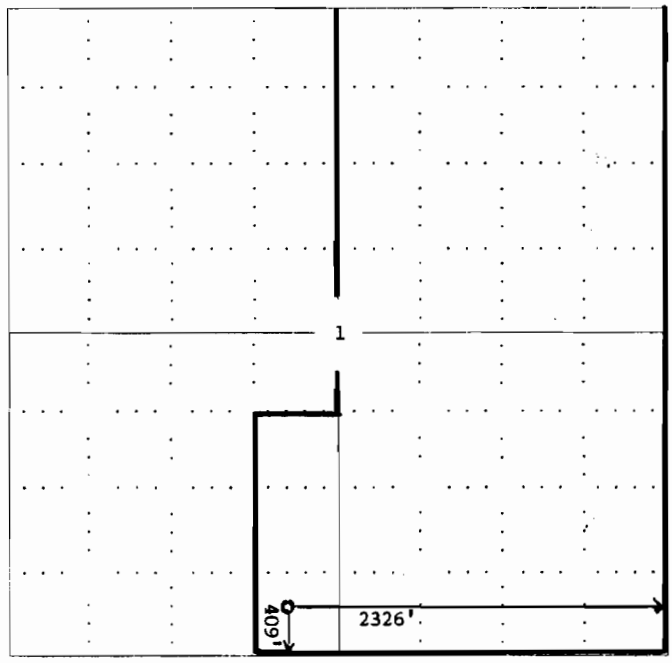

RECEIVED
MAY 04 2006
KCC WICHITA

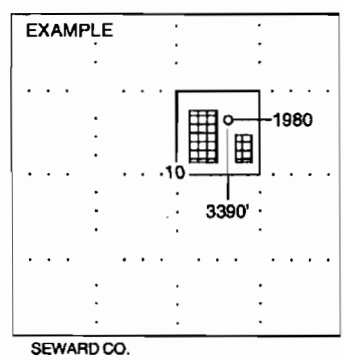

NOTE: In all cases locate the spot of the proposed drilling location.

In plotting the proposed location of the well, you must show:

1. The manner in which you are using the depicted plat by identifying section lines, i.e. 1 section, 1 section with 8 surrounding sections, 4 sections, etc.
2. The distance of the proposed drilling location from the section's south / north and east / west.
3. The distance to the nearest lease or unit boundary line.
4. If proposed location is located within a prorated or spaced field a certificate of acreage attribution plat must be attached: (CO-7 for oil wells; CG-8 for gas wells).

CORRECTED
API #
 Form CDP-1
 April 2004
 Form must be Typed

KANSAS CORPORATION COMMISSION
 OIL & GAS CONSERVATION DIVISION
APPLICATION FOR SURFACE PIT

Submit in Duplicate

Operator Name: Citation Oil & Gas Corp.		License Number: 03553
Operator Address: P O Box 690688, Houston, Texas 77269		
Contact Person: Sharon Ward		Phone Number: (281) 517 - 7309
Lease Name & Well No.: Wieland Unit 6-11		Pit Location (QQQQ): <u>SW SW SE</u> Sec. <u>1</u> Twp. <u>13</u> R. <u>16</u> <input type="checkbox"/> East <input checked="" type="checkbox"/> West <u>409</u> Feet from <input type="checkbox"/> North / <input checked="" type="checkbox"/> South Line of Section <u>2326</u> Feet from <input checked="" type="checkbox"/> East / <input type="checkbox"/> West Line of Section Ellis County
Type of Pit: <input type="checkbox"/> Emergency Pit <input type="checkbox"/> Burn Pit <input type="checkbox"/> Settling Pit <input checked="" type="checkbox"/> Drilling Pit <input type="checkbox"/> Workover Pit <input type="checkbox"/> Haul-Off Pit <small>(If WP Supply API No. or Year Drilled)</small>	Pit is: <input checked="" type="checkbox"/> Proposed <input type="checkbox"/> Existing If Existing, date constructed: _____ Pit capacity: 600 (bbls)	
Is the pit located in a Sensitive Ground Water Area? <input type="checkbox"/> Yes <input checked="" type="checkbox"/> No		Chloride concentration: _____ mg/l <small>(For Emergency Pits and Settling Pits only)</small>
Is the bottom below ground level? <input checked="" type="checkbox"/> Yes <input type="checkbox"/> No	Artificial Liner? <input type="checkbox"/> Yes <input checked="" type="checkbox"/> No	How is the pit lined if a plastic liner is not used? Bentonite and drill solids
Pit dimensions (all but working pits): <u>100</u> Length (feet) <u>100</u> Width (feet) N/A: Steel Pits Depth from ground level to deepest point: <u>4</u> (feet)		
If the pit is lined give a brief description of the liner material, thickness and installation procedure.		Describe procedures for periodic maintenance and determining liner integrity, including any special monitoring.
Distance to nearest water well within one-mile of pit <u>None</u> / feet Depth of water well <u>N/A</u> feet		Depth to shallowest fresh water <u>180</u> feet. Source of information: _____ measured _____ well owner _____ electric log <input checked="" type="checkbox"/> KDWR
Emergency, Settling and Burn Pits ONLY: Producing Formation: _____ Number of producing wells on lease: _____ Barrels of fluid produced daily: _____ Does the slope from the tank battery allow all spilled fluids to flow into the pit? <input type="checkbox"/> Yes <input type="checkbox"/> No		Drilling, Workover and Haul-Off Pits ONLY: Type of material utilized in drilling/workover: <u>Conditioned native mud fresh water</u> Number of working pits to be utilized: <u>1</u> Abandonment procedure: <u>Evaporation and backfill</u> Drill pits must be closed within 365 days of spud date.
I hereby certify that the above statements are true and correct to the best of my knowledge and belief.		
<u>May 5, 2006</u> Date		<u>Sharon Ward</u> Signature of Applicant or Agent
RECEIVED MAY 04 2006 KCC WICHITA		
KCC OFFICE USE ONLY		
Date Received: <u>5/8/06</u> Permit Number: _____ Permit Date: <u>5/8/06</u> Lease Inspection: <input type="checkbox"/> Yes <input checked="" type="checkbox"/> No		

15-051-25530-0000

Mail to: KCC - Conservation Division, 130 S. Market - Room 2078, Wichita, Kansas 67202