

For KCC Use: 4-29-06
Effective Date: 3
District # 3
SGA? ☐ Yes ☒ No

KANSAS CORPORATION COMMISSION
OIL & GAS CONSERVATION DIVISION

NOTICE OF INTENT TO DRILL

Must be approved by KCC five (5) days prior to commencing well

Revised
CORRECTED
Form must be Typed
Form must be Signed
Form must be Filled
Shiloh

Form C-1

December 2002

Expected Spud Date 4/26/06
month day year

OPERATOR: License# 33583
Name: Admiral Bay (USA) Inc.
Address: 14550 E Easter Ave, Ste. 1000
City/State/Zip: Centennial, CO 80112
Contact Person: Steven Tedesco
Phone: 303.671-7242
617
CONTRACTOR: License# 5786
Name: McGowan Drilling

Well Drilled For:	Well Class:	Type Equipment:
<input type="checkbox"/> Oil	<input type="checkbox"/> Enh Rec	<input checked="" type="checkbox"/> Infield
<input checked="" type="checkbox"/> Gas	<input type="checkbox"/> Storage	<input type="checkbox"/> Pool Ext.
<input type="checkbox"/> OWWO	<input type="checkbox"/> Disposal	<input type="checkbox"/> Wildcat
<input type="checkbox"/> Seismic; # of Holes	<input type="checkbox"/> Other	<input type="checkbox"/> Cable
<input type="checkbox"/> Other		

If OWWO: old well information as follows:

Operator: _____
Well Name: _____
Original Completion Date: _____ Original Total Depth: _____

Directional, Deviated or Horizontal wellbore? ☐ Yes ☒ No

If Yes, true vertical depth: _____

Bottom Hole Location: _____

KCC DKT #: _____

** WAS: 2005 FSL 505 FWL NW SW
IS: 2178 FSL 410 FWL NW NW SW*

AFFIDAVIT

The undersigned hereby affirms that the drilling, completion and eventual plugging of this well will comply with K.S.A. 55 et. seq.

It is agreed that the following minimum requirements will be met:

1. Notify the appropriate district office **prior** to spudding of well;
2. A copy of the approved notice of intent to drill **shall be** posted on each drilling rig;
3. The minimum amount of surface pipe as specified below **shall be set** by circulating cement to the top; in all cases surface pipe **shall be** through all unconsolidated materials plus a minimum of 20 feet into the underlying formation.
4. If the well is dry hole, an agreement between the operator and the district office on plug length and placement is necessary **prior to plugging**;
5. The appropriate district office will be notified before well is either plugged or production casing is cemented in;
6. If an ALTERNATE II COMPLETION, production pipe shall be cemented from below any usable water to surface within **120 days** of spud date.
Or pursuant to Appendix "B" - Eastern Kansas surface casing order #133,891-C, which applies to the KCC District 3 area, alternate II cementing must be completed within 30 days of the spud date or the well shall be plugged. **In all cases, NOTIFY district office** prior to any cementing.

I hereby certify that the statements made herein are true and to the best of my knowledge and belief.

Date: 5/11/06 Signature of Operator or Agent: [Signature] Title: Land Coordinator

For KCC Use ONLY

API # 15 - 001-29402-0000
Conductor pipe required None feet
Minimum surface pipe required 20 feet per Alt. *X2*
Approved by: Recd 4-24-06 / Recd 5-17-06
This authorization expires: 10-24-06
(This authorization void if drilling not started within 6 months of effective date.)
Spud date: _____ Agent: _____

Spot NW NW SW Sec. 25 Twp. 26S S. R. 17 ☒ East ☐ West
2178 feet from ☐ N / ☒ S Line of Section
410 feet from ☐ E / ☒ W Line of Section

Is SECTION ☒ Regular ☐ Irregular?

(Note: Locate well on the Section Plat on reverse side)

County: Allen

Lease Name: Quinn Well #: 12-25

Field Name: Humboldt-Chanute

Is this a Prorated / Spaced Field? ☐ Yes ☒ No

Target Formation(s): Riverton

Nearest Lease or unit boundary: 410 FWL

Ground Surface Elevation: 955 feet MSL

Water well within one-quarter mile: ☐ Yes ☒ No

Public water supply well within one mile: ☐ Yes ☒ No

Depth to bottom of fresh water: 100'+

Depth to bottom of usable water: 200'+

Surface Pipe by Alternate: ☐ 1 ☒ 2

Length of Surface Pipe Planned to be set: 20'

Length of Conductor Pipe required: None

Projected Total Depth: 1200

Formation at Total Depth: Mississippian

Water Source for Drilling Operations: [Signature]

☐ Well ☒ Farm Pond ☐ Other

DWR Permit #: _____

(Note: Apply for Permit with DWR ☐)

Will Cores be taken? ☐ Yes ☒ No

If Yes, proposed zone: _____

RECEIVED
KANSAS CORPORATION COMMISSION
MAY 16 2006

CONSERVATION DIVISION
WICHITA, KS

Remember to:

- File Drill Pit Application (form CDP-1) with Intent to Drill;
- File Completion Form ACO-1 within 120 days of spud date;
- File acreage attribution plat according to field proration orders;
- Notify appropriate district office 48 hours prior to workover or re-entry;
- Submit plugging report (CP-4) after plugging is completed;
- Obtain written approval before disposing or injecting salt water.
- If this permit has expired (See: authorized expiration date) please check the box below and return to the address below.

☐ Well Not Drilled - Permit Expired

Signature of Operator or Agent: _____

Date: _____

Mail to: KCC - Conservation Division, 130 S. Market - Room 2078, Wichita, Kansas 67202

25
26
17E

CORRECTED**ALL CASES PLOT THE INTENDED WELL ON THE PLAT BELOW***Plat of acreage attributable to a well in a prorated or spaced field*

If the intended well is in a prorated or spaced field, please fully complete this side of the form. If the intended well is in a prorated or spaced field complete the plat below showing that the well will be properly located in relationship to other wells producing from the common source of supply. Please show all the wells and within 1 mile of the boundaries of the proposed acreage attribution unit for gas wells and within 1/2 mile of the boundaries of the proposed acreage attribution unit for oil wells.

API No. 15 - 001-29402
 Operator: Admiral Bay (USA) Inc.
 Lease: Quinn
 Well Number: 12-25
 Field: Humboldt-Chanute
 Number of Acres attributable to well: 40
 QTR / QTR / QTR of acreage: - NW - SW

Location of Well: County: Allen

* 2178 _____ feet from ☐ N / ☒ S Line of Section
 410 _____ feet from ☐ E / ☒ W Line of Section
 Sec. 25 Twp. 26S S. R. 17 ☒ East ☐ West

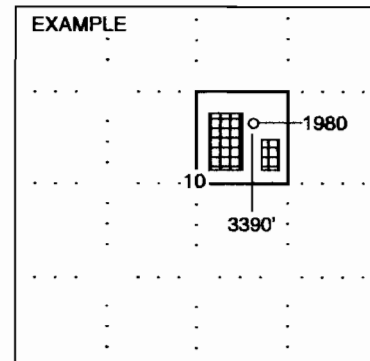
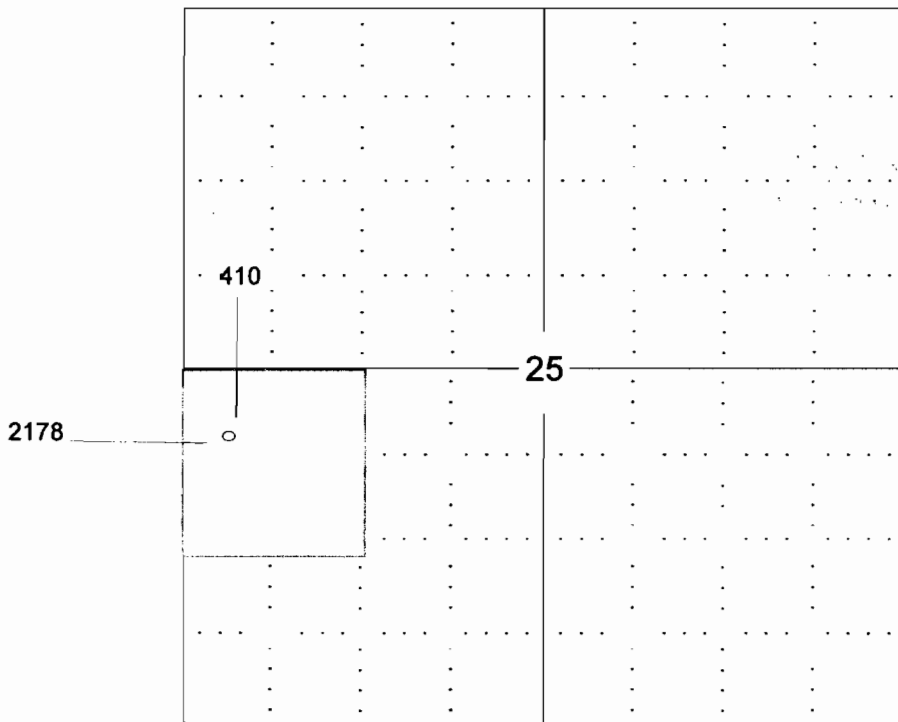
Is Section: ☒ Regular or ☐ Irregular**If Section is Irregular, locate well from nearest corner boundary.**Section corner used: ☐ NE ☐ NW ☐ SE ☐ SW**PLAT***(Show location of the well and shade attributable acreage for prorated or spaced wells.)**(Show footage to the nearest lease or unit boundary line.)*

SEWARD CO.

NOTE: In all cases locate the spot of the proposed drilling location.**In plotting the proposed location of the well, you must show:**

1. The manner in which you are using the depicted plat by identifying section lines, i.e. 1 section, 1 section with 8 surrounding sections, 4 sections, etc.
2. The distance of the proposed drilling location from the section's south / north and east / west.
3. The distance to the nearest lease or unit boundary line.
4. If proposed location is located within a prorated or spaced field a certificate of acreage attribution plat must be attached: (C0-7 for oil wells; CG-8 for gas wells).

KANSAS CORPORATION COMMISSION
OIL & GAS CONSERVATION DIVISION

APPLICATION FOR SURFACE PIT

Form CDP-1
April 2004
Form must be Typed

Submit in Duplicate

CORRECTED

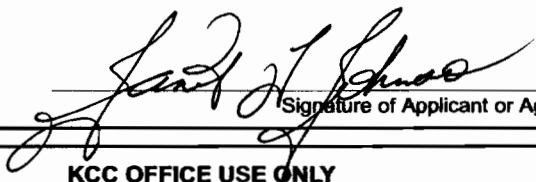
Operator Name: Admiral Bay (USA) Inc.		License Number: 33583
Operator Address: 14550 E Easter Ave., Ste. 100		
Contact Person: Janet Johnson		Phone Number: (303) 350 - 1255
Lease Name & Well No.: Quinn 12-25		Pit Location (QQQQ): _____ NW _____ SW Sec. 25 Twp. 26S R. 17 <input checked="" type="checkbox"/> East <input type="checkbox"/> West * 2475 * Feet from <input type="checkbox"/> North / <input checked="" type="checkbox"/> South Line of Section * 415 * Feet from <input type="checkbox"/> East / <input checked="" type="checkbox"/> West Line of Section Allen County
Type of Pit: <input type="checkbox"/> Emergency Pit <input type="checkbox"/> Burn Pit <input type="checkbox"/> Settling Pit <input checked="" type="checkbox"/> Drilling Pit <input type="checkbox"/> Workover Pit <input type="checkbox"/> Haul-Off Pit (If WP Supply API No. or Year Drilled)	Pit is: <input checked="" type="checkbox"/> Proposed <input type="checkbox"/> Existing If Existing, date constructed: _____ Pit capacity: 150 (bbls)	
Is the pit located in a Sensitive Ground Water Area? <input type="checkbox"/> Yes <input checked="" type="checkbox"/> No		Chloride concentration: _____ mg/l (For Emergency Pits and Settling Pits only)
Is the bottom below ground level? <input checked="" type="checkbox"/> Yes <input type="checkbox"/> No	Artificial Liner? <input type="checkbox"/> Yes <input checked="" type="checkbox"/> No	How is the pit lined if a plastic liner is not used?
Pit dimensions (all but working pits): 20 Length (feet) 20 Width (feet) N/A: Steel Pits Depth from ground level to deepest point: 5 (feet)		
If the pit is lined give a brief description of the liner material, thickness and installation procedure.		Describe procedures for periodic maintenance and determining liner integrity, including any special monitoring. <div style="text-align: center;">RECEIVED KANSAS CORPORATION COMMISSION MAY 16 2006 CONSERVATION DIVISION WICHITA, KS</div>
Distance to nearest water well within one-mile of pit N/A feet Depth of water well _____ feet	Depth to shallowest fresh water _____ feet Source of information: _____ measured _____ well owner _____ electric log _____ KDWR	
Emergency, Settling and Burn Pits ONLY: Producing Formation: _____ Number of producing wells on lease: _____ Barrels of fluid produced daily: _____ Does the slope from the tank battery allow all spilled fluids to flow into the pit? <input type="checkbox"/> Yes <input type="checkbox"/> No	Drilling, Workover and Haul-Off Pits ONLY: Type of material utilized in drilling/workover: Fresh Water & Native mud Number of working pits to be utilized: 2 Abandonment procedure: Evaporation and back fill Drill pits must be closed within 365 days of spud date.	
I hereby certify that the above statements are true and correct to the best of my knowledge and belief. _____ Date 5/11/06 <div style="text-align: center;"> Signature of Applicant or Agent</div>		
KCC OFFICE USE ONLY		
Date Received: 5/16/06 Permit Number: _____ Permit Date: 5/16/06 Lease Inspection: <input type="checkbox"/> Yes <input checked="" type="checkbox"/> No		

Mail to: KCC - Conservation Division, 130 S. Market - Room 2078, Wichita, Kansas 67202

15-001-29402-0000