

For KCC Use:  
 Effective Date: 5-28-06  
 District # 3  
 SGA?  Yes  No

KANSAS CORPORATION COMMISSION  
 OIL & GAS CONSERVATION DIVISION

RECEIVED

MAY 22 2006

Form C-1  
 December 2002  
 Form must be Typed  
 Form must be Signed  
 All blanks must be Filled

NOTICE OF INTENT TO DRILL

KCC WICHITA

Must be approved by KCC five (5) days prior to commencing well

Expected Spud Date 5 / 24 / 06  
 month day year

Spot NE-NW NE NW/4 Sec. 20 Twp. 24 S. R. 19  East  West

OPERATOR: License# 31708 ✓  
 Name: Ensminger/ Kimzey  
 Address: p.o. box 267  
 City/State/Zip: Colony Ks 66015  
 Contact Person: David Kimzey  
 Phone: 620-852-3456

4955' feet from  N /  S Line of Section  
 3520' feet from  E /  W Line of Section  
 Is SECTION  Regular  Irregular?

(Note: Locate well on the Section Plat on reverse side)

CONTRACTOR: License# 31708 ✓  
 Name: Company tools

County: Allen  
 Lease Name: Strickler Well #: W-1  
 Field Name: Iola ✓

Is this a Prorated / Spaced Field?  Yes  No ✓  
 Target Formation(s): Tucker

Nearest Lease or unit boundary: 330'

Ground Surface Elevation: N.A. feet MSL

Water well within one-quarter mile:  Yes  No ✓

Public water supply well within one mile:  Yes  No ✓

Depth to bottom of fresh water: 150'

Depth to bottom of usable water: 200+

Surface Pipe by Alternate:  1  2

Length of Surface Pipe Planned to be set: 20' ✓

Length of Conductor Pipe required: None

Projected Total Depth: 940'

Formation at Total Depth: Tucker

Water Source for Drilling Operations:  
 Well  Farm Pond Other \_\_\_\_\_

DWR Permit #: \_\_\_\_\_

(Note: Apply for Permit with DWR )

Will Cores be taken?  Yes  No

If Yes, proposed zone: \_\_\_\_\_

Well Drilled For:	Well Class:	Type Equipment:
<input type="checkbox"/> Oil	<input checked="" type="checkbox"/> Enh Rec	<input checked="" type="checkbox"/> Infield
<input type="checkbox"/> Gas	<input type="checkbox"/> Storage	<input type="checkbox"/> Pool Ext.
<input type="checkbox"/> OWWO	<input type="checkbox"/> Disposal	<input type="checkbox"/> Wildcat
<input type="checkbox"/> Seismic; _____ # of Holes	<input type="checkbox"/> Other	<input checked="" type="checkbox"/> Mud Rotary
<input type="checkbox"/> Other		<input type="checkbox"/> Air Rotary
		<input type="checkbox"/> Cable

If OWWO: old well information as follows:  
 Operator: \_\_\_\_\_  
 Well Name: \_\_\_\_\_  
 Original Completion Date: \_\_\_\_\_ Original Total Depth: \_\_\_\_\_

Directional, Deviated or Horizontal wellbore?  Yes  No

If Yes, true vertical depth: \_\_\_\_\_

Bottom Hole Location: \_\_\_\_\_

KCC DKT #: \_\_\_\_\_

AFFIDAVIT

The undersigned hereby affirms that the drilling, completion and eventual plugging of this well will comply with K.S.A. 55 et. seq.

It is agreed that the following minimum requirements will be met:

1. Notify the appropriate district office **prior** to spudding of well;
2. A copy of the approved notice of intent to drill **shall be** posted on each drilling rig;
3. The minimum amount of surface pipe as specified below **shall be set** by circulating cement to the top; in all cases surface pipe **shall be set** through all unconsolidated materials plus a minimum of 20 feet into the underlying formation.
4. If the well is dry hole, an agreement between the operator and the district office on plug length and placement is necessary **prior to plugging**;
5. The appropriate district office will be notified before well is either plugged or production casing is cemented in;
6. If an ALTERNATE II COMPLETION, production pipe shall be cemented from below any usable water to surface within **120 days** of spud date. Or pursuant to Appendix "B" - Eastern Kansas surface casing order #133,891-C, which applies to the KCC District 3 area, alternate II cementing must be completed within 30 days of the spud date or the well shall be plugged. **In all cases, NOTIFY district office** prior to any cementing.

I hereby certify that the statements made herein are true and to the best of my knowledge and belief.

Date: 5/17/06 Signature of Operator or Agent: David Kimzey Title: Co/owner

**For KCC Use ONLY**  
 API # 15 - 001-29421-0000  
 Conductor pipe required None feet  
 Minimum surface pipe required 20 feet per Alt. X2  
 Approved by: RHS-23-06  
 This authorization expires: 1-23-06  
 (This authorization void if drilling not started within 6 months of effective date.)  
 Spud date: \_\_\_\_\_ Agent: \_\_\_\_\_

Remember to:

- File Drill Pit Application (form CDP-1) with Intent to Drill;
- File Completion Form ACO-1 within 120 days of spud date;
- File acreage attribution plat according to field proration orders;
- Notify appropriate district office 48 hours prior to workover or re-entry;
- Submit plugging report (CP-4) after plugging is completed;
- Obtain written approval before disposing or injecting salt water.
- If this permit has expired (See: authorized expiration date) please check the box below and return to the address below.

Well Not Drilled - Permit Expired  
 Signature of Operator or Agent: \_\_\_\_\_  
 Date: \_\_\_\_\_

20  
24  
19E

RECEIVED

MAY 22 2006

KCC WICHITA

IN ALL CASES PLOT THE INTENDED WELL ON THE PLAT BELOW

Plat of acreage attributable to a well in a prorated or spaced field

If the intended well is in a prorated or spaced field, please fully complete this side of the form. If the intended well is in a prorated or spaced field complete the plat below showing that the well will be properly located in relationship to other wells producing from the common source of supply. Please show all the wells and within 1 mile of the boundaries of the proposed acreage attribution unit for gas wells and within 1/2 mile of the boundaries of the proposed acreage attribution unit for oil wells.

API No. 15 - 001-29421-0000
Operator: Ensminger/ Kimzey
Lease: Strickler
Well Number: W-1
Field: lola
Number of Acres attributable to well:
QTR / QTR / QTR of acreage: - - NW/4

Location of Well: County: Allen
4955' feet from N / S Line of Section
3520' feet from E / W Line of Section
Sec. 20 Twp. 24 S. R. 19 East West

Is Section: Regular or Irregular

If Section Is Irregular, locate well from nearest corner boundary.

Section corner used: NE NW SE SW

PLAT

(Show location of the well and shade attributable acreage for prorated or spaced wells.)
(Show footage to the nearest lease or unit boundary line.)

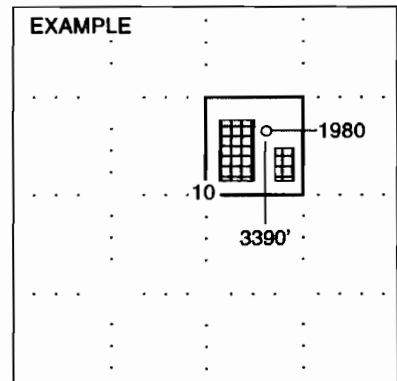
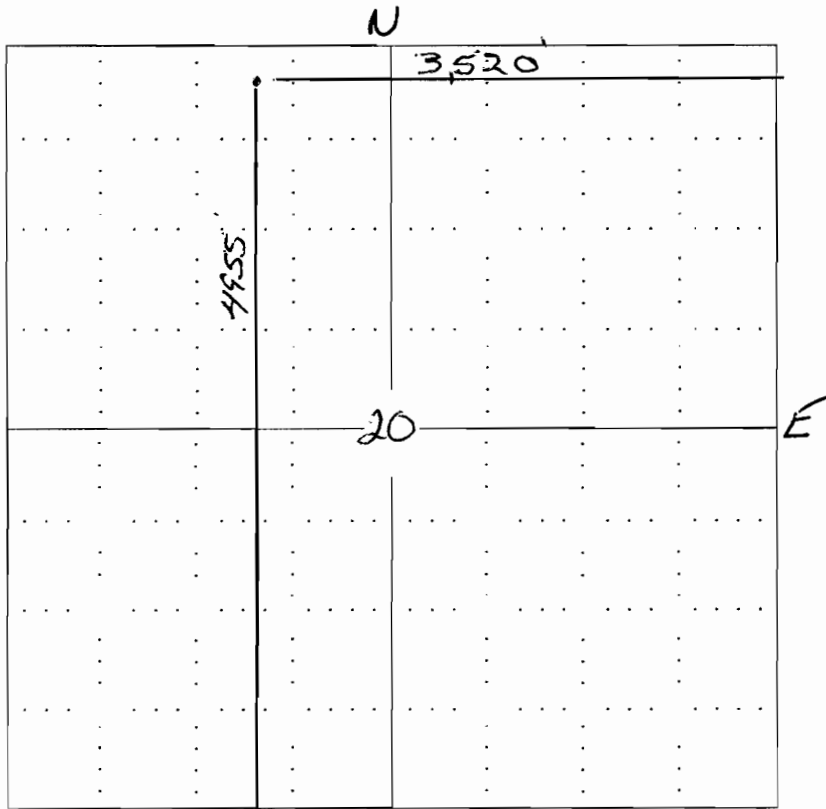

NOTE: In all cases locate the spot of the proposed drilling location.

In plotting the proposed location of the well, you must show:

- 1. The manner in which you are using the depicted plat by identifying section lines, i.e. 1 section, 1 section with 8 surrounding sections, 4 sections, etc.
2. The distance of the proposed drilling location from the section's south / north and east / west.
3. The distance to the nearest lease or unit boundary line.
4. If proposed location is located within a prorated or spaced field a certificate of acreage attribution plat must be attached: (CO-7 for oil wells;

KANSAS CORPORATION COMMISSION  
OIL & GAS CONSERVATION DIVISION  
APPLICATION FOR SURFACE POND

RECEIVED  
MAY 22 2006  
KCC WICHITA

Form CDP-1  
January 2001  
Form must be Typed

Submit in Duplicate

Operator Name: <b>Ensminger/ Kimzey</b>		License Number: <b>31708</b>
Operator Address: <b>p.o.box267 Colony,Ks. 66015</b>		
Contact Person: <b>David Kimzey</b>		Phone Number: ( <b>620</b> ) <b>852 - 3456</b>
Lease Name: <b>Strickler w-1</b>		Pit Location:
Type of Pond: ___ Emergency Pit    ___ Treatment Pit ___ Workover Pit <input checked="" type="checkbox"/> Drilling Pit ___ Burn Pit (If WP Supply API No. or Year Drilled)	Pit is: <input checked="" type="checkbox"/> Proposed    ___ Existing If Existing, date constructed: _____ Pit capacity: <b>240</b> (bbls)	<b>NW</b> Qtr. Sec. <b>20</b> Twp. <b>24</b> R. <b>19</b> <input checked="" type="checkbox"/> E <input type="checkbox"/> W <b>4955'</b> Feet from N <b>(S)</b> (circle one) Line of Section <b>3520'</b> Feet from <b>(E)</b> W (circle one) Line of Section <b>Allen</b> County
Is the pit located in a Sensitive Ground Water Area? <input type="checkbox"/> Yes <input checked="" type="checkbox"/> No		Chloride concentration: _____ mg/l (For Emergency Pits and Treatment Pits only)
Is the bottom below ground level? <input checked="" type="checkbox"/> Yes <input type="checkbox"/> No	Artificial Liner? <input type="checkbox"/> Yes <input checked="" type="checkbox"/> No	How is the pit lined if a plastic liner is not used? <b>Clay</b>
Pit dimensions (all but working pits): <u>12'</u> Length (feet) <u>5'</u> Width (feet) Depth from ground level to deepest point: <u>5'</u> (feet)		
If the pit is lined give a brief description of the liner material, thickness and installation procedure. _____ _____		Describe procedures for periodic maintenance and determining liner integrity, including any special monitoring. _____ _____
Distance to nearest water well within one-mile of pit <u>NA</u> feet    Depth of water well _____ feet		Depth to shallowest fresh water _____ feet. Source of information: _____ measured _____ well owner _____ electric log _____ KDWR
<b>Emergency, Treatment and Burn Pits ONLY:</b> Producing Formation: _____ Number of producing wells on lease: _____ Barrels of fluid produced daily: _____ Does the slope from the tank battery allow all spilled fluids to flow into the pond? <input type="checkbox"/> Yes <input type="checkbox"/> No		<b>Drilling and Workover Pits ONLY:</b> Type of material utilized in drilling/workover: <u>native mud</u> Number of working pits to be utilized: <u>2</u> Abandonment procedure: <u>air dry back fill</u> Drill pits must be closed within 365 days of spud date.
I hereby certify that the above statements are true and correct to the best of my knowledge and belief.		
5/17/06 Date		<u>David Kimzey</u> Signature of Applicant or Agent

15-001-100-0000

<b>KCC OFFICE USE ONLY</b>		
Date Received: <u>5/22/06</u>	Permit Number: _____	Permit Date: <u>5/22/06</u> Lease Inspection: <input type="checkbox"/> Yes <input checked="" type="checkbox"/> No



# KANSAS

CORPORATION COMMISSION

KATHLEEN SEBELIUS, GOVERNOR

BRIAN J. WOLINE, CHAIR

ROBERT E. KREBIEL, COMMISSIONER

MICHAEL C. MOFFET, COMMISSIONER

## NOTICE TO OPERATORS FILING INTENT TO DRILL FOR DISPOSAL OR ENHANCED RECOVERY INJECTION WELLS, (CLASS II INJECTION WELL)

The attached approved Notice of Intent to Drill indicates the proposed well is to be used for injection. An approved "Intent to Drill" does not approve injection authority as a Class II Injection Well in Kansas.

Before any well is used for injection purposes, the operator must file an application for injection authority in accordance with K.A.R. 82-3-401 and provide notice in accordance with K.A.R. 82-3-402. The Conservation Division must issue a written permit granting the application before commencement of injection.

The Conservation Division requirements and restrictions associated with Class II Injection are identified in K.A.R. 82-3-400 et seq of our regulations. Associated regulations governing drilling, completion and injection applications may be found in K.A.R. 82-3-135, Table I, Table II, in the Cedar Hills Sandstone Moratorium, (Docket #156,397-C), and the Eastern Kansas Surface Casing Order, (Docket #133,891-C).

If you have questions regarding the approval of injection authority, an injection application may be filed as a "Design Approval" before actual drilling and completion of the well occurs. If you have any questions or concerns regarding Class II injection wells or regulations, call the Underground Injection Control Department at 316-337-6200.

Failure to obtain commission approval before beginning injection is punishable by a penalty, shut-in of the well or both.